

# Udini R/C

## RAGESHARK

### OPERATING INSTRUCTIONS

Applicable to the 1611 model. V1.0 25602

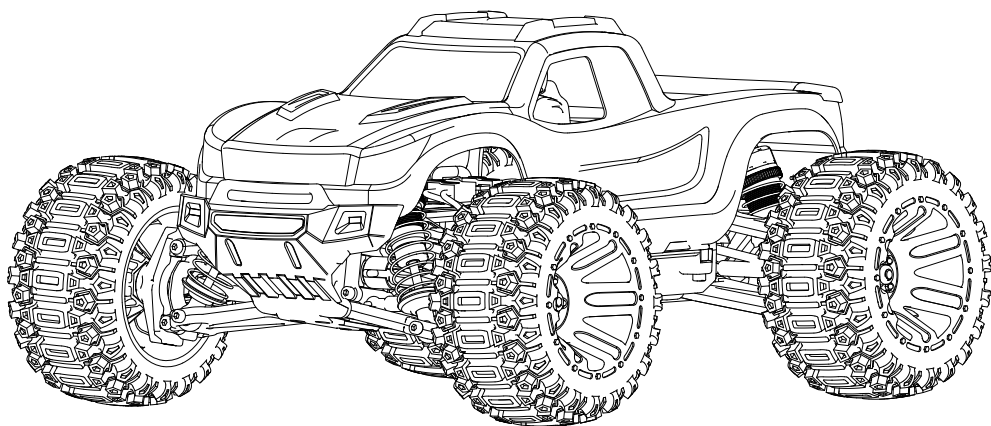

If any problem with the product, **EVEN IF** return period has ended, feel free to reach out to us directly via the retailer which the consumer purchased the product from.

**IMPORTANT!**

**WARRANTY  
GUARANTEE**

**1:16**

**4x4**

**2.4  
GHZ**

**14+**  
AGES



## THANK YOU & WHY CHOOSE UD1611

### *Thank You for Choosing UD1611!*

UD1611 RC Monster Truck - A entry-level model but built-in hobby grade design!

Your UD1611 isn't just another toy-grade remote-controlled vehicle—it's a hobby-grade machine for who demand more. With its strong upgrade system, this beast grows with you—from your first speed run at kid age to professional-level bashing decades later. Simply swap electric and transmission components to unlock new levels of performance, all while keeping the same rugged chassis that makes the UD1611 legendary.

---

### **Why choose UD1611:**

#### ▣ **Hobby-Grade Construction**

Precision-machined components with tight tolerances  
Industrial-strength chassis designed for extreme durability

#### ▣ **Professional Fastener System**

12.9-grade hardened steel hex screws throughout (vs cheap iron Phillips-head screws on toy-grade vehicle)

#### ▣ **Advanced Suspension System**

Oil-filled shocks with adjustable damping  
3x better impact absorption than basic spring shocks

#### ▣ **Battle-Ready Drivetrain**

Fully sealed transmission constructure  
Zero dirt ingress—keeps gears running smoothly in sand, mud, or rocks

#### ▣ **Quick-disassembly Design**

Swap components in short time!

#### ▣ **Unique Body Design**

Unique buckle lock to fix the body effortlessly  
Reinforced roll cage structure provides better crash protection for the body  
Detailed driver figurine adds realism for immersive driving experience

#### ▣ **Lifetime Support Ecosystem**

Genuine replacement parts always available  
Lots of upgrade parts to push limits further

#### ▣ **24/7 Lifetime Support Commitment**

- ✓ 24-hour rapid response within 7 days
- ✓ Lifetime technical support for all products
- ✓ Instant troubleshooting regardless of timezone
- ✓ Your lifetime service journey starts with your purchase



# TABLE OF CONTENTS

<b>01 - WARNING &amp; PRECAUTION &amp; POLICY STATEMENT .....</b>	<b>04</b>
01-01 Important Notice .....	04
01-02 Warning Statement .....	04
01-03 Use Sequential .....	05
01-04 Attention Statement .....	05
01-05 Battery Safety Statement .....	06
01-06 WEEE Compliance .....	06
01-07 FCC Note .....	07
<b>02 - VEHICLE SPECIFICATION .....</b>	<b>08</b>
02-01 Vehicle data .....	08
02-02 Electronic system spec. ....	08
02-03 Transmission system spec. ....	08
02-04 Structure system spec. ....	08
<b>03 - QUICK START .....</b>	<b>09</b>
03-01 Step 1 - Charge the Li-battery before playing .....	09
03-02 Step 2 - Open the truck body .....	10
03-03 Step 3 - Check the connecting on electronic parts .....	11
03-04 Step 4 - Connect the battery to SCR .....	11
03-05 Step 5 - Install the transmitter batteries .....	11
03-06 Step 6 - Power on transmitter & SCR for frequency pairing .....	12
03-07 Step 7 - Assemble the body & Start to play .....	12
03-08 Step 8 - Power OFF the SCR & transmitter .....	13
03-09 Step 9 - Product maintenance .....	13
<b>04 - TRANSMITTER &amp; SCR INSTRUCTIONS .....</b>	<b>14</b>
04-01 SCR instructions .....	14
04-01-01 SCR data .....	14
04-01-02 SCR installation .....	14
04-01-03 SCR operation tips .....	14
04-02 Transmitter instructions .....	15
04-02-01 Transmitter data .....	15
04-02-02 Transmitter functions .....	15
04-02-03 Battery installation .....	16
04-02-04 ST.TRIM .....	17
04-02-05 ST.D/R .....	17
04-02-06 Transmitter indicator light .....	18
04-02-07 Power Switch .....	18
04-02-08 CH4, Throttle speed limiter switch .....	18
04-02-09 CH3, Control button .....	18
04-02-10 CH2, Throttle trigger .....	19
04-02-11 CH1, Steering wheel .....	19
<b>05 - BUYABLE ACCESSORIES LIST .....</b>	<b>20</b>
05-01 Chassis & transmission part list .....	20
05-02 Electronic part list .....	21
05-03 Fitting part list .....	21
<b>06 - TROUBLESHOOTING .....</b>	<b>22</b>
<b>07 - EXPLOSION VIEW (REFER TO THE "APPENDIX" FOR DETAILS)</b>	



## 01 - WARNING & PRECAUTION & POLICY STATEMENT

Remark: Including Section 01-01 to 01-07.

### 01-01

### IMPORTANT NOTICE

- (1) The package or instruction manual contains important information and must be **RETAINED**.
- (2) Our company's products are improving all the time, design and specifications are subject to change without notice. All the information in this manual has been carefully checked to ensure accuracy, if any printing errors, our company reserves the final interpretation right.
- (3) The spare parts (including batteries and chargers) mentioned in the User Manual are subject to sales. KIT version not included electronic component. Configurations vary by version, please refer to the sales version.
- (4) Failure to follow these instructions (including PART 01, and others) may result in injury to yourself or others. You may also cause property damage or model damage.
- (5) For more safety precautions, please refer to the "Disclaimer and Safety Operation Guidelines".
- (6) Usage: Please follow the instructions to install and operate the model.



Download the  
operating guide

### 01-02

### WARNING STATEMENT

#### Warning:

The product should only be used by adults and children over 14 years. Adult supervision is required for children under 14 years.

#### Hinweis:

Dieses Produkt ist für die Erwachsene und die Kinder ab 14 Jahren. Die Kinder unter 14 Jahren müssen von Erwachsenen beaufsichtigt werden.

#### Avertissement:

Ce produit est destiné aux adultes et aux enfants de plus de 14 ans. Les enfants de moins de 14 ans doivent être surveillés par des adultes.

#### Avvertimento:

Questo prodotto è destinato all'uso per i adulti e bambini di età superiore ai 14 anni. I bambini di età inferiore ai 14 anni devono essere sorvegliati da un adulto.

#### Advertencia:

Este producto es para adultos y niños mayores de 14 años. Los niños menores de 14 años deben ser supervisados por adultos.

**警告:** この製品は、大人と14歳以上の子供には使用対象です。

14歳未満の子供は大人の監視が必要です。

. ويحتاج الأطفال دون سن الرابعة عشرة إلى رعاية البالغين

تحذير : هذا المنتج يستخدم فقط من قبل البالغين والأطفال فوق سن 14



**DANGER!**  
Only suitable  
for age 14+

**Before  
Operation**

- (1) Read the instruction manual in detail, or ask for the person with experience in operation, and read with the guardian if necessary.
- (2) Make sure all screws and nuts are properly tightened.
- (3) The transmitter and the vehicle should always use the battery with saturated power to avoid losing control of the model.
- (4) Please make sure that the throttle trigger is in the center position.

**During  
Operation**

- (1) First turn on the power of the transmitter, and then turn on the power of the model.
- (2) Use this product only in open areas (>5x5m) without pedestrians.
- (3) DO NOT put fingers or any objects inside rotating and moving parts.

**After  
Operation**

- (1) First turn off the model power, then turn off the transmitter's power, and take out the all battery.
- (2) Daily maintenance is required after the model is used.

- (1) The model must stop immediately and check for the reasons when it is operating abnormal.
- (2) Keep in mind that people around you may also operate a radio control model.
- (3) The motor is a heating part, please do not touch it.
- (4) If you don't use the model for a long time, please raise the chassis to let the wheels hang in the air.
- (5) Please use this product only in empty place! It is strictly forbidden to use it on roads, living area, parks, indoor areas, children or places where people gather, otherwise injury may occur.



The product contains small and sharp parts. Keep away from children.



Be sure to read the instruction manual in detail, or ask for the person with experience in operation, and read with the guardian if necessary.

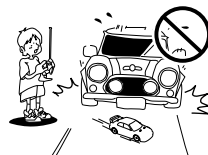

DO NOT operate in public streets or crowded places to avoid accidents.



Cutters, nippers and screw drivers need careful handling.

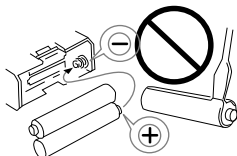

Please don't reverse contact or disassemble the battery, as this way will cause the battery to explode.

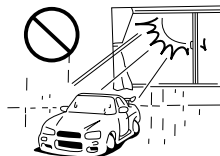

DO NOT put the model in high temperature, humidity and direct sunlight.

● Please read and observe all precautions before use. Improper use of battery may cause danger.

● It is normal for the battery to heat up after operation. Please be careful when handling the battery. If the wire is worn, it is easy to short circuit and cause fire.

1) Pay attention to the polarity of the battery when installing or replacing the battery;

2) Different types of batteries or old and new batteries should not be mixed;

3) After use, please disconnect the power supply and pull out the plug;

4) DO NOT charge the battery when it is bulging or expanding;

5) Keep away from damp, corrosive environment and heat source;

6) DO NOT short circuit, decompose or put the battery into fire;

7) Please use the attached special charger to charge the battery;

8) Please charge the battery under adult supervision;

9) Remove the battery from the model before charging;

10) DO NOT short circuit any terminals.



**⚠ WARNING  
FIRE HAZARD!**



### Li-Po Battery Disposal & Recycling

Wasted Lithium-Polymer batteries must not be placed with household trash. Please contact local environmental or waste agency or the supplier of your model or your nearest Li-Po battery recycling center.



Please help the environment by disposing of your product responsibly at the end of its life. The wheeled bin symbol indicates that this product should not be disposed of in your household waste containers. Instead, the product should be disposed of by using a designated collection point for the recycling of waste electrical and electronic equipment. The Waste of Electrical and Electronic Equipment (WEEE) Directive (2002/96/EC) requires that the best available recycling techniques be employed to minimize the impact on the environment.

Recycling electronics helps by keeping harmful chemicals out of the environment, and also saves money by reusing precious metals. Remove any batteries and dispose of them and the product at your local authority's recycling facility. For more information about where you can drop off your waste equipment for recycling, please contact your local city office your household waste disposal service, or the location where you purchased this product.

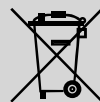

This equipment has been tested and found to comply with the limits for a Class B digital device, pursuant to Part 15 of the FCC Rules. These limits are designed to provide reasonable protection against harmful interference in a residential installation. This equipment generates uses and can radiate radio frequency energy and, if not installed and used in accordance with the instructions, may cause harmful interference to radio communications. However, there is no guarantee that interference will not occur in a particular installation. If this equipment does cause harmful interference to radio or television reception, which can be determined by turning the equipment off and on, the user is encouraged to try to correct the interference by one or more of the following measures:

- Reorient or relocate the receiving antenna.
- Increase the separation between the equipment and receiver.
- Connect the equipment into an outlet on a circuit different from that to which the receiver is connected.

**WARNING: Changes or modifications not expressly approved by the party responsible for compliance could void the user's authority to operate the equipment.**

### FCC Notice

The equipment may generate or use radio frequency energy. Changes or modifications to this equipment may cause harmful interference unless the modifications are expressly approved in the instruction manual. Modifications not authorized by the manufacturer may void user's authority to operate this device.

This device complies with Part 15 of the FCC Rules. Operation is subject to the following two conditions: (1) this device may not cause harmful interference, and (2) this device must accept any interference received, including interference that may cause undesired operation.

### FCC Radiation Exposure Statement

The device has been evaluated to meet general RF exposure requirement.

The device can be used in portable exposure condition with out restriction.





## 02 - VEHICLE SPECIFICATION

Remark: Including Section 02-01 to 02-04.

### 02-01 VEHICLE DATA

Model No.	UD1611
Vehicle Scale	1:16
Vehicle Size	L292×W225×H133mm
Vehicle Weight	1021g (without battery)
Wheelbase	180mm
Ground Clearance	24mm
Battery Compartment Size	L110×W34×H25mm
Wheel Size	ø85×45mm

### 02-02 ELECTONIC SYSTEM SPEC.

Motor	390 Brushed Motor
SCR	2-in-1 speed control & receiver (SCR), refer to "Section 04-01".
Battery	1200mAh, 7.4V, 18650, T-type connector
Steering Servo	3 wires, 17g plastic gear
Transmitter	Refer to "Section 04-02" for detail.

### 02-03 TRANSMISSION SYSTEM SPEC.

Pinion Gear	0.6M 14T Metal (Position: assembled on the Motor Shaft)
Spur Gear	0.6M 50T Metal (Position: assembled on the Main Shaft)
Input Gear	0.95M 10T Metal (Position: assembled on the 2 tips of Main Shaft)
Main Differential Gear	0.95M 30T Metal
Satellite Gear	0.8M 16T Metal
Planetary Gears	0.8M 8T Metal
Main Driveshaft	Metal
Universal Driveshaft	High-quality Nylon

### 02-04 STRUCTURE SYSTEM SPEC.

Truck Body	PVC
Chassis	2.0mm Thickness High-quality Nylon
Suspension Arm	High-quality Nylon
Shock Absorber	Oil-filled Shock Absorber, Nylon, 300cst
Shock Tower	High-quality Nylon
Wheel Hex	High-quality Nylon
Deck Board	2.0mm Thickness High-quality Nylon
Motor Mount	Metal





## 03 - QUICK START

Remark: Including Section 03-01 to 03-09.

### 03-01 STEP 1 - CHARGE THE LI-BATTERY BEFORE PLAYING

- The battery contains less power when leaving the factory, so it must be fully charged before use.
- When charging the battery, it must be disconnected from the SCR and separated from the model.
- The battery must be allowed to cool for 20 minutes after use before recharging.

- (1) Connect the included USB charging cable to the model-battery charging port;
- (2) Connect the USB cable with battery to USB port of your computer or USB adaptor (output 5V 2A)(not included);
- (3) Plug the adaptor to the household power supply;
- (4) When charging, the green LED will flash, and will become stable after fully charged. The charging process takes approximately 3-4 hours. (Not support fast charging protocol!)

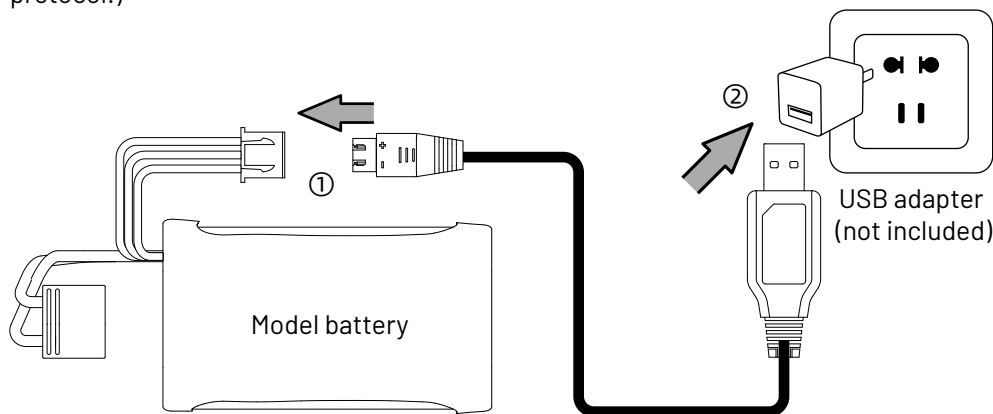

### **WARNING: MUST BE SUPERVISED WHILE CHARGING.**

*Please use the included USB charging cable and make sure it is properly connected.*

Notes: The charging time provided is experimental data and is for reference only. Actual charging time may vary depending on factors such as battery aging and charger efficiency. Use a charger with appropriate current to avoid overcharging or over-discharging, which helps extend battery lifespan.

## 03-02 STEP 2 - OPEN THE TRUCK BODY

Step 2-1

① Rear Buckle

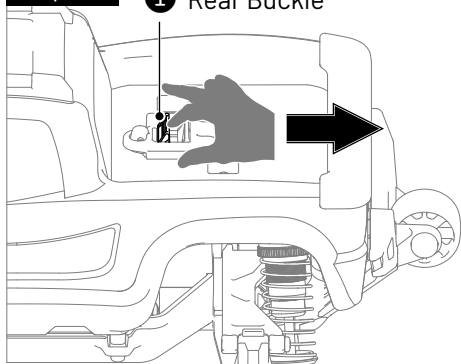

Step 2-2

② Rear Clip

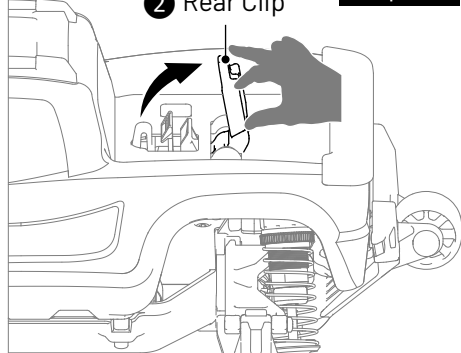

Step 2-3

Front Hook

④

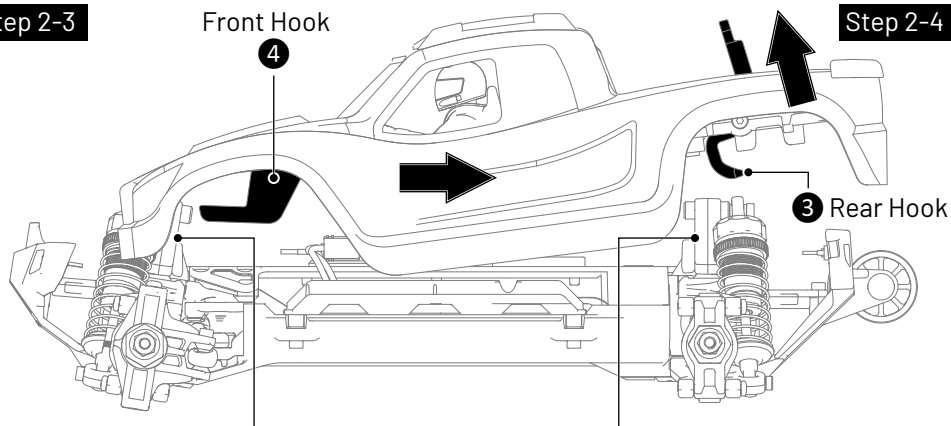

Step 2-4

③ Rear Hook

Front Shock Tower

⑤

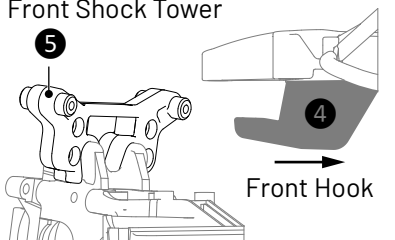

Rear Shock Tower

⑥

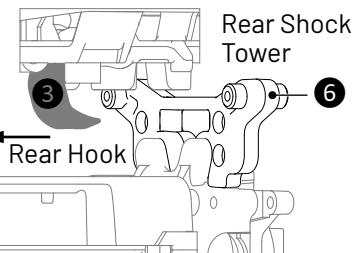

Step 2-1: Push ① Rear Buckle towards the tail to release ② Rear Clip;

Step 2-2: Lift ② Rear Clip at its max-throw to separate ③ Rear Hook from ⑥ Rear Shock Tower;

Step 2-3: Pull the truck body towards the tail to separate ④ Front Hook from ⑤ Front Shock Tower ;

Step 2-4: Lift up the truck body and take it out.

### 03-03 STEP 3 - CHECK THE CONNECTING ON ELECTRONIC PARTS

- After removing the truck body, check the connecting among SCR and other electric parts per the instruction of "Section 04-01-02".

### 03-04 STEP 4 - CONNECT THE BATTERY TO SCR

- Put the battery into the battery compartment, fix the battery with Velcro and then connect with the SCR. Take out the battery when not in use, otherwise the battery is easily damaged.

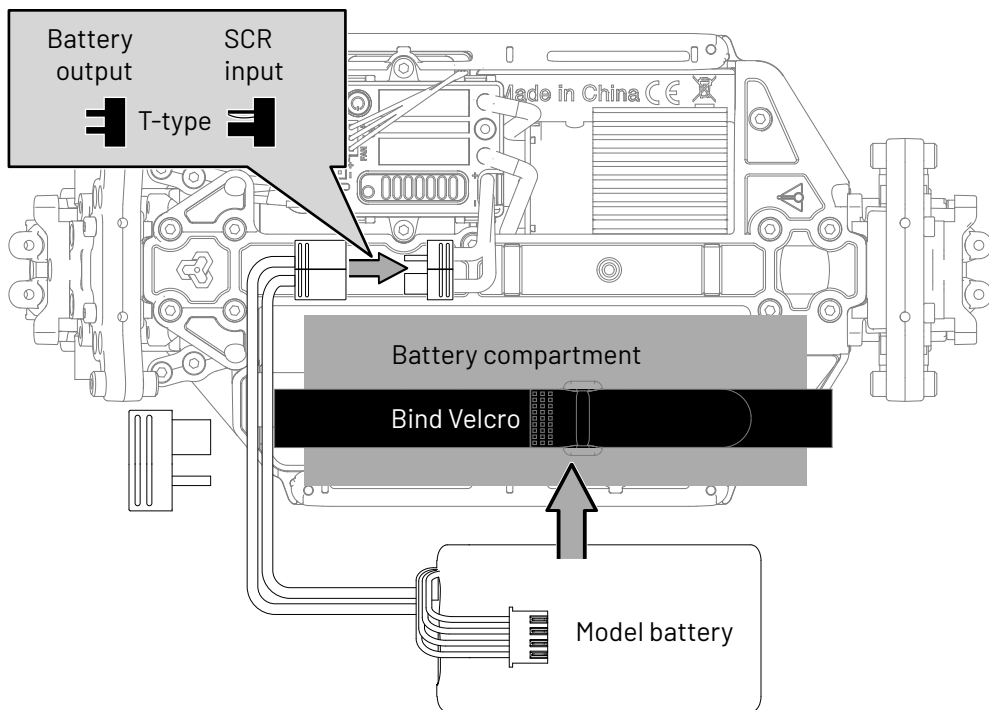

### 03-05 STEP 5 - INSTALL THE TRANSMITTER BATTERIES

- (1) Open the battery cover at the bottom of transmitter, and then install the 4 PCS of 1.5V AA batteries or 7.4V Li-ion battery with connector type PH2.0-3P.
- (2) For installation detail, refer to the "Section 04-02-03".

- (1) Always power ON your transmitter first, and then power on the SCR.
- (2) The device automatically frequency pairing successful. If all the lights keep bright, it indicates that the frequency pairing is successful. Otherwise, frequency pairing fails and needs to be done again. Refer to "Function 1" of "Section 04-02-09 CH3, CONTROL BUTTON".

Always power on your transmitter first

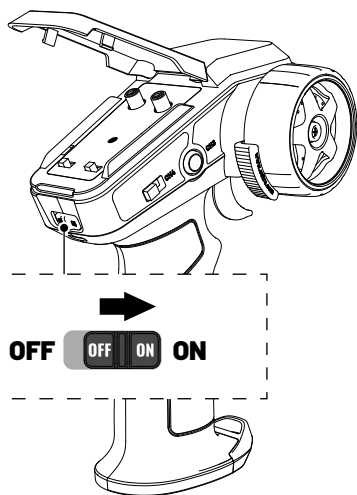

And then power on the SCR

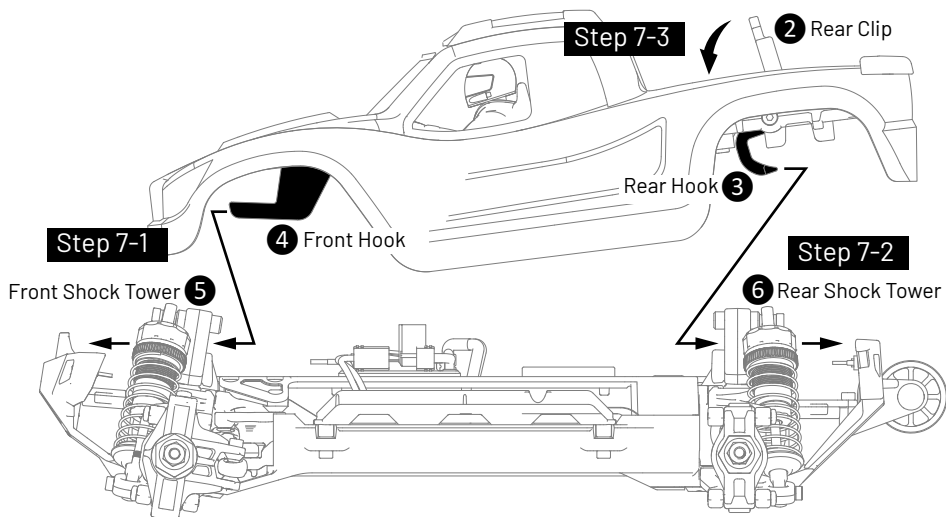
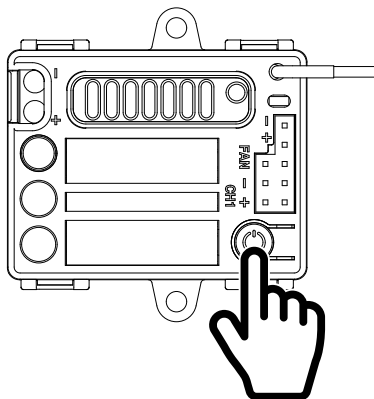

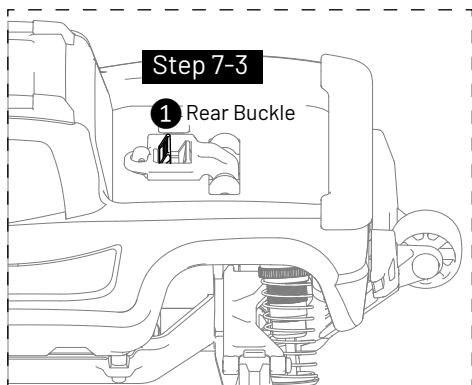

Step 7-1: Insert **4** Front Hook into **5** Front Shock Tower;

Step 7-2: Lift **2** Rear Clip at its max-throw so that **3** Rear Hook inserts into **6** Rear Shock Tower.

Step 7-3: Press down the truck body downward to secure **2** Rear Clip into **1** Rear Buckle.

The installation steps are opposite to the removal steps, refer to "Section 03-02".

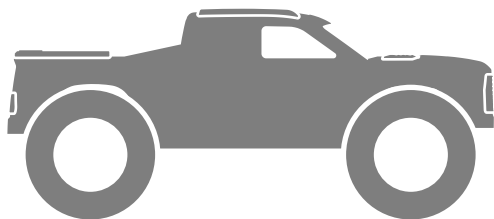

Placed on Horizontal ground

## 03-08 STEP 8 - POWER OFF THE SCR & TRANSMITTER

- (1) First, turn off the vehicle's SCR (short press  $\leq 1$  second) power and remove the battery. Open the truck body and refer to "Section 03-02" for details.
- (2) Second, turn off the transmitter power and remove the battery. Open the battery cover and refer to "Section 04-02-03" for details.
- (3) IMPORTANT: Always power OFF the SCR before the transmitter.

## 03-09 STEP 9 - PRODUCT MAINTENANCE

When not in use, remove the battery from the model and transmitter.

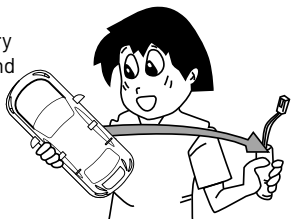

Please remove the sediment and dirt on the car completely and must be kept dry after play.



Apply lubricating oil to external metal parts.



Please separate the car and battery when not in use.

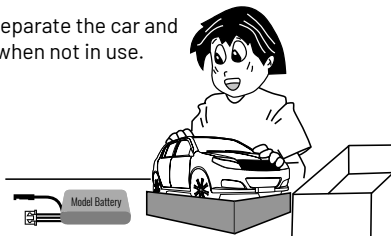



## 04 - TRANSMITTER & SCR INSTRUCTIONS

Remark: Including Section 04-01 to 04-02.

### 04-01 SCR INSTRUCTIONS

#### 04-01-01 SCR DATA

Model:	SCR1
RF Standard:	2.4GHz
Input Power:	2S (7.4V)
Rated current:	35A
Size:	39.6×17×41.5mm
Power Connector:	T-type
Motor Limit:	2S
Motor Connector:	3.5mm banana connector

#### 04-01-02 SCR INSTALLATION

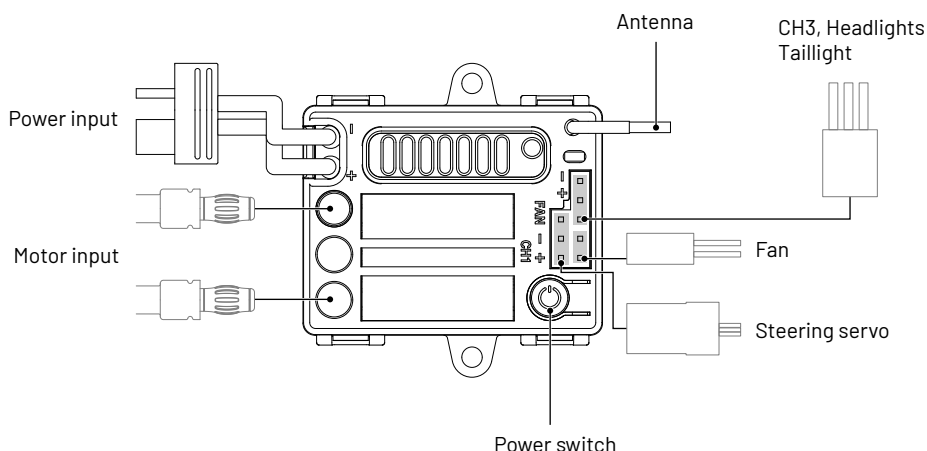

- (1) Press and hold ( $\leq 2$  seconds) to turn on the power.
- (2) Short press ( $\leq 1$  second) to turn off the power.

#### 04-01-03 SCR OPERATION TIPS



- (1) When starting to play the vehicle, always power ON your transmitter before the SCR.
- (2) After playing the vehicle, always power OFF the SCR before the transmitter.

## 04-02 TRANSMITTER INSTRUCTIONS

Before installing and operating your transmitter, please take a few minutes to familiarize yourself with the various features of the system by reading this instruction manual thoroughly.

### 04-02-01 TRANSMITTER DATA

Model	UA42-C
Control Type	Proportional
Frequency Band	2.4GHz
Channels	4
Control Distance	197 ft (60m)
Input Power Method 1	1.5V AA Battery × 4pcs
Input Power Method 2	7.4V Battery with connector type PH2.0-3P

### 04-02-02 TRANSMITTER FUNCTIONS

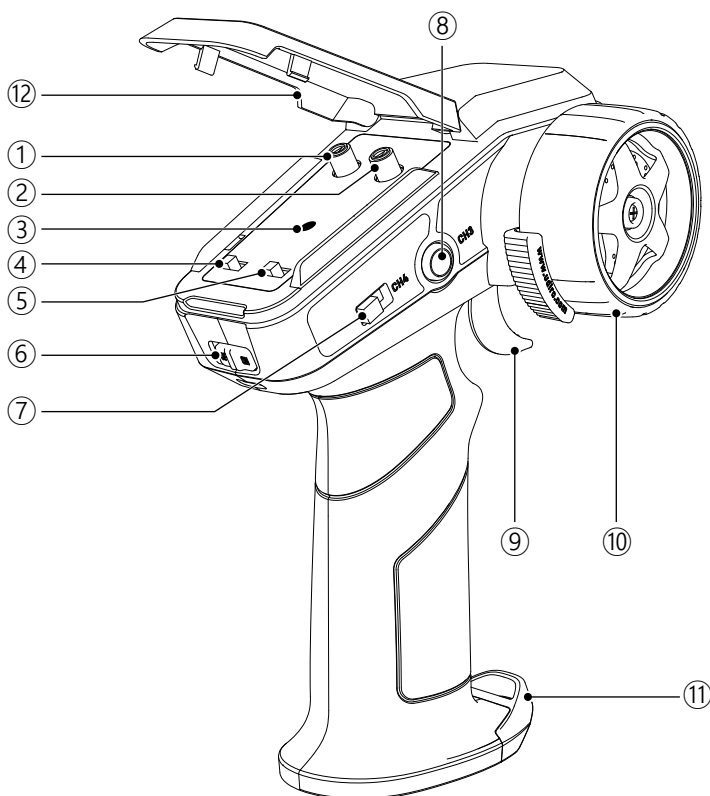

① ST. TRIM:	Steering Trim, refer to "Section 04-02-04" for detail.
② ST. D/R:	Steering Dual Rate, refer to "Section 04-02-05" for detail.
③ Transmitter Indicator:	Refer to "Section 04-02-06" for detail.
④ TH. REV:	Reverse the throttle function.
⑤ ST. REV:	Reverse the steering function.
⑥ Power Switch:	Power on / off the transmitter, refer to "Section 04-02-07".
⑦ Throttle Speed Limiter Switch:	CH4, refer to "Section 04-02-08" for detail.
⑧ CH3 Control Button:	Frequency Paring Button / the button to power on/off the headlights of the vehicle, refer to "Section 04-02-09".
⑨ CH2, Throttle Trigger:	Control the vehicle to move forward, backward, or brake, refer to "Section 04-02-10" for detail.
⑩ CH1, Steering Wheel:	Control the vehicle to turn right/left, refer to "Section 04-02-11".
⑪ Battery Cover:	Battery installation, refer to "Section 04-02-03" for detail.
⑫ Regulatory Interface Cover:	To avoid dust or water splash.

## 04-02-03

## BATTERY INSTALLATION

Open battery cover at the bottom of transmitter. Install batteries. Follow the direction of batteries designated in the inside of the battery box.

### HOW TO OPEN THE BATTERY COVER

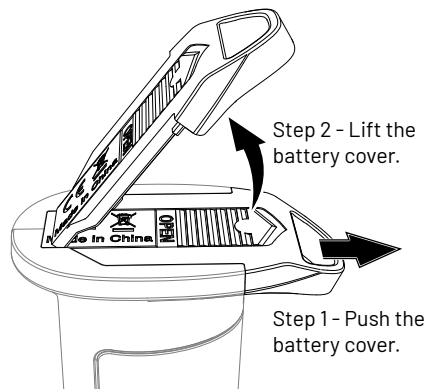

### Input Power Method 2

- Step 1: Remove the 1.5V AA battery case.
  - Step 2: Put the 7.4V Li-battery with connector type PH2.0-3P inside the battery compartment.
- Battery compartment capacity: 70×37×19mm

**NOTE:** Only 7.4V Li-batteries can be used.

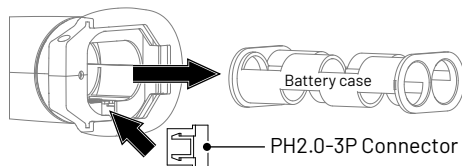

### NOTE POLARITY DIRECTION

#### Input Power Method 1

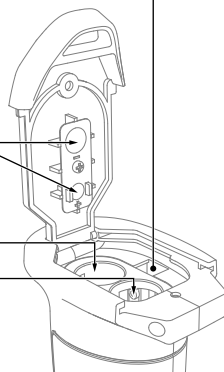
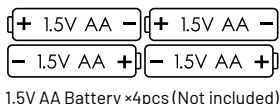



**Steering Trim:** Trim adjustment allows you to finely tune the inputs from your transmitter. It's the dial you reach for when your RC car isn't tracking straight. The steering trim is what helps navigate the RC car in a straight line.

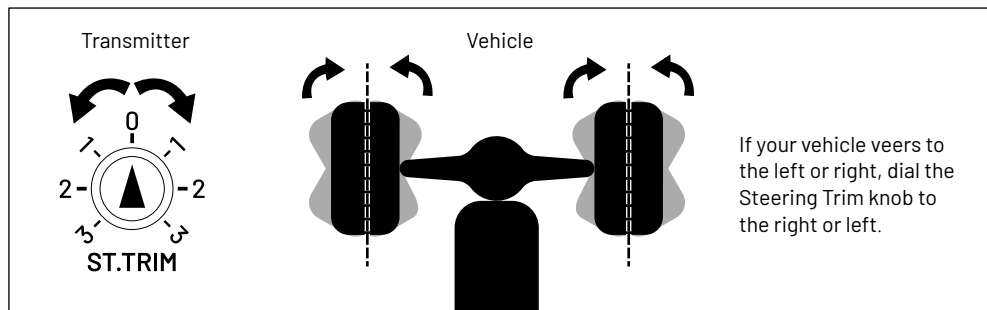

**Steering Dual Rate:** Steering Dual Rate knob can be set to control the steering throw:  
 (1)Turning the knob clockwise to increase the steering throw.  
 (2)Turning the knob anticlockwise to reduce the steering throw.

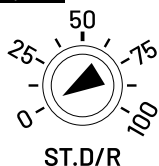
**Sample 1**

Step 1- Set the ST.D/R knob to "0" position.  
 Step 2- Dia the steering wheel of transmitter to the end.

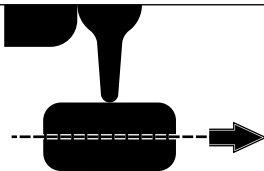

Result: The wheels cannot turn right or left, only can run straight, even you dia the steering wheel to the end.

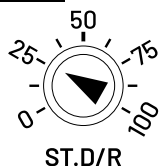
**Sample 2**

Step 1- Set the ST.D/R knob to "25" position.  
 Step 2- Dia the steering wheel of transmitter to the end.

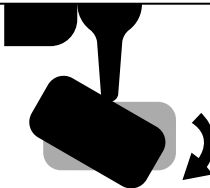

Result: The wheels can turn right or left under 25% steering throw, turn wider than 0%(Sample 1).

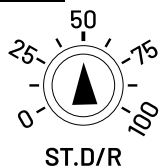
**Sample 3**

Step 1- Set the ST.D/R knob to "50" position.  
 Step 2- Dia the steering wheel of transmitter to the end.

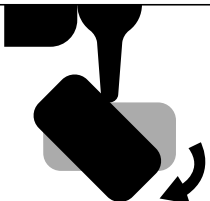

Result: The wheels can turn right or left under 50% steering throw, turn wider than 25%(Sample 2) and 0%(Sample 1).

Note: Above are the samples to help the players to under the ST. D/R function.

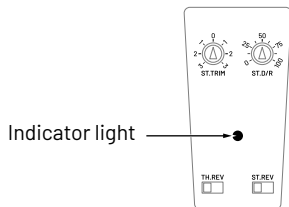

Situation 1: When the signal is weak or interrupted, the indicator will flash quickly.

Situation 2: When the power of the transmitter is low, the indicator light will flash slowly.

The above situation should be handled as soon as possible to avoid accidents.

OFF  ON

Please make sure the transmitter throttle trigger and Steering wheel are normal before starting up. Do not touch the throttle trigger when turning on the power of the transmitter.

After powering on, the transmitter will automatically pair with the device, and the indicator light will remain steadily lit. If the indicator light blinks, please refer to "Section 04-02-09" for troubleshooting instructions.

Throttle Speed Limiter has 3 speed levels: 50%, 75%, 100%.

50% Speed Level is the training mode; recommend the new beginner to play under 50% Speed Level first.

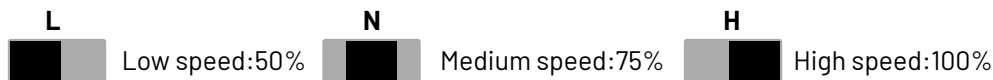

### Function 1: Frequency Paring

If auto-pairing fails, turn off all power sources. ① Restart the SCR power supply; ② Press the CH3 button to turn on the transmitter power, then release CH3. When all the lights keep bright, it indicates that the frequency pairing is successful.

### Function 2: Turn off/on the car lights

Corresponding to the CH3 channel on the SCR. The light cable needs to be properly connected before it can be used.

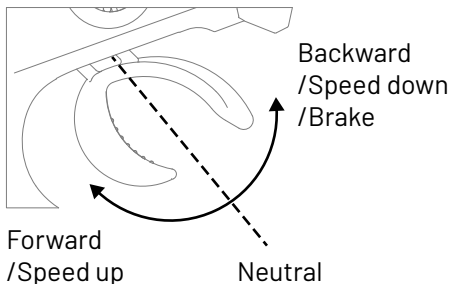
**Note:**

When using the transmitter in electric powered vehicles, the throttle trigger should always remain in the neutral position. Otherwise the vehicle may suffer erratic operation of the throttle trigger functions.

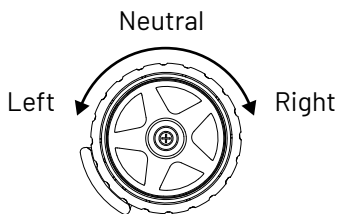



## 05 - BUYABLE ACCESSORIES LIST

Remark: Including Section 05-01 to 05-03.

### 05-01

### CHASSIS & TRANSMISSION PART LIST

Part#	Name
P16-040A/B	Body assembly
P16-002A	Wheel
P16-003A	Wheel anti slip gasket
P16-004A	Wheel adapters
P16-005	Front & Rear wheel carriers
P16-006A	Steering linkage (Not adjustable)
P16-007A	Universal drive shaft (Plastics)
P16-008	Suspension arms (Upper)
P16-009A	Shock absorber (Plastics)
P16-010	Suspension arms (Lower)
P16-011	Rear driveshaft (Plastics)
P16-012	Chassis
P16-013	Nerf bars
P16-014	Upper chassis
P16-015	Servo arm set
P16-016	Steering mechanism
P16-017A	Servo mounts
P16-018C	Main driveshaft (132mm)
P16-019A	Drive bevel gear (Zinc alloy)
P16-020A	Main spur gear (Zinc alloy)
P16-021A	Motor mounts (Zinc alloy)
P16-022A	Pinion gear (ø2.3mm, Powder alloy)
P16-023A	Differential assembly (Zinc alloy)
P16-024	Butterfly rack
P16-025	Differential housing
P16-037	Front bumper
P16-027	Buffer plate
P16-038	Bumper assembly (Rear)
P16-030A	Sun gear (Zinc alloy)
P16-031A	Differential large bevel gear (Zinc alloy)
P16-032A	Planetary gear (Zinc alloy)
P16-033	Bind Velcro

Part#	Name
-------	------

S1701	Steering servo (Plastics gear)
SCR1	2 in 1 Speed control & Receiver (Brushed)
UA42-C	Transmitter
M390	Brushed motor
LAM16-01	Lamp group
FUN16-3010	Cooling fans (30×30×10mm)
MB0-TT1274	T-type Model battery (1200mAh)
UCX24-E005	Charger (For 7.4V battery)

Part#	Name
-------	------

M01-001	Hexagon socket head cap tapping screw (ø2.6×6mm HB)
M01-003	Hexagon socket head cap tapping screw (ø2.6×10mm HB)
M01-004	Hexagon socket head cap tapping screw (ø2.6×12mm HB)
M01-005	Hexagon socket head cap tapping screw (ø2.6×15mm HB)
M01-006	Hexagon socket head cap tapping screw (ø2.6×20mm HB)
M01-012	Hexagon socket countersunk head tapping screw (ø2.6×8mm KB)
M01-016	Hexagonal flat round head self tapping screw (ø2.6×6mm TB)
M01-052	Hexagon socket head cap half threaded tapping screw (ø3×4.5+ø2.6×9mm)
M01-053	Hexagon socket head cap half threaded tapping screw (ø3×4.5+ø2.6×16mm)
M01-054	Set screw (ø3×3mm)
M01-056	Hexagon socket head cap machine screw (ø2.5×8mm HM)
M01-058	Hexagon socket countersunk head tapping screw (2.0×8mm KM)
M02-004	Outer hexagonal flange screw (ø2.6×15mm)
M03-007	Ball bearing (ø6.35×ø9.5×3.2mm)
M03-012	Ball bearing (ø8×ø12.7×4mm)
M05-041	Hollow ball (ø5×5.6mm)
M05-042	Hollow ball (ø5×7mm)
M06-015	Pin (ø2.5×27mm)
M06-016	Pin (ø2.5×38mm)
M06-017	Pin (ø1.8×9mm)
M06-018	Pin (ø1.8×10mm)
1601-022	Pin (ø1.8×6.8mm)



## 06 - TROUBLESHOOTING

PROBLEM	POSSIBLE REASON	SOLUTION
Vehicle can not move	Batteries are incorrectly assembled in remote controller.	Check transmitter batteries, refer to 04-02-03 for detail.
	Weak or damage battery in the car.	Install fully charged batteries.
	Worn or broken ESC/SCR wires or motor.	Check condition, reconnect and insulate.
	High temperature protection is triggered when the ESC/SCR is overheated.	Stop driving, ESC/SCR or motor has to cool down.
	Motor is damaged.	Replace with new unit.
	ESC/SCR or Receiver is damaged.	Replace with new unit.
	The wheel or drive shaft is entangled by debris.	Check components and remove the debris.
	The vehicle is off the control distance.	Operate the vehicle within the controlled range of transmitter.
Short runtime	Battery damaged or not fully charged.	Check condition, replace or recharge.
	Motor is dirty or damaged.	Check condition, replace or recharge.
	Terrain resistance causes excessive power consumption.	Play on other kinds of terrain.
Limited steering angle	The button of Transmitter Steering Dual Rate is set incorrectly.	Adjust Transmitter Steering Rate button per the manual.
	Damaged steering components.	Check components and replace.
Sluggish performance	Battery damaged or not fully charged.	Check condition, replace or recharge.
	Motor is dirty or damaged.	Clean , check condition or replace.
	Drivetrain is dirty or damaged.	Clean , check condition or replace.
Short range or no control on vehicle	Transmitter battery is weak or installed incorrectly.	Check transmitter batteries.
	Servo wires of receiver loose or connected incorrectly.	Reinstall signal wires to ESC receiver.
	Transmitter and ESC/SCR receiver are not paired correctly.	Frequency re pairing, refer to 04-02-09 for detail.
The indicator of the transmitter is not bright	The battery is installed incorrectly or has not enough power.	Install the battery properly or replace a new battery.
	The transmitter doesn't work.	Replace a new one.
Steering / Throttle works intermittent	ESC/SCR shuts down due to overheating.	Stop driving, ESC/SCR or motor has to cool down.
	Transmitter and ESC/SCR receiver are not paired correctly.	Check if any interference sources, or repair the transmitter and ESC receiver.

PROBLEM	POSSIBLE REASON	SOLUTION
Vehicle wanders left / right	Steering trim set out.	Adjust steering trim.
	Steering components are damaged.	Check and replace components.
	Drivetrain is dirty or damaged.	Clean, check, or replace.
Steering / Throttle operation reversed	"TH.REV" or "ST-REV" on the transmitter is set reversely.	Adjust the "TH.REV" or "ST-REV" on the transmitter per the manual .
	Check the wires from ESC/SCR to the motor are connected correctly .	Disconnect and reconnect.
The speed is lower than claimed	Use the lower speed level on Throttle Limiter.	Choose the higher speed level on Throttle Limiter.
	The Pinion Gear was jamming against the Motor Mount.	Disassemble Motor Mount to adjust the Pinion Gear.
Long frequency matching time	The signal is disturbed.	Restart the vehicle and the transmitter.
Operation delay	There might be obstacles or interferences.	Remove or avoid the obstacles or interferences.
The vehicle moves forward (backward) automatically or makes a sound of "en...."	Something wrong in transmitter.	Restart the transmitter.



## 07 - EXPLOSION VIEW (APPENDIX)

Refer to the "Appendix" for details



Copyright © UDIRC®, All rights reserved. Made in China  
Manufacturer: SHANTOU CITY UDIRC TECHNOLOGY COMPANY LIMITED  
Address: Guangfeng Industrial Zone, Guangyi street, Chenghai District,  
Shantou City, Guangdong Province, China





# 07

## **APPENDIX**

### **EXPLOSION VIEW**

Refer to (05 - BUYABLE Accessories  
LIST) for detail list.





## VIEW-1 BODY ASSEMBLY

### 视图-1 车壳组装

P16-040A

P16-040B

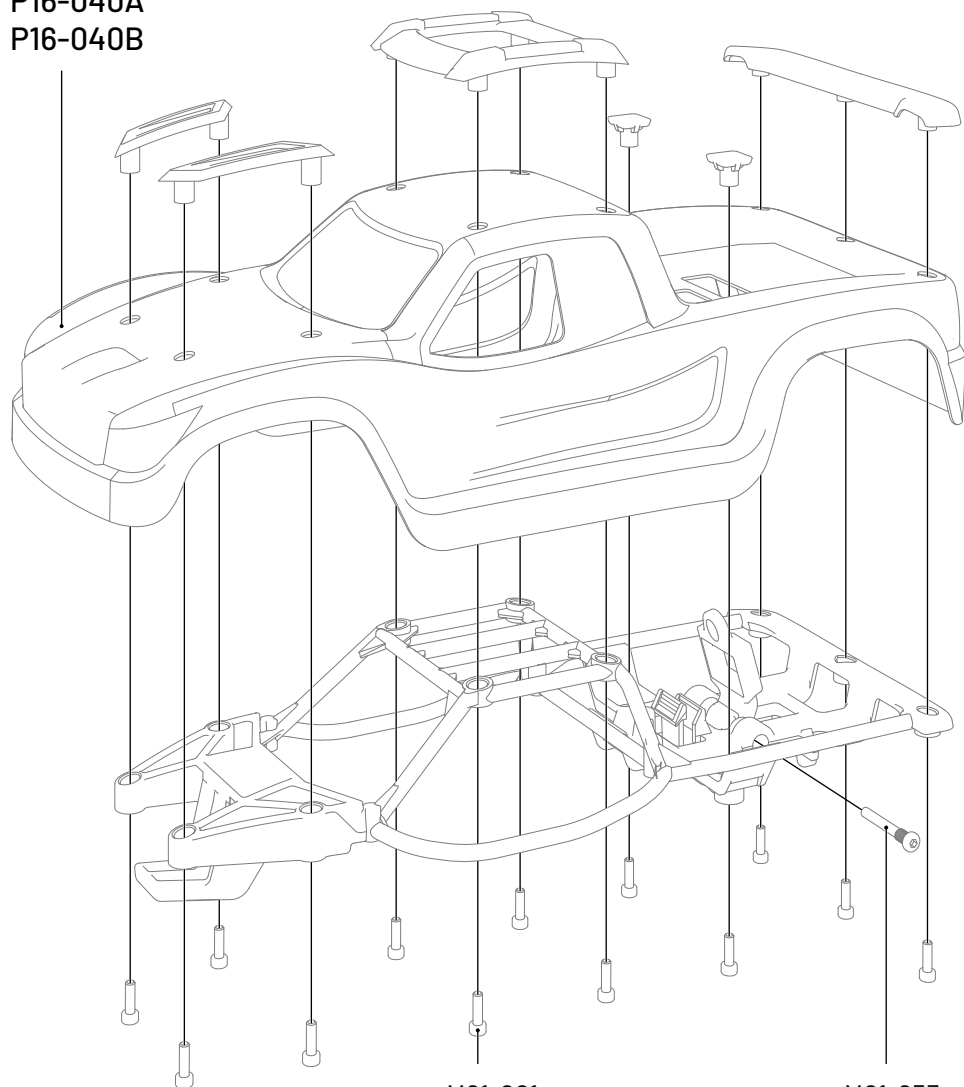

M01-001  
×13pcs

M01-053

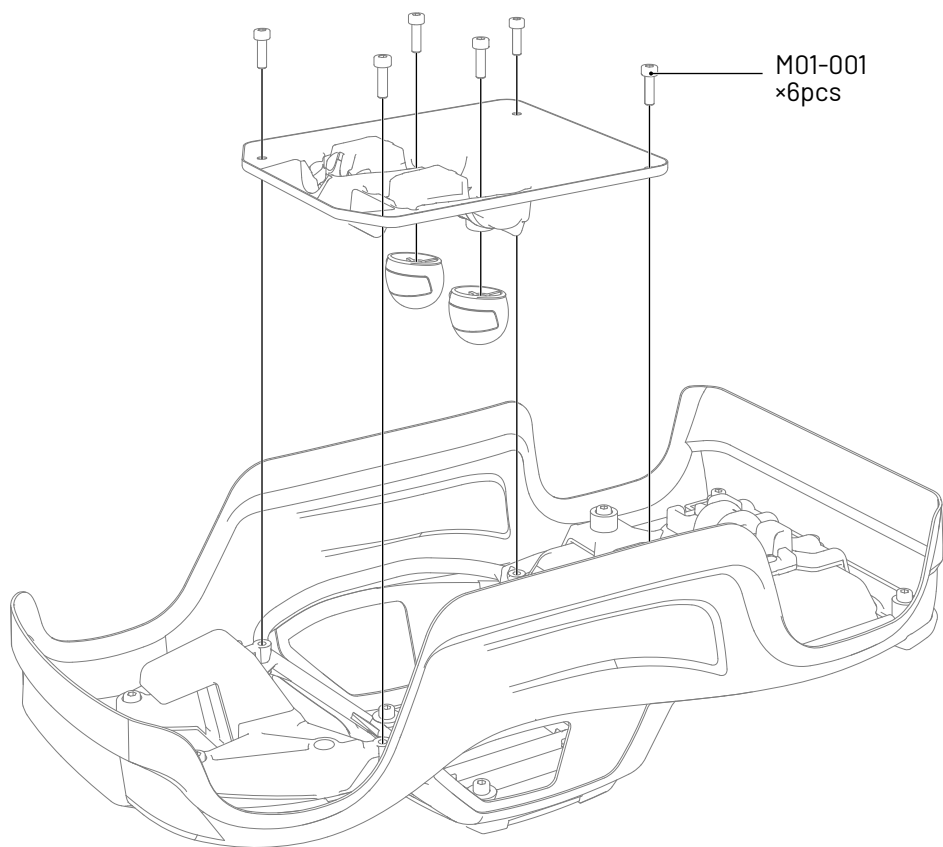



## VIEW-2 FRONT ASSEMBLY (The left and right installation is the same)

### 视图-2 前轮组装 (左右安装方法一样)

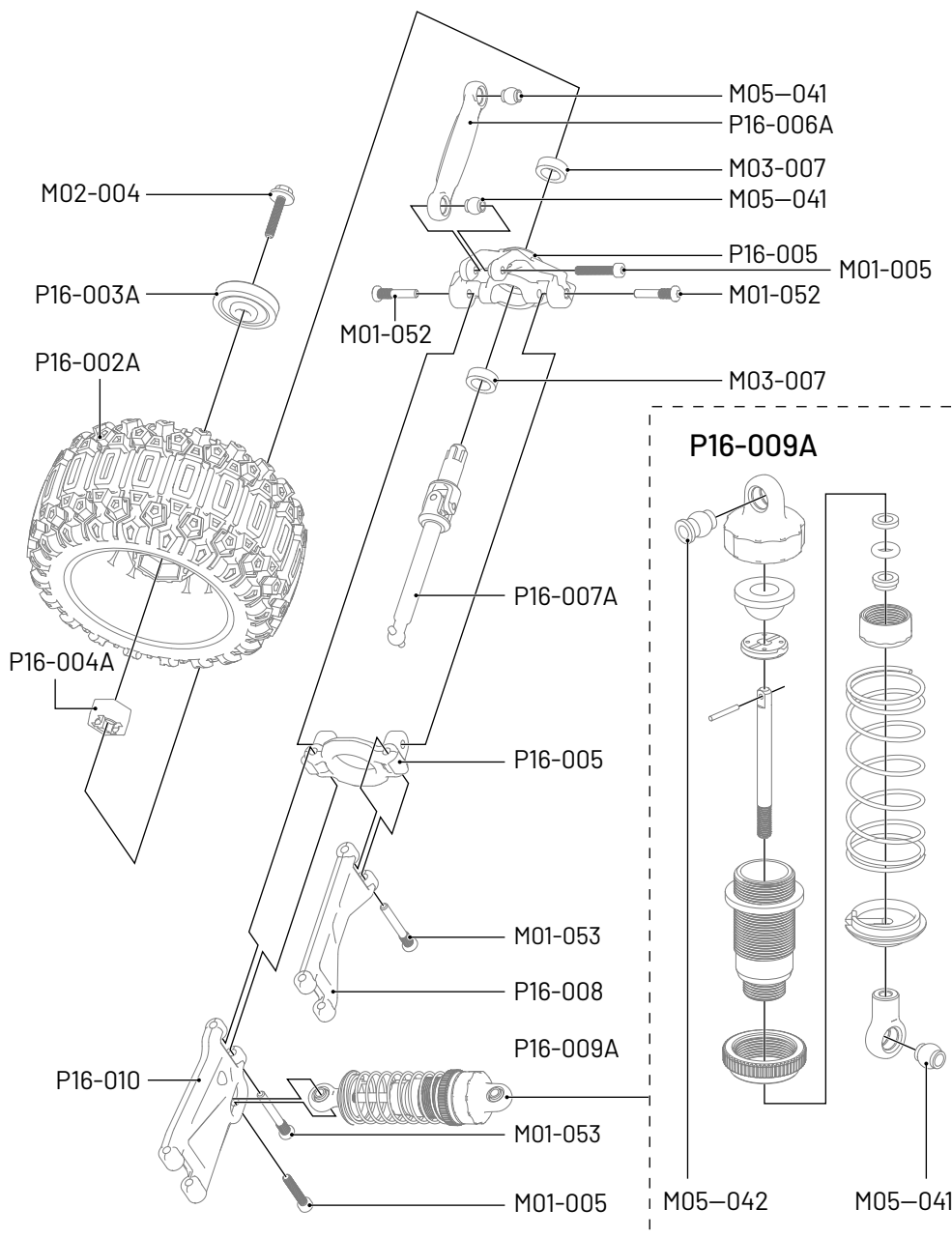



## VIEW-3 REAR ASSEMBLY (The left and right installation is the same)

### 视图-3 后轮组装 (左右安装方法一样)

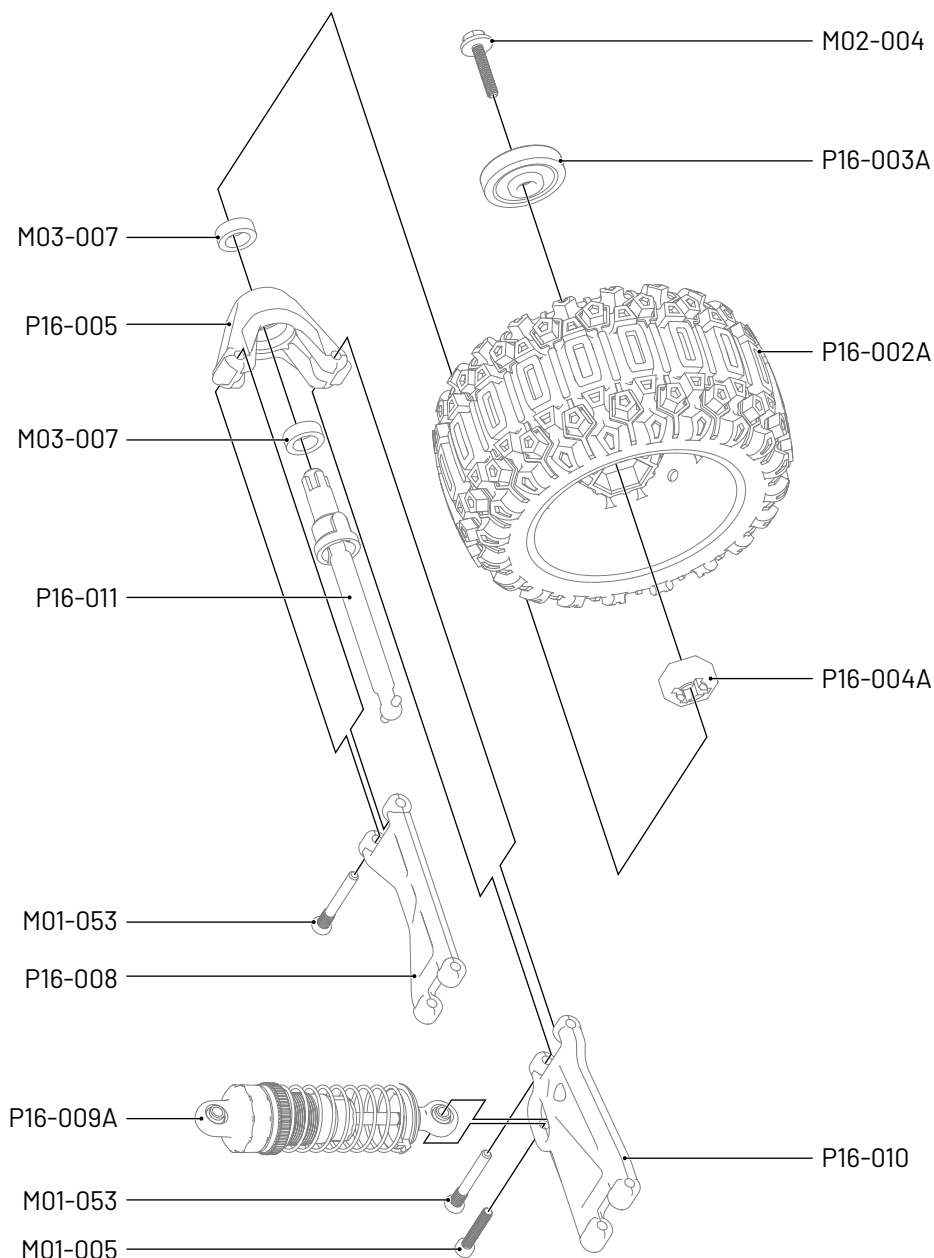



## VIEW-4 CHASSIS ASSEMBLY

### 视图-4 底盘组装

P16-020A

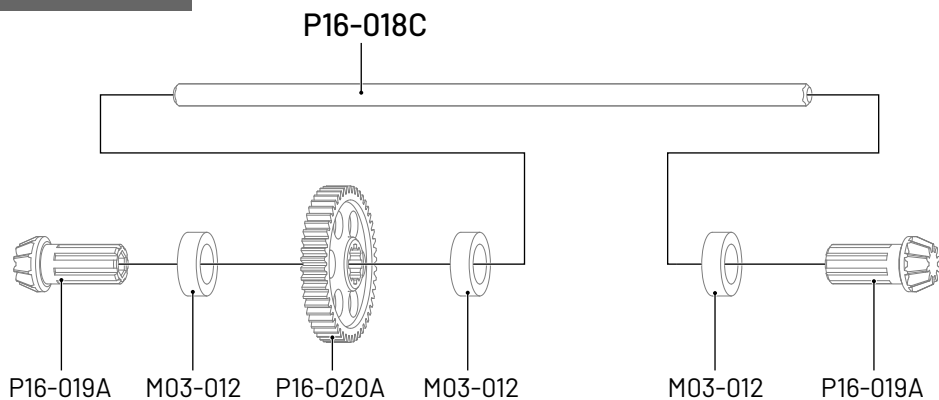

SCR1

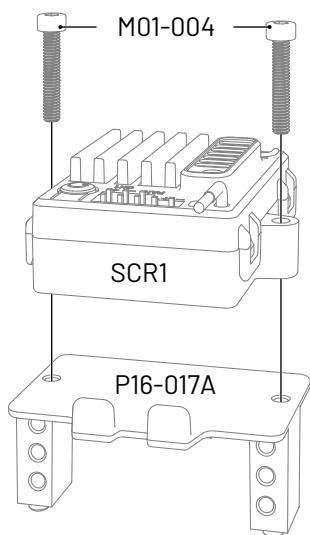

M390

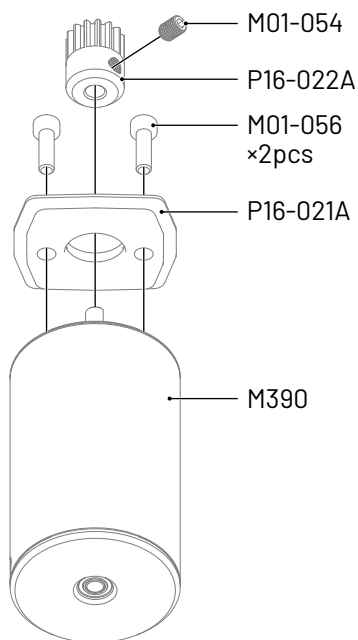

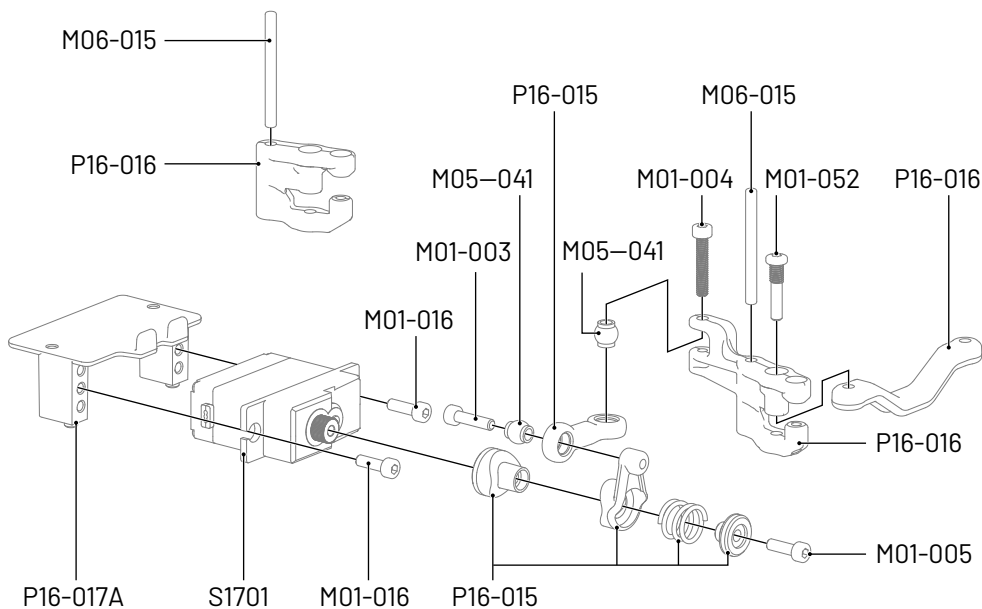

## P16-023A

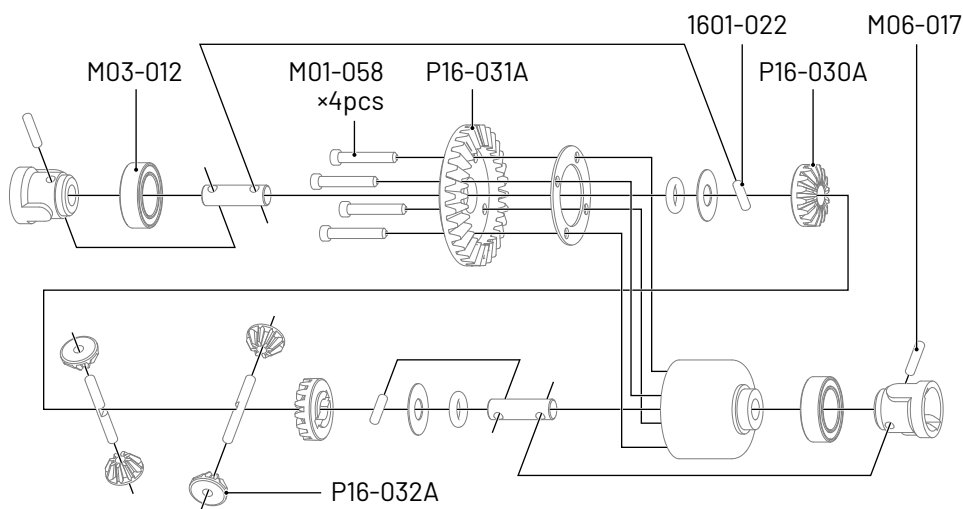

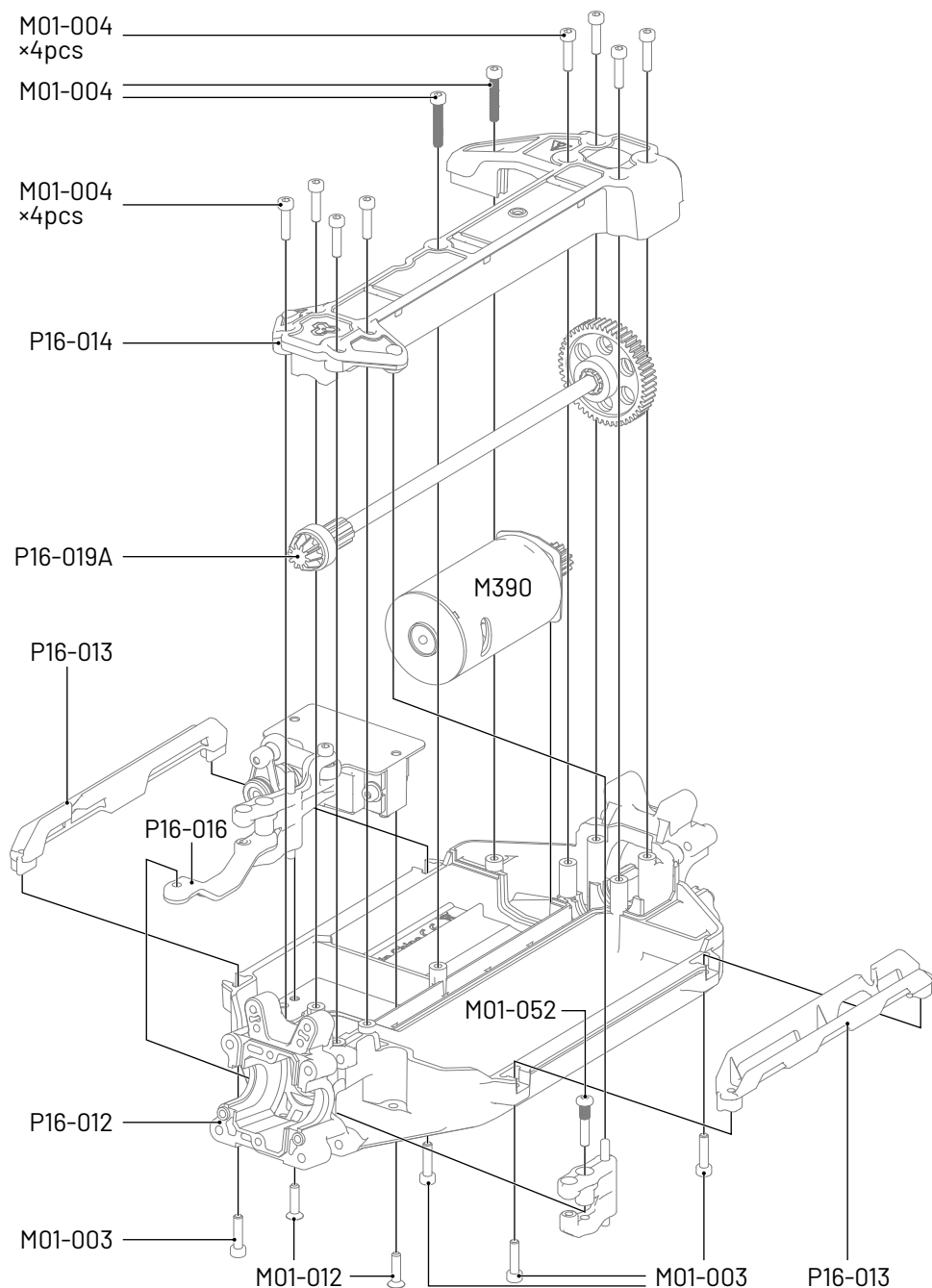





## VIEW-5 FRONT BUMPER ASSEMBLY (The left and right installation is the same)

视图-5 前保险杠组装 (左右安装方法一样)

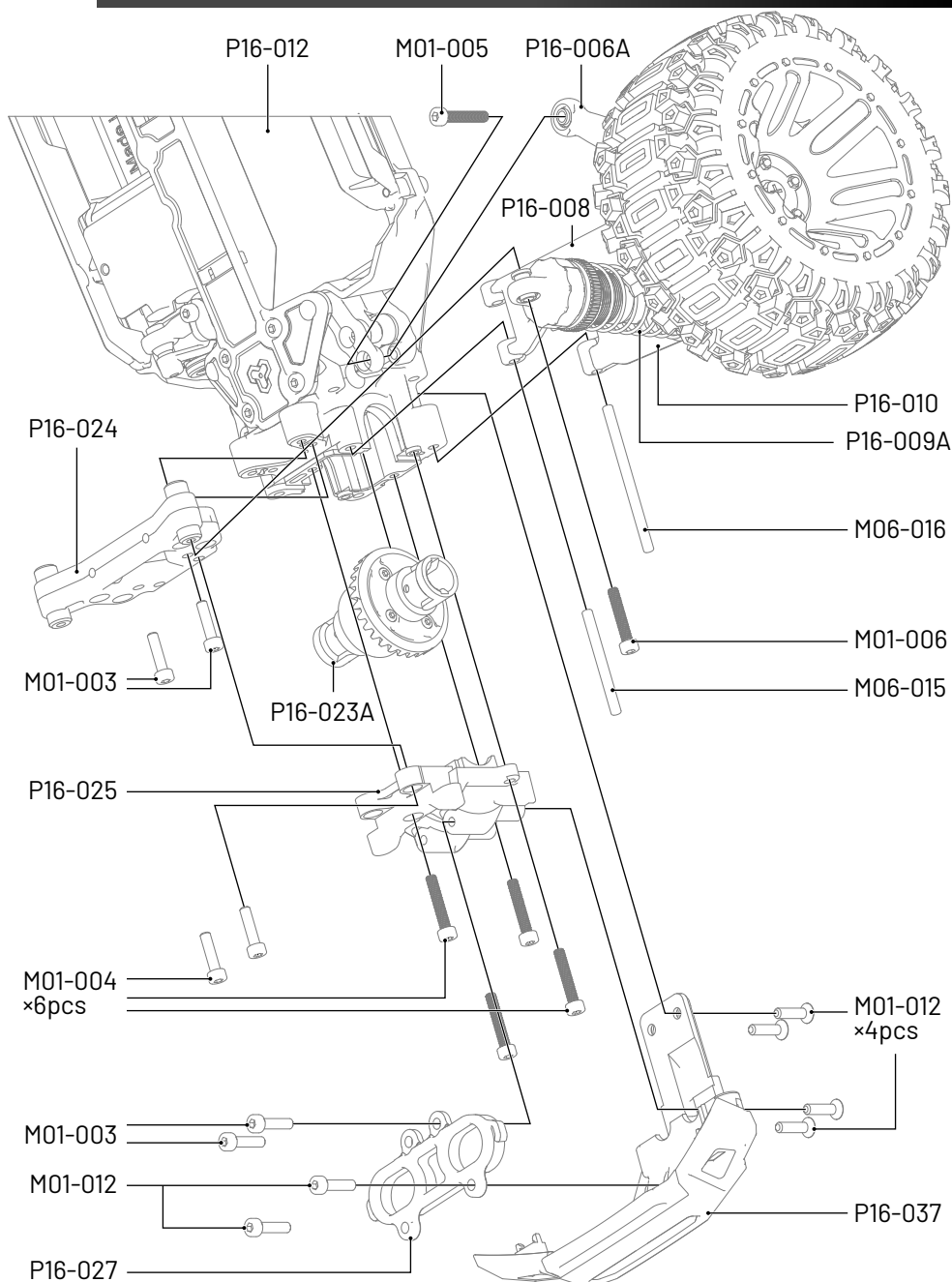



## VIEW-6 REAR BUMPER ASSEMBLY (The left and right installation is the same)

### 视图-6 后保险杠组装 (左右安装方法一样)

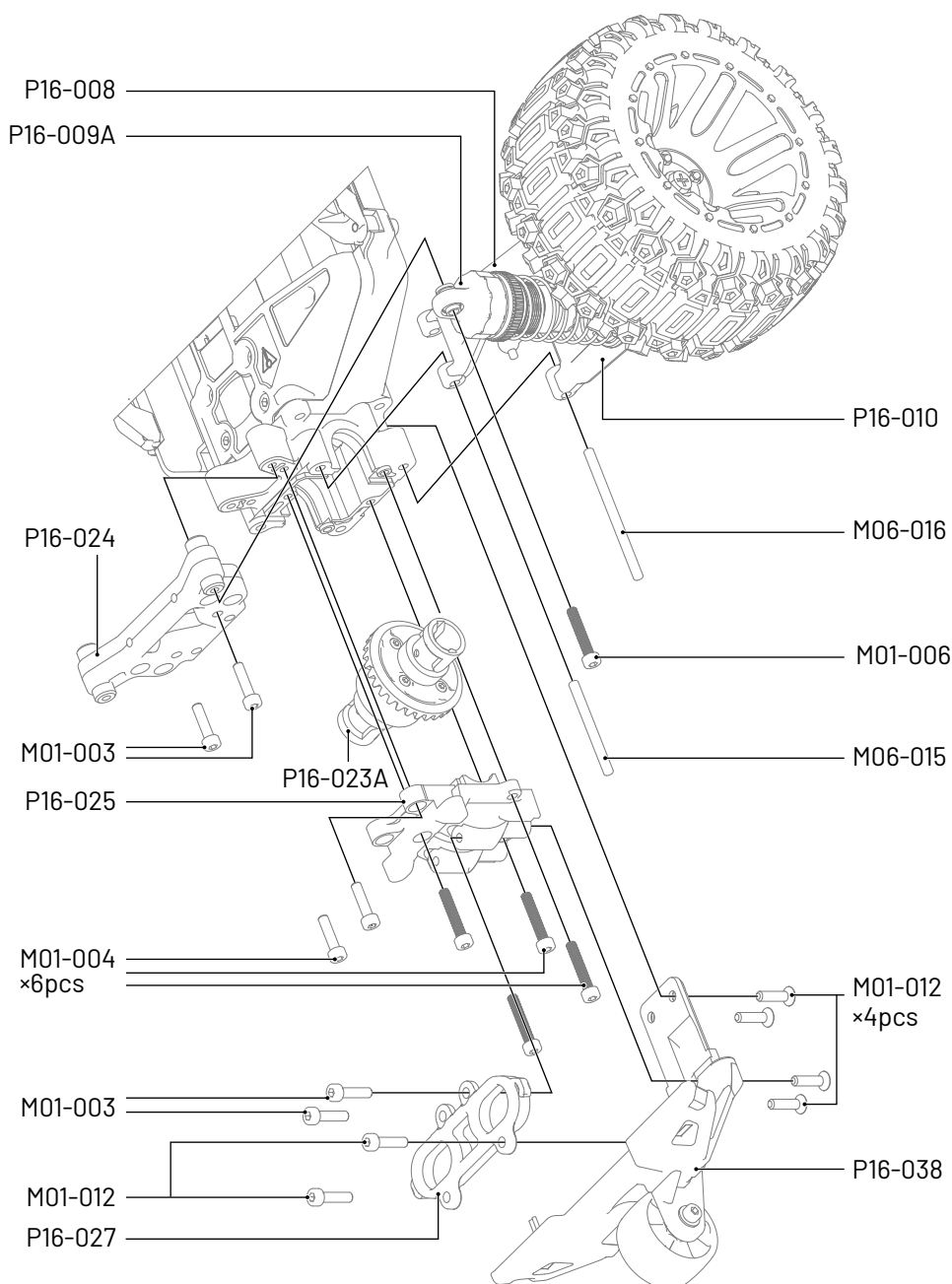

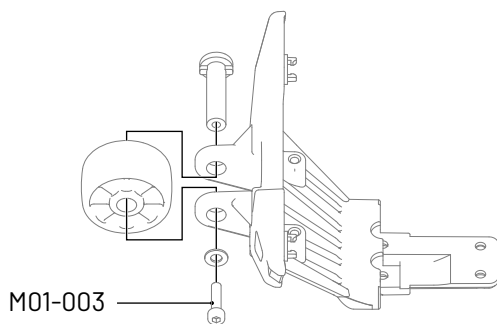

VIEW-7 TOP VIEW

视图-7 顶视

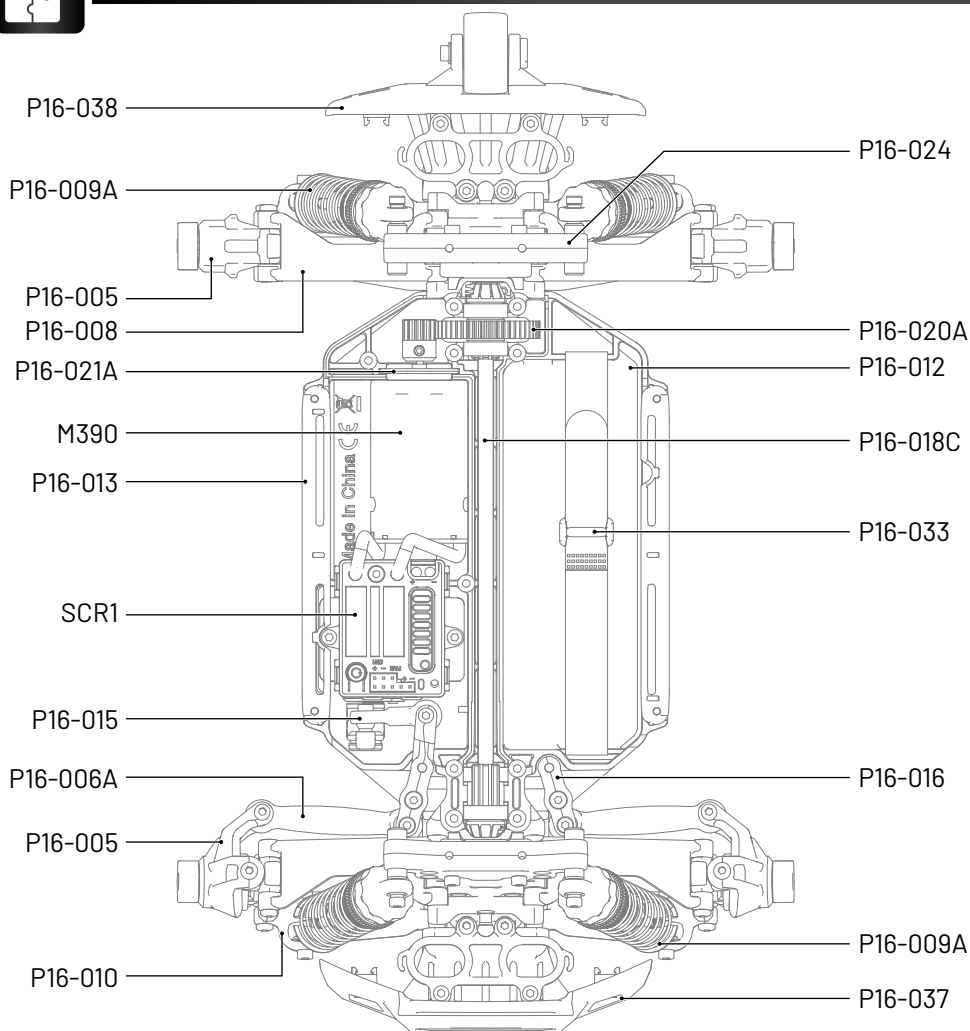



## 视图-8 灯组安装

① LED light bead

② Bumper

③ Lamp hole

④ DuPont

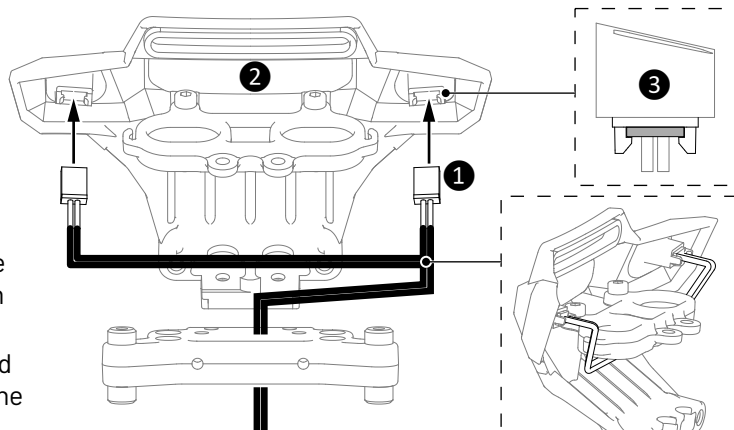

(1) Insert ① (the LED light bead) into ③ (the lamp hole) position on ② (the bumper), ensuring that the bead is completely inside the limit buckle.

(2) Connect ④ (2P DuPont plug) to SCR (Refer to the relevant manual).

① LED灯珠

② 保险杠

③ 灯孔

④ 杜邦插

(1) 将 ① LED灯珠插入 ② 保险杠上的 ③ 灯孔位置，确保灯珠完全在限位扣内。

(2) 将 ④ 2P杜邦插连接 SCR（参考相关说明书）。

