

TOURING CAR

REPLACEMENT PARTS

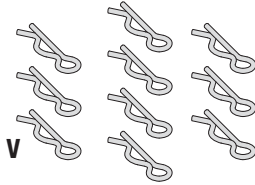

BODY CLIP



DIDC1000

3MM NYLON INSERT LOCK NUT

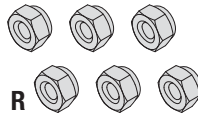

DIDC1001

DIFF BEVEL GEAR SET

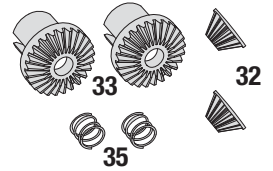

DIDC1002

DIFF RING & PINION GEAR SET

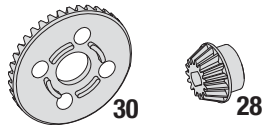

DIDC1003

DIFFERENTIAL CASE

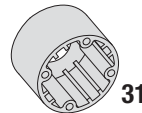

DIDC1004

45T SPUR GEAR

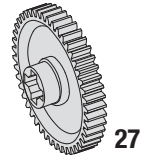

DIDC1005

GEARBOX SET

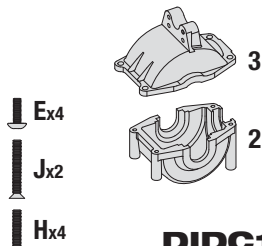

DIDC1006

CENTER DRIVE SHAFT

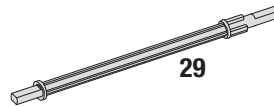

DIDC1007

AXLE SET

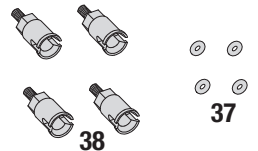

DIDC1008

STEERING BELLCRANK SET

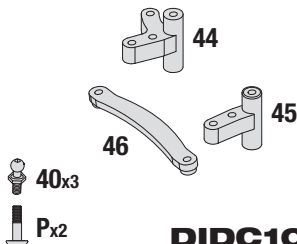

DIDC1010

FRONT HUB CARRIER SET

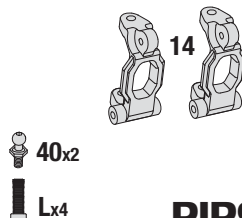

DIDC1012

STEERING KNUCKLE SET

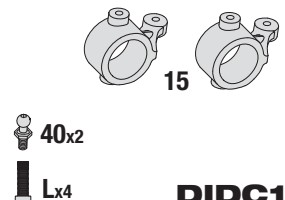

DIDC1013

REAR HUB SET

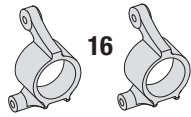

40x2

DIDC1014

UPPER CHASSIS BRACE

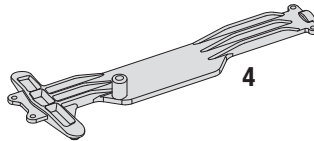

Ex6

DIDC1021

HINGE PIN HOLDER SET

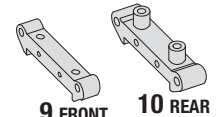

Jx2

Hx2

DIDC1024

BATTERY HOLD-DOWN

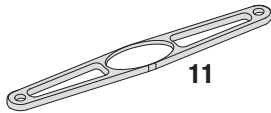

Vx2

DIDC1026

SPUR GEAR COVER

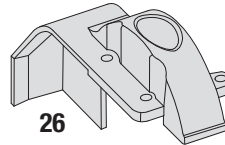

Ex4

DIDC1027

CHASSIS

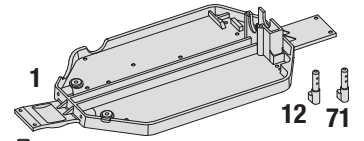

Gx2

Vx2

DIDC1028

UPPER SHOCK MOUNT SET

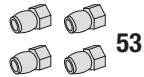

Mx4

Sx4

DIDC1029

MOTOR MOUNT

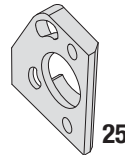

Kx2

DIDC1031

12T PINION GEAR

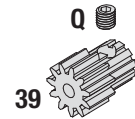

DIDC1032

6-CELL 1300MAH BATTERY

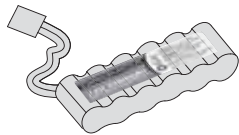

DIDC1033

BALL STUD SET

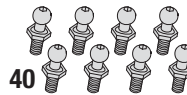

DIDC1034

2x36.5MM HINGE PIN SET

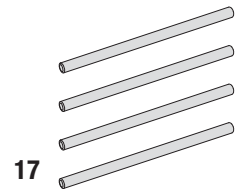

DIDC1035

2x16.5MM DIFF PIN SET



DIDC1037

ASSEMBLED DIFFERENTIAL

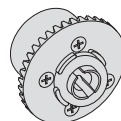

DIDC1061

DRIVE SHAFT SPACER SET

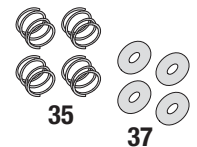

DIDC1062

BATTERY POST SET

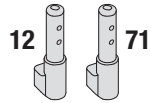

DIDC1063

ANTENNA TUBE & CAP

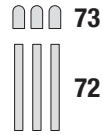

DIDC1064

6x10MM BALL BEARING

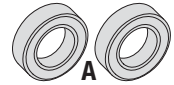

DIDC1070

8x12MM BALL BEARING

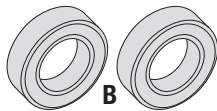

DIDC1071

TORQUE 370 MOTOR

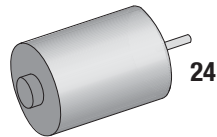

DIDC1193

SERVO SAVER SET

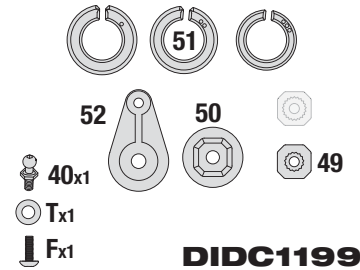

DIDC1199

LINKAGE SET

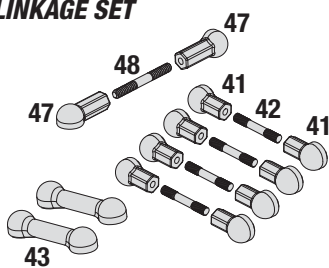

DIDC1250

DOGBONE SET

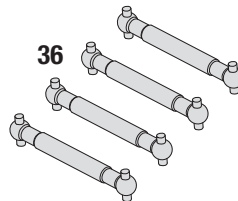

DIDC1251

ASSEMBLED SHOCK SET

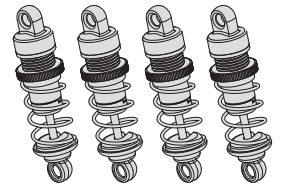

DIDC1252

SUSPENSION ARM SET

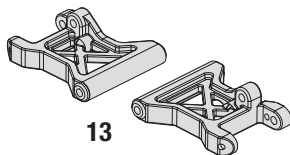

DIDC1254

FRONT SHOCK TOWER

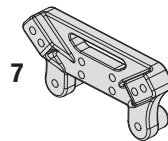

DIDC1255

REAR SHOCK TOWER

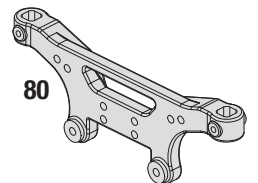

DIDC1256

FRONT BUMPER SET

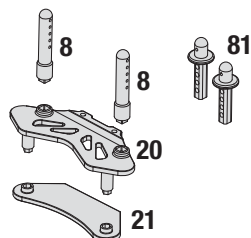

DIDC1257

2x19MM HINGE PIN SET

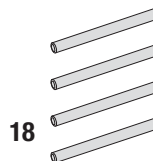

DIDC1258

2x3MM MACHINE SCREW

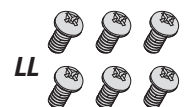

DIDC1259

FOAM FRONT BUMPER

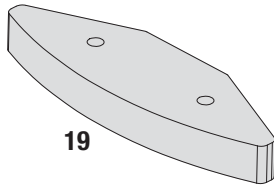

DIDC1261

ASSEMBLED WHEEL/TIRE/FOAM

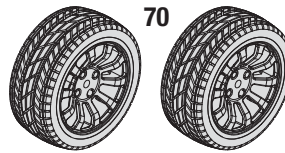

DIDC1262

BODY (RED)

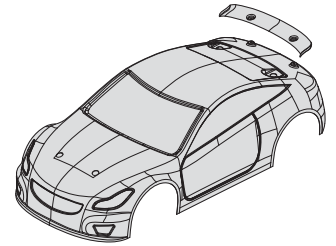

DIDC1263

SHOCK SPRINGS RALLY/TOURING

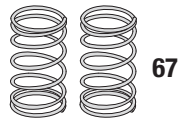

DIDC1267

SHOCK SHAFT SET

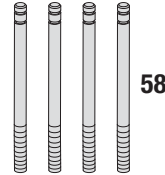

DIDC1270

TRANSMITTER

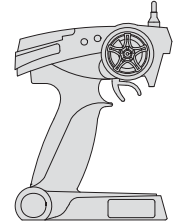

DIDJ1001

RE-183 RECEIVER/ESC UNIT

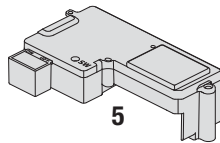

DIDM1004

D-S101 SERVO

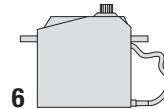

DIDM1005

6-CELL NIMH AC CHARGER

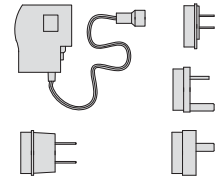

DIDP1003

HARDWARE SET

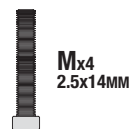
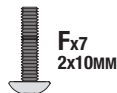
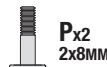
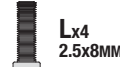

DIDC1057

OPTIONAL PARTS

Body Clips/Pulls (⇒ V)	DIDC1094	Hinge Pin Mnt Fr Alum Blue (⇒ 9)	DIDC1111	Wheel Adapter to 12mm Hex (4).....	DIDC1144
Graphite Battery Strap (⇒ 11).....	DIDC1100	Hinge Pin Mnt Rr Alum Blue (⇒ 10) ..	DIDC1112	Speed Kit Brushed.....	DIDC1151
Hub Carrier Alum Blue (2) (⇒ 14).....	DIDC1101	Motor Heatsink Aluminum Blue.....	DIDC1113	Universal Servo Mount.....	DIDC1202
Axle Set Alum Blue (4) (⇒ 38)	DIDC1102	Pinion 10T .6 Modular	DIDC1114	Wheel/Tire Assembly (2) (⇒ 70).....	DIDC1253
Chassis Brace Alum Blue (⇒ 4)	DIDC1103	Pinion 13T .6 Modular	DIDC1115	Body Set Touring Blue	DIDC1265
Knuckles Alum Blue (⇒ 15).....	DIDC1104	Shock Spring Short Black Firm	DIDC1116	Rx Brushless 3-Channel.....	DIDL1000
Spur Gear 45T Alum Blue (⇒ 27)	DIDC1105	Brushless Motor 5300kV	DIDC1128	Brushless ESC 25A.....	DIDM1002
Rear Hub Alum Blue (2) (⇒ 16).....	DIDC1106	Bttm Head Hex Screw 2.5x6mm (6) ..	DIDC1132		
Center Drive Shft Alum Blue (⇒ 29) ..	DIDC1107	Speed Secret Motor 22T Brushed	DIDC1133		

This parts list shows the key number, part description, and stock number for the replacement parts sets. When more than one stock number is listed, that part is available in multiple replacement parts sets.

#	Item Description	Available in Stock #	#	Item Description	Available in Stock #
1	Chassis	DIDC1028	63	Shock O-Ring Spacer.....	DIDC1252
2	Lower Gearbox Half	DIDC1006	65	Lower Shock Spring Retainer	DIDC1252
3	Upper Gearbox Half.....	DIDC1006	66	Shock End.....	DIDC1252
4	Upper Chassis Brace.....	DIDC1021	67	Shock Spring (Rally/Touring)	DIDC1267
5	RE-183 Receiver/ESC Unit	DIDM1004			DIDC1252
6	Servo w/Servo Saver	DIDM1005	69	Shock Pre-Load Adjuster	DIDC1252
7	Shock Tower Front.....	DIDC1255	70	Wheel/Tire/Foam Insert Assembled	DIDC1262
9	Front Hinge Pin Holder	DIDC1024	71	Rear Battery Post.....	DIDC1028, DIDC1063
10	Rear Hinge Pin Holder	DIDC1024	72	Antenna Tube	DIDC1064
11	Battery Hold Down.....	DIDC1026	73	Antenna Cap	DIDC1064
12	Front Battery Post.....	DIDC1028, DIDC1063	80	Shock Tower Rear	DIDC1256
13	Suspension Arm.....	DIDC1254			
14	Front Hub Carrier	DIDC1012			
15	Steering Knuckle	DIDC1013			
16	Rear Hub	DIDC1014			
17	2x36.5mm Pin (Inner Hinge).....	DIDC1035			
18	2x19mm Pin (Outer Hinge, Steering)	DIDC1258			
19	Bumper	DIDC1257			
24	Torque 370 Motor.....	DIDC1193			
25	Motor Mount	DIDC1031			
26	Spur Gear Cover.....	DIDC1027			
27	45 Tooth Spur Gear	DIDC1005			
28	15 Tooth Differential/Pinion Gear	DIDC1003			
29	Center Drive Shaft	DIDC1007			
30	38T Differential Ring Gear	DIDC1003, DIDC1061			
31	Differential Case	DIDC1004, DIDC1061			
32	Diff Bevel Gear (Small).....	DIDC1002, DIDC1061			
33	Diff Bevel Gear (Large).....	DIDC1002, DIDC1061			
34	2x16.5mm Pin (Diff Gear Pin).....	DIDC1037			
		DIDC1061			
35	Dogbone Spring	DIDC1002, DIDC1062			
36	Dogbone.....	DIDC1251			
37	2x5mm O-Ring.....	DIDC1008, DIDC1062			
38	Axle.....	DIDC1008			
39	12T Pinion Gear (.6 Mod, 2mm Shaft).....	DIDC1032			
40	Ball Stud	DIDC1034			
41	Ball Cup (Long)	DIDC1250			
42	Camber Rod	DIDC1250			
43	Tie Rod	DIDC1250			
44	Steering Bell Crank (Right)	DIDC1010			
45	Steering Ball Crank (Left).....	DIDC1010			
46	Steering Drag Link.....	DIDC1010			
47	Ball Cup (Short).....	DIDC1250			
48	Steering Rod.....	DIDC1250			
49	Servo Saver Spline	DIDC1199			
50	Servo Saver Base	DIDC1199			
51	Servo Saver Spring.....	DIDC1199			
52	Servo Saver Arm	DIDC1199			
53	Upper Shock Mount	DIDC1029			
55	Shock Body.....	DIDC1252			
56	Shock Cap.....	DIDC1252			
58	Shock Shaft	DIDC1270, DIDC1252			
59	Shock Seal Retainer	DIDC1252			
60	Shock Diaphragm	DIDC1252			
61	Shock Piston.....	DIDC1252			
62	Shock O-Ring.....	DIDC1252			

HARDWARE

A	6x10mm Ball Bearing	DIDC1070
B	8x12mm Ball Bearing	DIDC1071
E	2x8mm Round head Screw.....	DIDC1057
F	2x10mm Round Head Screw	DIDC1057
G	2x8mm Flat Head Screw	DIDC1057
H	2x10mm Flat Head Screw	DIDC1057
J	2x14mm Flat Head Screw	DIDC1057
K	2.5x8mm Flat Head Screw	DIDC1057
L	2.5x8mm Socket Head Cap Screw	DIDC1057
M	2.5x14mm Socket Head Cap Screw	DIDC1057
N	3x6mm Socket Head Cap Screw	DIDC1057
P	2x8mm Round Head Shoulder Screw	DIDC1057
Q	3x3mm Set Screw	DIDC1057
R	3mm Nylon-Insert Lock Nut.....	DIDC1001,
		DIDC1057
S	2.6x5mm Washer	DIDC1057
T	3x6mm Washer	DIDC1057
U	1.5mm E-Clip	DIDC1057
V	Body Clip (Small).....	DIDC1000, DIDC1057
X	2x6mm S/T Round Head Screw	DIDC1057
LL	2x3mm Round Head Screw	DIDC1259

TOURING CAR™

