

Carisma[®]
ScaleAdventure

SCA-1E ★ **COYOTE**

USER MANUAL & SETUP GUIDE

用户手册和设置指南

MANUALE D'USO E DI MONTAGGIO

Bedienungs - und Bauanleitung

Manuel de l'utilisateur et guide de réglages



Trail Start



Welcome to the world of Carisma SCA-1E Adventure. This is just the starting point on a journey that for many will undoubtedly last a lifetime. Where it eventually leads you to is your own choice. The first step was simply opening the box, the next will be entirely up to you.

Find that perfect location, drive from point A to point B, soaking in the scenery along the way and truly becoming one with your environment. The World is so diverse, it's terrain varied and challenging, but the SCA-1E offers the perfect Travelling Companion to embracing it all, head on...

The rig offers tried and trusted Off Road features like a Solid Axle, 4WD Driveline, a centrally located Transmission and Motor, True 4-Link Suspension, Adjustable Coil Over, Oil Filled Shocks, and Soft Compound, Thickly Treaded Scale Tyres. The electrics Splash proof, the Steering Servo High Torque and 2.4GHz Radio System, safe and Interference Free.

The bodyshell can be left completely stock or personalised to your own level of additional detail. You can alter the weight bias and how the rig physically drives by adjusting the main packs location, or adding Wheel Weights. Improve its extreme abilities by adding a Remote Winch to the front bumper and to aid Night Running, optional LED lights. The Electronic Speed Control is set into Crawler Mode as standard, offering instant reverse and an always on Drag Brakes. This improves the rigs ability to descend steep inclines under compete Electronic Descent Control.

Look at the SCA-1E as a blank sheet of paper. You decide its future feature set and abilities, and in turn it will help shape your own personal destiny. Thank you for becoming another member of the fast-growing Global Scale Community, and Carisma RC Family. We hope that you enjoy every aspect of the journey.

Life is short, so truly live it, one #CarismaScaleAdventure at a time!



SAFETY PRECAUTIONS

Thank you for your purchase of the Carisma SCA-1E Rig. With proper use and regular, basic maintenance, this rig will provide you and all those who drive it hours of reliable RC fun! Please read this manual to fully understand its features, capabilities, and the best operation of the product. Should you have a technical question or need replacement parts, please contact your local Carisma RC dealer, original place of purchase or our dedicated web Shop: <http://www.carisma-shop.com>. You may also contact us direct via e-mail at: webmaster@carisma-shop.com

WARNING

Read the ENTIRE instruction manual to become familiar with the features of this product before operating. This is a sophisticated hobby grade product. It must be operated with caution and common sense. It will require some basic mechanical ability. Failure to operate this product in a safe and responsible manner could result in injury or damage to the product, persons, or other property. This product is not intended for use by children without direct adult supervision. Do not use with incompatible components or alter this product in any way outside of the instructions provided by Carisma RC. This manual contains instructions for safe operation and maintenance. It is essential to read and follow all the instructions and warnings in the manual, prior to assembly, setup, or use. If you are not prepared to accept these condition, please return this product immediately to place of purchase.

CAUTION:

This product is intended for ages 14+ Users under 18 years of age require parental supervision. Do not expose any battery or component to open flame or other source of high temperature. You must read the enclosed instruction manual completely prior to using this product. Do not use any charger except the one included to charge the battery. Never leave a battery unattended during charging. Do not expose any components to moisture. Always avoid water exposure to all equipment that's not specifically designed and protected for this purpose. As the end user of this product, you are solely responsible for operating in a manner that does not endanger yourself and others, or result in damage to the product, or property of others.

Always carefully follow the directions and warnings for this, and any optional equipment (chargers, etc.). This model is controlled by a radio signal subject to interference from many sources outside your control. Never place any portion of the vehicle in your mouth as it could cause serious injury or even death. Always operate your vehicle in open space away from full-size vehicles, traffic, people, and animals. Always keep a safe distance in all directions around your model to avoid collisions or injury. Always keep all chemicals, small parts, and anything electrical out of the reach of children. Always keep transmitter powered on while your vehicle is power on. Always remove batteries after use or before disassembly. Never operate your vehicle with low transmitter batteries. Always keep your vehicle in sight and under control. Never operate your vehicle with damaged wiring. Always let parts cool after use before touching. Always keep moving parts clean and dry. Always use fully charged batteries.



WHAT'S IN THE BOX



SCA-1E Rig



Transmitter

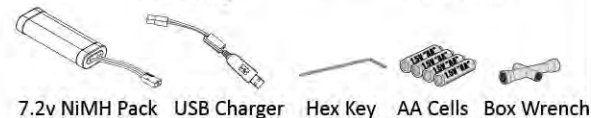

7.2v NiMH Pack USB Charger Hex Key AA Cells Box Wrench

TOOLS RECOMMENED (NOT INCLUDED)

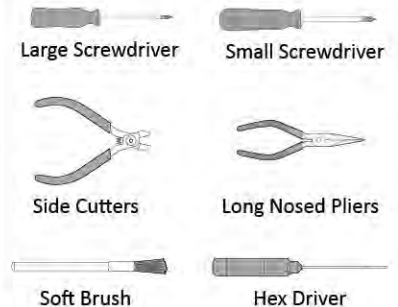

Large Screwdriver Small Screwdriver Side Cutters Long Nosed Pliers Soft Brush Hex Driver

ABOUT THE RADIO SYSTEM

CTX-8000 2.4GHZ FHSS TECHNOLOGY SYSTEM

The following is an overview of the various functions and adjustments found on CTX-8000 radio system. It is important to read and understand these functions and adjustments before driving your Crawler.

TRANSMITTER FUNCTIONS:

Steering Wheel: Controls the turning direction of the Crawler (left/right).

Throttle Trigger: Controls the speed and direction of movement (forward/brake/reverse) of the Crawler.

On/Off Switch: Powers the transmitter on and off.

FTN Key: Used to synchronize the connection between the transmitter and receiver. May also serve as an additional function on different models.

LED Indicator: Glows green or red to indicate low battery power, synchronizing in progress, setting endpoints, and normal operation.

ATV: Adjust the maximum steering throw in both directions when turning the Crawler left of right.

ST. Trim: Adjusts the neutral (centered) position of the steering servo.

TH. Trim: Adjusts throttle neutral position.

Steering Reverse: Reverses the L/R direction when operating the steering wheel.

Throttle Reverse: Reverses the forward/reverse direction when operating throttle.

Usually, drivers will experience understeer when making a wide turn at high speed or oversteer when attempting sharp turns at high speed (easy to spin out). Drivers should practice a smooth application of both steering and throttle for various cornering speeds and road surfaces.

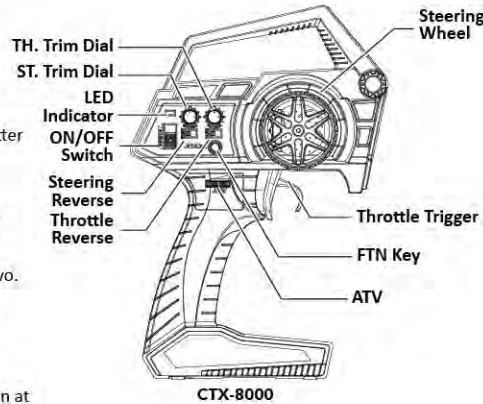

CTX-8000

BATTERY INSTALLATION

1. Remove the battery compartment cover as shown.
2. Install the batteries observing the correct polarity as marked on the battery compartment.
3. Reinstall the battery compartment cover as pictured.

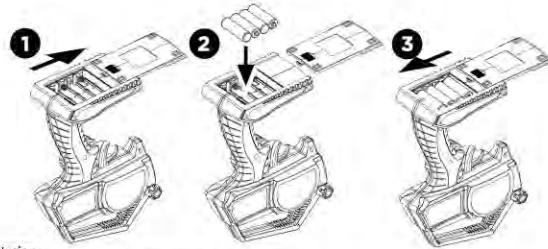

Warning:

Never disassemble alkaline batteries or place batteries in fire or near chemical agents, as personal injury or property damage can occur.

Battery Disposal:

Observe local environmental regulations regarding disposal of expired batteries.

1. After use, dispose old batteries in designated areas far away from any water supply, household areas and plants.
2. Submit the used batteries to specified battery recycling stations. Visit www.call2recycle.org for directions to battery recycling centers near you.

BATTERY LED INDICATOR

The Green LED indicator located on the front left side of the transmitter provides a visual status of battery condition. The green LED will illuminate solid, indicating that the batteries have sufficient power. When batteries voltage drops below 4 volts, LED will flash red, indicating the batteries are low and should be replaced.

Solid GREEN: Sufficient Power supply

Flashing RED: Time to replace batteries

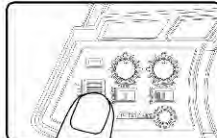

GREEN

ATV

ATV (adjustable travel volume) allows the driver to adjust the maximum steering angle in both directions.

Experiment to find the ideal setting for your vehicle based on the running surface and personal preference.

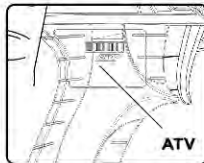

ATV

BEFORE DRIVING YOUR CRAWLER

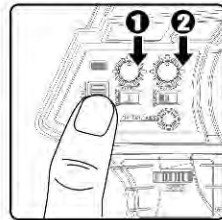

1. **Steering:** Adjust the steering trim so that the Crawler goes in a straight line without needing to touch the steering wheel.
2. **Throttle:** Adjust the throttle trim so that the vehicle remains at rest (not moving) when the throttle trigger is in the neutral position.

SERVO REVERSING

Use this feature to change the direction of steering wheel and throttle trigger.

Steering Reverse: Reverses the response direction when operating steering wheel. Right becomes left and vice versa.

Throttle Reverse: Reverses the response direction when operating throttle trigger. Pulling the throttle trigger becomes reverse and pushing the trigger is now forward.

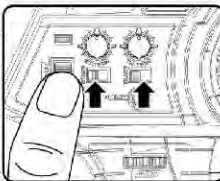

SCA-1E Electrics

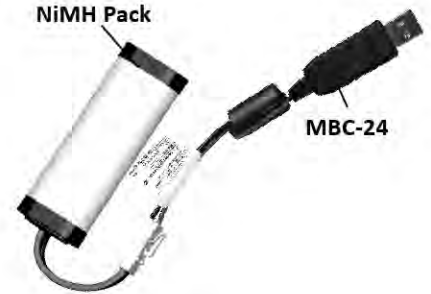
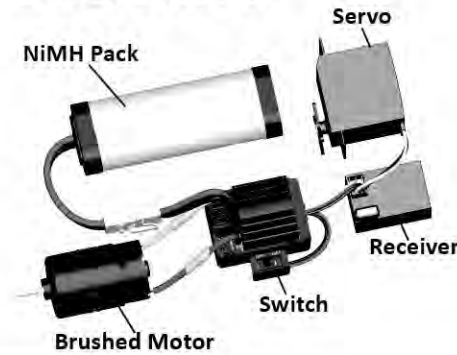

ESC/Transmitter Settings

The included RTR Tx and ESC will be set from the factory, but if you choose to change the radio please follow these instructions:

For LCD screen Tx's ensure that "D/R", "EPA" & "ALT" are set to 100%, and "TRIM" is set to 0 on Throttle Channel. For non-LCD screen Tx's, ensure that the throttle "TRIM" knob is set to neutral.

For Futaba and some OEM Tx's set the direction of the throttle channels reversing switch to "REV", while other radio systems should be set to "NOR"

Using the failsafe function of your chosen radio system is strongly advised to ensure the motor stops if signal is lost or Tx battery runs low.

Warning: An incorrect Input Voltage Polarity will damage the ESC immediately.

Throttle Calibration

In order to make the ESC match the throttle range of different transmitters, it needs to be calibrated. This is a simple three step procedure. First turn on the Tx. Then with the Tx's trigger in a neutral position the ESC. Wait for 3 seconds so the ESC can perform an Automatic Throttle Calibration. When this has finished and the ESC is ready to run, a long beep is emitted from the motor.

The Meaning of Beep Sound	LED Status
<ul style="list-style-type: none"> • 1 short Beep: The battery is NiMH/NiCd • 2 short Beeps: The battery is 2S LIPO • 3 short Beeps: The battery is 3S LIPO • 1 long Beep: Self-test and throttle calibration is OK, the ESC is ready to run 	<ul style="list-style-type: none"> • When the throttle stick is in neutral range, red LED is off • Forward, brake or reverse in partial throttle, red LED blinks • Forward, brake or reverse at full throttle, red LED is solid

Throttle Trigger Position:



WP-1040 Brushed Crawler ESC

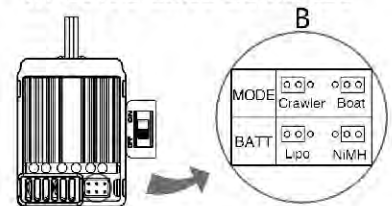

The ESC will come set as standard from the factory in "Crawler Mode" and for the "NiMH" battery type. It is programmed by the use of jumpers, so tweezers are recommended to plug and unplug each one to change parameters.

Remember to change to LIPO mode when using this type of pack, as the ESC has a built in Low Voltage detection circuit to safeguard the LIPO from over-discharging and possible permanent damage.



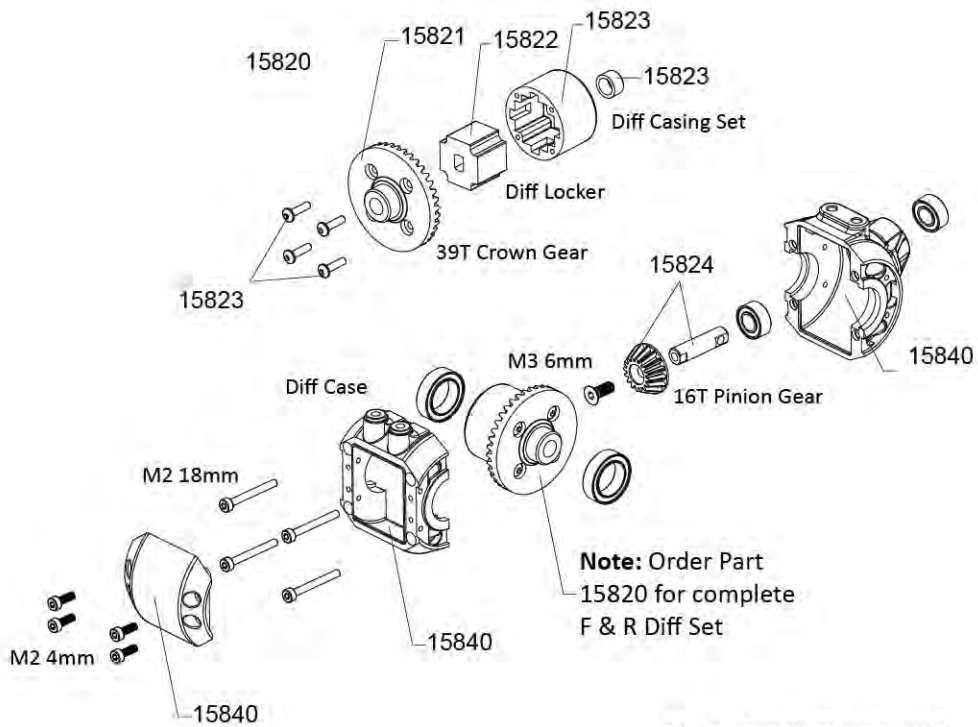

Note: Order Part 15820 for complete F & R Diff Set

Note: Regularly strip and re-lube axles and bearings if rig is used in damp or wet conditions

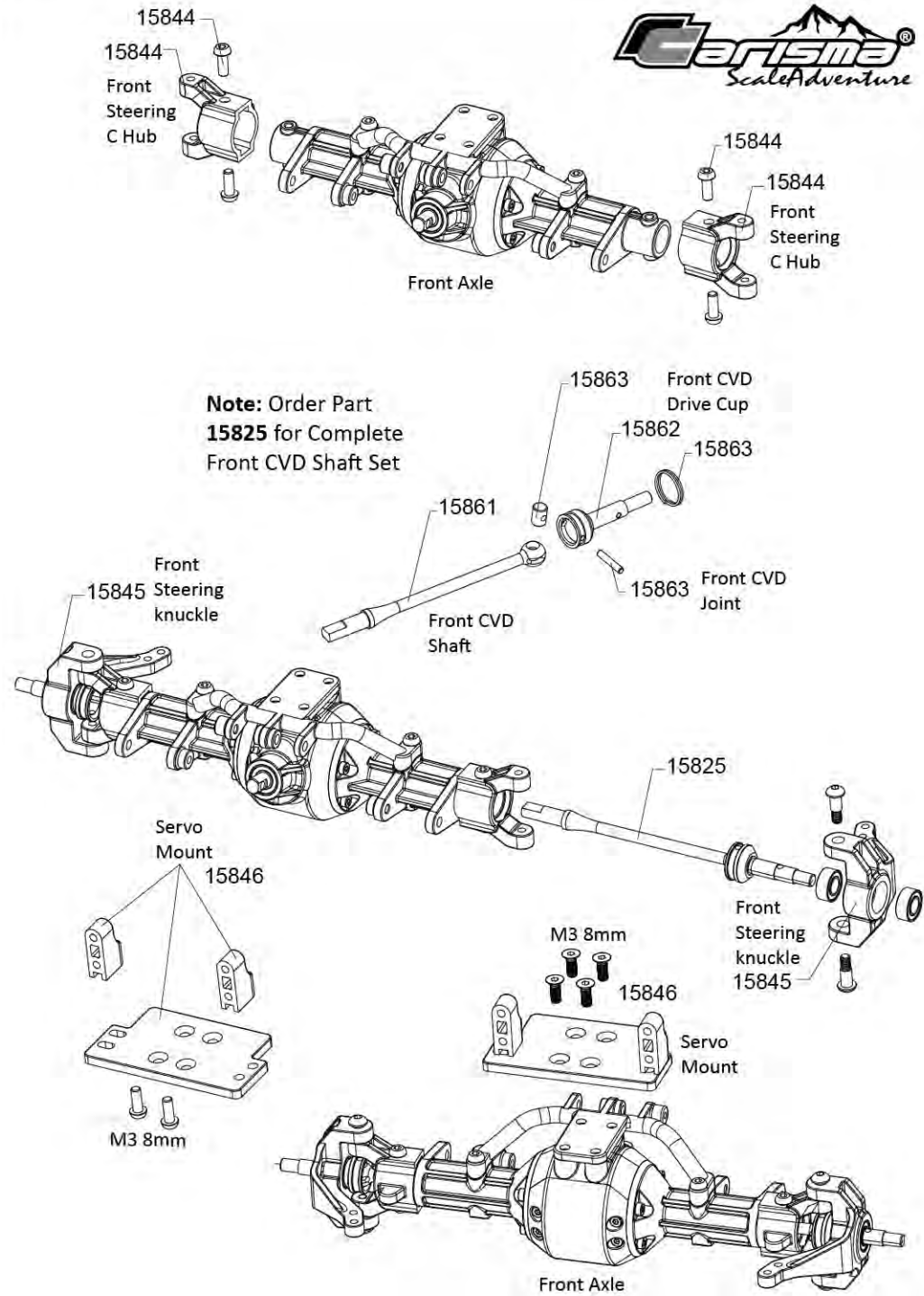
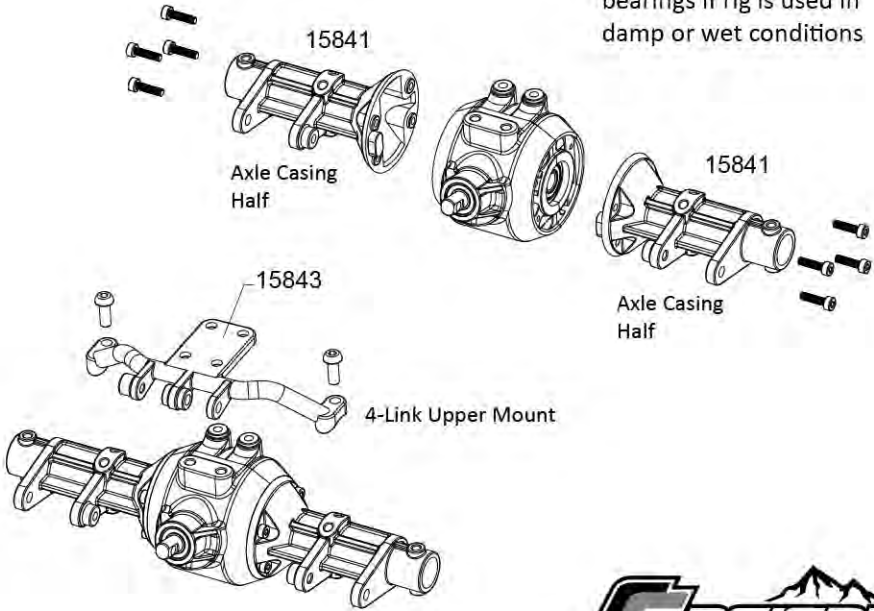

Note: Order Part 15825 for Complete Front CVD Shaft Set

Front Axle

Rear Axle In Stock RTR Format

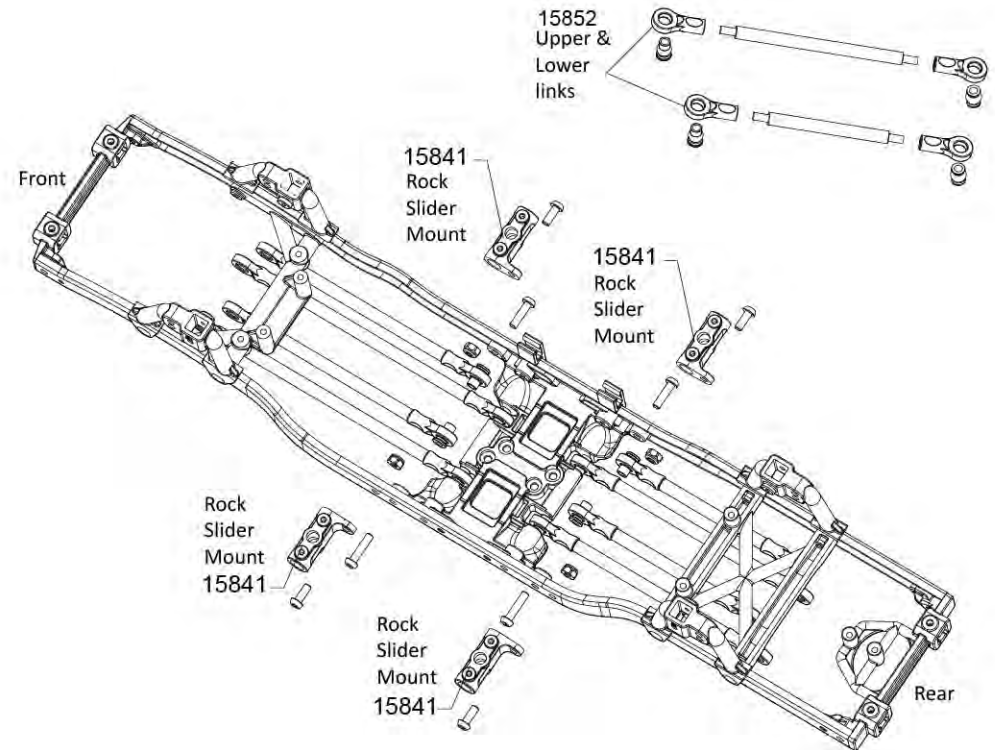
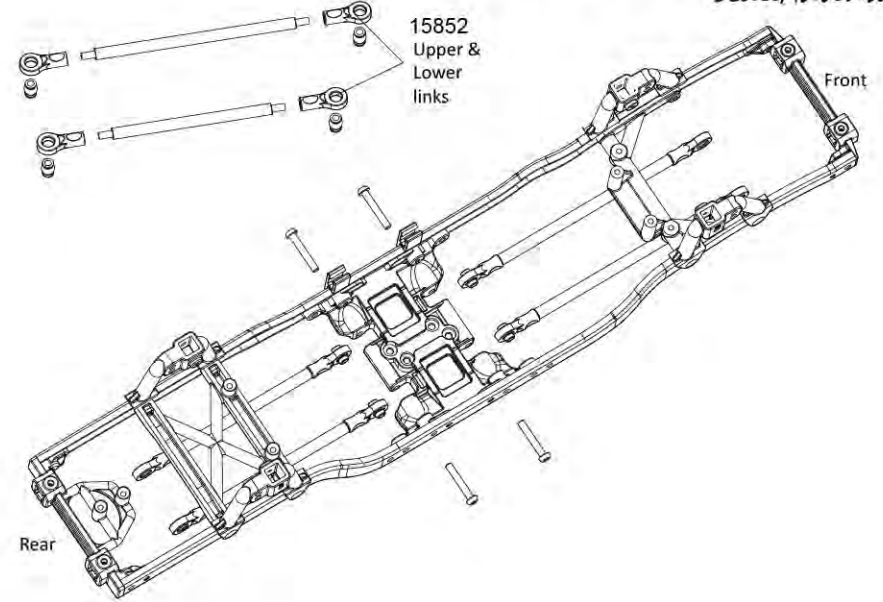
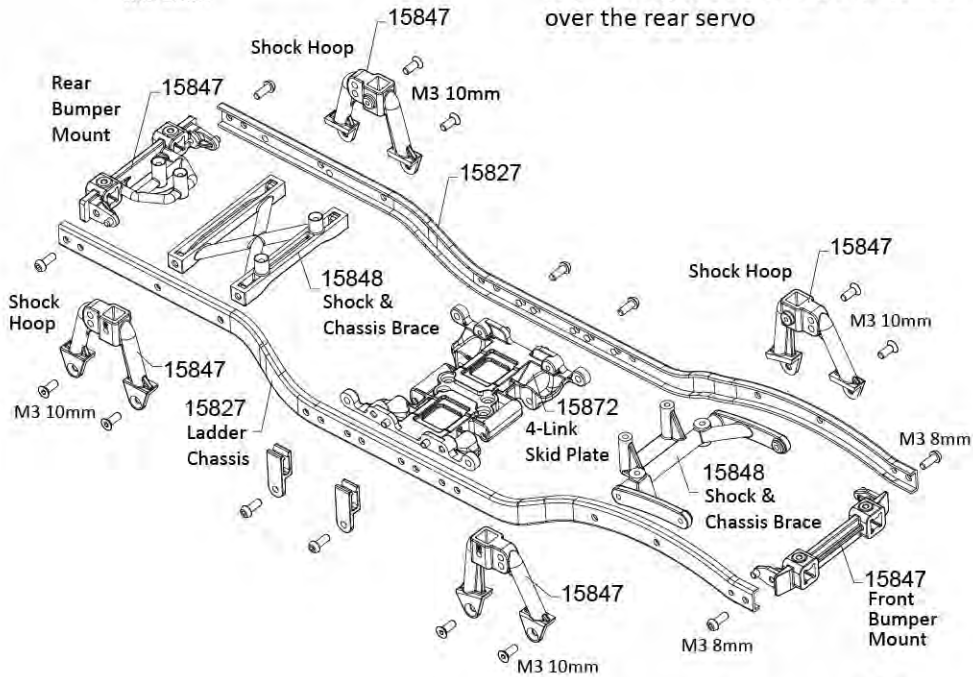
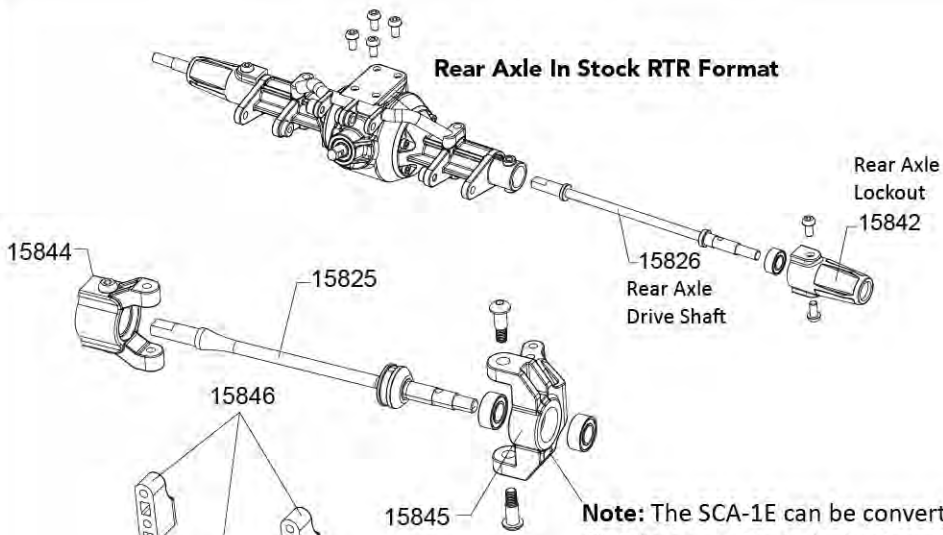

SCA-1E Shocks

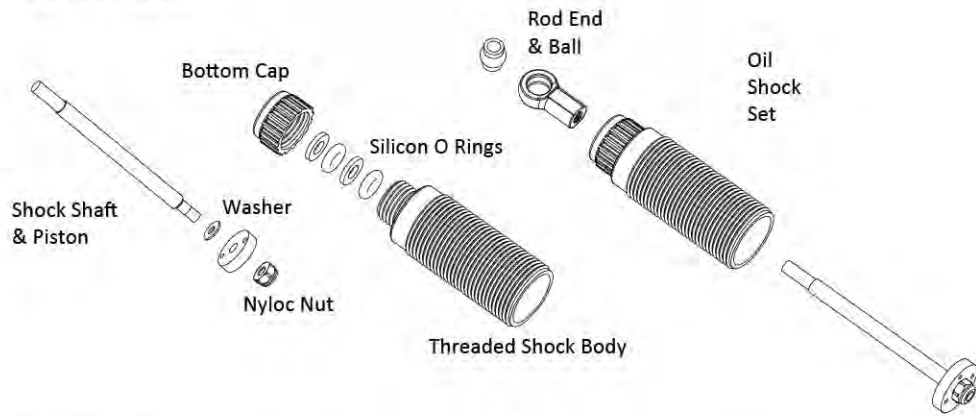

Note: Shock oil and spring choice affects the driving characteristics of your rig. The thicker the oil is, the slower the shock piston moves inside the shock body and the slower the rig can react to differences in your chosen running surface. Too thin and the rig can become unpredictable when crawling and suffer from excessive Torque Twist. This is a phenomenon where the torque of the driveline is transferred through the axles and shocks on one or more corners of the rig compress to compensate. All solid axle rigs suffer from this to some extent, but with the right oil, springs and pre-load applied to the shock/shocks that compress, this can be vastly improved.

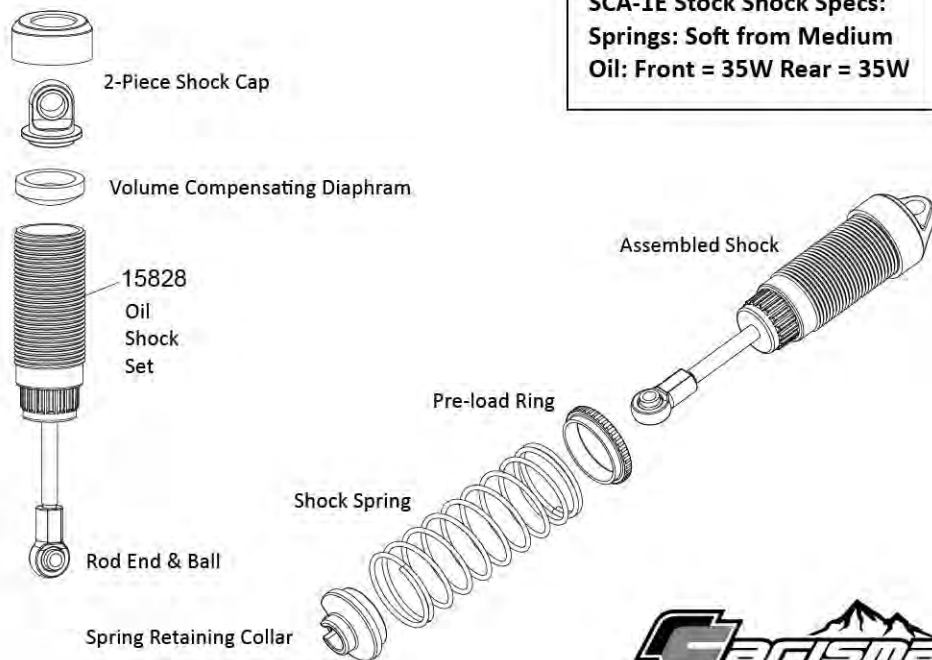

SCA-1E Stock Shock Specs:
Springs: Soft from Medium
Oil: Front = 35W Rear = 35W

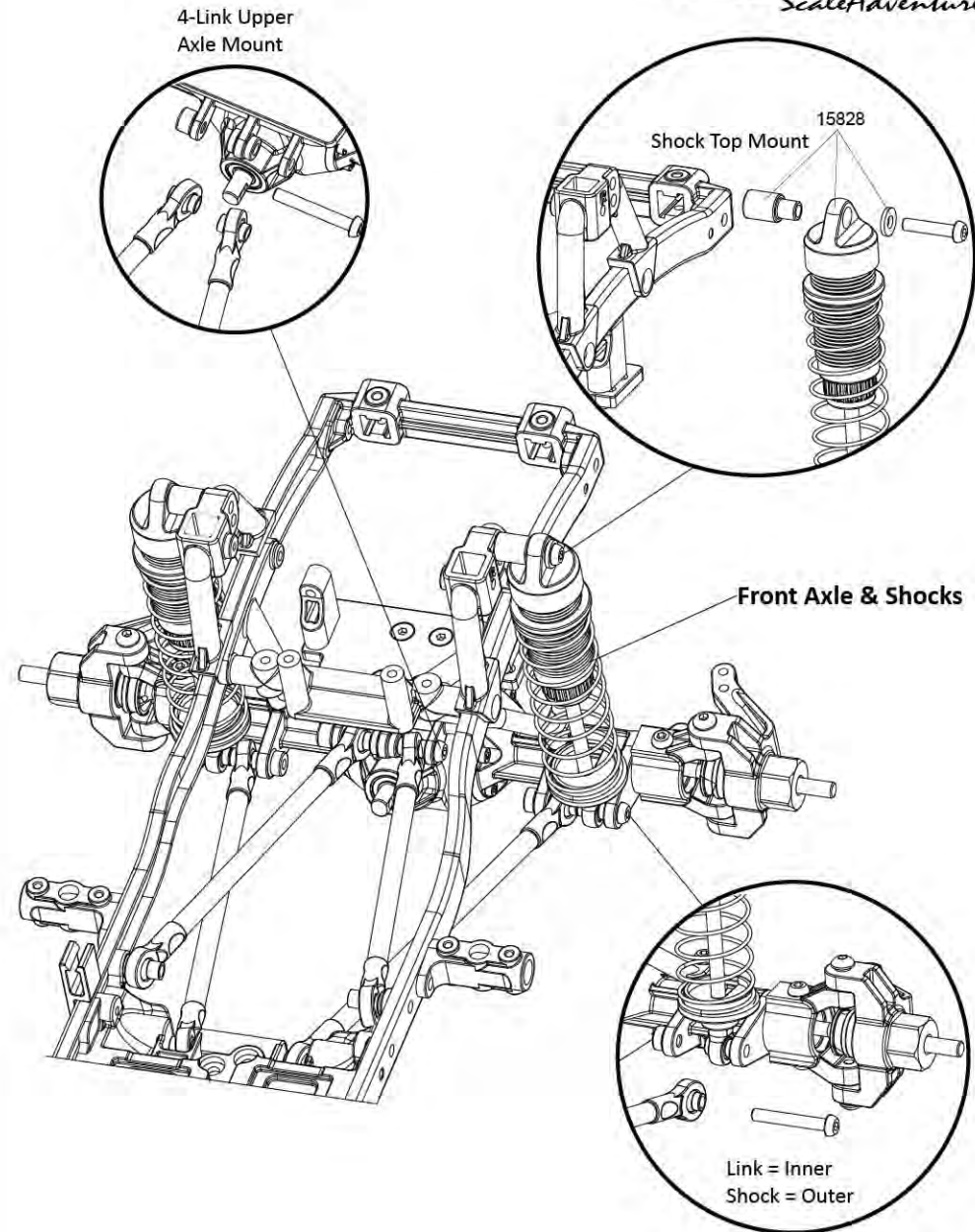

Note: Uper & lower links are "Double Triangulated" for a more stable chassis geometry & reduction in "Axle Steer"

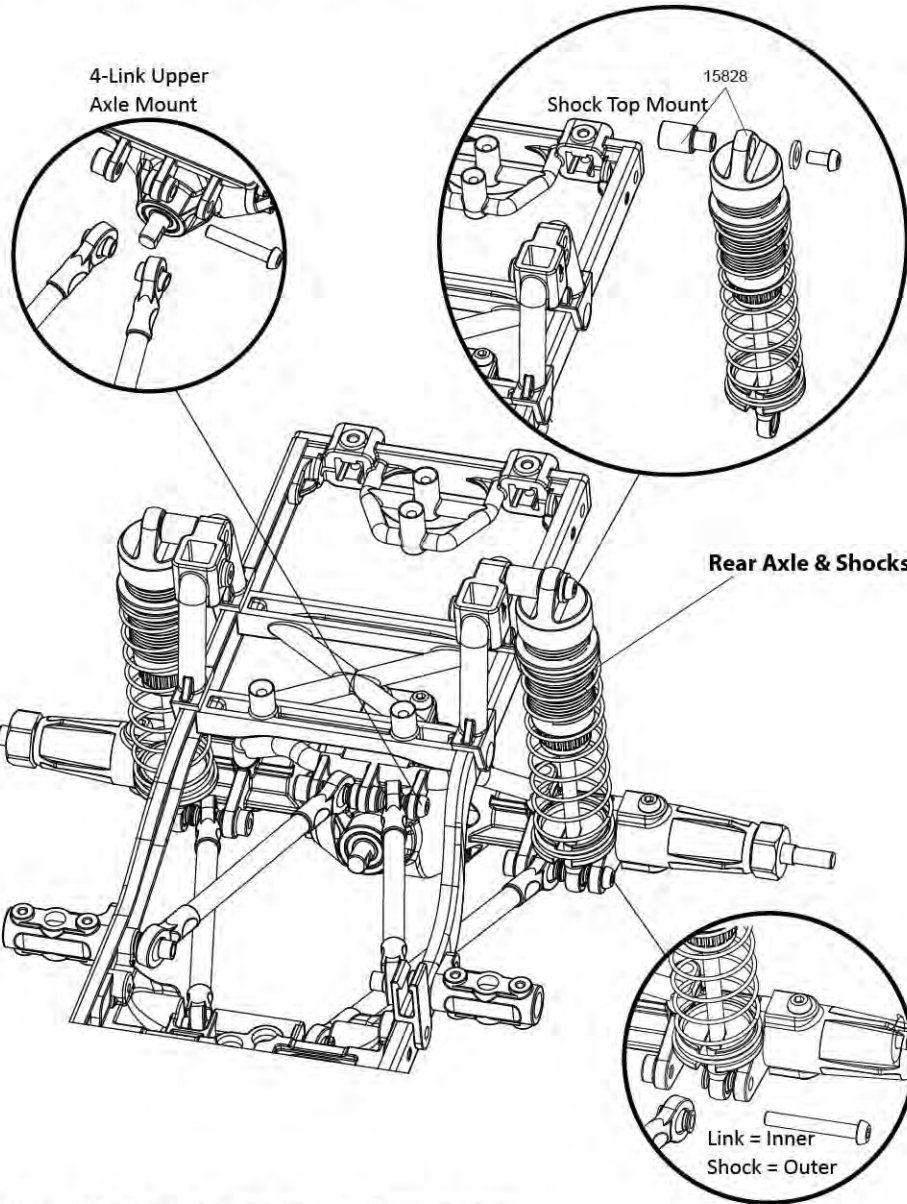

Note: Axle Steer is when an axle (front or rear) moves in a front to back arc as it articulates, making the rig crab. The end result being innacurate & unpredictable handling.

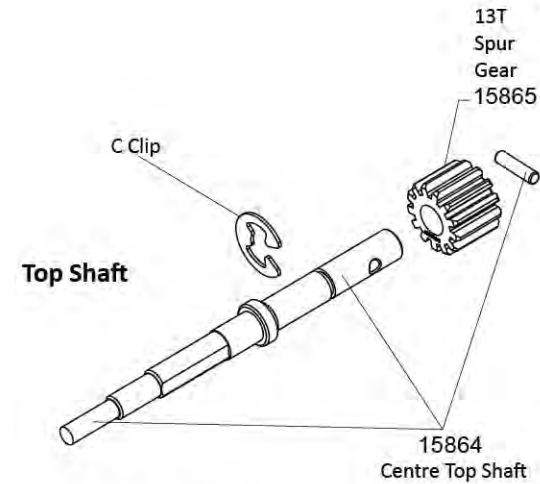

Note: With the stock 17T Pinion and 83T Spur gear the final drive ratio of the transmission is 15:1. This means that for every fifteen turns of the Motor, the Transmissions outrives turn just once. This offers the locked axles (and in turn the wheels and tyres) a lower wheel speed and lots of crawling Torque.

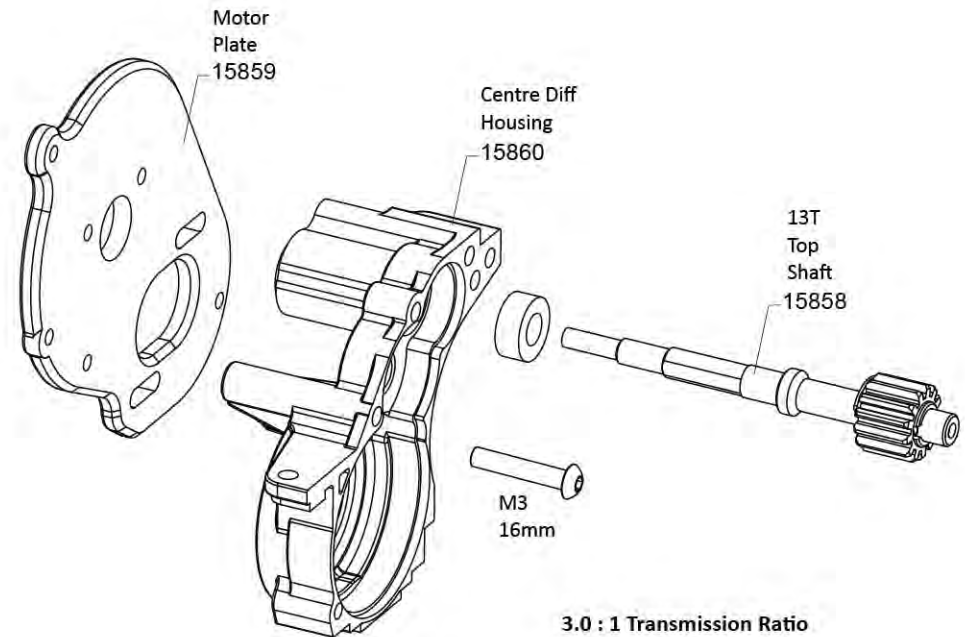

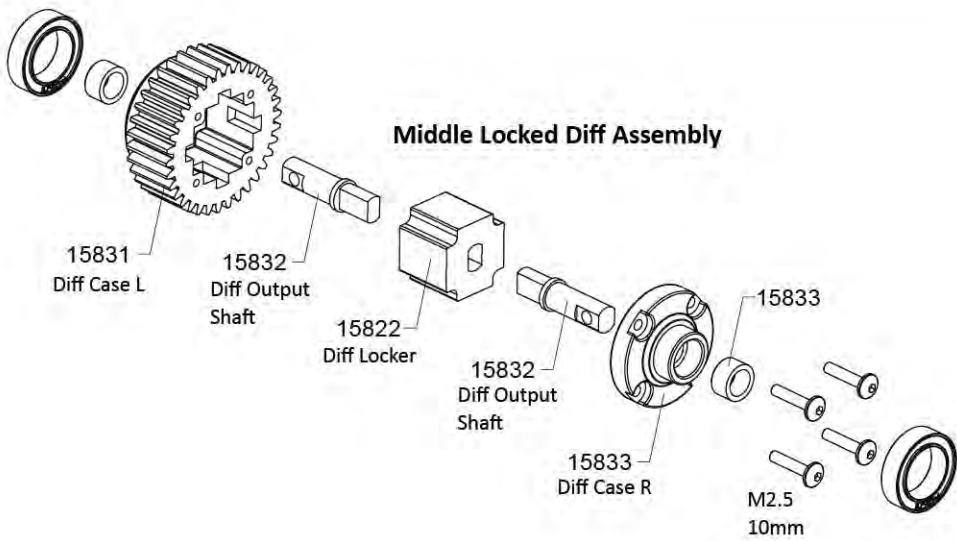

Middle Locked Diff Assembly

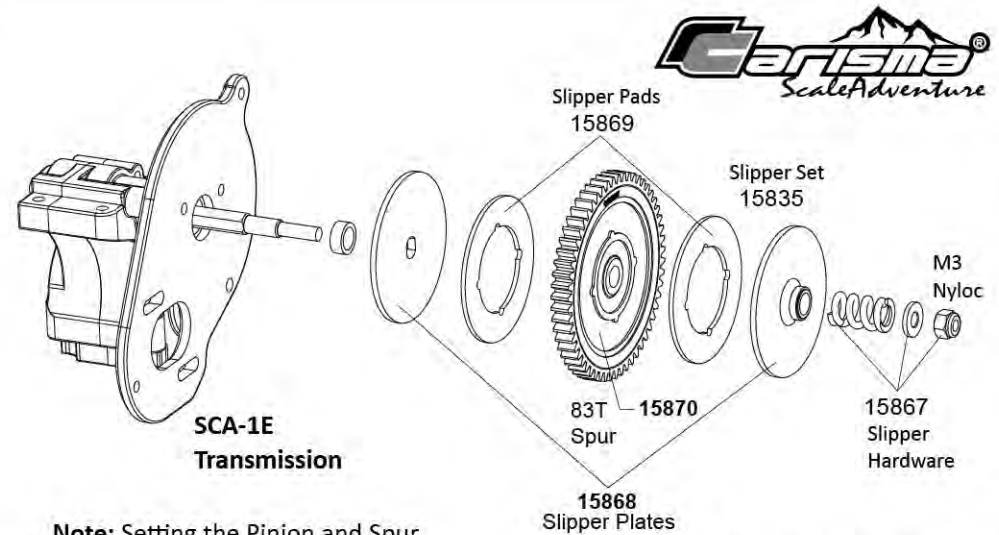

SCA-1E Transmission

Note: Setting the Pinion and Spur Gear Mesh, and the Slipper Clutch correctly are very important for smooth running and to protect the driveline from damage.

Gear Mesh: Use a thin strip of printer or note paper, and feed this between the Motors Pinion and the Spur. Press together, then tighten up motor bolts. Once paper is then pulled clear, will set the perfect gear mesh.

Slipper Clutch: Place the rig on a high grip surface, such as a carpet. The slippers spring should then be compressed all the way in using the M3 Nyloc nut, then backed off approximately 1.5 turns. The slipper should only slip in the event the driveline gets locked up under full load when Crawling.

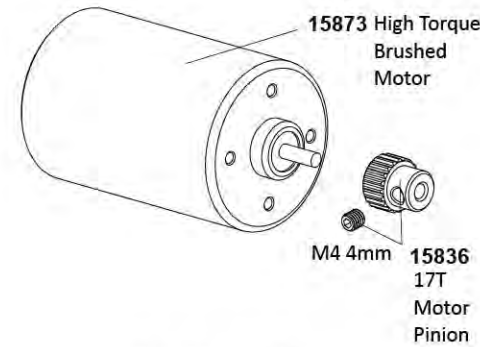

SCA-1E Motor & Transmission

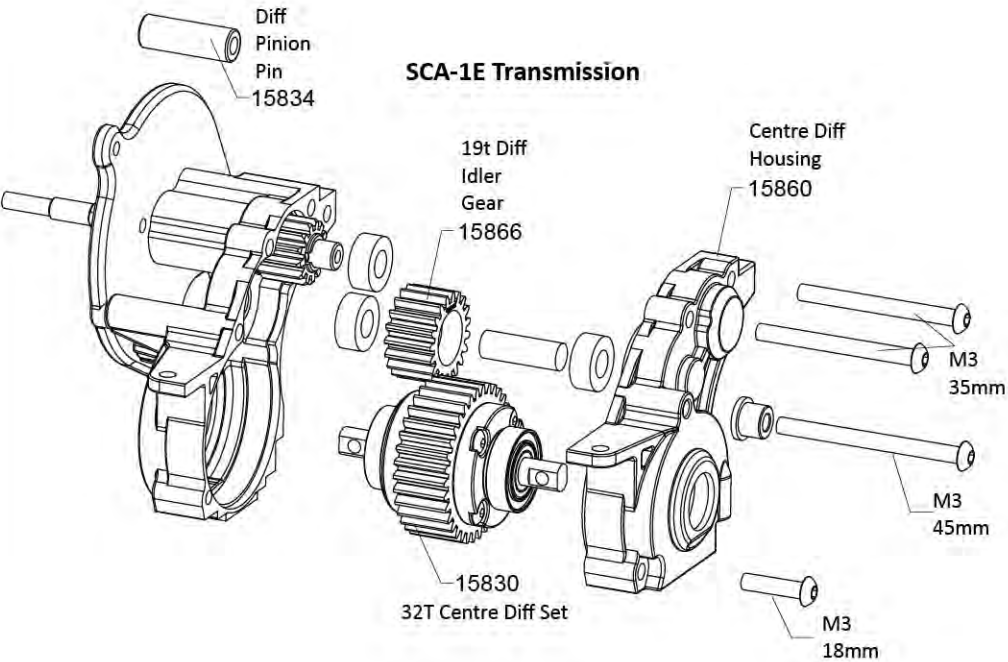
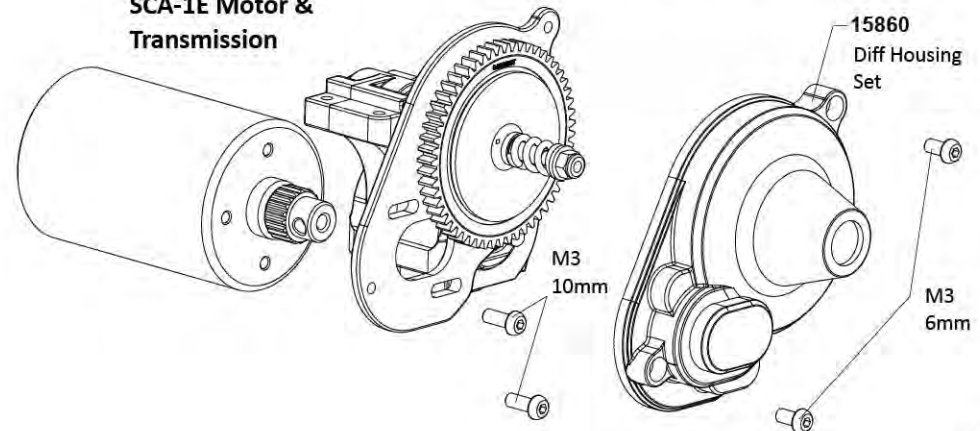

SCA-1E Transmission

15 : 1 Drive Ratio
With Stock 17T Pinion & 83T Spur = 15.1 Drive Ratio



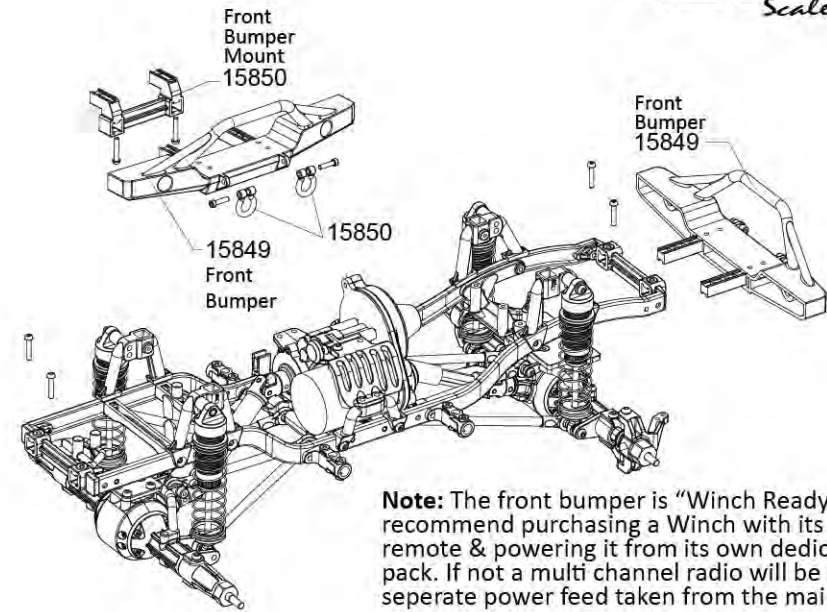
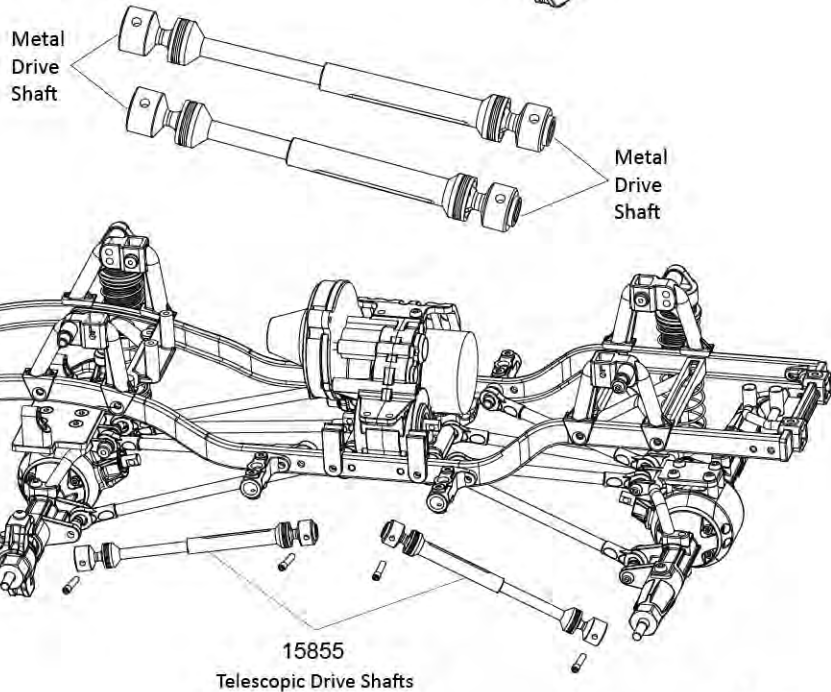
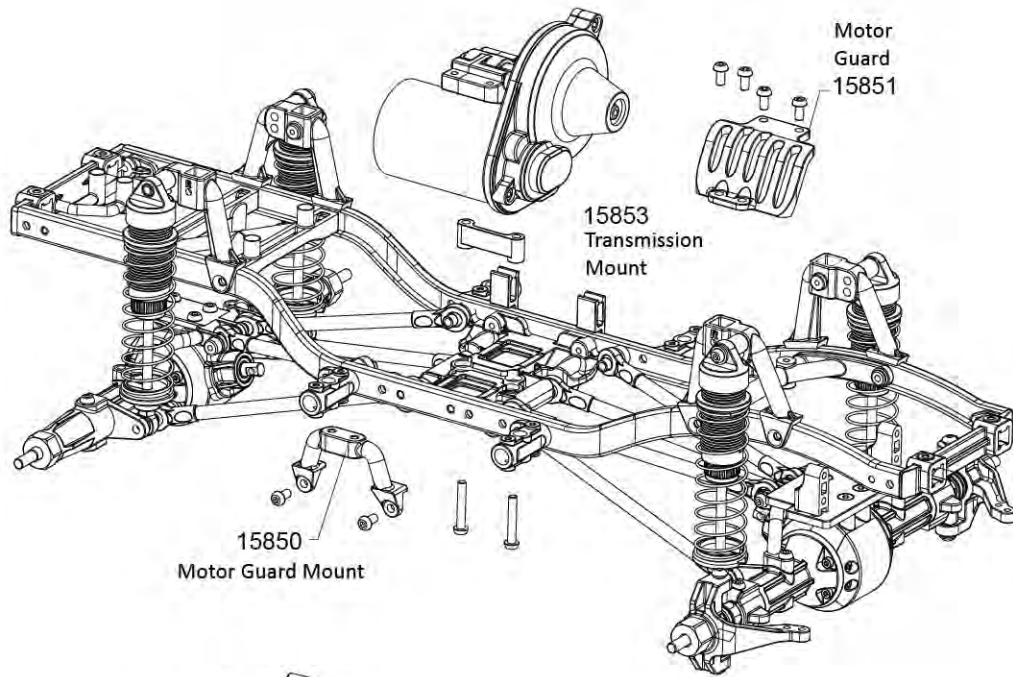

Note: The front bumper is "Winch Ready" but we recommend purchasing a Winch with its own keyfob remote & powering it from its own dedicated, smaller pack. If not a multi channel radio will be required and seperate power feed taken from the main pack

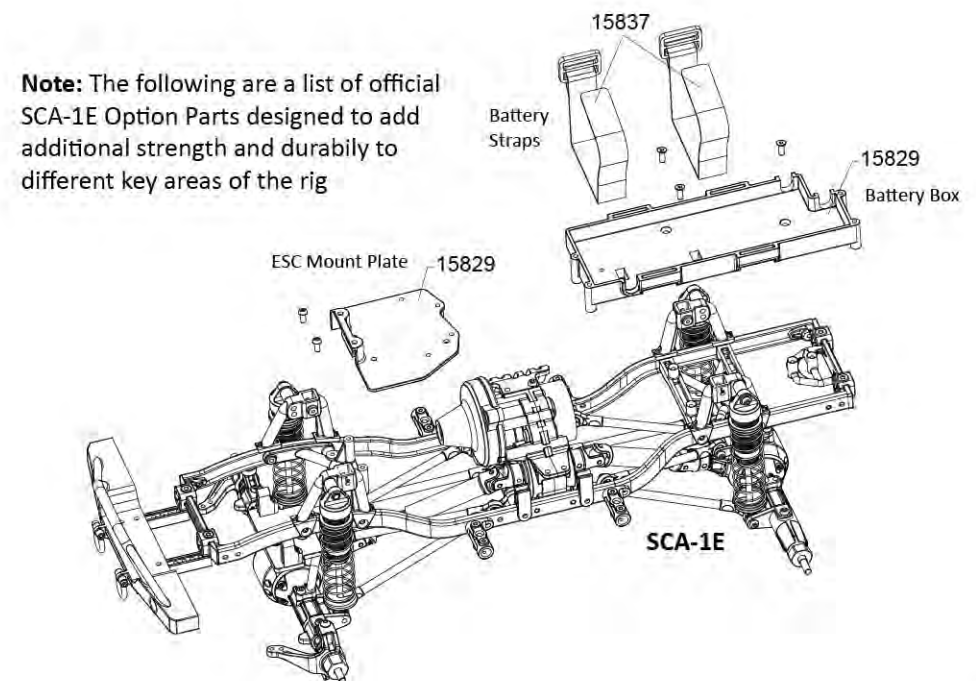

Note: The following are a list of official SCA-1E Option Parts designed to add additional strength and durability to different key areas of the rig

Note: Rock Sliders are designed to protect bodyshell from side abrasion and damage in use

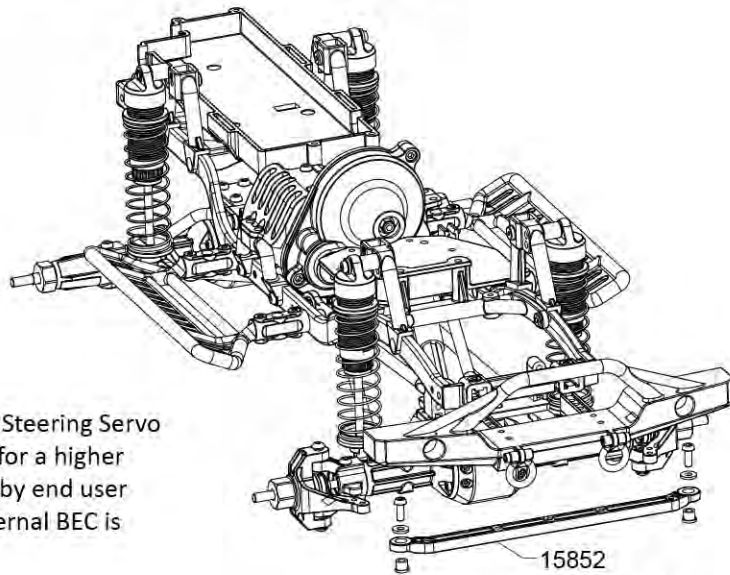
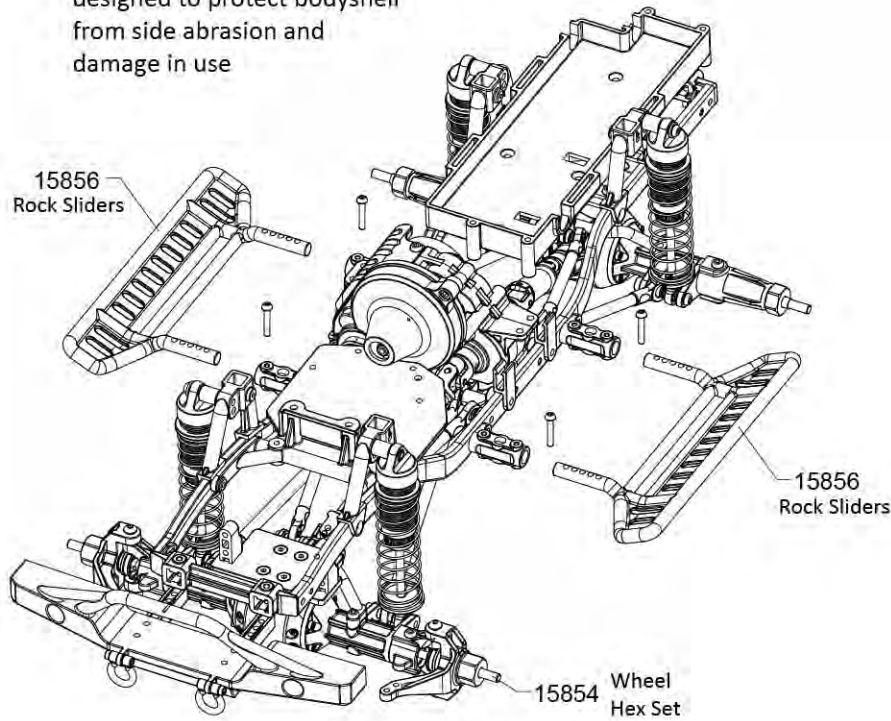

Note: If the Steering Servo is swapped for a higher torque unit by end user then an external BEC is required

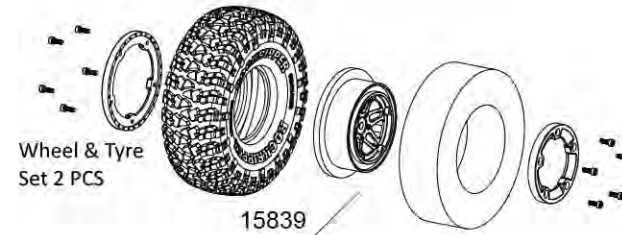
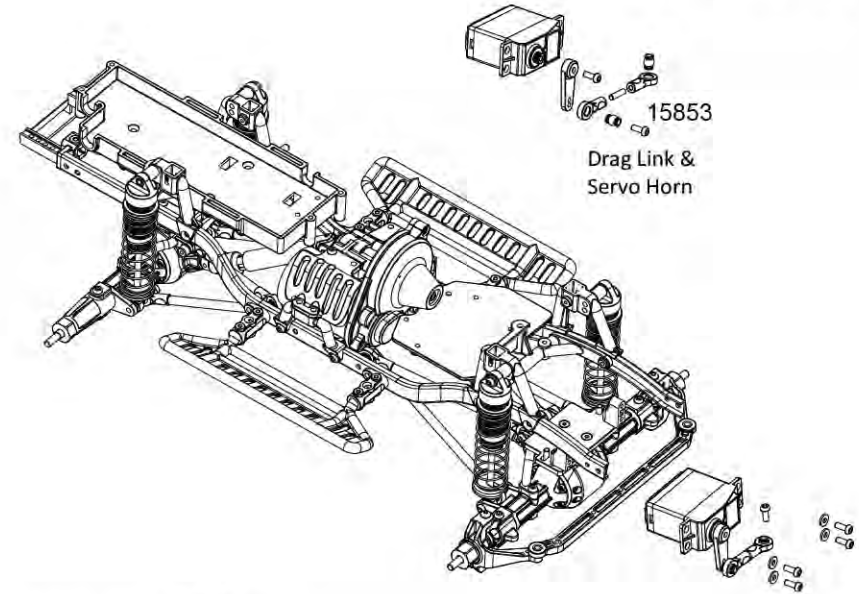

Note: Climbing ability and weight bias can be adjusted by adding additional weight to the front wheels

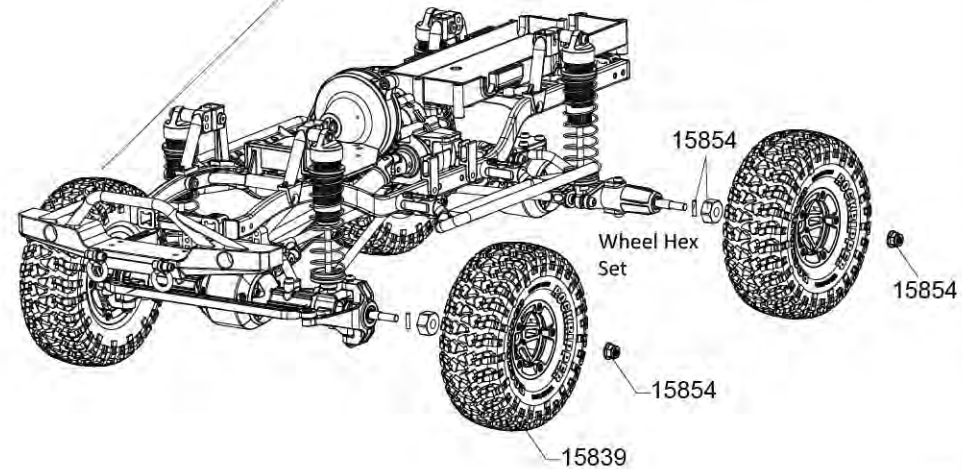

15851 Body Posts & Motor Guard

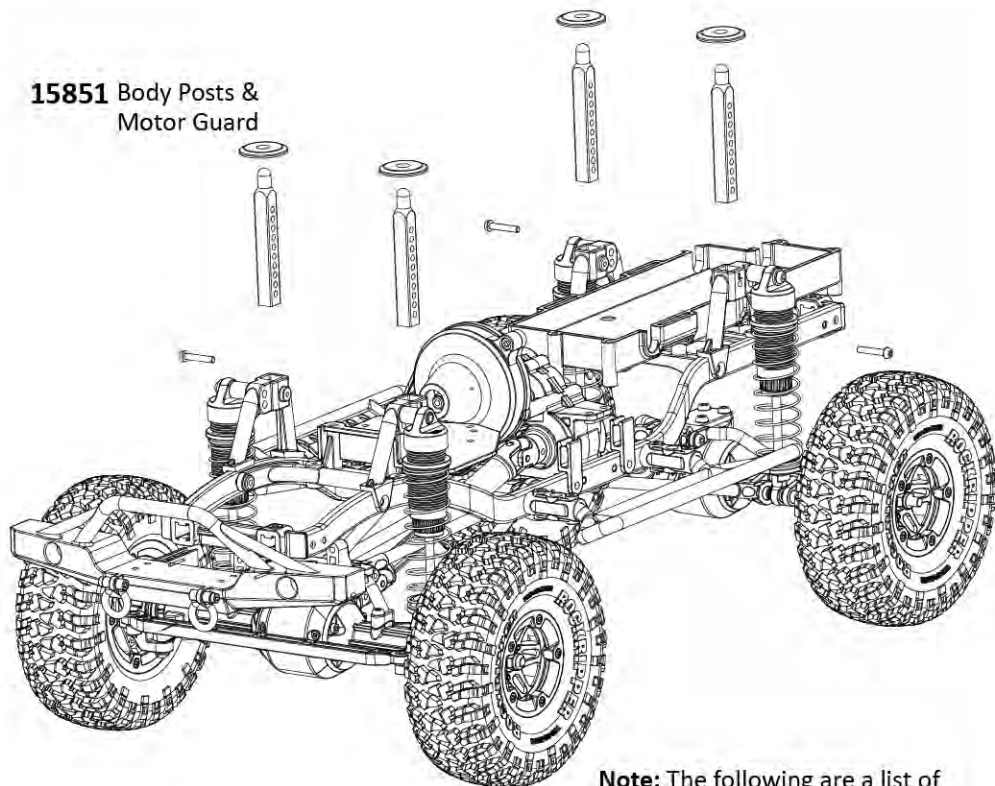

Note: The following are a list of official SCA-1E Option Parts designed to add additional strength and durability to different key areas of the rig

PART DESCRIPTION

- 15872 Aluminium Rear Bumper
- 15873 Aluminium Rim Set 2pcs
- 15874 Front Upper Links Set
- 15875 Front Lower Link Set
- 15876 Rear upper Link Set
- 15877 Rear Lower Link Set
- 15878 Aluminium Battery Holder
- 15879 Aluminium Servo Arm 25T
- 15880 Aluminium Servo Arm 24T
- 15881 Aluminium Servo Arm 23T
- 15882 Aluminium Rock Slider
- 15883 Aluminium Servo Holder

PART DESCRIPTION

- 15884 Aluminium Servo Mount
- 15885 Aluminium Wheel Hex 8mm
- 15886 Aluminium Steering Knuckle
- 15887 Aluminium Front Differential Case Set
- 15888 Aluminium Rear Differential Case Set
- 15889 Aluminium Steering Linkage
- 15890 Body Post + Aluminium Front Shocks Holder
- 15891 Body Post + Aluminium Rear Shocks Holder
- 15892 Aluminium Center Differential Mont
- 15893 Aluminium Rock Slider Mount
- 15894 Aluminium ESC Mount Plate + Font Shock Mount
- 15895 Aluminium Rear Shock Mount + Battery Holder Support

Spare Parts

PART DESCRIPTION

- 15820 F & R Differential Set
- 15821 39T Differential Crown Gear
- 15822 Differential Locker
- 15823 Differential Casing Set
- 15824 16T Differential Input Pinion Gear
- 15825 Front CVD Shaft Set
- 15826 Rear Axle Drive Shaft
- 15827 SCA-1E Ladder Chassis
- 15828 Oil Shocks Set
- 15829 Battery Box + ESC Mount Plate
- 15830 Center Differential Set
- 15831 Center Differential Case - L
- 15832 Center Differential output Shaft
- 15833 Center Differential Case - R
- 15834 Differential Pinion Pin 5 x 14.7
- 15835 Slipper Set
- 15836 Motor Pinion Gear 17T
- 15837 Battery Straps
- 15838 Coyote Painted Body Set
- 15839 Wheel & Tyre Set 2 PCS
- 15840 F & R Differential Case
- 15841 F & R Axle Casing Half
- 15842 Rear Axle Lockout
- 15843 4-Link Upper Mount
- 15844 Front Steering C Hub
- 15845 Front Steering Knuckle
- 15846 Servo Mount
- 15847 F & R Bumper Mount + F&R Shock Hoop
- 15848 F & R Shock & Chassis Brace

PART DESCRIPTION

- 15849 F & R Bumpers Set
- 15850 Center Differential Mount
- 15851 Body Posts & Motor Guard
- 15852 Steering Link
- 15853 Drag Link and Servo Horn
- 15854 Wheel Hex Set
- 15855 Drive Shafts
- 15856 Rock Sliders
- 15857 Bearing Set (13pcs 5x10x4, 6pcs 10x15x4)
- 15858 Center Top Shaft assembly (13T)
- 15859 Motor Plate
- 15860 Center Differential Housing Set
- 15861 Front CVD Shaft
- 15862 Front CVD Drive Cup
- 15863 Front CVD Joint
- 15864 Center Top Shaft
- 15865 Top Spur Gear 13T
- 15866 Differential Idler Gear 19T
- 15867 Slipper Hardware Set
- 15868 Slipper Plate Set
- 15869 Slipper Pads
- 15870 Spur Gear 83T
- 15871 LED Light Set for LYNX Wagon
- 15872 4-Link Skid Plate
- 15873 High Torque Brushed Motor
- 15903 Coyote Clear body set
- 15917 Y-Harness
- 15918 LYNX Painted Body Set
- 15919 LYNX Clear Body Set



15838 Coyote Painted Body set

FCC Information

This equipment has been tested and found to comply with the limits for a Class B digital device, pursuant to part 15 of the FCC Rules. These limits are designed to provide residential protection against harmful interference in a residential installation. This equipment generates, uses, and can radiate radio frequency energy and, if not installed and used in accordance with the instructions, may cause harmful interference to radio communications. However, there is no guarantee that interference will not occur in a particular installation. If this equipment does cause harmful interference to radio or television reception, which can be determined by turning the equipment on and off, the user is encouraged to correct the interference by one or more of the following measures: Reorient or relocate the receiving antenna. Increase the separation between the equipment and the receiver. Connect the equipment into an outlet on a circuit different from that to which the receiver is connected.

FCC Warning:

The equipment may generate or use radio frequency energy. Changes or modifications to this equipment may cause harmful interference unless the modifications are expressly approved in the instruction manual. Modifications not authorized by the manufacturer may void the user's authority to operate this device. This device complies with part 15 of the FCC Rules. Operation is subject to the following two conditions (1) This device may not cause harmful interference, and (2) this device must accept any interference received, including interference that may cause undesired operation.

Limited Warranty

Warranty Period: Carisma R/C warrants that the SC-1E ("Product") will be free from original factory defects in materials and workmanship upon purchase ("Warranty Period"). **What is Not Covered** - This warranty is not transferable and does not cover (a) cosmetic damage, (b) damage due to acts of God, accident, misuse, abuse, negligence, commercial use, or due to improper use, installation, operation or maintenance, (c) modification to any part of the Product, (d) attempted service by anyone other than a Carisma R/C authorized service center, or (e) Product not purchased from an authorized Carisma RC dealer.

OTHER THAN THE EXPRESS WARRANTY ABOVE, CARISMA RC MAKES NO OTHER WARRANTY OR REPRESENTATION, AND THEREFORE DISCLAIMS ANY AND ALL IMPLIED WARRANTIES, INCLUDING, WITHOUT LIMITATION, THE IMPLIED WARRANTIES OF NON-INFRINGEMENT, MERCHANTABILITY AND SUITABILITY FOR A PARTICULAR PURPOSE. THE PURCHASER ACKNOWLEDGES THAT THEY ALONE HAVE DETERMINED THAT THE PRODUCT WILL MEET THE REQUIREMENTS OF THEIR INTENDED USE.

Purchaser's Remedy - Carisma RC's sole obligation and purchaser's sole and exclusive remedy shall be that Carisma RC will, at its option, either (a) service, or (b) replace, any Product determined by Carisma RC to be defective. Carisma RC reserves the right to inspect any and all Product(s) involved in a warranty claim. Service or replacement decisions are at the sole discretion of Carisma RC. Proof of purchase is required for all warranty claims. **SERVICE OR REPLACEMENT AS PROVIDED UNDER THIS WARRANTY IS THE PURCHASER'S SOLE AND EXCLUSIVE REMEDY.**

Limitation of Liability

CARISMA RC SHALL NOT BE LIABLE FOR SPECIAL, INDIRECT, INCIDENTAL OR CONSEQUENTIAL DAMAGES, LOSS OF PROFITS OR PRODUCTION OR COMMERCIAL LOSS IN ANY WAY, REGARDLESS OF WHETHER SUCH CLAIM IS BASED IN CONTRACT, WARRANTY, TORT, NEGLIGENCE, STRICT LIABILITY OR ANY OTHER THEORY OF LIABILITY, EVEN IF CARISMA RC HAS BEEN ADVISED OF THE POSSIBILITY OF SUCH DAMAGES.

Further, in no event shall the liability of Carisma RC exceed the individual price of the Product on which liability is asserted. As Carisma RC has no control over use, setup, final assembly, modification or misuse, no liability shall be assumed nor accepted for any resulting damage or injury. By the act of use, setup or assembly, the user accepts all resulting liability. If you or the purchaser or user are not prepared to accept the liability associated with the use of the Product, purchaser is advised to return the Product immediately in new and unused condition to the place of purchase. This warranty gives you specific legal rights, and you may also have other rights which vary from country to country, or state to state. Carisma RC reserves the right to change or modify this warranty at any time without notice.

Carisma LTD

21/ Floor, Kingsway Industrial Building,
Phase 2, 173 - 175 Wo Yi Hop Road,
Kwai Chung, N.T., Hong Kong.

Note: For official Carisma RC spare parts, see your local hobby shop or place of purchase first. If unavailable, parts can be ordered direct at: <http://www.carisma-shop.com>

SCA-1E Setup Notes



Shocks, Oil Weight & Springs:

Weight Bias:

Motor Pinion & Spur Gear:

Slipper Clutch & Motor Wind:

Other Setup Options Used:

"Owning a Coyote is just the start, where it takes you is the real adventure..."

Ivan Carisma

历险开始



欢迎来到恺司玛SCA-1E的冒险世界。这虽然只是旅程的起点，但许多人无疑将持续一生。最终引导你到哪里是你自己的选择。第一步只是打开盒子，而你将会主宰它的演化。

找到理想的地方，遊歷其中，沉浸在沿路风景中，与环境融为一体。世界是如此的多样化，它多变的地形具有挑战性，而SCA-1E将与你一起去拥抱这一切...

此机车通过了考验并拥有可靠的越野功能，如稳固车轴，四轮驱动，中置传动系统及电机，真正的4链接悬挂，可调节线圈，油压避震，和软身厚轮胎，防水电变，高扭力伺服和2.4GHz无干扰无线电系统。

可使用原身车壳或按自己风格仔细改装。亦可调节MAIN PACKS 位置来改变重量，在前保险杠加上远绞盘来提高其极限能力，再加上LED灯来辅助夜间运行。ESC标准被设定为攀爬模式，提供即时反向和持续自动刹车。这改善了下降陡峭时的操控。

把SCA-1E看成是一张白纸，而您将决定其未来的功能和能力，它亦会帮助塑造你的命运。感谢你成为全球规模快速增长社群和恺司玛遥控家族的另一位成员。希望你能享受历程中的每一个环节。

人生匆匆，好好享受吧



安全须知

感谢您购买恺司玛 SCA-1E 攀爬车。正确使用和定期维护，本攀爬车将为您和所有开车的人提供无限的遥控车的乐趣！请阅读本手册来完全了解其特性，功能和最佳的操作。如有技术问题或需要更换零件，请联系您当地的恺司玛遥控经销商、购买地点或我们的网店：<http://www.carisma-shop.com> 您也可以通过电子邮件 webmaster@carisma-shop.com 直接与我们联系。

警告

请仔细阅读使用说明书，以便在操作之前熟悉本产品的特性。这个是一个复杂的爱好品级产品，它必须谨慎地操作。这将需要一些基本的机械能力。未能以安全和负责任的方式操作本产品可能会导致对产品，人员或其他财产的伤害或损坏。

本产品不适合没有成人监督的儿童使用。

不要使用在恺司玛遥控提供的指示之外，不兼容的组件或以任何方式更改本产品。

本手册包含安全操作说明及保养方法。在装配，设置或使用之前，必须阅读并遵守手册中的所有说明和警告，如果您不准备接受这些指引，请立即把本产品退回购买地点。

警告

本产品适用于14岁以上消费者。18岁以下的用户需要家长监督。

请勿将任何电池或组件暴露于明火或其他高温源。

在使用本产品之前，必须先阅读随附的使用说明书。

除原本充电器之外，不要使用任何充电仪器。

在充电过程中，切勿无人看守充电池。

不要将任何组件暴露于潮湿环境中。

没有防水设计和保护的部件，要避免接触水份。

作为本产品的使用者，您将全权负责以不危害自己和其他人，或者导致产品损坏，或其他人的财产的方式进行操作。

一定要仔细按照方向和警告，以及任何可选设备（充电器等）。

此模型受到无线电信号的控制，或会受到来自您控制之外的许多来源的干扰。

不要将车辆的任何部分放在口中，否则可能导致严重伤害甚至死亡。

操作此模型车辆时，请远离实物车辆，交通，人和动物。

模型的各个方向都必须保持安全距离，以避免碰撞或受伤。

所有化学品，小零件和任何电气，切勿接触儿童。

当模型车通电时，要保持发射器的电源开启。

使用后或拆卸前请务必取出电池。

发射机低电量时，不要操作车辆。

保持车辆在自己视线和受控制。

切勿在导线损坏的情况下操作车辆

必须等待部件冷却，方可触摸。

保持活动部件的清洁和干燥。

请务必使用充满电的电池。



包装内容



越野攀爬车



发射器



镍氢电池



USB涓流充电器



六角起子



台湾：「3号电池」
中国大陆：「5号电池」



箱式扳手

工具推荐（不包括）



大号螺丝刀

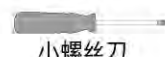

小螺丝刀



剪钳

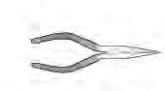

长鼻钳

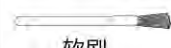

软刷



六角扳手

关于无线电系统

Carisma CTX-8000 2.4GHz FHSS 技術系統

下列是有关Carisma 2.4GHz FHSS線電系統功能及設定，請在操作前細心閱讀以確保系統正常運作。

遙控器 CTX-8000

- 方向盤：控制(左/右)轉向
- 遙控器油門把手：控制前後速度
- 遙控器開/關：遙控器電源開/關
- FTN配對按鈕：與遙控器進行配對
- 電源顯示燈：綠色LED燈顯示電源已開
紅色LED燈閃顯示電源不足
- ATV轉向幅度旋鈕：調節左/右轉向幅度
- 轉向微調旋鈕：微調轉向正中心位置
- 油門微調旋鈕：微調油門正中心位置
- 左右轉向反向制：對左右轉向的正/反向調節
- 油門反向制：對油門前後的正/反向調節

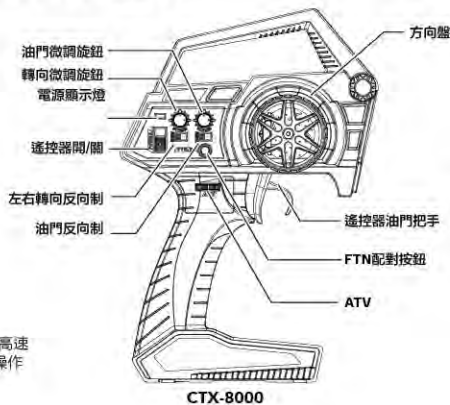

*提示：如使用高速駛入大弧角度彎時，可能會感到模型車的轉向不足或在高速駛入急彎時可能出現打滑的情況。建議使用者多練習控制油門及轉向的操作以應對不同速度及不同路面。

電池安裝說明

1. 使用全新5號1.5伏 × 4枚乾電池，CTX-8000遙控器可操作幾個小時。
安裝方法：推開遙控器底部電池門。如下圖顯示。
2. 安裝5號乾電池到遙控器電池箱內時，請準確安裝電池到相對應的“正”極及“負”極位置上。
3. 把遙控器底部的電池門蓋上。如下圖顯示。

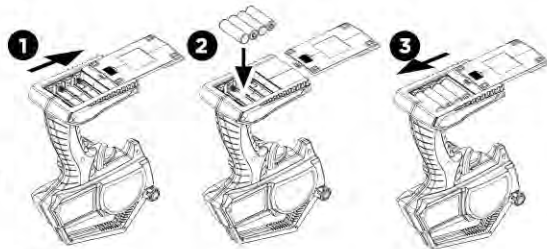

警告：
不要拆解電池，也不要將電池投入化學藥劑或火堆中。否則可能會造成嚴重身體受傷或財產損失。

電池棄置：

- 請參閱當地有關電池棄置或處理規則
1. 如乾電池使用完畢請把電池棄置於指定，地點，必須遠離水源，種植或民居範圍。
 2. 把使用完畢的電池送到指定回收站處理。

電池LED顯示

遙控器上LED燈顯示綠色表示有足夠電量。當遙控器內的電池電壓低於4伏以下，LED燈由綠色轉為紅色閃動狀態。這表示電池電量不足，必須立刻更換全新乾電池才可繼續操作。

長亮綠色LED燈：
有足夠電量

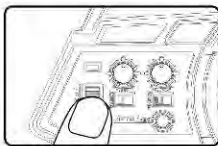

閃動紅色LED燈：
電池電量不足

綠色

ATV轉向幅度旋鈕

轉向幅度旋鈕容許對轉向幅度做調節。轉向伺服器的微細度對轉向幅度調節有相對關係，調低轉向幅度會減低轉向伺服器的微細度，同時也會減少最大左右轉向幅度。

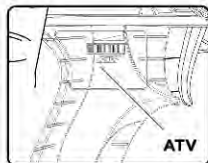

操作前檢查

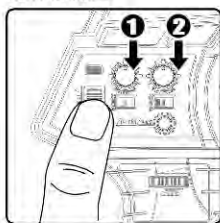

1. 轉向：當方向盤在正中位置時，使用轉向微調旋鈕來調節前輪以保持模型車能夠直線行駛。
2. 油門：當油門把手在正中位置時，使用油門微調旋鈕來調節模型車驅動馬達保持靜止狀態。

反向調節

反向調節是用於對左右轉向或油門前後的反向設定。CTX-8000遙控器有兩個反向調節功能：轉向反向調節及油門反向調節

轉向反向調節：

反向調節是實現方向盤轉向操作的左/右的反方向。當轉動方向盤向左方，模型車應相對轉向左方，因調節反向而轉為往右方轉。

油門反向調節：

反向調節是實現油門把手操作的推/拉的反方向。當推動油門把手，模型車動作應相對向後退，因調節反向模型車轉為往前移動。

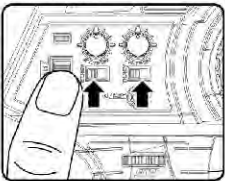

SCA-1E 电子部件



ESC / 遙控器設置

包装内的RTR Tx和ESC由工厂设置，但如果你选择更换无线电系统，请按照以下说明操作：

对于附有液晶屏的遥控器，要确保“D/R”，“EPA”，“ALT”设置为100%， “TRIM”的油门频道设置为0。对于非LCD屏幕的遥控器，请确保油门“TRIM”旋钮设置为空档。

对于Futaba和一些OEM的遥控器，油门通道请切换到“REV”，而其他无线电系统应设置为“NOR”

强烈建议使用所选无线电系统的故障保护功能，如果信号丢失或Tx电池电量不足，系统会停止马达。

警告： 不正确的电压极性输入将立即损坏ESC。

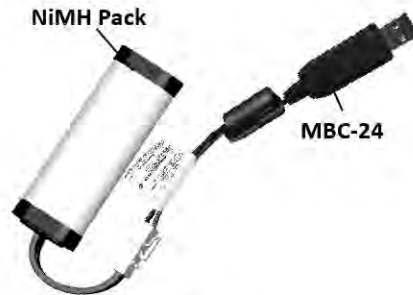

MBC-24 USB Charging

SCA-1E配有USB涪流充电器。MBC-24仅用于为7.2V镍氢电池充电。
注意：不要收取任何其他类型的电池。它不适用于LiPo或Li-ion包装。

当连接到标准USB电源时，红色LED将亮起，表示电源已打开。涪流输出电流为100mA，对于完全耗尽的电池，充电时间约为14小时。充电后，断开USB充电器，电池应感觉稍微温暖。部分充电包会快得多，所以如果电池在充电周期早期时变暖，请断开USB充电器的运行，直到完全放电。NiMH包装完全放电和循环最好。您的包可能需要几个周期才能充分发挥潜力。

注意： 请务必在监控下对电池充电，不要将充电电池无人值守。红色LED不会关闭，它只表示充电器有电。

油门校准

为了使ESC能够与不同遥控器的油门范围相匹配，需要进行校准。这是一个简单的三步程序。首先打开遥控器。然后将它的油门扳机置于中性位置。ESC等待3秒钟，以便ESC可以执行自动油门校准。当这完成后而ESC又可以运作，马达会发出长「哔」声。

哔声的含义	LED状态
<ul style="list-style-type: none"> • 1短哔声：电池为NiMH / NiCd • 2短哔声：电池为2S LIPO • 3短哔声：电池为3S LIPO • 1个长哔声：自检和油门校准好的，ESC准备运行了 	<ul style="list-style-type: none"> • 当油门扳机处于空档范围时时，红色LED熄灭 • 部分油门前进，制动或反向时，红色LED闪烁 • 全油门正向来时，制动或反向，红色LED指示灯会持续亮起

油门扳机位置：



WP-1040攀爬车专用ESC

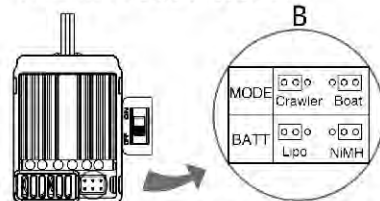

本ESC由工厂标准设置已设定为“攀爬模式”和“NiMH”电池类型。它是通过使用跳线来编程的，所以推荐使用镊子来拔下插头并设定案每个参数。

使用LIPO电池时请记住更改为LIPO模式，这种类型的包，因为这ESC有一个内置的低电压检测电路去保护LIPO，过度放电可能会永久损伤。



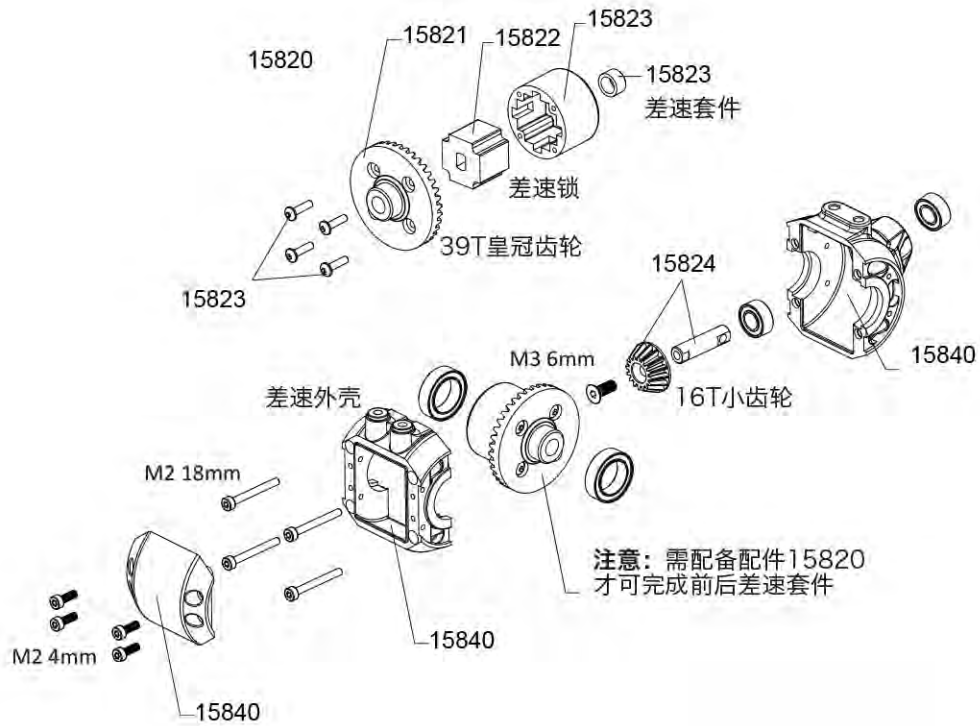

注意事项：如果模型车曾在泥沼或潮湿
环境下运行，请定时润滑齿轮轴和轴承

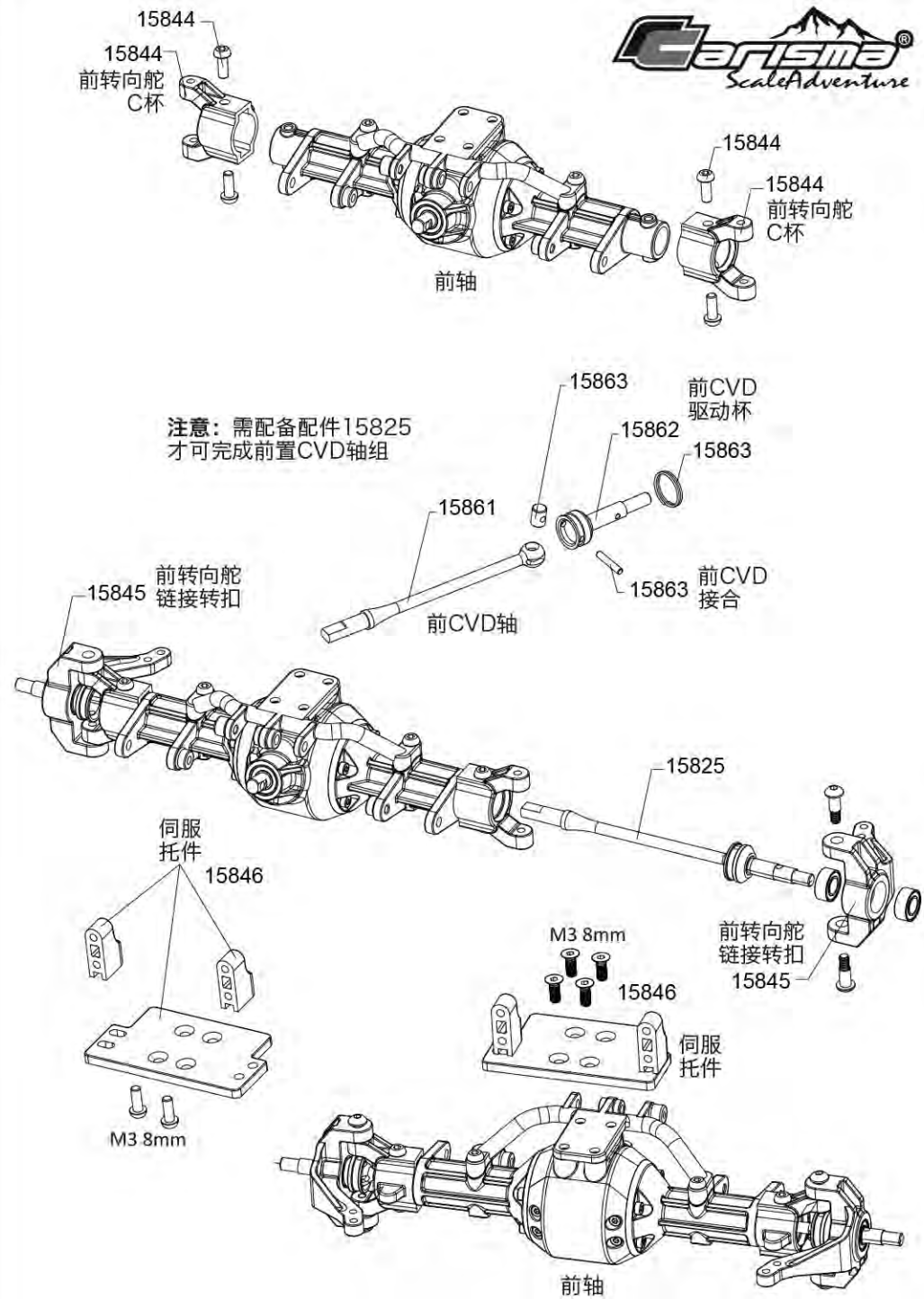
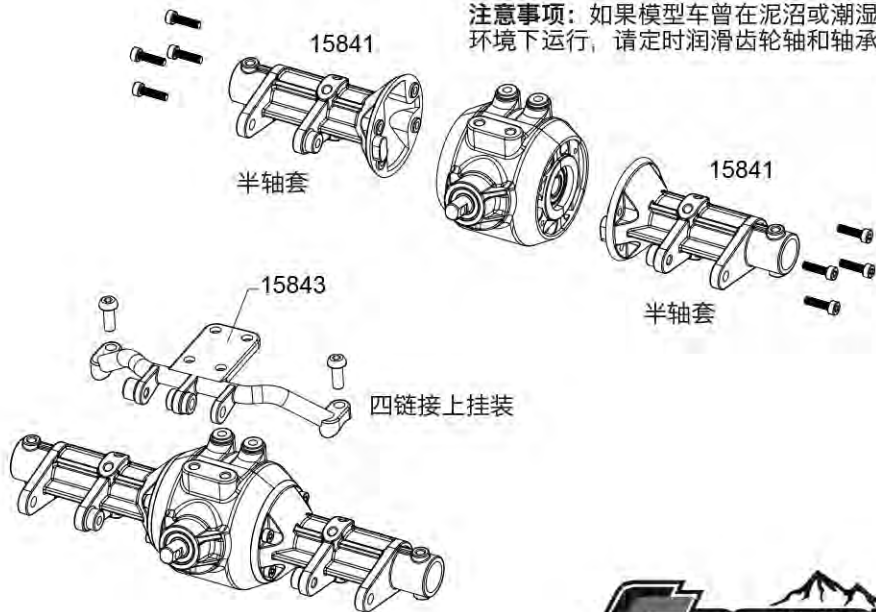

RTR 套装配备的后轴

后轴
闭锁
15842

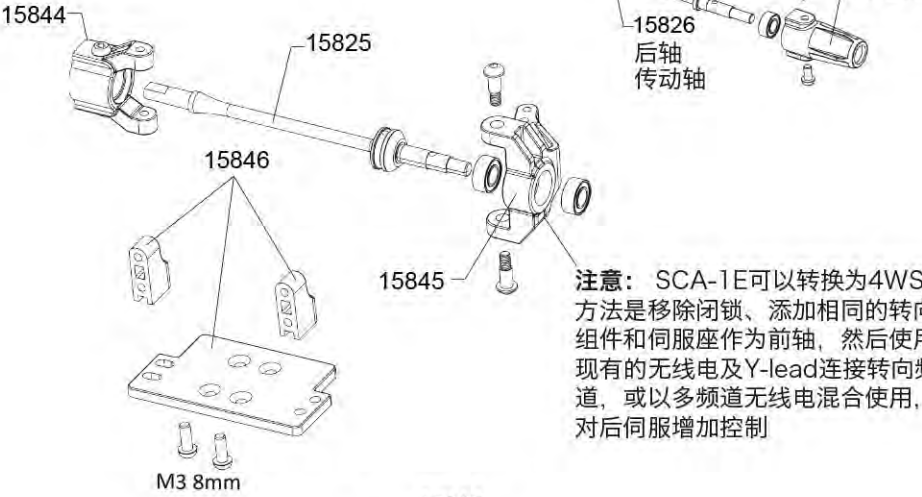

注意：SCA-1E可以转换为4WS，方法是移除闭锁、添加相同的转向组件和伺服座作为前轴，然后使用现有的无线电及Y-lead连接转向频道，或以多频道无线电混合使用，对后伺服增加控制

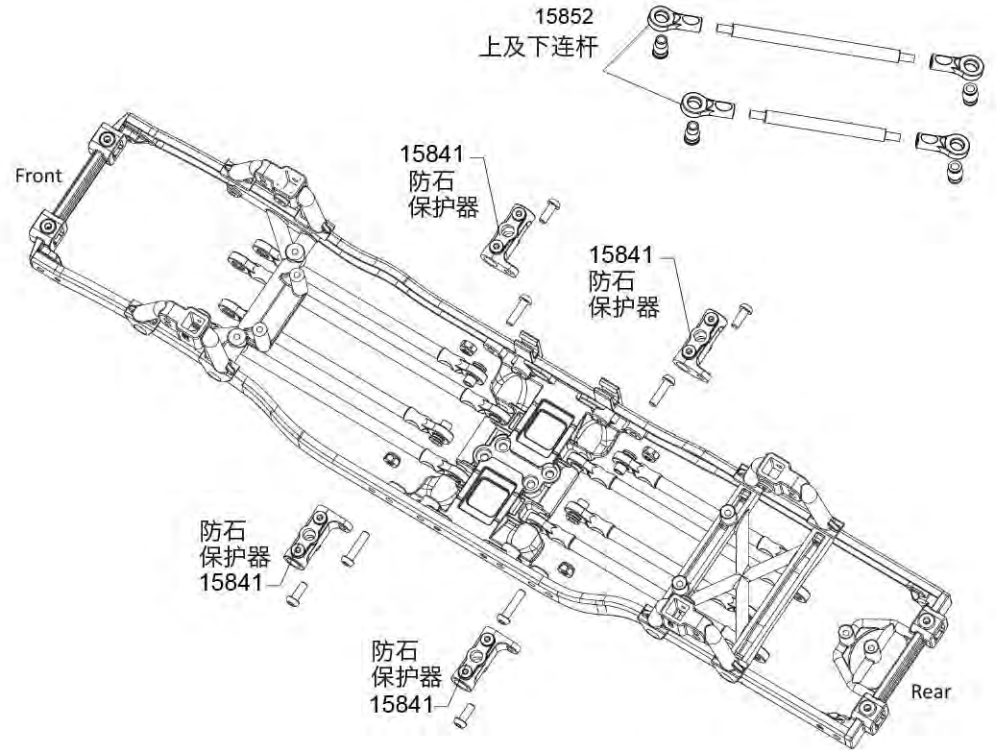
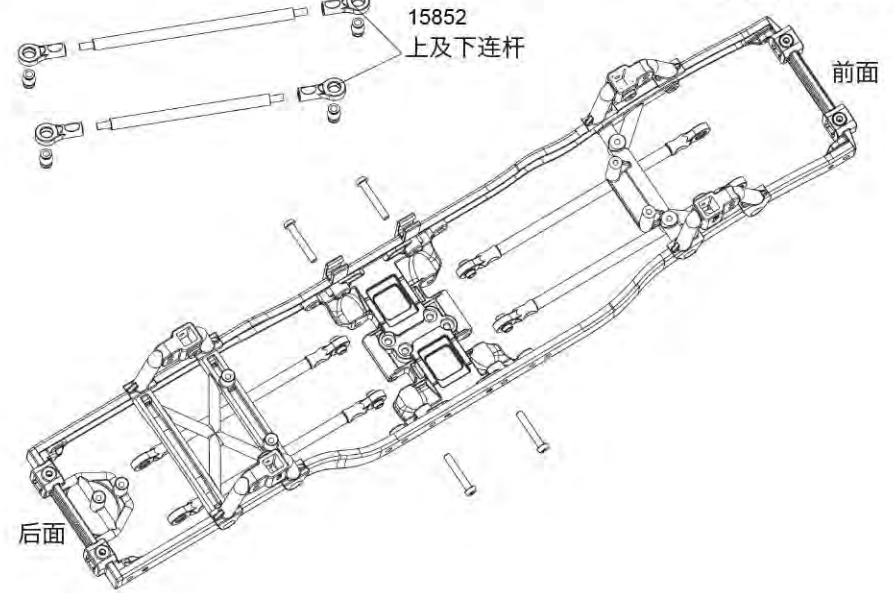
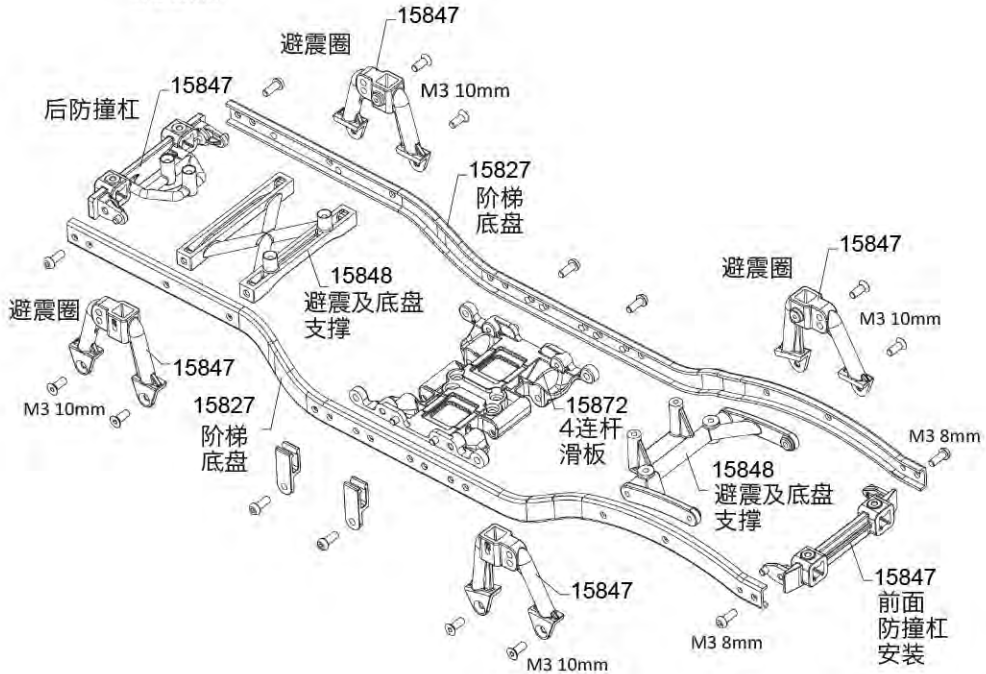

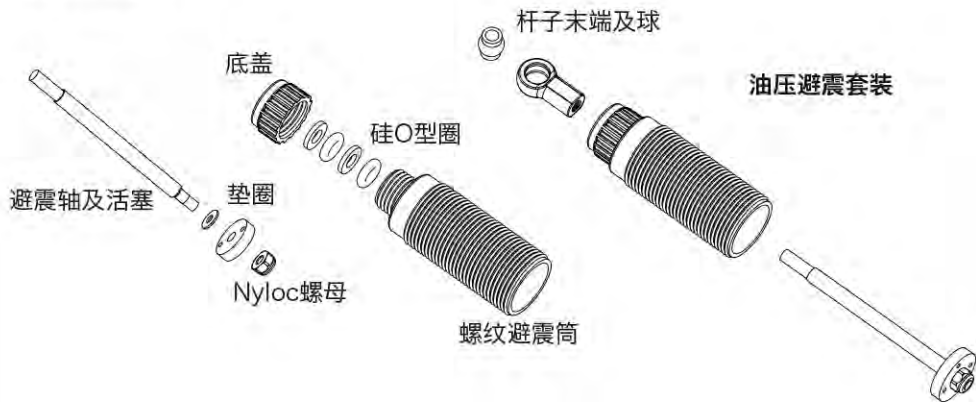

注意：避震油和弹簧的选择会影响模型车的驾驶特性。油越厚，避震活塞在避震筒内移动的速度越慢，模型车对您选择的路面的差异反应越慢；太薄了，当模型车爬行时又会变得不可预测，并遭受过大的「扭矩扭曲」(Torque Twist)。当扭力从模型车的一个或多个角上的避震及车轴，通过传动系统转移并在压缩。所有硬轴模型车在一定程度上都受到这种影响，但是用了正确的避震油、弹簧及负载，情况可以大大改善。



SCA-1E套装配置避震规格：
 弹簧：从柔软到中度
 油：前面= 35W后部= 35W

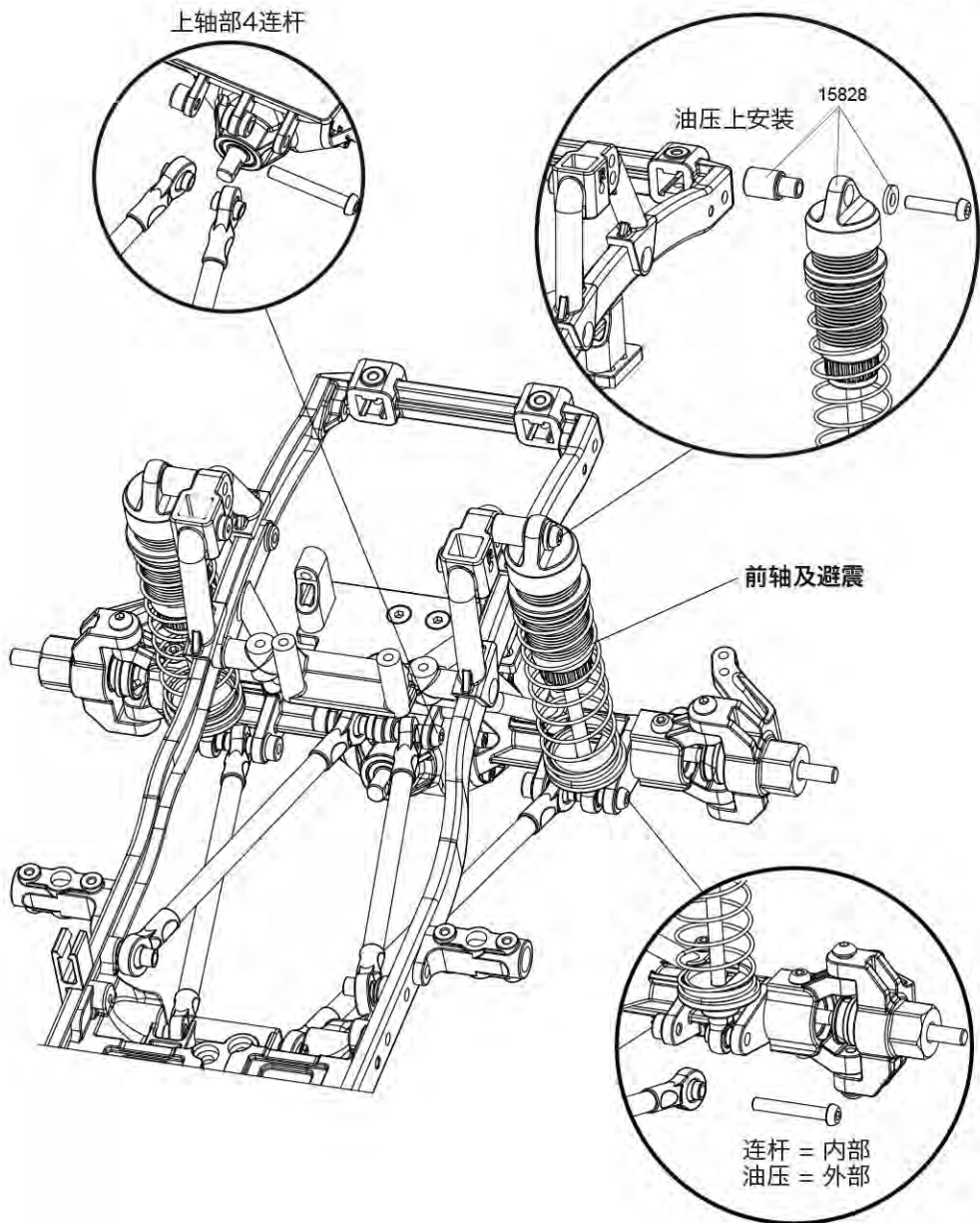

注意：上链接及下链接是「双重三角形」
为更稳定的底盘几何学及减少「轴转向」

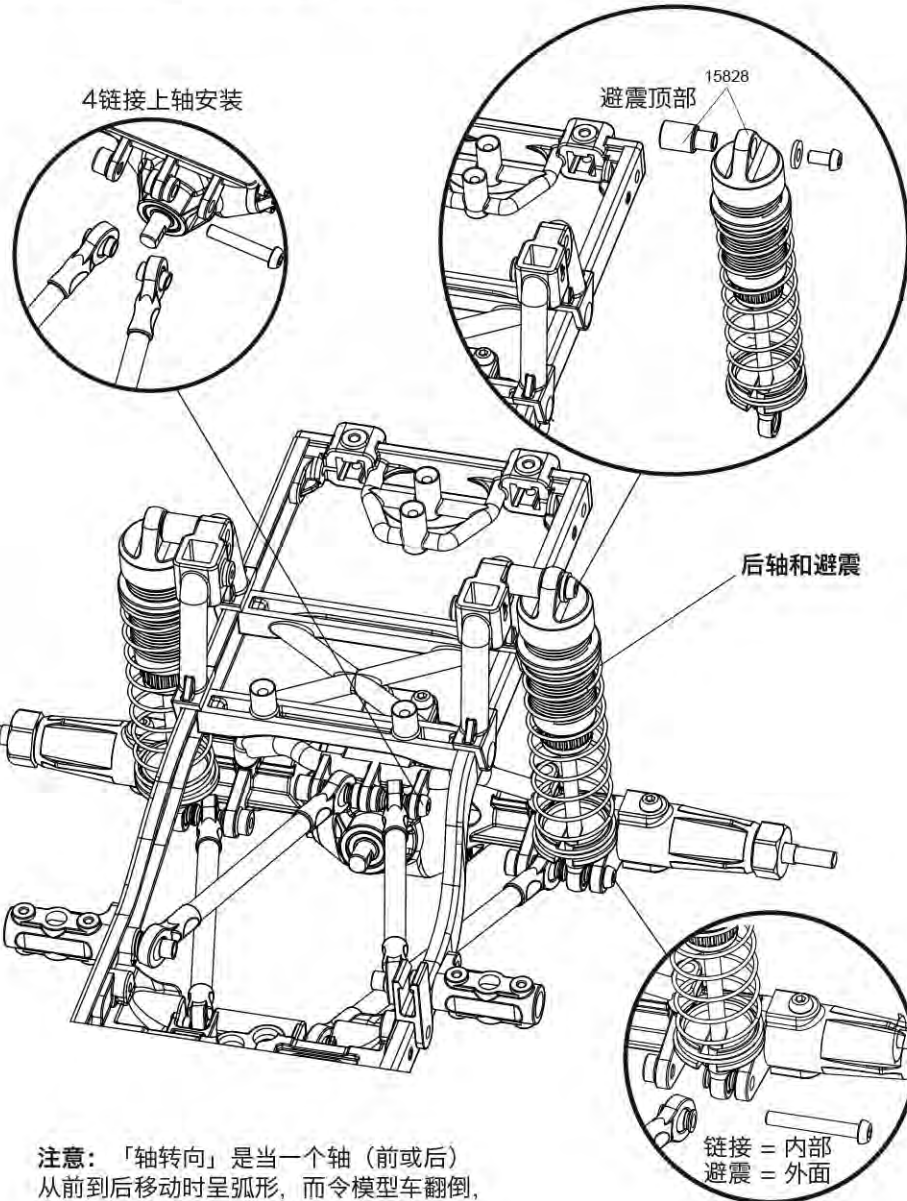

注意：「轴转向」是当一个轴（前或后）
从前到后移动时呈弧形，而令模型车翻倒，
导致不准确及不能预测的操控

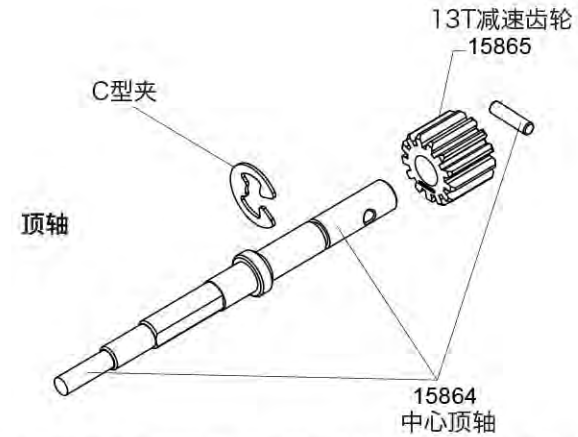

注意：使用套装配置的17T小齿轮及83T减速齿轮，最终传动比是
15:1。这代表电动机的每十五圈，传动系统的驱动会转一次，这
为固定轴（及早轮子和轮胎）提供了下轮速度和大量攀爬扭力。

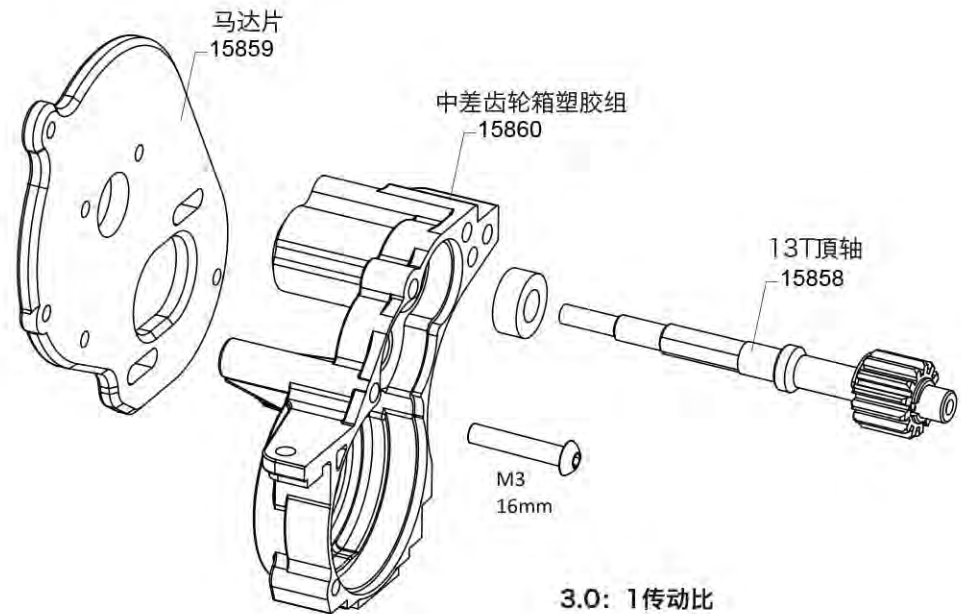

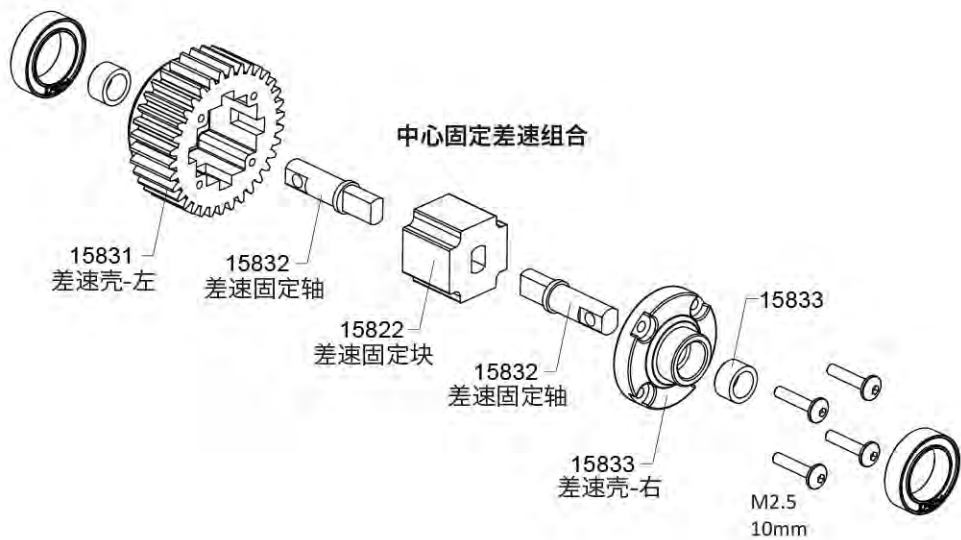

中心固定差速组合

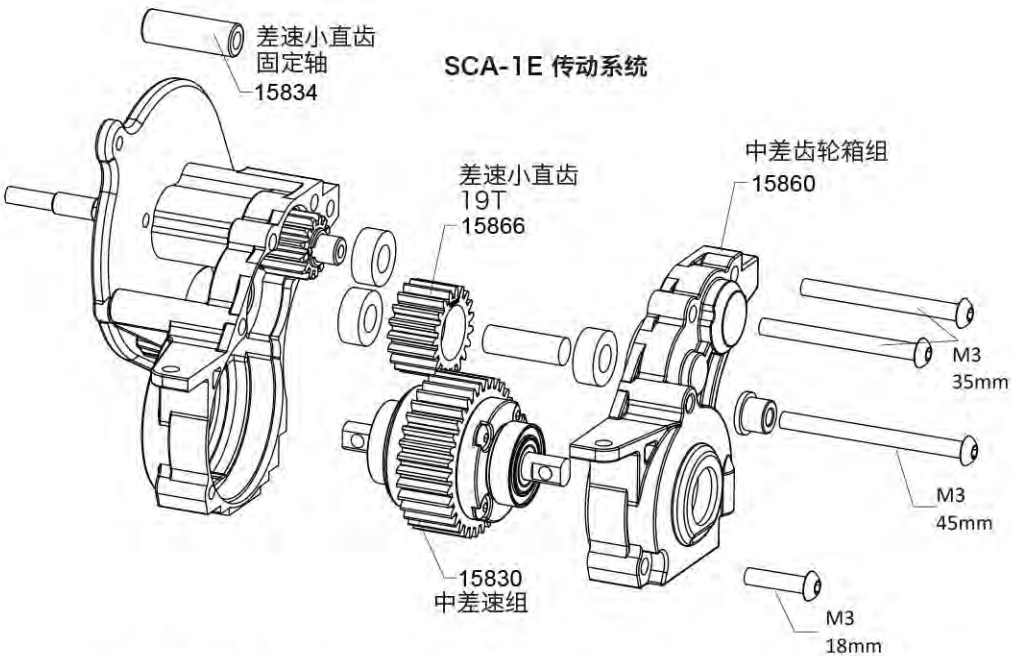

SCA-1E 传动系统

15:1 驾驶比例
套装配备17T小齿轮及83T
减速齿轮 = 15.1 传动比

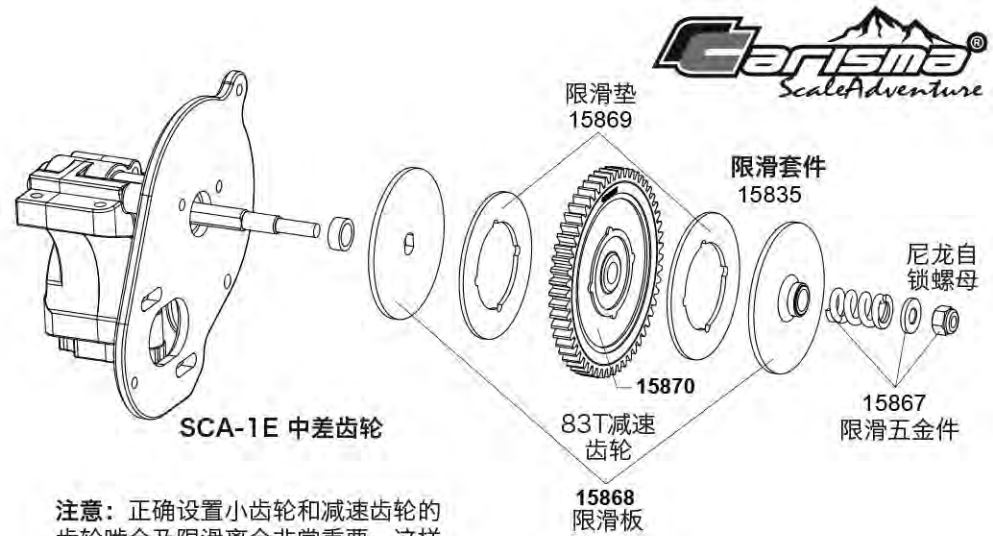

SCA-1E 中差齿轮

注意：正确设置小齿轮和减速齿轮的齿轮啮合及限滑离合非常重要，这样可以令车子顺利运行和保护传动系免受损坏。

齿轮啮合：使用细条打印机或便签纸，把纸条放在小齿轮及减速齿轮中间，然后把它们压在一起，拧紧马达螺栓。把纸张拉出，这样设定齿轮啮合最为完美。

限滑离合：将模型车放在一个如地毯的高拉力表面，利用 M3 Nyloc螺母把限滑弹簧压缩，然后反向转约1.5圈。限滑应该只在模型车在满载下爬行时，传动系统被锁定才会滑动

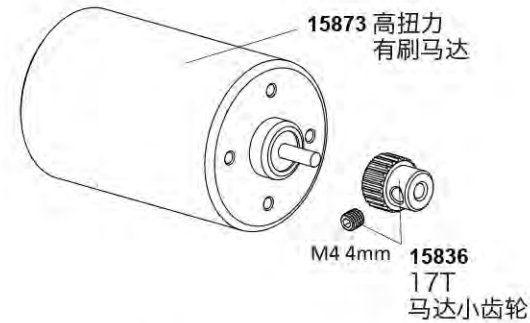

SCA-1E马达及传动系统

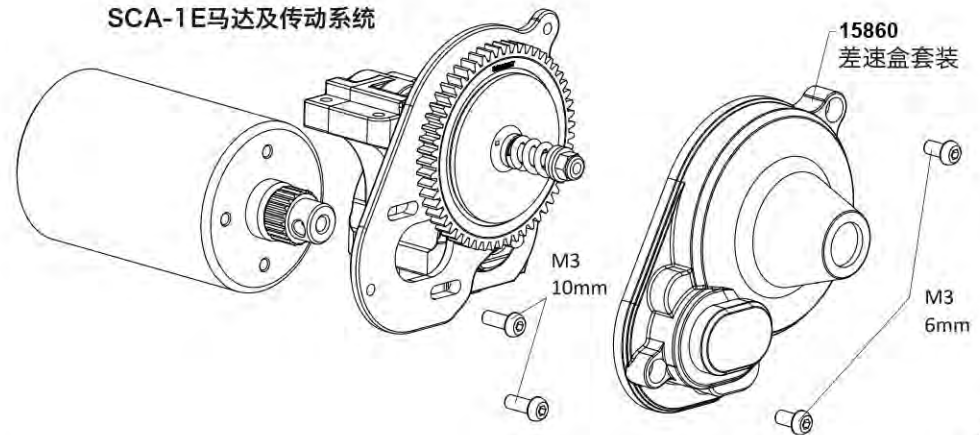

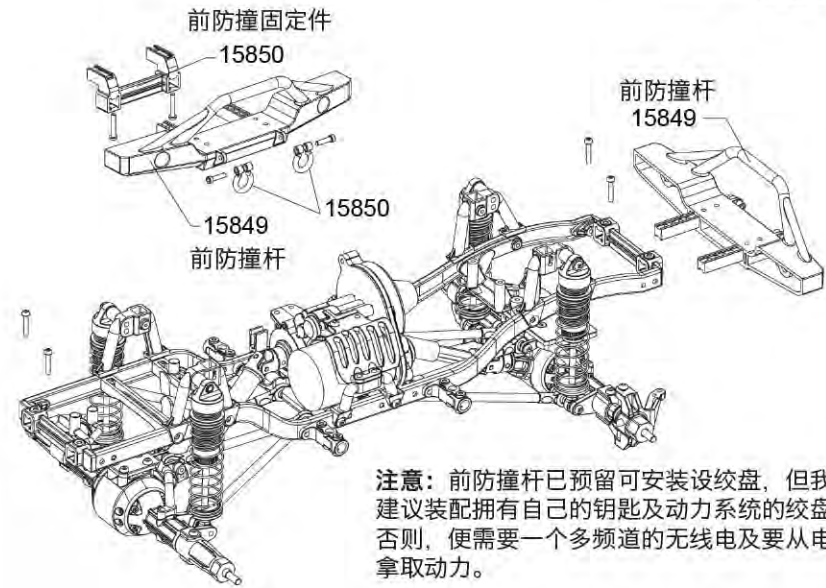
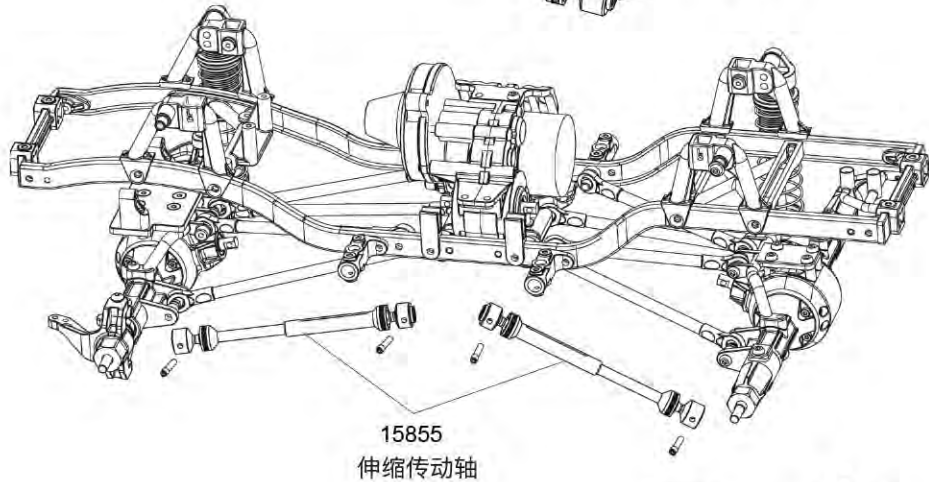
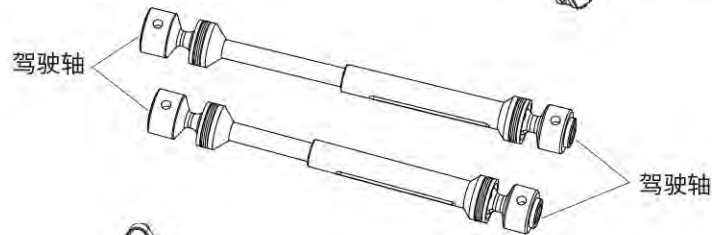
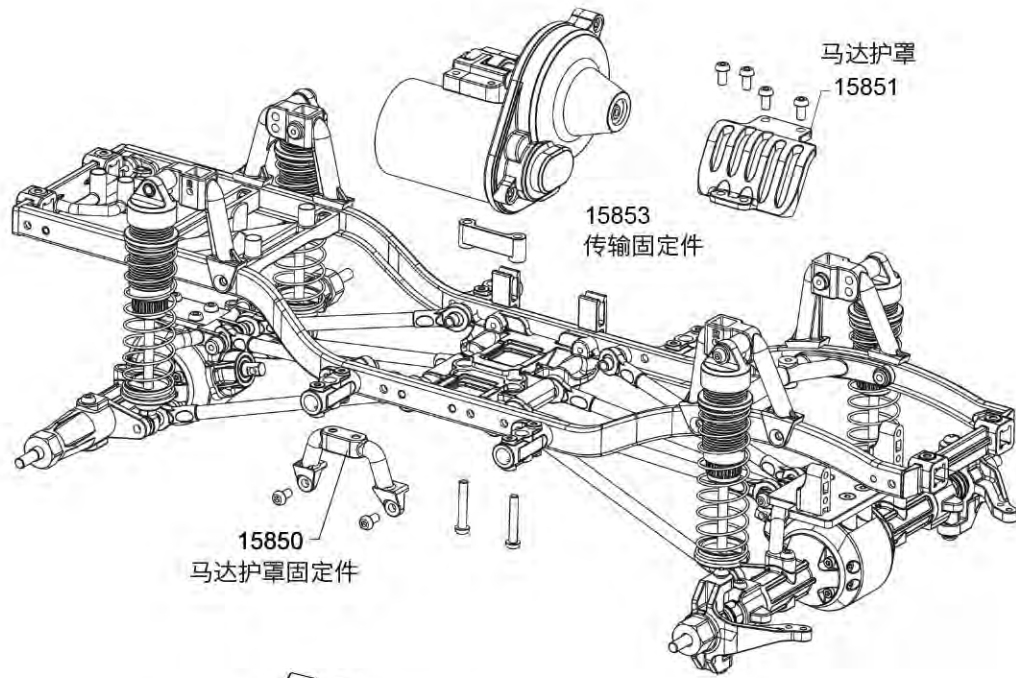

注意：前防撞杆已预留可安装绞盘，但我们建议装配拥有自己的钥匙及动力系统的绞盘。否则，便需要一个多频道的无线电及要从电池拿取动力。

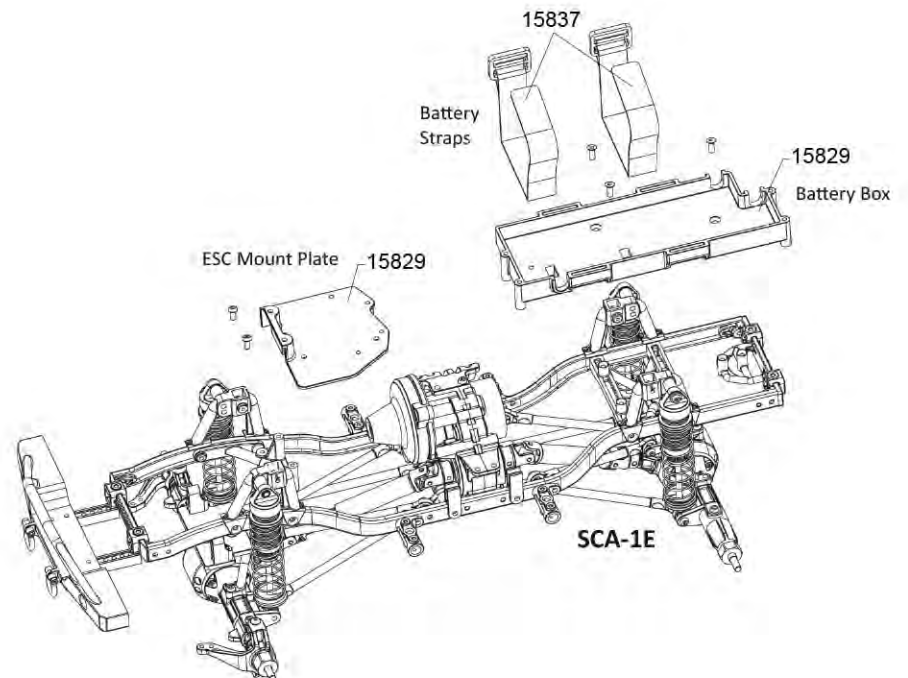

注意：防石保护杆是旨在保护车身，
避免从侧面的确磨损和 使用中的损坏

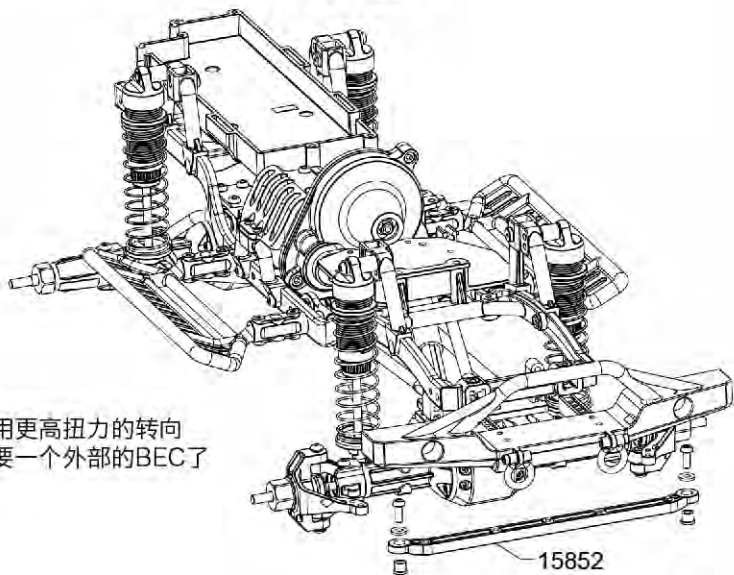
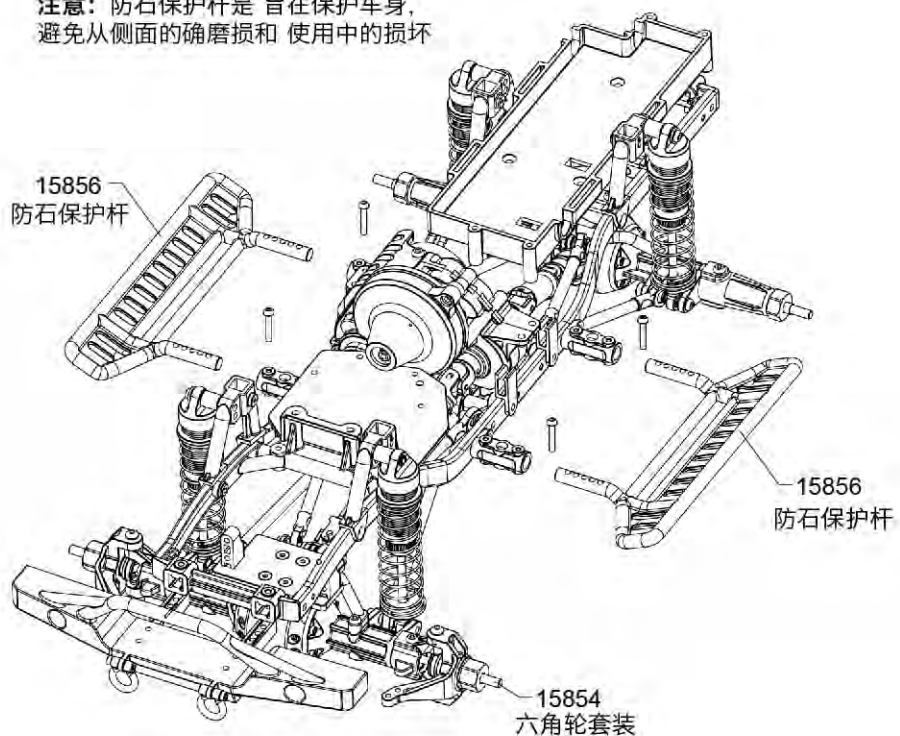

注意：如用户使用更高扭力的转向
伺服，那么就需要一个外部的BEC了

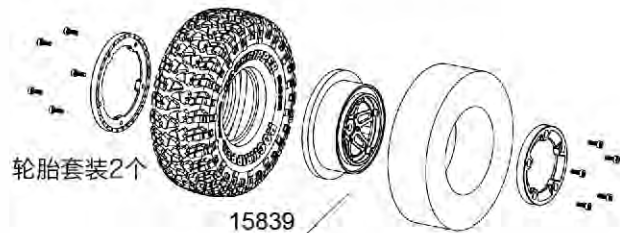
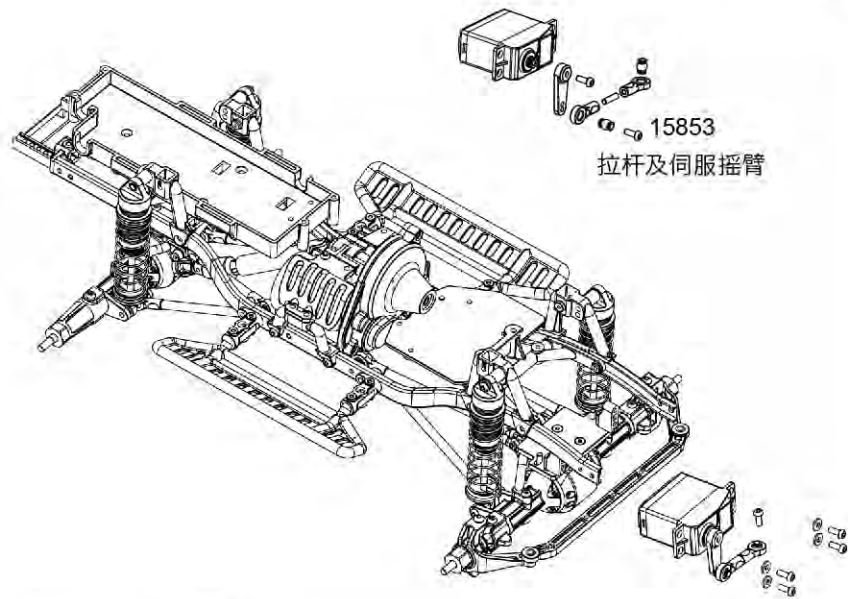

注意：攀岩能力
和重量偏差可以
通过添加额外的
重量到前面车轮
来调整

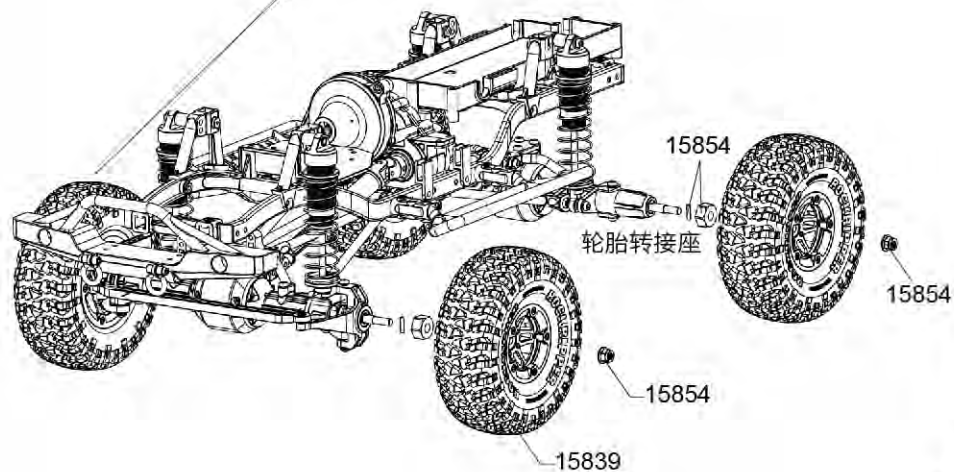

15851 车壳柱及 马达护罩

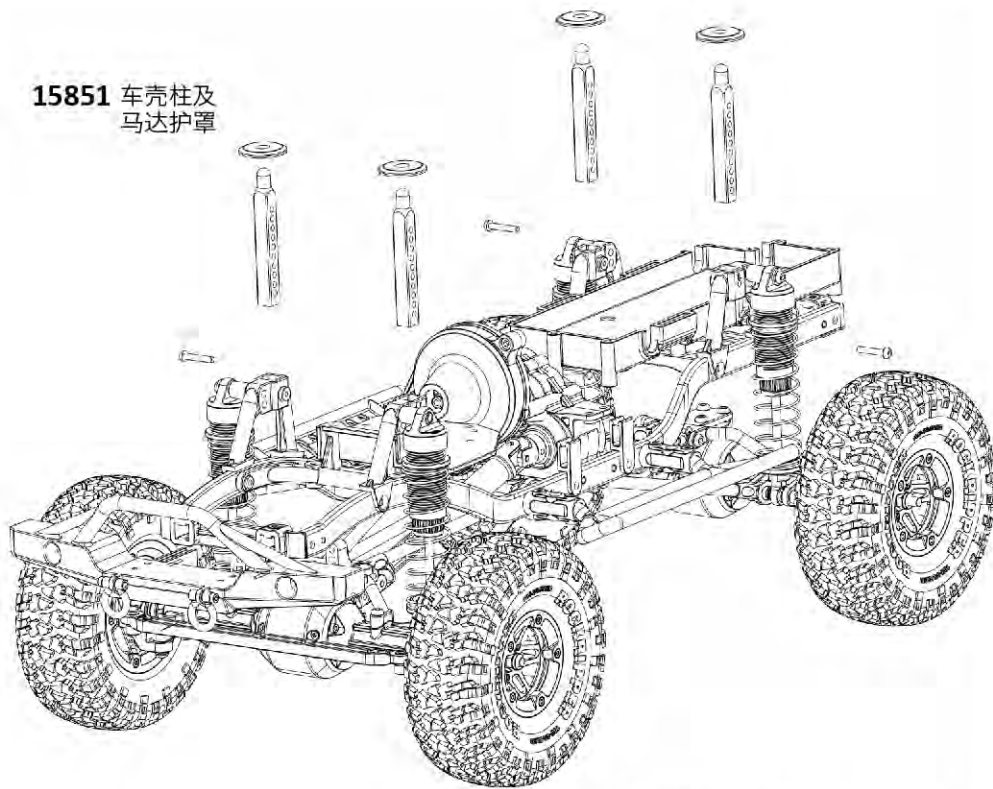

注意：以下是SCA-1E原厂升级配件，
可以加强模型车不同范畴的力量及耐力。

部件 说明

- 15872 铝制后保险杠
- 15873 铝合金圈2套
- 15874 前上链接组件
- 15875 前下链接组件
- 15876 后上链接组件
- 15877 后下链接组件
- 15878 铝电池座
- 15879 铝制伺服臂25T
- 15880 铝制伺服臂24T
- 15881 铝制伺服臂23T
- 15882 铝制抗石架
- 15883 铝制伺服支架

部件 说明

- 15884 铝制伺服座
- 15885 铝制六角轮8mm
- 15886 铝制转向节
- 15887 铝制前端差速器组件
- 15888 铝制后差速器组件
- 15889 铝制转向连杆
- 15890 车身柱+铝制前避震支架
- 15891 车身柱+铝制后避震支架
- 15892 铝制中心差速器
- 15893 铝制防石保护杆固定件
- 15894 铝制ESC安装板+前防震固定件
- 15895 铝制后防震固定件+电池座支架

备件

部件	说明	部件	说明
15820	前及后差速套装	15849	前及后防撞杠套装
15821	39T差速皇冠齿轮	15850	中心差速座
15822	差速锁	15851	车壳柱及马达护罩
15823	差速外壳套件	15852	转向链接
15824	16T差速输入小齿轮	15853	拖拉链和服务器舵角片
15825	前置CVD轴组	15854	六角轮壳结合器
15826	后轮驱动轴	15855	驱动轴
15827	SCA-1E梯形底盘	15856	防石保护杆
15828	油压避震组件	15857	轴承套 (13个5x10x4,6个10x15x4)
15829	电池盒 + ESC安装板	15858	中心顶轴组件 (13T)
15830	中心差速组件	15859	马达板
15831	中心差速外壳 - 左	15860	中心差速外壳套件
15832	中心差速输出轴	15861	前CVD轴
15833	中心差外壳 - 右	15862	前CVD驱动杯
15834	差速小针5 x 14.7	15863	前CVD接头
15835	限滑套装	15864	中心顶轴
15836	马达小齿轮17T	15865	上部减速齿轮13T
15837	电池带	15866	差速惰齿19T
15838	Coyote已着色车身套装	15867	限滑五金套件
15839	轮胎和轮胎组2件	15868	限滑板组
15840	前及后差速外壳	15869	限滑垫
15841	前及后车轴外壳(半边)	15870	减速齿轮83T
15842	后轴锁定	15871	LYNX Wagon LED灯套装
15843	4-Link上部安装件	15872	4链滑板
15844	前转向C杯	15873	高扭力有刷马达
15845	前转向调节轴	15903	Coyote未着色车身套装
15846	伺服座	15917	Y型线束
15847	前及后防撞杠座 + 前及后避震圈	15918	LYNX已着色车身套装
15848	前及后避震及底盘座	15919	LYNX未着色车身套装



15838 Coyote已着色车身套装

SCA-1E设置注意事项

FCC信息

该设备已经过测试，符合B类数字设备，FCC规则15的限制。这些限制旨在对住宅环境提供保护，防止有害干扰。如该设备不依照说明书指示来安装，或会产生并使用及以无线电频率能量辐射发射，可能对无线电通信造成有害干扰。但是，亦不能保证依照安装而不会发生干扰。如果这个设备的开与关对无线电或电视接收造成不良干扰，用户可通过以下一种或多种措施来纠正：

- 调整或重新定位接收天线的方向
- 增加设备与接收机之间的距离
- 连接设备进入不同于接收机连接的电路的插座

FCC警告：

设备可能会产生或使用无线电射频能量。除非在说明手册中明确批准修改，对本设备的更改或修改可能造成有害干扰。未经制造商授权的修改可能会使用户失去操作本设备的权利。这个设备符合FCC规则第15部分的规定。

操作符合以下两个条件

- (1) 本设备不得造成有害干扰。
- (2) 本设备必须接受任何干扰，包括可能导致不良操作的干扰。

有限保修

保修期：Carisma R / C保证SC-1E（“产品”）在顾客购买时将免于原厂出现材料或工艺的缺陷（“保修期”）。

不包括的部份 - 这个保修是不可转让，同时亦不包括

- (a) 人为损坏，
- (b) 由不可抗力的因素造成的损害，意外，误用，滥用，疏忽，商业用途或由于使用不当，安装，运行或维护不当，
- (c) 修改产品的任何部分，
- (d) 以Carisma RC授权服务中心以外的任何人提供服务，或
- (e) 产品于未经Carisma RC授权的经销商处购买。

除上述已叙述保证之外，CARISMA RC不作任何其它保证或声明，

并且不提供任何和所有暗示的保证，包括但不限于暗示

非侵权，适销性和适用于特定用途的保证。购买者确认他们已经确定产品将会满足其预期用途的要求。

Carisma RC将可以选择 (a) 维修或 (b) 将由Carisma RC确定的任何产品替换为买方作出补偿，这是 Carisma RC 的唯一义务和购买者的唯一和排他的补救措施。Carisma RC保留涉及保修索赔和对所有产品检查的权利。服务或替换由Carisma RC自行决定。所有保修都需要采购证明。根据本保证提供的维修或更换是购买者的唯一的补救。

有限责任

CARISMA RC不对特殊的，间接的，偶然的或后果性的损害负责。任何方式的利益或生产或商业上的损失，无论此类索赔是否基于合同，担保，侵权，疏忽，严格责任或任何其它责任理论，即使CARISMA RC曾被告知此类损害的可能性，CARISMA RC亦不会负责。

此外，在任何情况下，Carisma RC的责任在任何情况下均不会超过负责产品的价格。由于Carisma RC无法控制使用，设置，最终装配，修改或误用，Carisma RC将不会对任何由产品导致的伤害而负责。

通过使用，设置或组装的行为，用户必须承担由产品所有造成的责任。如果购买者或用户不准备接受使用相关责任的产品，买方应立即将产品以全新和未使用的状态退回到购买的地方。此保修给您特定的法定权利，您可能因国家或州份还有其它权利。Carisma RC保留在未通知情况下随时更改或修改本保修协议的权利

避震、油重和弹簧：

重量偏差：

马达齿轮和减速齿轮：

限滑离合合理及马达圈数：

其它使用的安装选项：



SCA-1E ★ **COYOTE**

Visit us on www.carisma-shop.com

請到：www.carisma-shop.com

Visitateci su www.carisma-shop.com

Besuchen sie uns auf www.carisma-shop.com

Visitez notre site www.carisma-shop.com

©2017 Carisma. All Rights Reserved. Product specifications are subject to change. Some models shown are prototypes which may vary slightly from what is inside.

©2017 所有權歸 Carisma 所有。產品規格可能有變動。顯示的一些模型是原型，可能與商品內部略有不同。

©2017 Carisma. Tutti i diritti riservati. Le caratteristiche del prodotto sono soggette a modifiche. Alcuni prodotti mostrati sono prototipi e possono differire leggermente da quanto fornito.

©2017 Carisma. Alle Rechte vorbehalten. Die Eigenschaften der Produkte können Änderungen unterliegen. Einige dargestellte Produkte sind Prototypen und können leicht von dem Inhalt unterscheiden.

Copyright 2017 Carisma. Tous droits réservés. Les spécifications du produit peuvent changer. Certains modèles présentés sont des prototypes qui peuvent être légèrement différents du modèle commercialisé.

Printed in China
中國印刷
Stampato in Cina
Gedruckt in China
Imprimé en Chine

