



German Fast Attack Craft S-100 CLASS

05162-0389

© 2019 by REVELL GmbH



Ersatzteile benötigt?

Kein Problem. Einfach den Revell-Service mit Angabe von Artikel- und Teilenummer kontaktieren. Entweder unter service@revell.de oder Revell GmbH, Abteilung X, Henschelstr. 20-30, 32257 Bünde.*

*Wir bitten um Verständnis, dass eine Gewährleistung nur bei aktuellen Artikeln, die im Zeitraum der letzten 24 Monate erworben wurden, übernommen werden kann. Mit der Ersatzteil-Bestellung können Kosten z.B. für Verpackung und Versand entstehen. Ob diese Kosten anfallen wird im Vorfeld schriftlich durch unseren Service mitgeteilt. Das Angebot kann dann angenommen oder abgelehnt werden. Unfrei eingesandte Ersatzteil-Bestellungen werden von uns nicht angenommen! Dieser Direktservice gilt für die Länder Deutschland, Benelux, Österreich, Frankreich, Großbritannien. Ersatzteil-Bestellungen aus den übrigen Ländern werden über die jeweiligen Distributeure abgewickelt. Bitte kontaktieren Sie Ihren Händler.

Need spare parts?

No problem. Contact Revell Service with the item number and part numbers you need: service@revell.de or Revell GmbH, Unit 10, Old Airfield Industrial Estate, Cheddington Lane, Tring, Herts, HP23 4QR, Great Britain.*

*We request your understanding that a warranty can only be accepted for current articles which have been purchased in the last 24 months. Orders for spare parts may also be subject to costs for packaging and shipping. You will be notified in advance by our Service department if such costs are incurred. The offer can then be accepted or rejected. We will not be able to process any postal requests unless correct postage has been applied to mailing! This direct service applies to the countries: Germany, Benelux, Austria, France, and the United Kingdom. Spare part orders from other countries are processed by the local distributors. Please contact your dealer.

Besoin de pièces de rechange?

Il vous suffit de contacter le service Revell et d'indiquer la référence de l'article et de la pièce. Soit en écrivant par mail à france@revell.de (uniquement pour la France) ou par courrier à Revell GmbH, Département X, Henschelstr. 20-30, D-32257 Bünde.*

*La garantie s'applique pour les articles présents au catalogue et achetés au cours des 24 derniers mois. Merci de votre compréhension. La commande de pièces de rechange peut donner lieu à des frais supplémentaires, par ex. pour l'emballage et le port. Notre service client vous en informera au préalable par écrit. Vous pourrez accepter ou refuser le devis. Nous n'acceptons pas les commandes de pièces de rechange envoyées sans affranchissement! Ce service direct est valable pour les pays suivants : Allemagne, Benelux, Autriche, France, Grande-Bretagne. Les commandes de pièces en provenance d'autres pays sont traitées par les distributeurs correspondants. Veuillez contacter votre revendeur.

Hebt u reserveonderdelen nodig?

Geen probleem! Neem eenvoudig contact op met de klantenservice van Revell en geef ons het artikel- en onderdeelnummer door. U kunt ons bereiken op service@revell.de of per post: Revell GmbH, Afdeling X, Henschelstr. 20-30, 32257 Bünde.*

*Wij vragen uw begrip voor de omstandigheid, dat er alleen garantie kan worden geboden voor actuele artikelen, die in de afgelopen 24 maanden zijn gekocht. Met het bestellen van reserveonderdelen kunnen kosten gemoeid zijn, bijv. voor verpakking en verzending. U wordt vooraf schriftelijk door onze klantenservice op de hoogte gesteld als er kosten zouden ontstaan. Het aanbod kan dan worden aangenomen of afgewezen. Wij nemen geen ongefrankeerde bestellingen van reserveonderdelen aan! Deze rechtstreekse service wordt verleend in de landen Duitsland, de Benelux, Oostenrijk, Frankrijk en Groot-Brittannië. Bestellingen van reserveonderdelen in de overige landen worden afgewikkeld via de betreffende distributeurs. Neem hiervoor contact op met uw verkoper.

Verwendete Symbole/Used Symbols

Bitte beachten Sie folgende Symbole, die in den nachfolgenden Baustufen verwendet werden.

Veillez noter les symboles indiqués ci-dessous, qui sont utilisés dans les étapes suivantes du montage.

Sirvase tener en cuenta los símbolos facilitados a continuación, a utilizar en las siguientes fases de construcción.

Si prega di fare attenzione ai seguenti simboli che vengono usati nei susseguenti stadi di costruzione.

Huomioi seuraavat symbolit, joita käytetään seuraavissa kokoonsovituksissa.

Legg merke til symbolene som benyttes i monteringstrinene som følger.

Proszę zwracać na następujące symbole, które są użyte w poniszczych etapach montażowych.

Daha sonraki montaj basamaklarında kullanılacak olan, aşağıdaki kulanmaları lütfen dikkat edin.

Kérjük, hogy a következő szimbólumokat, melyek az alábbi építési fokokban alkalmazásra kerülnek, vegyétek figyelembe.

Please note the following symbols, which are used in the following construction stages.

Neem a.u.b. de volgende symbolen in acht, die in de onderstaande bouwfasen worden gebruikt.

Por favor, preste atención a los símbolos que siguen a continuación, los mismos serán usados en las próximas etapas de montaje.

Observera: Nedanstående piktogram används i de följande arbetsmomenten.

Legg venligst merke til følgende symboler, som benyttes i de følgende byggestrider.

Покажіть увагу на наступні символи, які використовуються в наступних операціях збирання.

Παρακαλώ προσέξτε τα παρακάτω σύμβολα, τα οποία χρησιμοποιούνται στις παρακάτω βήματα συναρμολόγησης.

Dbejte prosím na dále uvedené symboly, které se používají v následujících konstrukčních stupních.

Prosimo za Vašu pozornost na sledeće simbole ki se uporabljajo v naslednjih korakih gradbe.



Kleben
Glue
Coller
Lijmen
Engomar
Colar
Incollare
Limmas
Liimaa
Klæbning
Lim
Клеить
Przykleić
κόλλημα
Yapıştırma
Lepení
ragasztani
Lepiti



Nicht kleben
Don't glue
Ne pas coller
Niet lijmen
No engomar
Não colar
Non incollare
Limmas ej
Älä liimaa
Må ikke klæbes
Ikke lim
Не клеить
Nie przyklejać
μη κολλάτε
Yapıştırma yin
Nem szabad ragasztani
Ne lepiri



Wahlweise
Optional
Facultatif
Naar keuze
No engomar
Número de etapas de trabalho
Facultativo
Valfritt
Valitsoehtoisesti
Efter eget valg
Valgfritt
На выбор
Do wyboru
εναλλακτικά
Seçmeli
Voliteľné
tetszés szerint
nacin izbire



Anzahl der Arbeitsgänge
Number of working steps
Nombre d'étapes de travail
Het aantal bouwstappen
Número de operaciones de trabajo
Número de etapas de trabalho
Numero di passaggi
Antal arbetsmoment
Työväihteiden lukumäärä
Antal arbeidsforløb
Antall arbeidstrinn
Количество операций
Liczba operacji
αριθμός των εργασιών
İş safhalannın sayısı
Počet pracovných operáci
a munkafolyamatok száma
Številka koraka montaže



Abziehbild in Wasser einweichen und anbringen
Soak and apply decals
Mouiller et appliquer les décalcomanies
Transfer in water even laten weken en aanbrengen
Remojar y aplicar las calcomanías
Pôr de molho em água e aplicar o decalque
Immergere in acqua ed applicare decalcomanie
Blöt och fäst dekalerna
Kostuta siirtokuva vedessä ja aseta paikalleen
Overføringsbilledet lægges i blød og anbringes
Dypp bildet i vann og sett det på
Переводную картинку намочить и нанести
Zmęczyć kalkomanie w wodzie a następnie nakleić
βουτήξτε τη χαλκομανία στο νερό και τοποθετήστε την
Çikmatayı suda yumuşatın ve koyun
Otsik namočiti v vodu a umistiti
a matricát vızben beažtatni eš felhelyezni
Preslikač potopiti v vodo in zatem nanašati

1.

Zusammenbau-Reihenfolge
Sequence of assembly
Ordre d'assemblage
Volgorde van montage
Orden de montaje
Ordine di montaggio
Ordem de montagem
Monteringsrekkefølge
Kokoonasjajärjestys
Monteringsföjld
Rækkefølgen af monteringen
Последовательность монтажа
Összeszerelési sorrend
Ακολουθία συναρμολόγησης
Kurmak-Sıra
Kolejność montażu
Vrstni red sestavljanja
Montáž - postup



Bauteile trocknen lassen
Laisser sécher les pièces
Dejar secar las piezas
Deixar secar os componentes
La delene tørke
Allow the parts to dry
Oderdelen laten drogen
Far asciugarsi i componenti
Anna osien kuivua
Låt byggdelarna torka
Lad komponenterne tørre
Czesci pozostawić do wyschnięcia
Yapı parçalarını kurumaya bırakınız
Jednotlivé díly nechte zaschnout
Αφήστε τα μέρη να στεγνώσουν
Alkatrészeket hagyja száradni
Pustite da sestavni deli posušijo
Дать деталям высохнуть



Klebeband
Adhesive tape
Dévidoir de ruban adhésif
Plakband
Cinta adhesiva
Fita adesiva
Nastro adesivo
Tejp
Teippi
Tape
Tape
Клейкая лента
Taśma klejąca
κολλητική ταινία
Yapıştırma bandı
Lepící páska
ragasztószalag
Traka z lepilom



Mit einem Messer abtrennen
Detach with knife
Détacher au couteau
Met een mesje afsnijden
Separarlo con un cuchillo
Separar utilizando uma faca
Staccare col coltello
Skär loss med kniv
Irrota veitsellä
Adskilles med en kniv
Skjær av med en kniv
Отделять ножом
Odciać nożem
διαχωρίζετε με ένα μαχαίρι
Bir bıçak ile kesin
Oddélit pomocí nože
kés segítségével leválasztani
Odelilit z nožem



Abbildung zusammengesetzter Teile
Illustration of assembled parts
Figure représentant les pièces assemblées
Afbeelding van samengevoegde onderdelen
Ilustración piezas ensambladas
Figura representando peças encaixadas
Illustrazione delle parti assemblate
Bildet visar dalarna hopsatta
Kuva yhteenliitetystä osista
Illustration af sammensatte dele
Illustrasjon, sammensatte deler
Изображение смонтированных деталей
Rysunek złożonych części
απεικόνιση των συναρμολογημένων εξαρτημάτων
Birleştirilen parçaların şekli
Zobrazení sestavených dílů
összeállított alkatrészek ábrája
Slika slopljenega dela



Loch bohren
Make a hole
Faire un trou
Maak een gat
Practicar un taladro
Perforar
Fare un foro
Borra hål
Poraa reikä
Der bores et hul
Bor hull
Просверлить отверстие
wywiercić otwór
ανοίξτε τρύπα
Delik açın
Vyvrat díru
lyukat fúrni
Narediti lukinjo



Gleichen Vorgang auf der gegenüberliegenden Seite wiederholen
Repeat same procedure on opposite side
Opérer de la même façon sur l'autre face
Dezelfde handeling herhalen aan de tegenoverliggende kant
Realizar el mismo procedimiento en el lado opuesto
Repetir o mesmo procedimento utilizado no lado oposto
Stessa procedura sul lato opposto
Upprepa proceduren på motsatta sidan
Toista sama toimenpide kullen viereisellä sivulla
Det samme arbejdet gentages på den modsatte liggende side
Gjenta prosedyren på siden tvers overfor
Повторять такую же операцию на противоположной стороне
Taki sam przebieg czynności powtórz na stronie przeciwnej
επανάλαβε την ίδια διαδικασία στην απέναντι πλευρά
Aynı işlemi karşı tarafta tekrarlayın
Stejný postup zopakovat na protilehlé straně
ugyanazt a folyamatot a szemben található oldalon megismételni
Isti postopek ponoviti in na suprotni strani



Schwarzen Faden benutzen
Use black thread
Employer le fil noir
Gebruik zwarte draad
Utilizar hilo color negro
Utilizar fio preto
Usare filo nero
Använd svart tråd
Käytä mustaa lankaa
Benyt en sort
Bruk svart
Использовать черные нитки
Użyć czarne nici
χρησιμοποιήστε την καφέ μαύρου
Kahverengi siyah iplik kullanın
Použit černé vlákno
barna fekete fonalat kell használni
Uporabljati črni nit



Anknolen and Kleben
Tie and Glue
Attacher et Coller
Vastknopen en Lijmen
Atar y Engomar
Anudar e Colar
Annodare e Incollare
Knyt fast och Limmas
Solmi ja Liimaa
Bindes fast og Klæbning
Knyt og Lim
Связать узлом И Клеить
Przywiązać oraz Przykleić
κομποδέστε και κόλλημα
Düğümleyin ve Yapıştırma
Nauzlit a Lepení
megcsomózni és ragasztani
Zavezati in Lepiti



Zur Anbringung der Abziehbilder empfohlen
Recommended for affixing the decals
Recommandé pour l'application des décalcomanies
Aanbevelen voor het aanbrengen van de transfers
Recomendado para fijar las calcas
Posição recomendada para aplicar os decalques
Raccomandato per applicare le decalcomanie
Rekommenderas för montering av dekaler
Anbefales til påsætning og placering af decals
Рекомендується використовувати для фіксації переводних картинок на поверхності моделі
Zalecane do nanoszenia kalkomanii
Připorodljivo za pritrdjevanje nalepk
Odporúčané na zlepenie prínavostní nálepiek
RECOMANDAT PENTRU APLICAREA ACTIBILURILOR
Подходящо за фиксация на картинко върху повърхността на модела

* Nicht enthalten
Not included
Non fourni

Behoort niet tot de levering
No included
Non compresi

Não incluído
Ikke medsendt
İngår ej

Ikke inkluderet
Eivät sisälly
Δεν συμπεριλαμβάνεται

He содержится
Nem tartalmazza
Nie zawiera

Ni vsebovano
Igerisinde bulunmamaktadır
Neni obsazeno

D: Beiliegenden Sicherheitstext beachten und nachschlagebereit halten.

E: Please note the enclosed safety advice and keep safe for later reference.

F: Respecter les consignes de sécurité ci-jointes et les conserver à portée de main.

NL: Houdt u aan de bijgaande veiligheidsinstructies en hou deze steeds bij de hand.

E: Observar y siempre tener a disposición este texto de seguridad adjunto.

I. Seguire le avvertenze di sicurezza allegate e tenerle a portata di mano.

P: Ter em atenção o texto de segurança anexo e guard-lo para consulta.

S: Beakta bifogad säkerhetstext och håll den i beredskap.

FIN: Huomioi ja säilytä ohjeistukset.

DK: Overhold vedlagte sikkerhedsanvisninger og hav dem liggende i nærheden.

N: Ha alltid vedlagt sikkerhetstekst klar til bruk.

RUS: Соблюдать прилагаемый текст по технике безопасности, хранить его в

легко доступном месте.

PL: Stosować się do załączonych karty bezpieczeństwa i mieć ją stale do wglądu.

GR: ροσ έτε τις συνημμ νεσ υποδείξεις ασ άλειας και υλέξετε τις τσι όστε

να τις χ τε πάντα σε διαθ ση ασ.

TR: Ekteki edginlik talimatlarini dikkate alip, bakabileceginiz bir sekilde muafaza ediniz.

CZ: Dbejte na pfilolen' bezpeanostni text a mujte jej pfipraven' na dosah.

H: A mellékelt biztonsg-i szöveget vegye figyelembe és tartsa fellapoz-sra készen!

SL0: Pridolena varnostna navodila izvajajte in jih hranite na vsem dostopnem mestu.

Benötigte Farben/Used Colours

Benötigte Farben
Required coloursPeintures nécessaires
Benodigde kleurenPinturas necesarias
Tintas necessáriasColori necessari
Använda färgerTarvittavat värit
Du trenger følgende fargerNødvendige farger
Необходимые краскиPotrzebne kolory
Απαιτούμενα χρώματαGerekli renkler
Potřebné barvySzükséges színek
Potrebne barve

A

ocker, matt 88
ochre brown, matt
ocre, mat
oker, mat
ocre, mate
ocra, fosco
ocra, opaco
ockra, matt
okra (keltamulta), himmeä
okker, mat
oker, matt
охра, матовый
ochra, matowy
ώκρα, ματ
koyu kavunçi, mat
okrově žlutá, matná
okker, matt
oker, mat

B

braun, matt 85
brown, matt
brun, mat
bruin, mat
marrón, mate
castanho, fosco
marrone, opaco
brun, matt
ruskea, himmeä
brun, mat
brun, matt
коричневый, матовый
brązowy, matowy
καφέ, ματ
kahverengi, mat
hnědá, matná
barna, matt
rjava, mat

C

staubgrau, matt 77
dust grey, matt
gris poussière, mat
stofgrijs, mat
ceniciento, mate
cinzento de pó, fosco
grigio sabbia, opaco
dammgrå, matt
pölynharmaa, himmeä
støvgrå, mat
støvgrå, matt
серый пыльный, матовый
szary kurz, matowy
χρώμα σκόνης, ματ
toz grisi, mat
prachově šedá, matná
porszürke, matt
prah siva, mat

D

messing, metallic 92
brass, metallic
laiton, métalique
messing, metallic
latón, metalizado
latão, metálico
ottone, metallico
mässing, metallic
messinki, metallikiilto
messing, metallak
messing, metallic
латунный, металл
mosiądz, metaliczny
ορείχαλκου, μεταλλικό
pirinç, metalik
mosazná, metaliza
sárgaréz, metáll
mesing, metalik

E

steingrau, matt 75
stone grey, matt
gris pierre, mat
steengrijs, mat
gris pizarra, mate
cinzento pedra, fosco
grigio roccia, opaco
stengrå, matt
kivenharmaa, himmeä
stengrå, mat
steingrå, matt
серый каменный, матовый
szary kamien., matowy
γκρι πέτρας, ματ
taş grisi, mat
kamenně šedá, matná
kőszürke, matt
kamen siva, mat

F

anthrazit, matt 9
anthracite grey, matt
anthracite, mat
antraciet, mat
antracita, mate
antracite, fosco
antracite, opaco
antracit, matt
antrasiitti, himmeä
koksgrå, mat
antrasitt, matt
антрацит, матовый
ανθρακί, ματ
antrasit, mat
antracit, matná
antracit, matt
tamno siva, mat

50% G 50%

grau, matt 57 + weiß, matt 5
grey, matt
gris, mat
grijs, mat
gris, mate
cinzento, fosco
grigio, opaco
grå, matt
harmaa, himmeä
grå, mat
grå, matt
серый, матовый
szary, matowy
γκρι, ματ
gri, mat
šedá, matná
szürke, matt
siva, mat
white, matt
blanc, mat
wit, mat
blanco, mate
branco, fosco
bianco, opaco
vit, matt
valkoinen, himmeä
hvid, mat
hvit, matt
белый, матовый
biały, matowy
λευκό, ματ
beyaz, mat
bílá, matná
fehér, matt
bela, mat

70% H 30%

rost, matt 83 + eisen, metallic 91
rust, matt
rouille, mat
roest, mat
orín, mate
ferrugem, fosco
color ruggine, opaco
rost, matt
ruoste, himmeä
rust, mat
rust, matt
ржавчина, матовый
rdzawy, matowy
χρώμα σκουριάς, ματ
pas rengi, mat
rezavá, matná
rozsvda, matt
rjava, mat
steel, metallic
coloris fer, métalique
ijzerkleurig, metallic
ferroso, metalizado
ferro, metálico
ferro, metallico
järnfärg, metallic
teräksenvärinen, metallikiilto
jern, metallak
jern, metallic
стальной, металл
żelazo, metaliczny
σιδήρου, μεταλλικό
demir, metalik
železná, metaliza
vas, metáll
železna, metalik

I

feuerrot, seidenmatt 330
fiery red, silky-matt
rouge feu, satiné mat
rood helder, zijdemat
rojo fuego, mate seda
vermelho vivo, fosco sedoso
rosso fuoco, opaco seta
eldrød, sidenmatt
tulipunainen, silkinhimeä
ildrød, silkematt
ildrød, silkematt
огненно-красный, шелк.-матовый
czerwony ognisty, jedwabisto-mat.
κόκκινο φωτιάς, μεταξωτό ματ
ateş kırmızısı, ipek mat
ohnivě červená, hedvábně matná
tűzpiros, selyemmatt
ogenj rdeča, svila mat

J

seegrün, matt 48
sea green, matt
vert d'eau, mat
zeegroen, mat
verde mar, mate
verde-mar, fosco
verde lago, opaco
havsgrün, matt
merenvihreä, himmeä
havgrøn, mat
sjøgrønn, matt
зеленый морской, матовый
zieleń morska, matowy
πράσινο λίμνης, ματ
göl yeşili, mat
mořská zelená, matná
tengerzöld, matt
morsko zelena, mat

K

weiß, matt 5
white, matt
blanc, mat
wit, mat
blanco, mate
branco, fosco
bianco, opaco
vit, matt
valkoinen, himmeä
hvid, mat
hvit, matt
белый, матовый
biały, matowy
λευκό, ματ
beyaz, mat
bílá, matná
fehér, matt
bela, mat

L

karminrot, matt 36
carmin red, matt
rouge carmin, mat
karmijnrood, mat
carmin, mate
vermelho carmin, fosco
rosso carminio, opaco
karminrød, matt
karmiiniinpunainen, himmeä
karminrød, mat
karminrød, matt
красный кармин, матовый
karminowy, matowy
κόκκινο δαϊήαδ, ματ
lâl rengi, mat
krbově červená, matná
kárminpiros, matt
šminka rdeča, mat

90% M 10%

gelb, matt 15 + grau, matt 57
yellow, matt
jaune, mat
geel, mat
amarillo, mate
amarelo, fosco
giallo, opaco
gul, matt
keltainen, himmeä
gul, mat
gul, matt
желтый, матовый
zólty, matowy
κίτρινο, ματ
sari, mat
žlutá, matná
sárga, matt
rumena, mat
grey, matt
gris, mat
grijs, mat
gris, mate
cinzento, fosco
grigio, opaco
grå, matt
harmaa, himmeä
grå, mat
grå, matt
серый, матовый
szary, matowy
γκρι, ματ
gri, mat
šedá, matná
szürke, matt
siva, mat

Benötigte Farben/Used Colours

Benötigte Farben
Required coloursPeintures nécessaires
Benodigde kleurenPinturas necesarias
Tintas necessáriasColori necessari
Använda färgerTavittavat värit
Du trenger følgende fargerNødvendige farger
Необходимые краскиPotrzebne kolory
Απαιτούμενα χρώματαGerekli renkler
Potřebné barvySzükséges színek.
Potrebne barve70%  30%

anthrazit, matt 9 + eisen, metallic 91
anthracite grey, matt steel, metallic
anthracite, mat coloris fer, métalique
antraciet, mat ijzerkleurig, metallic
antracita, mate ferroso, metalizado
antracite, fosco ferro, metálico
antracite, opaco ferro, metálico
antracit, matt järnfärg, metallic
antrasiitti, himmeä teräksenvärinen, metallikiilto
koksgrå, mat jern, metallak
antrasitt, matt jern, metallic
антрацит, матовый стальной, металл
antracyt, matowy żelazo, metaliczny
ανθρακί, ματ σιδήρου, μεταλλικό
antrasit, mat demir, metalik
antracit, matná železná, metalíza
antracit, matt vas, metáll
tamno siva, mat železna, metalik



eisen, metallic 91
steel, metallic
coloris fer, métalique
ijzerkleurig, metallic
ferroso, metalizado
ferro, metálico
ferro, metálico
järnfärg, metallic
teräksenvärinen, metallikiilto
jern, metallak
jern, metallic
стальной, металл
żelazo, metaliczny
σιδήρου, μεταλλικό
demir, metalik
železná, metalíza
vas, metáll
železna, metalik



braun, seidenmatt 381
brown, silky-matt
brun, satiné mat
bruin, zijdemat
marrón, mate seda
castanho, fosco sedoso
marrone, opaco seta
brun, sidenmatt
ruskea, silkinhimeä
brun, silkemat
brun, silkemat
коричневый, шелковисто-матовый
brązowy, jedwabisto-matowy
καφέ, μεταξωτό ματ
kahverengi, ipek mat
hnědá, hedvábně matná
bama, selyemmatt
rjava, svila mat



kupfer, metallic 93
copper, metallic
cuivre, métalique
koper, metallic
cobre, metalizado
cobre, metálico
rame, metálico
koppar, metallic
kupari, metallikiilto
kobber, metallak
kobber, metallic
медный, металл
miedź, metaliczny
χάλκινο, μεταλλικό
bakır, metalik
měděná, metalíza
vörösréz, metáll
baker, metalik

70%  30%

aluminium, metallic 99 + kupfer, metallic 93
aluminium, metallic copper, metallic
aluminium, métalique cuivre, métalique
aluminium, metallic koper, metallic
aluminio, metalizado cobre, metalizado
aluminio, metálico cobre, metálico
aluminio, metálico rame, metálico
aluminium, metallic koppar, metallic
alumiini, metallikiilto kupari, metallikiilto
aluminium, metallak kobber, metallak
aluminium, metallic kobber, metallic
алюминиевый, металл медный, металл
aluminium, metaliczny miedź, metaliczny
αλουμινίου, μεταλλικό χάλκινο, μεταλλικό
alüminyum, metalik bakır, metalik
hliníková, metalíza měděná, metalíza
aluminium, metáll vörösréz, metáll
aluminium, metalik baker, metalik

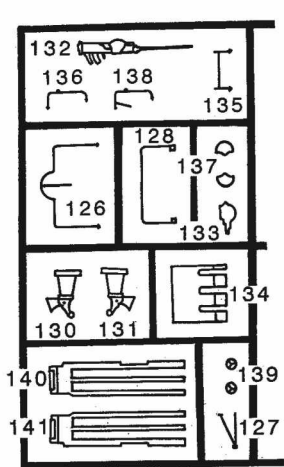
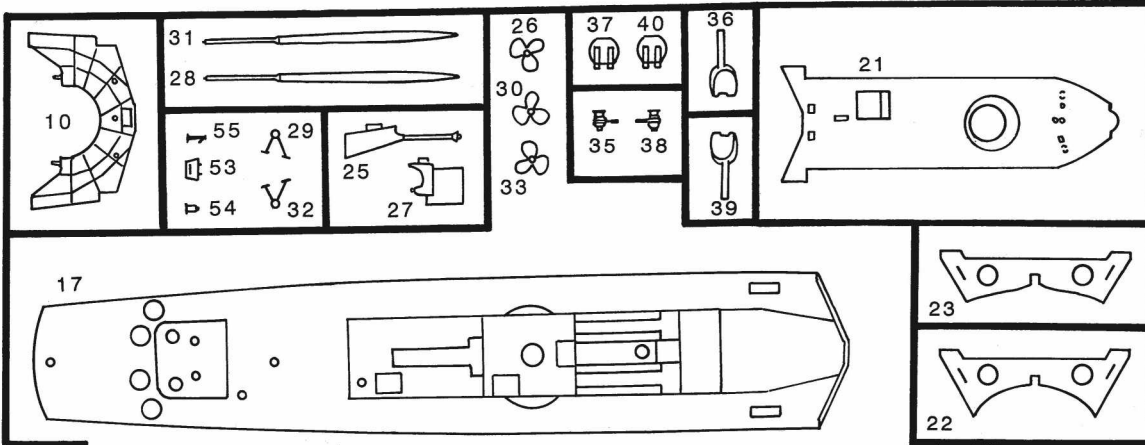
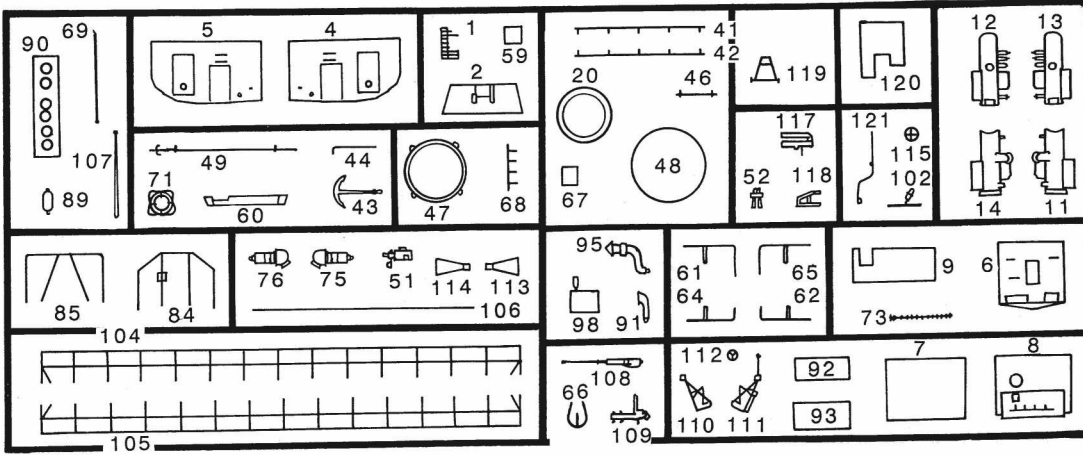

2x

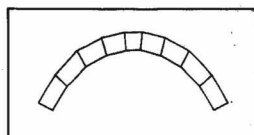
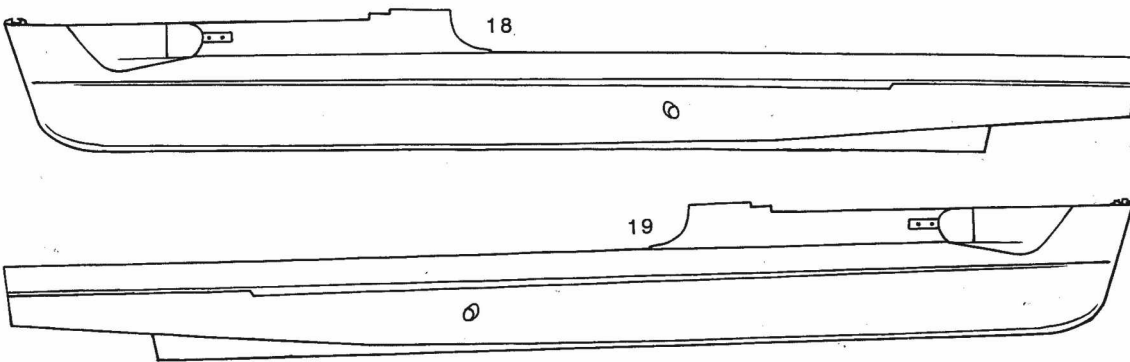
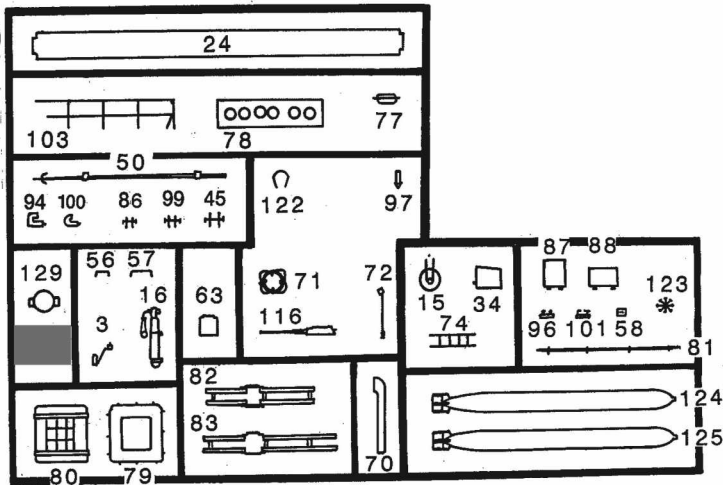

Fensterfolie
Window Sheet

Nicht benötigte Teile
 Parts not used
 Pièces non utilisées
 Niet benodigde onderdelen
 Piezas no necesarias
 Peças não utilizadas
 Parti non usate
 Inte används delar
 Tarpeettomat osat
 Ikke nødvendige dele
 Dele som ikke er nødvendige
 Неиспользованные детали
 Elementy niepotrzebne
 μη χρειαζόμενα εξαρτήματα
 Gereksiz parçalar
 Nepotrebné diely
 fel nem használt alkatrészek
 Nepotrebni deli

1 

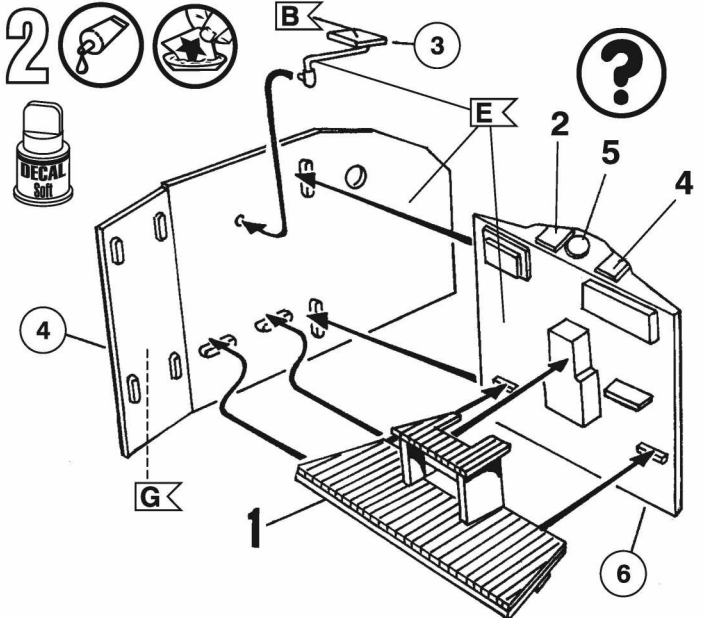
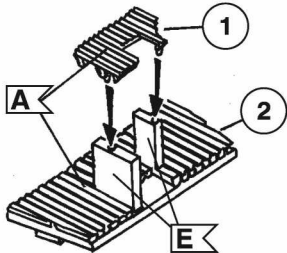

3 

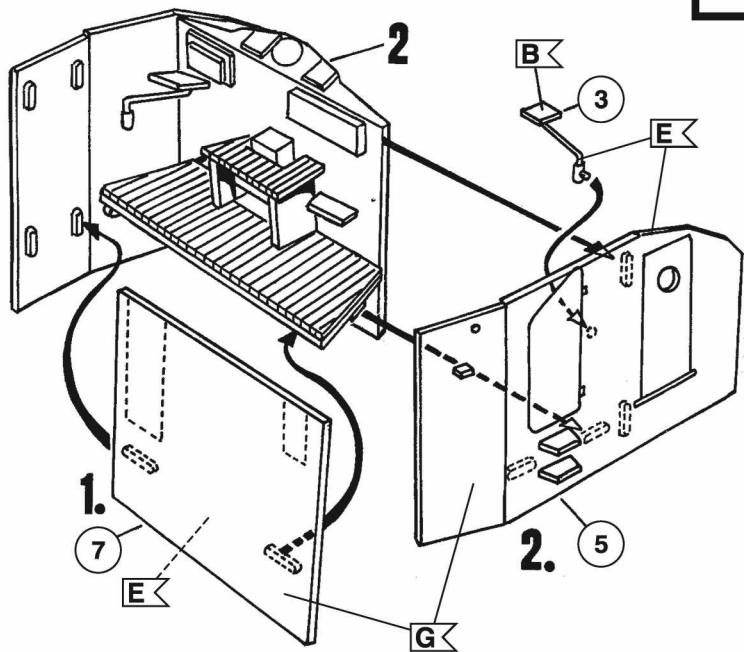

4 

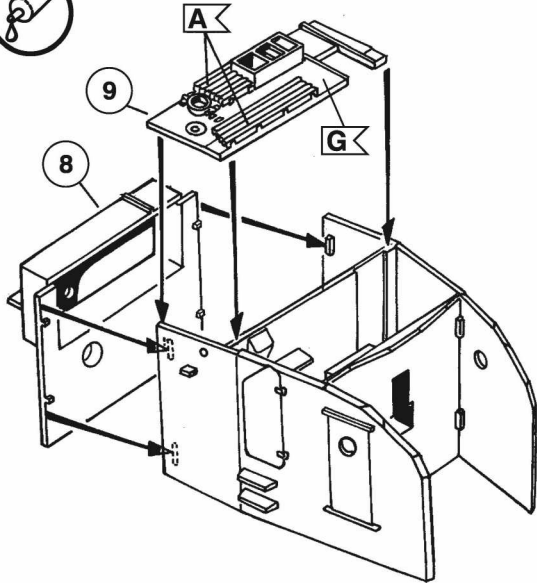

5 

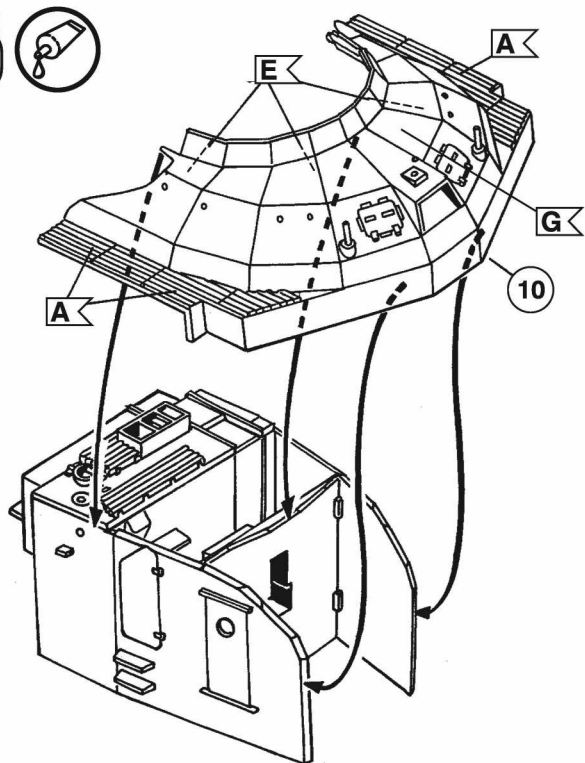

6 

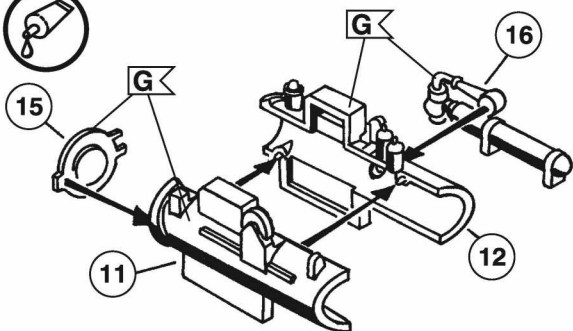

7 

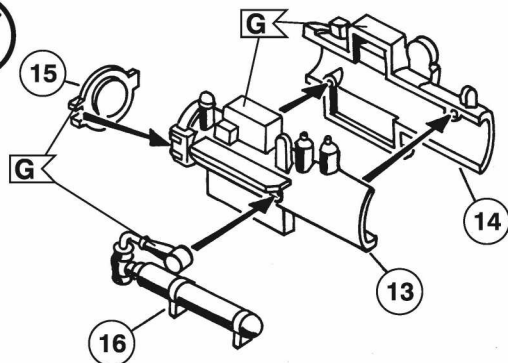

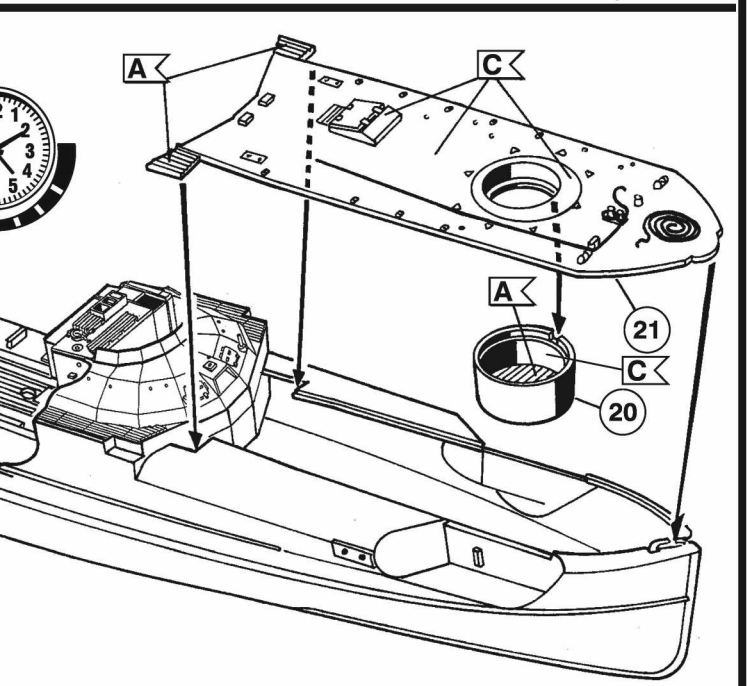
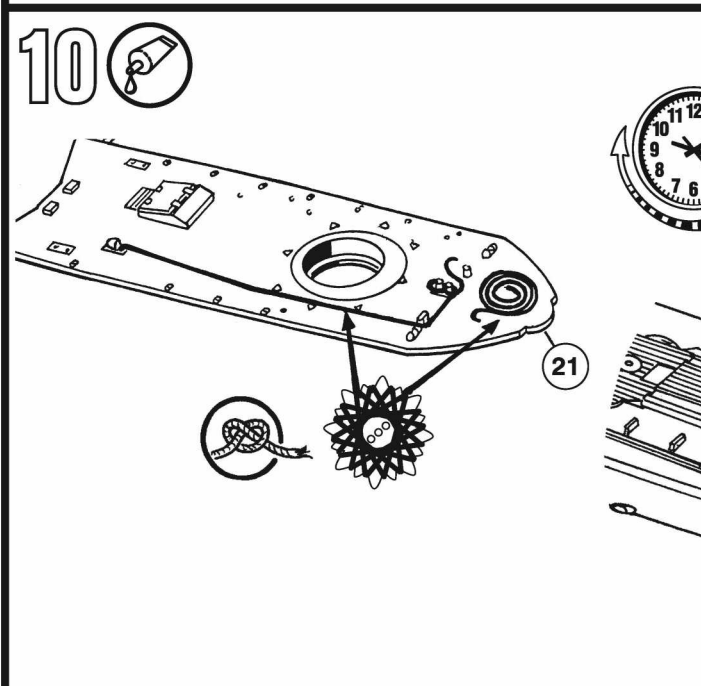
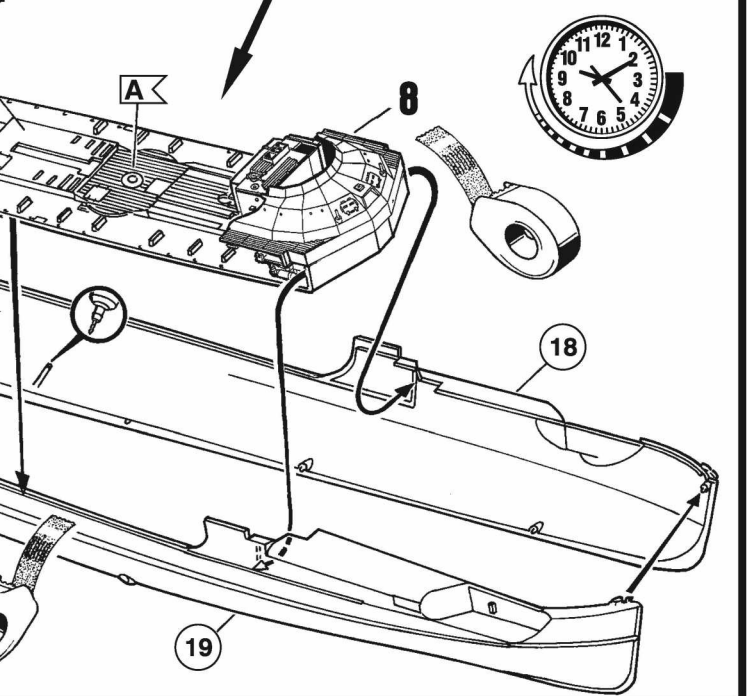
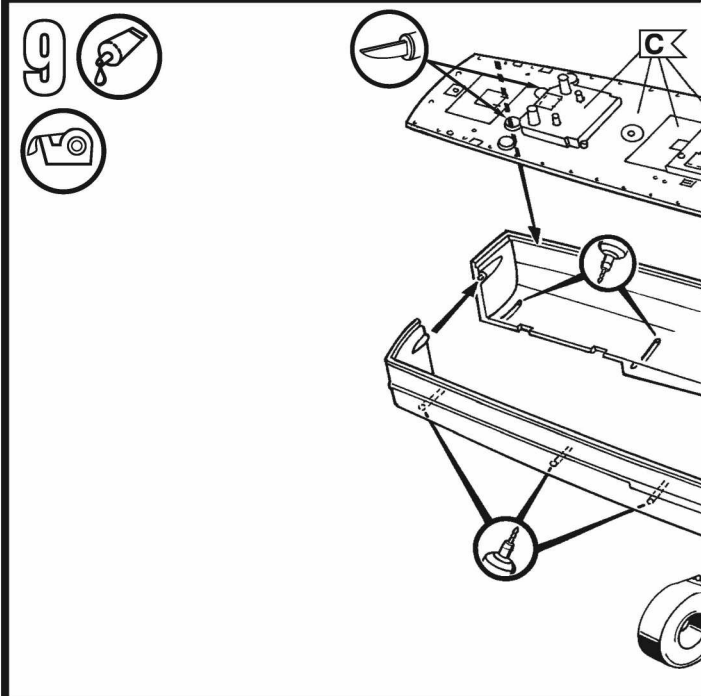
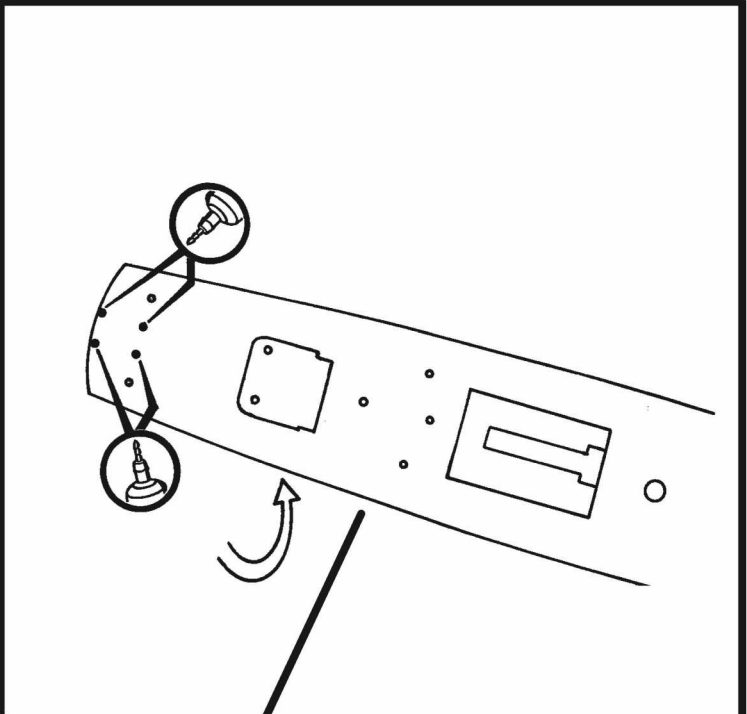
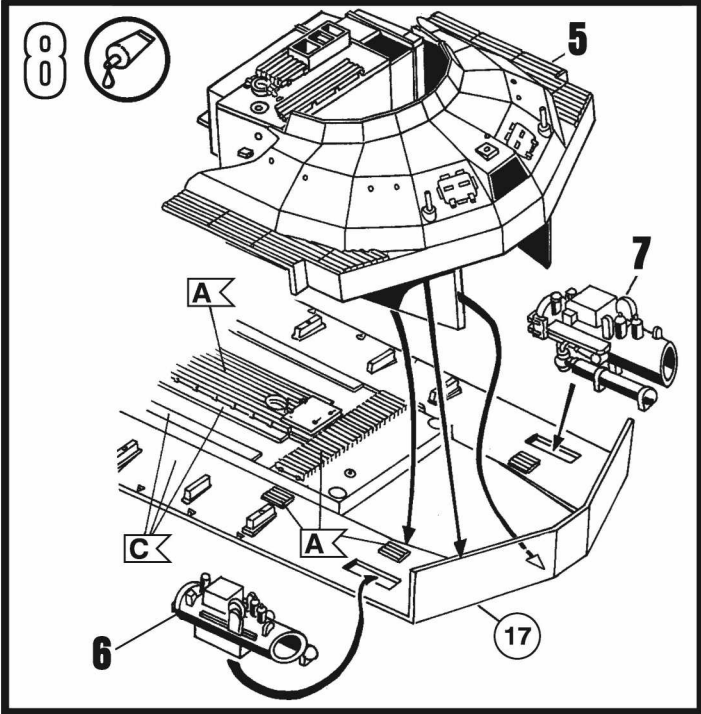

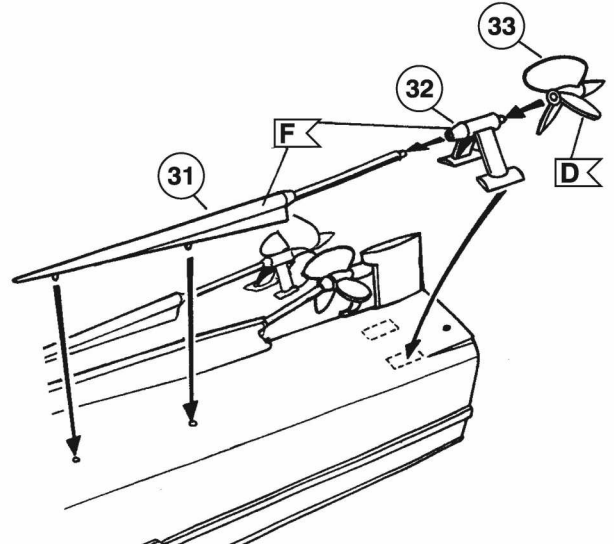
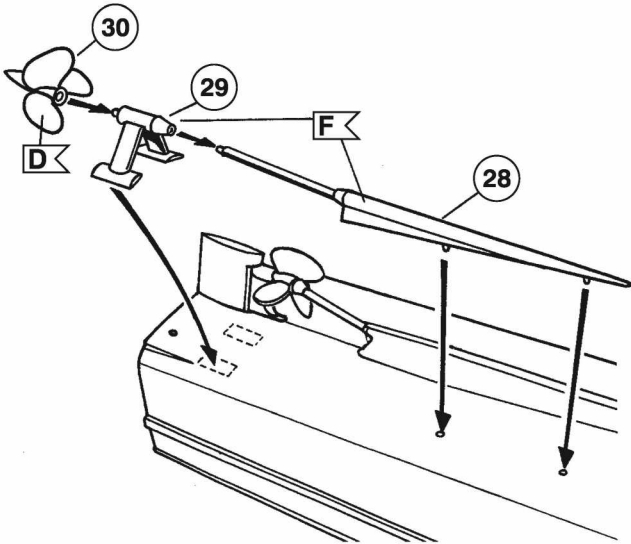
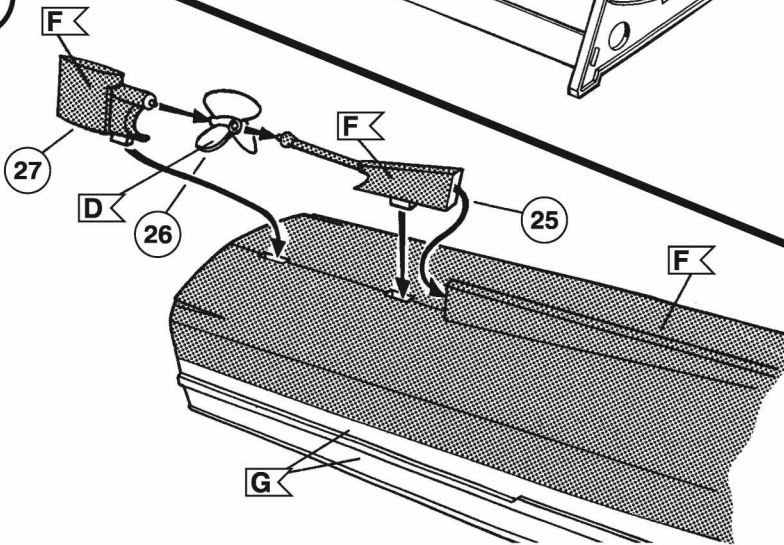
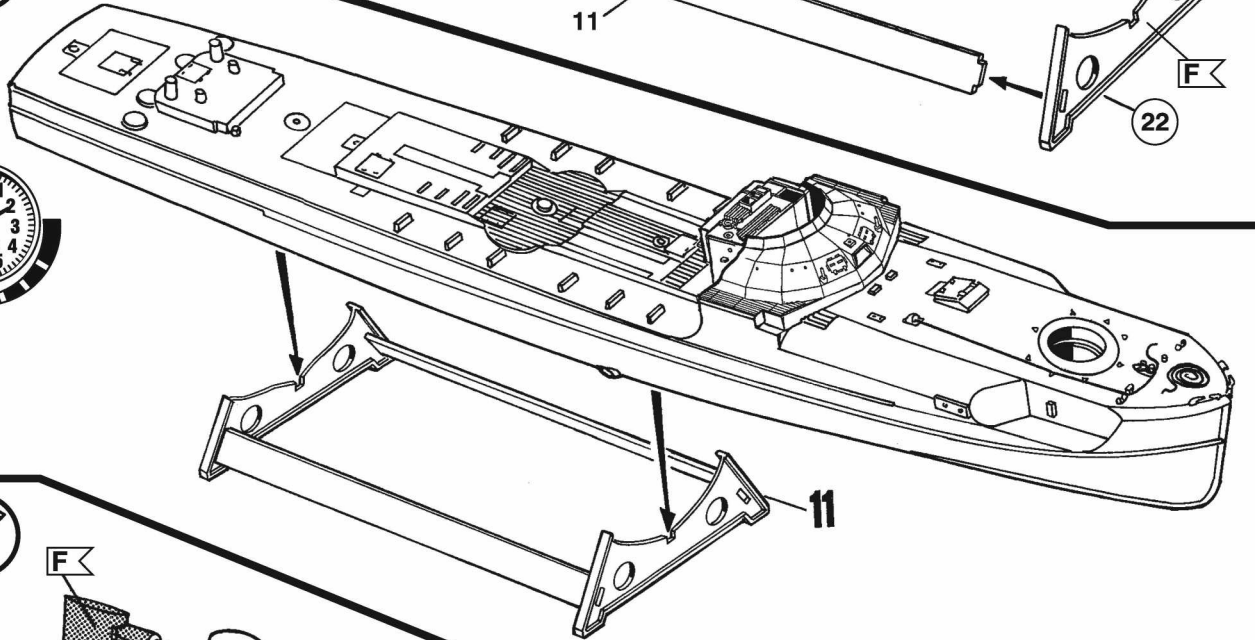
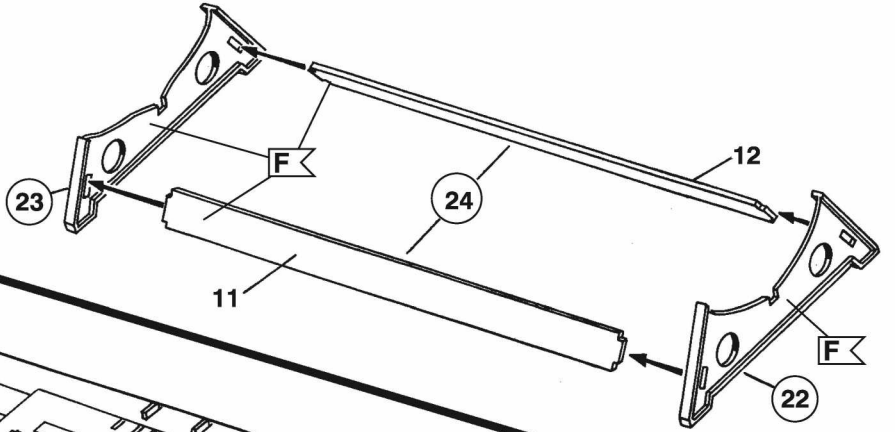

16

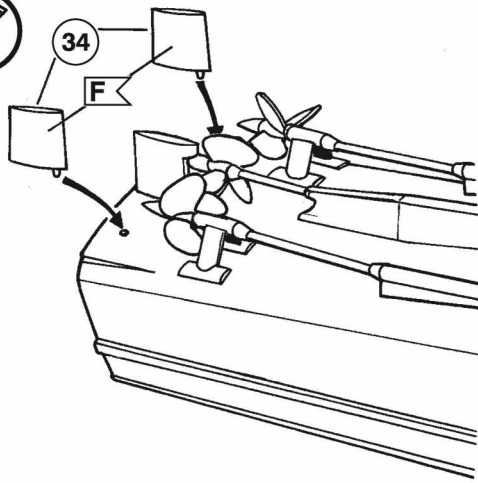

17

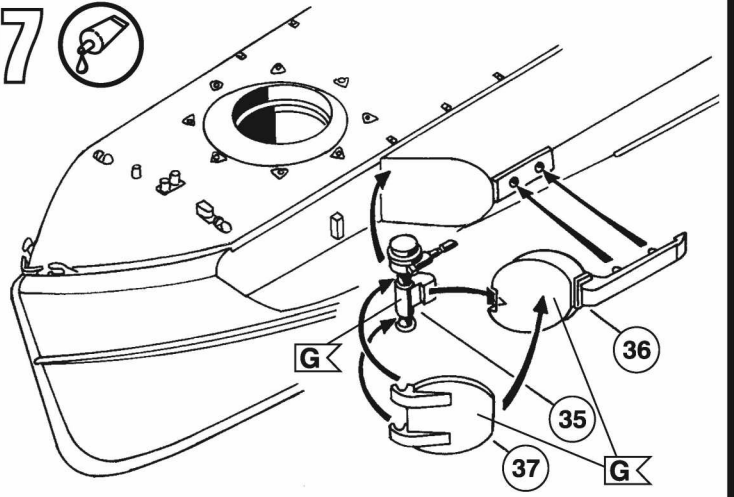

18

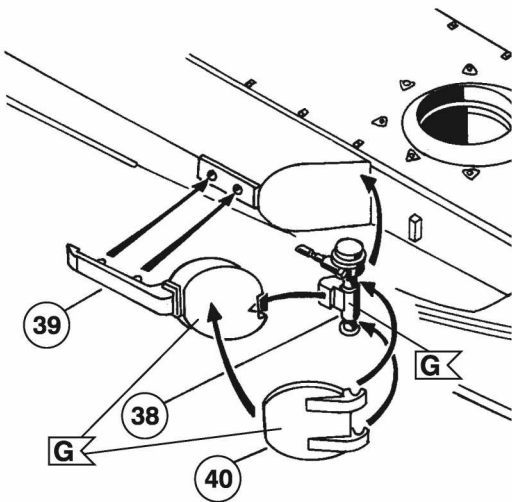

19

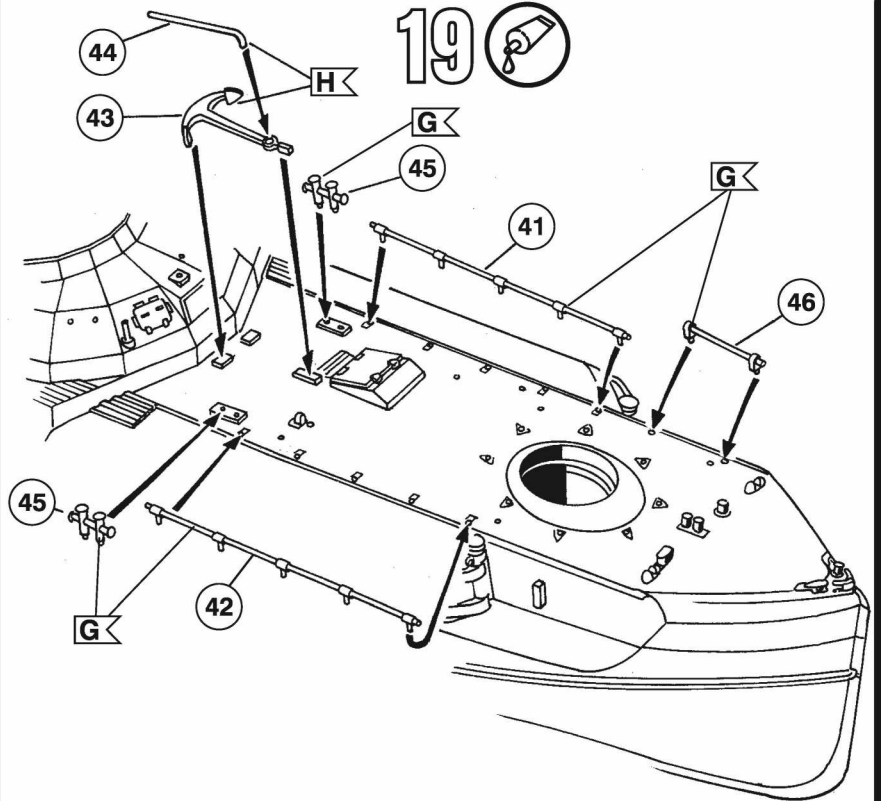

20

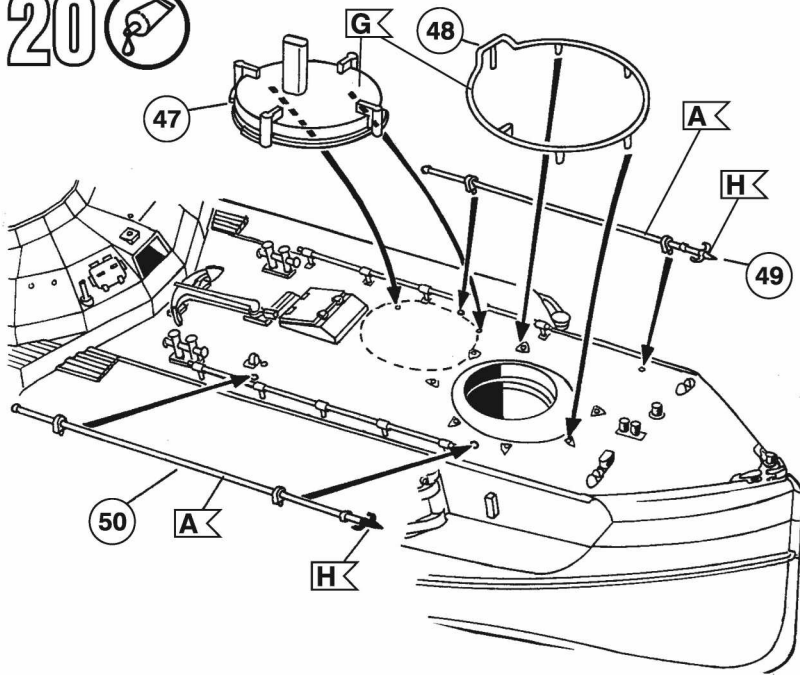

21

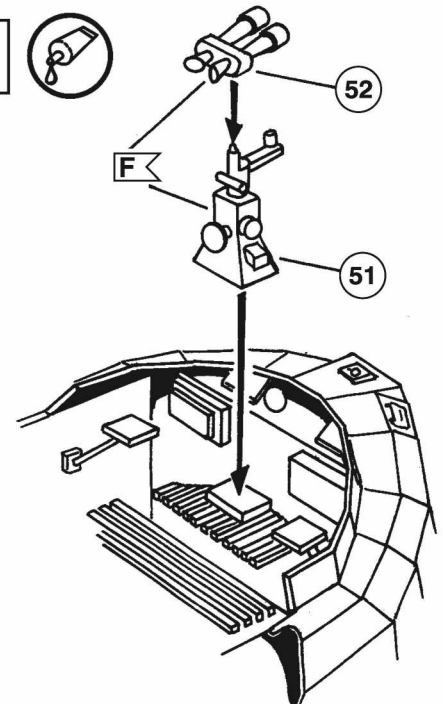

22 

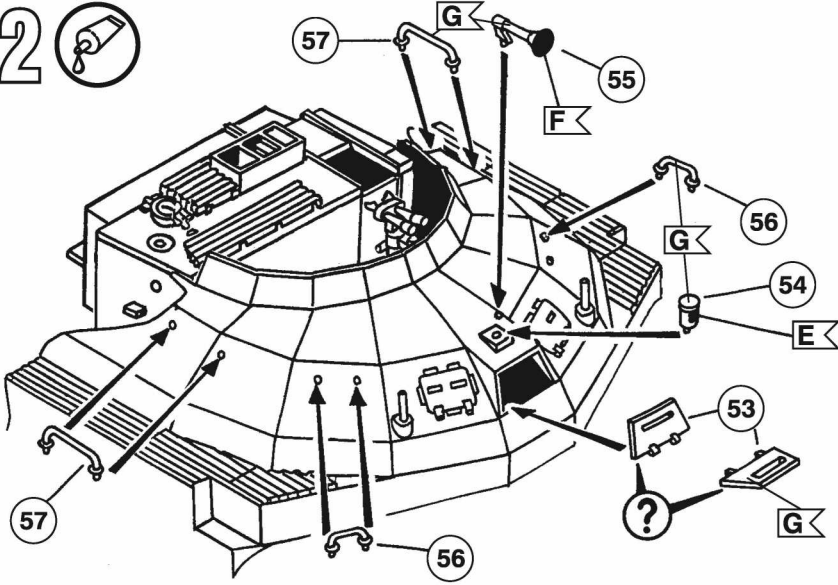

23 

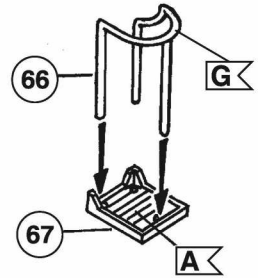

24 

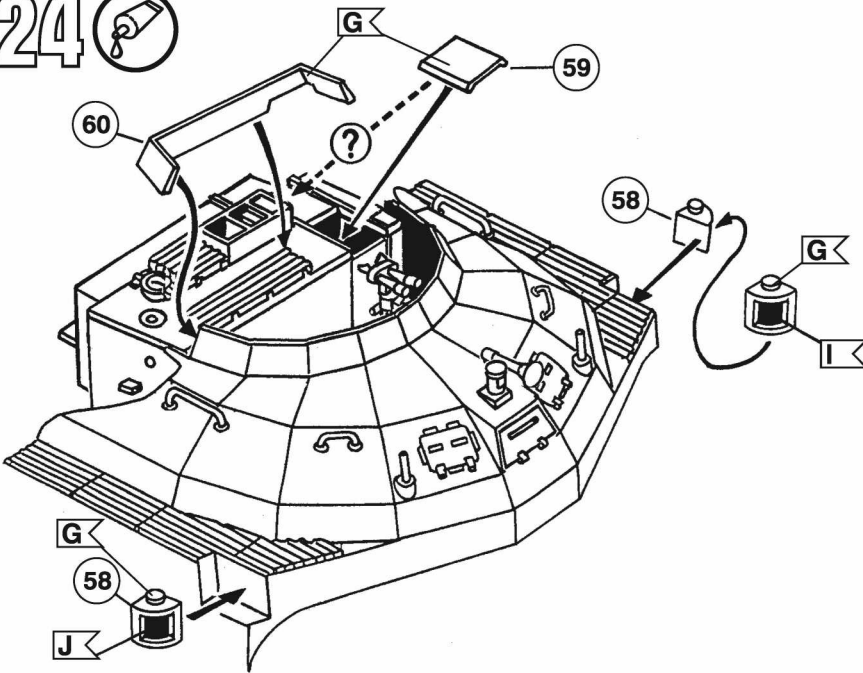

25  3x

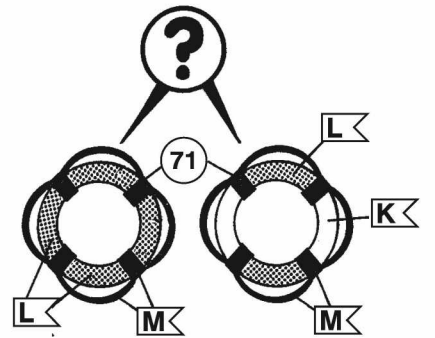

26 

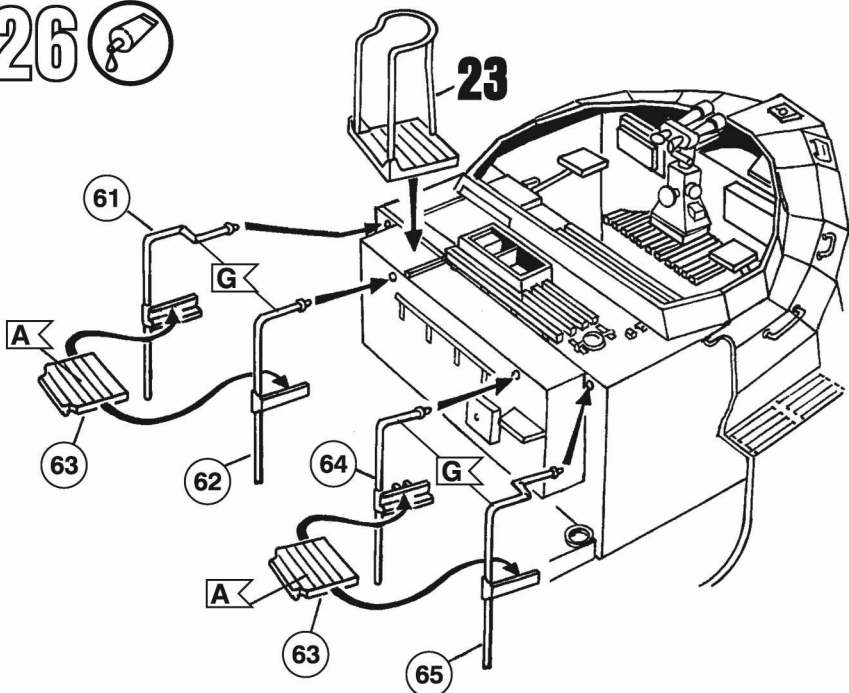

27 

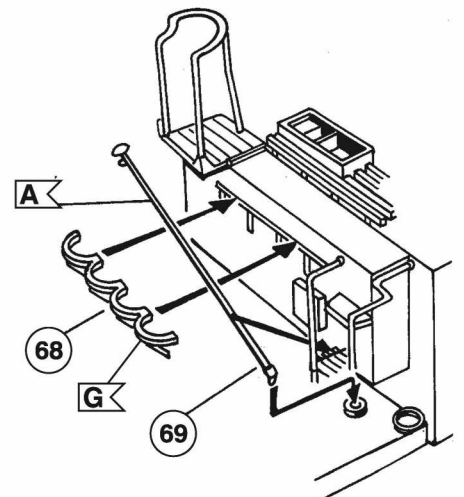

27a

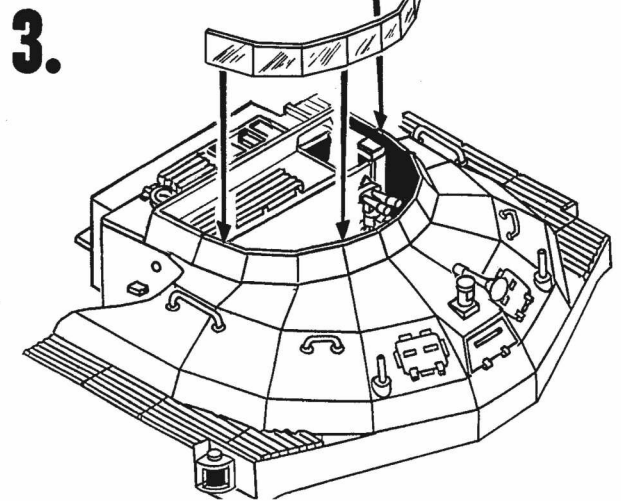
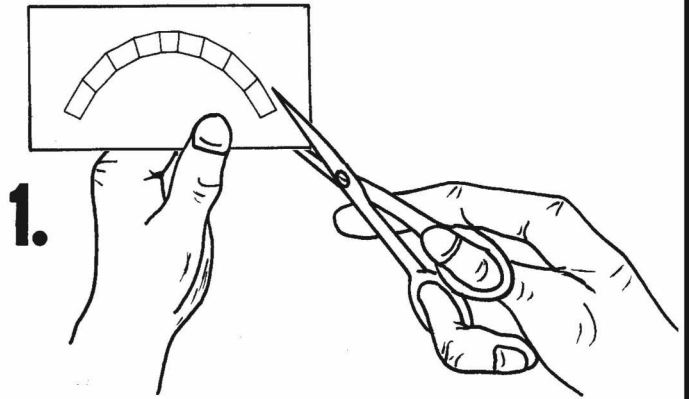
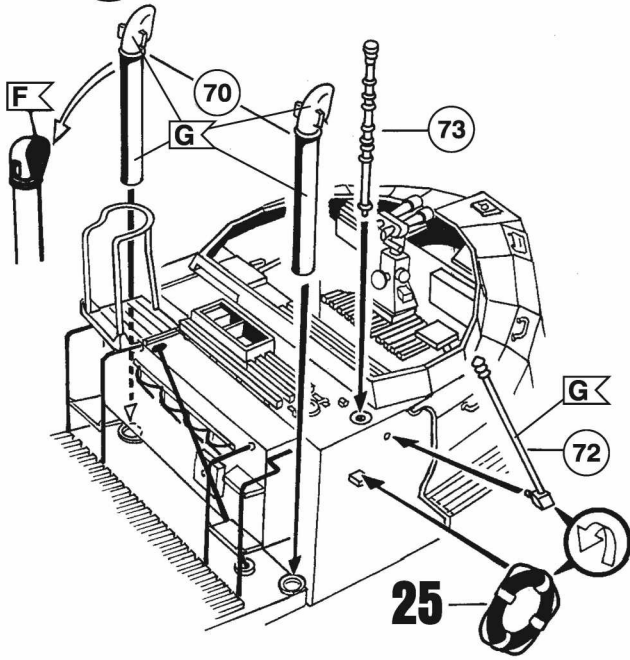

28

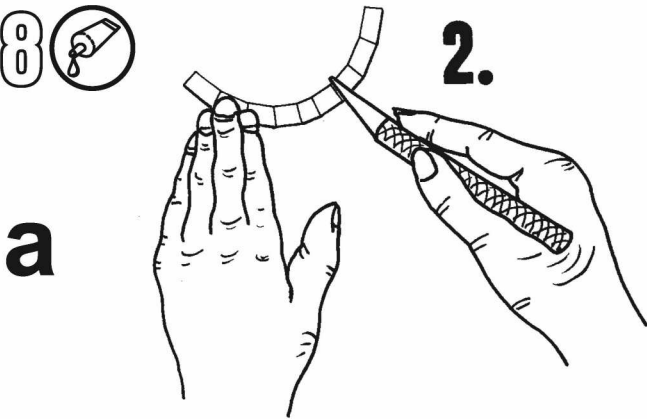

b

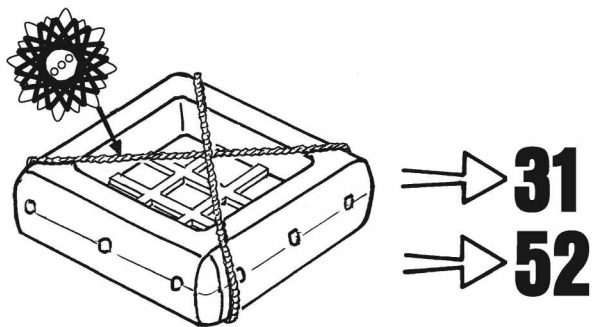
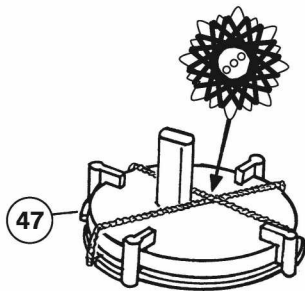

29

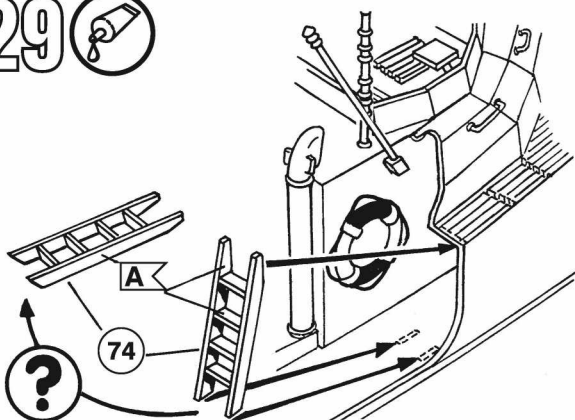

30

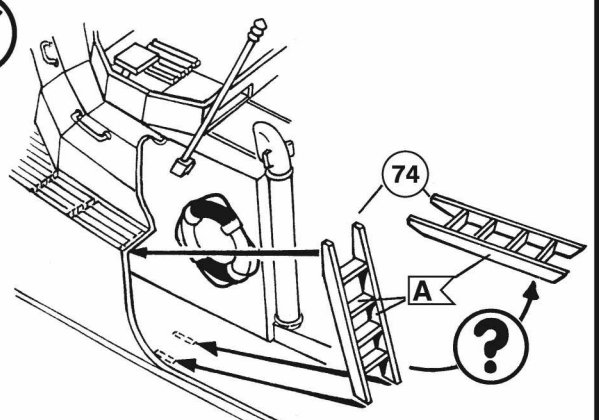

31

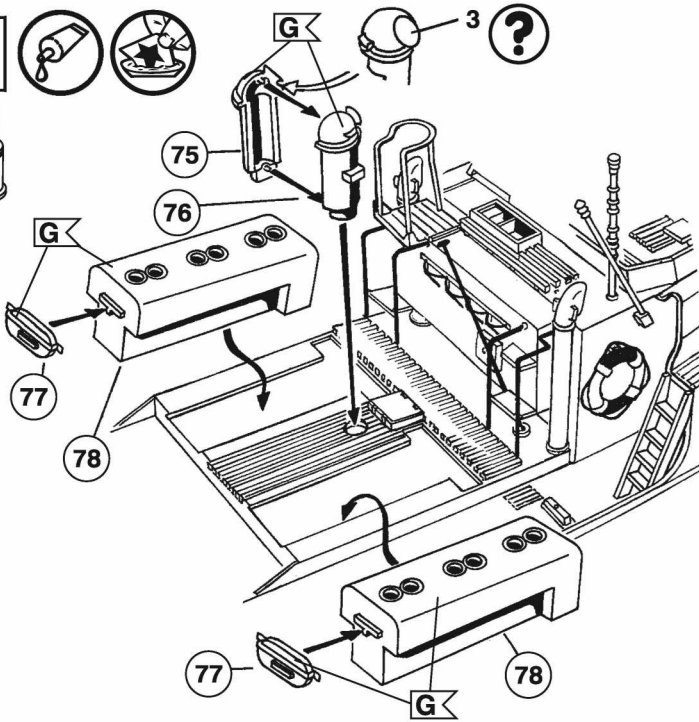

32

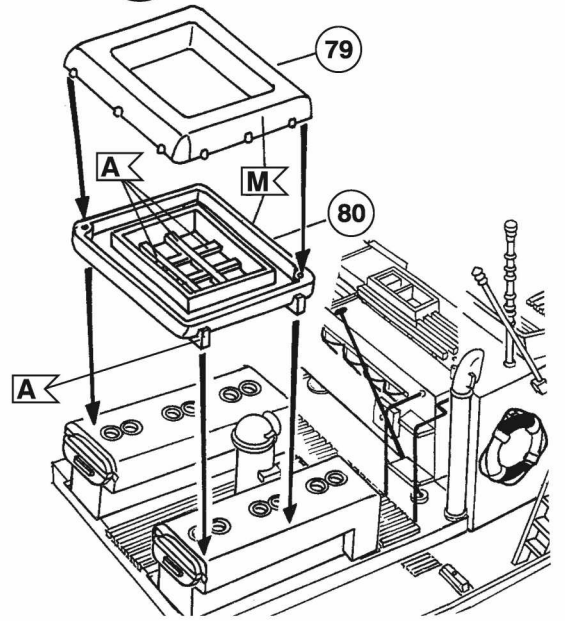

33

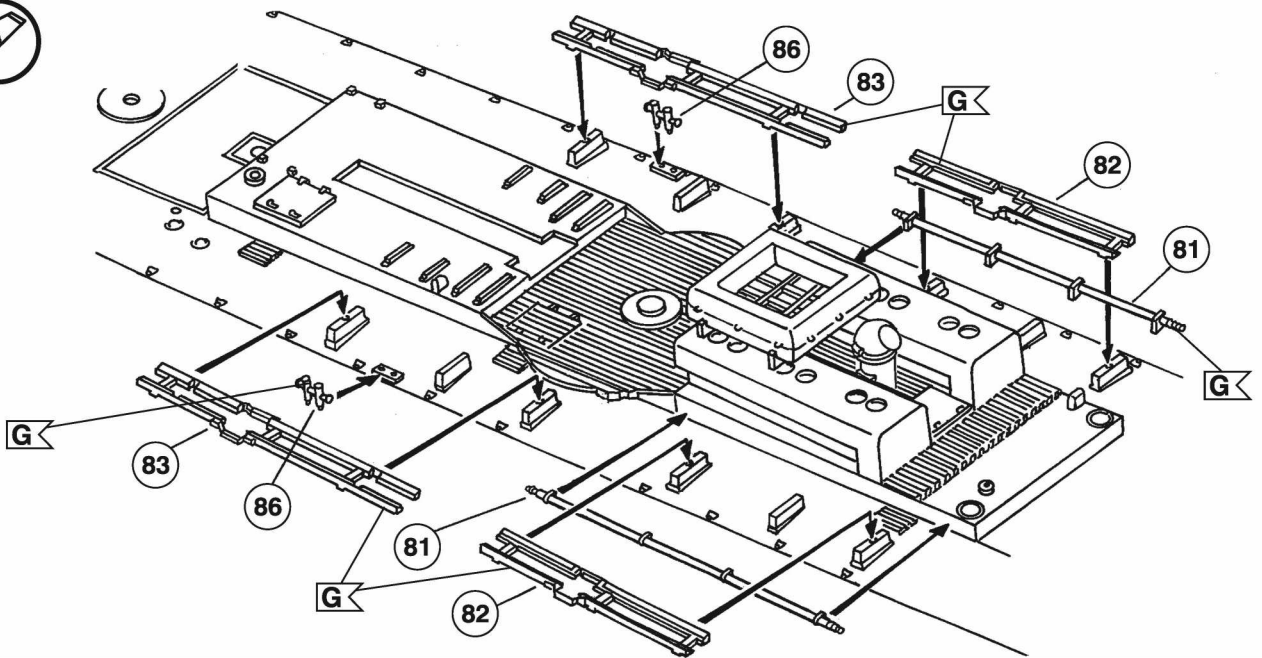

34

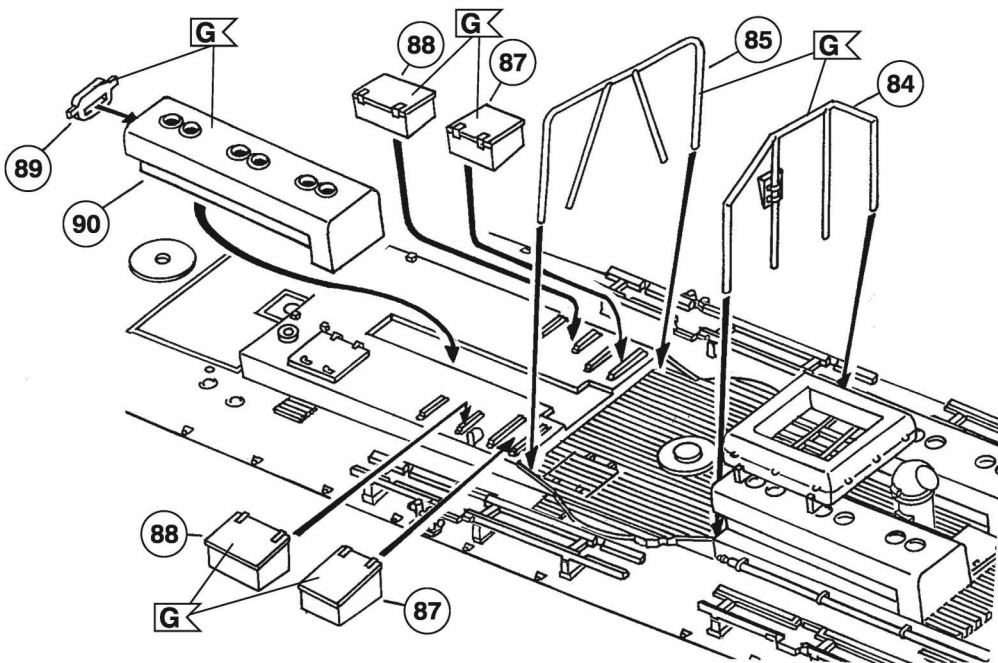

35

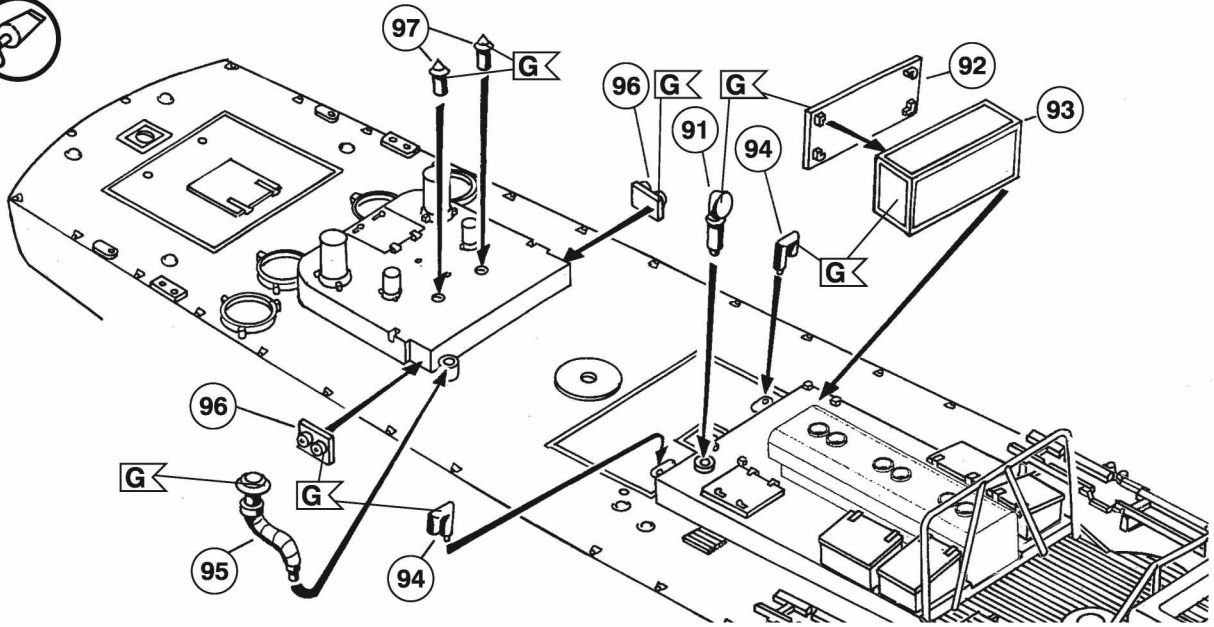

36

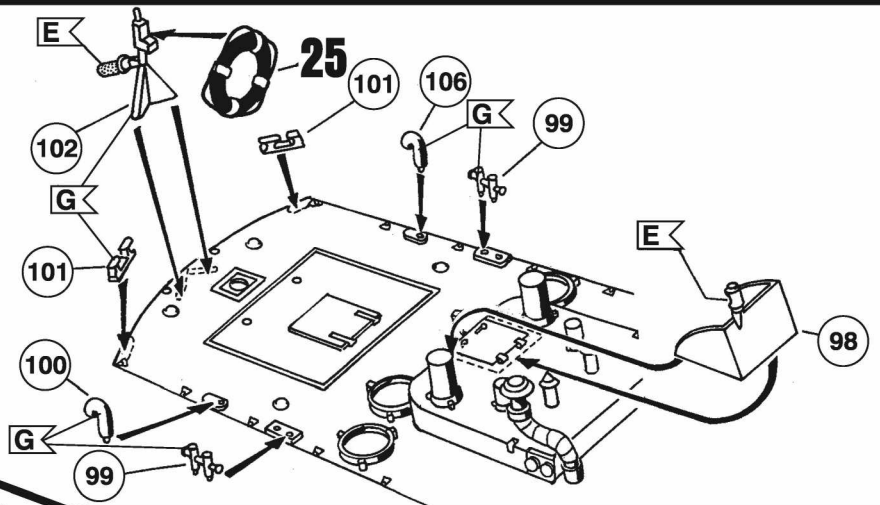

37

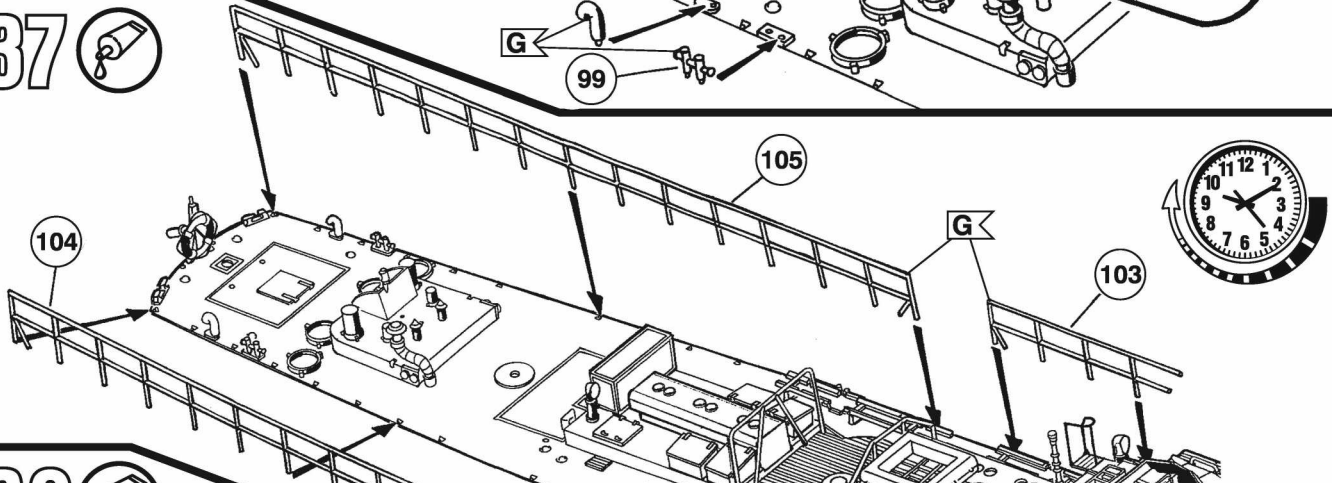

38

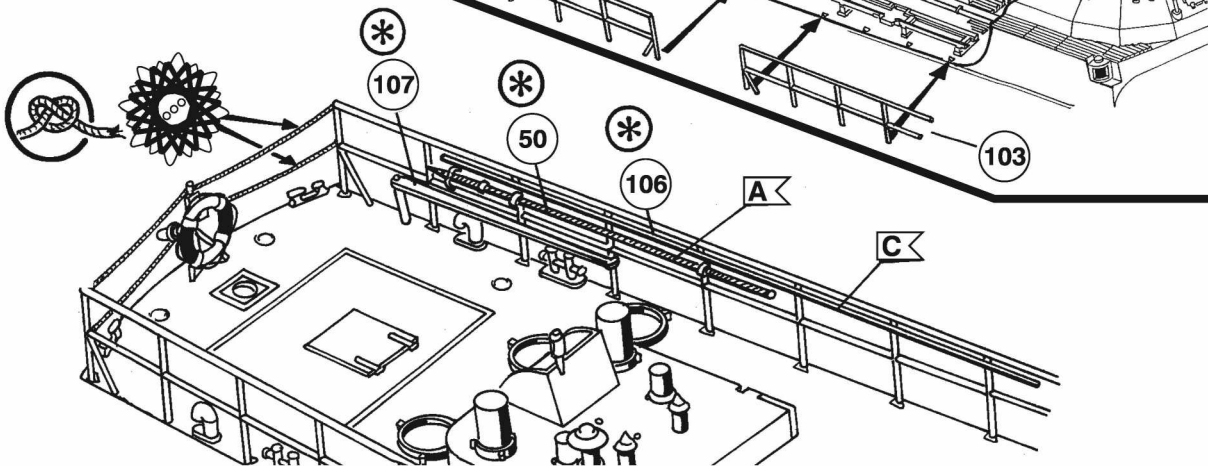

39 

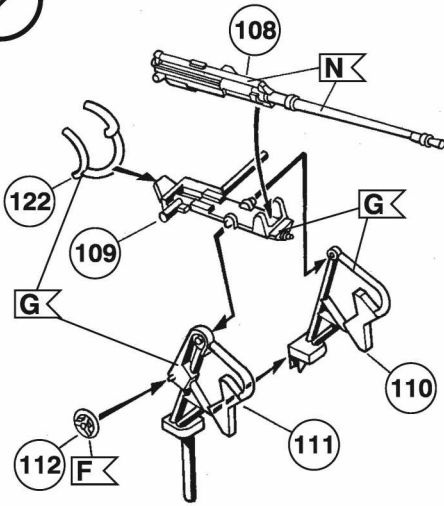

40   

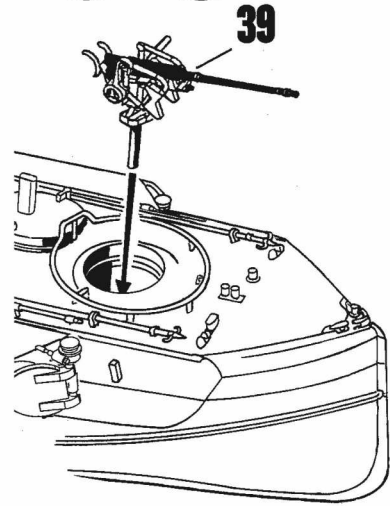

41 

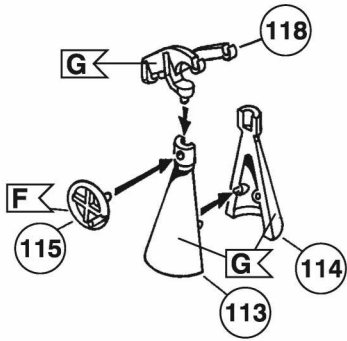

42 

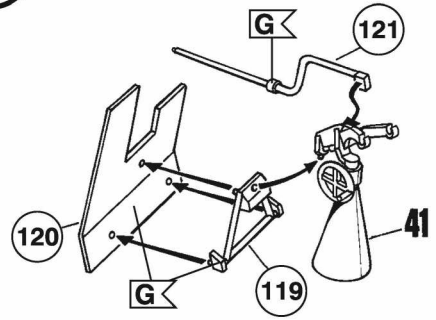

43 

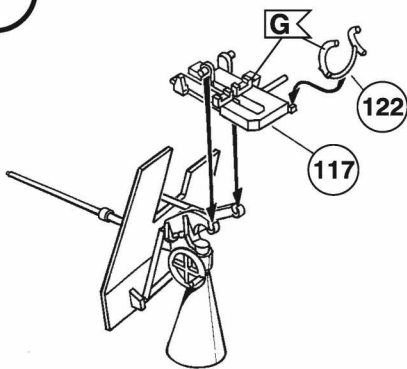

44 

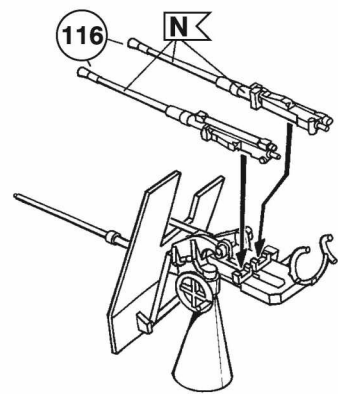

45  **2x**

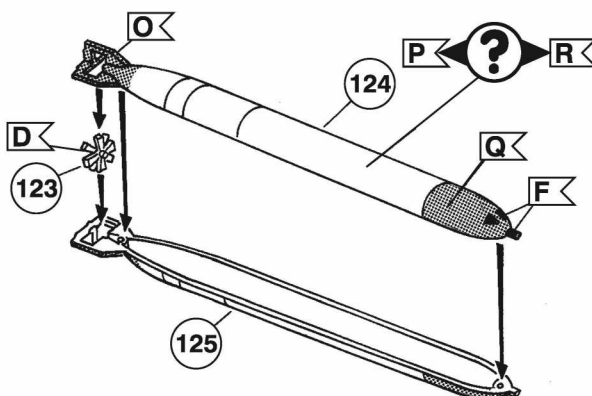

46

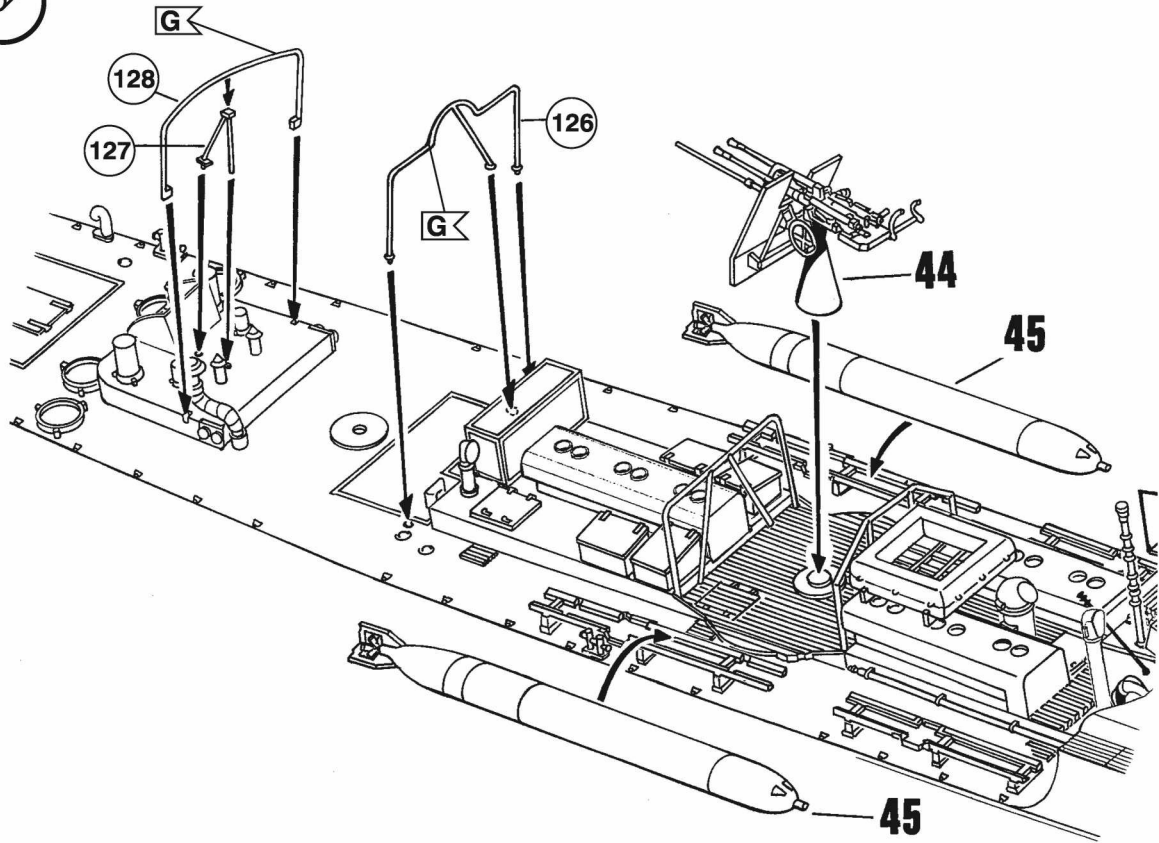

47

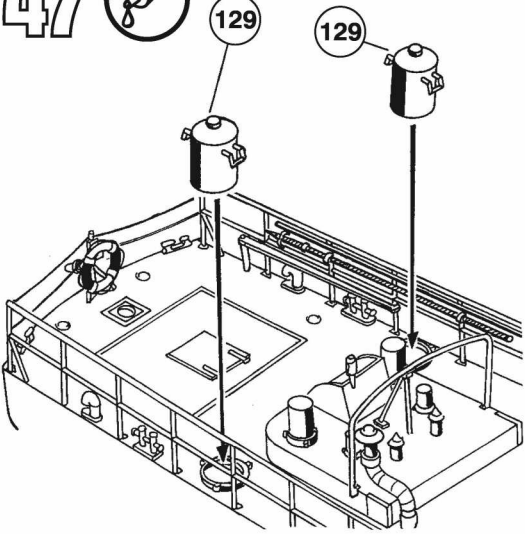

48

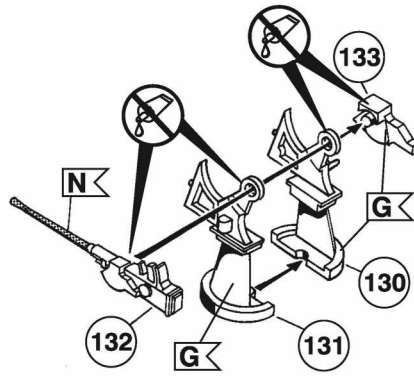

49

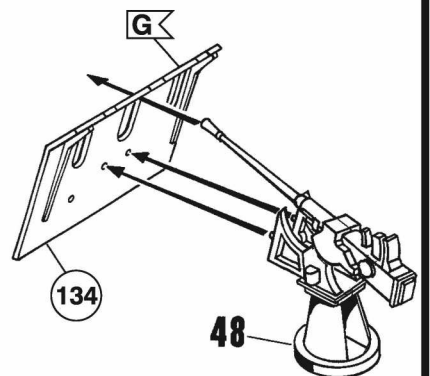

50

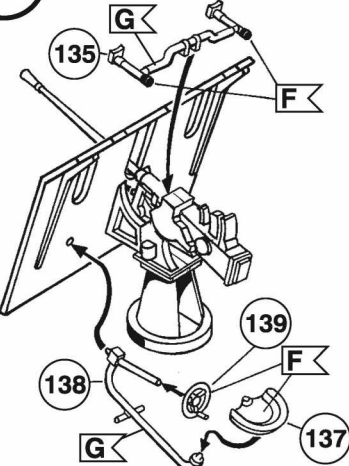

51

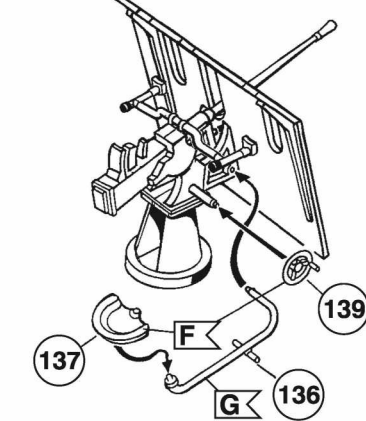

52

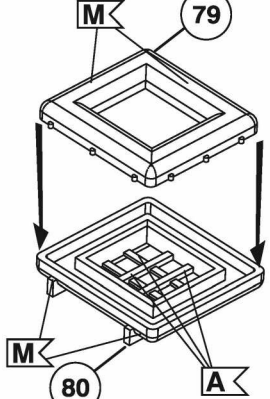

53

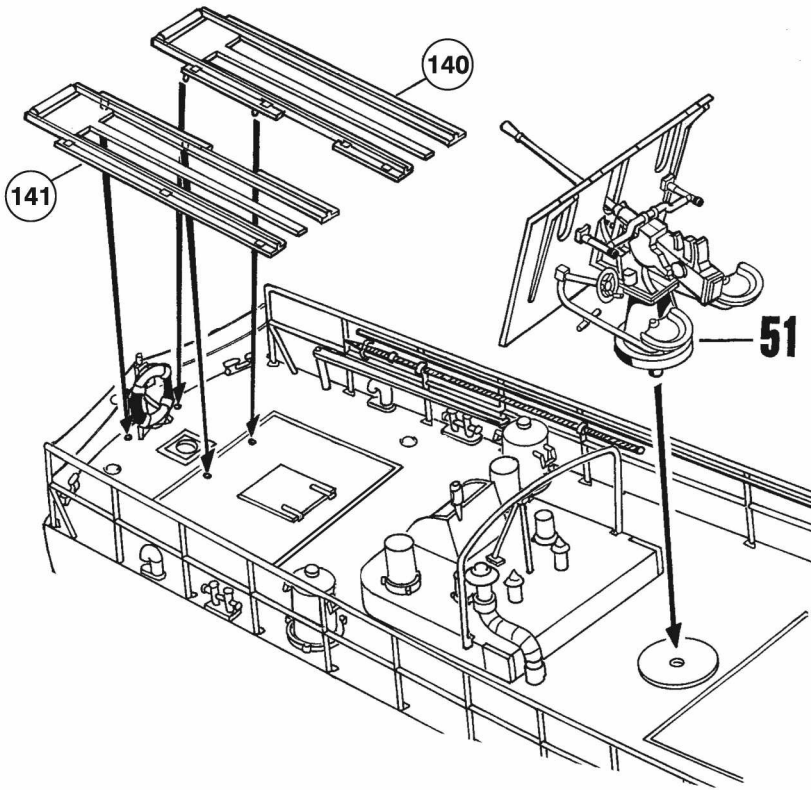

54

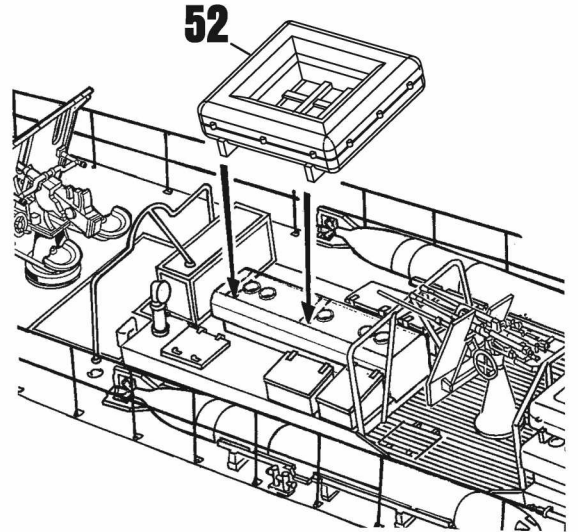

55

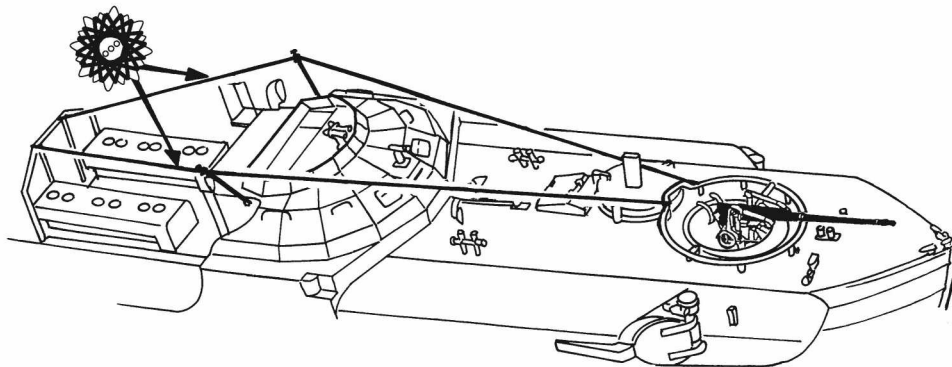

56

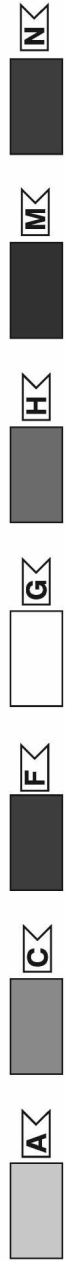
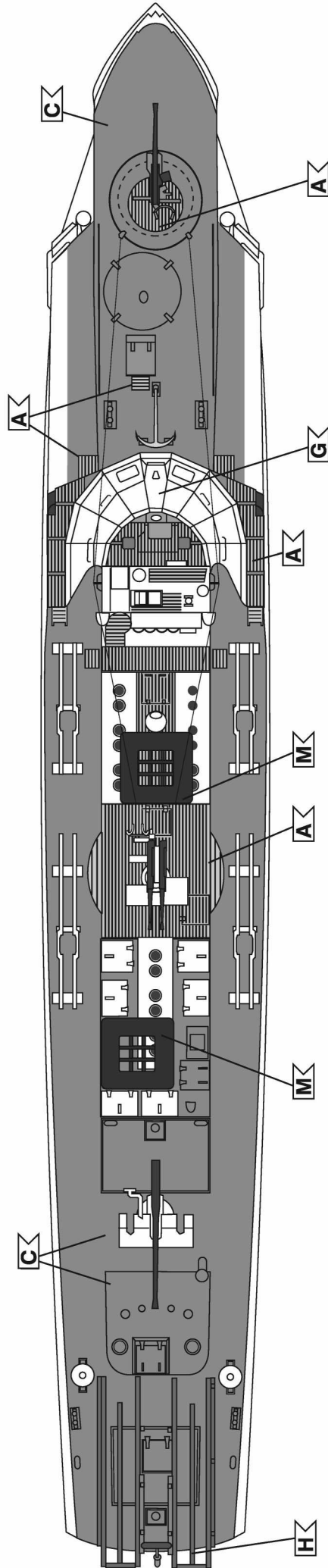
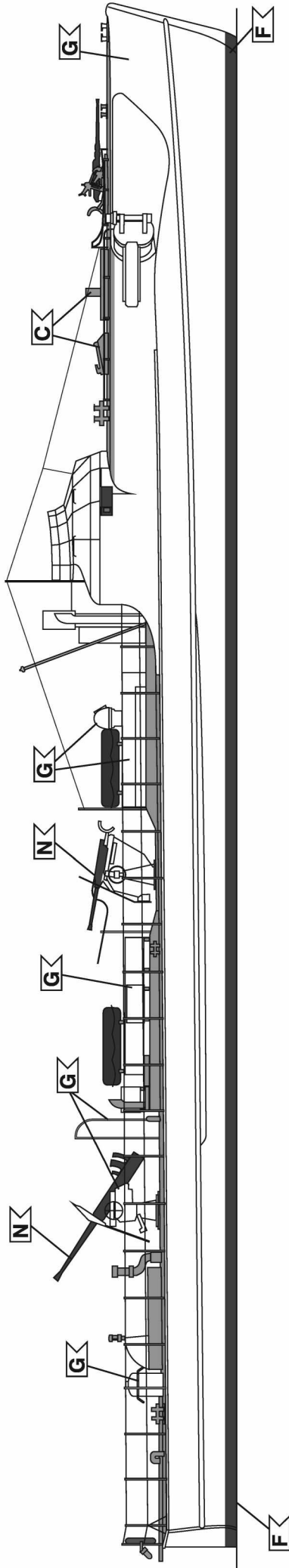

57

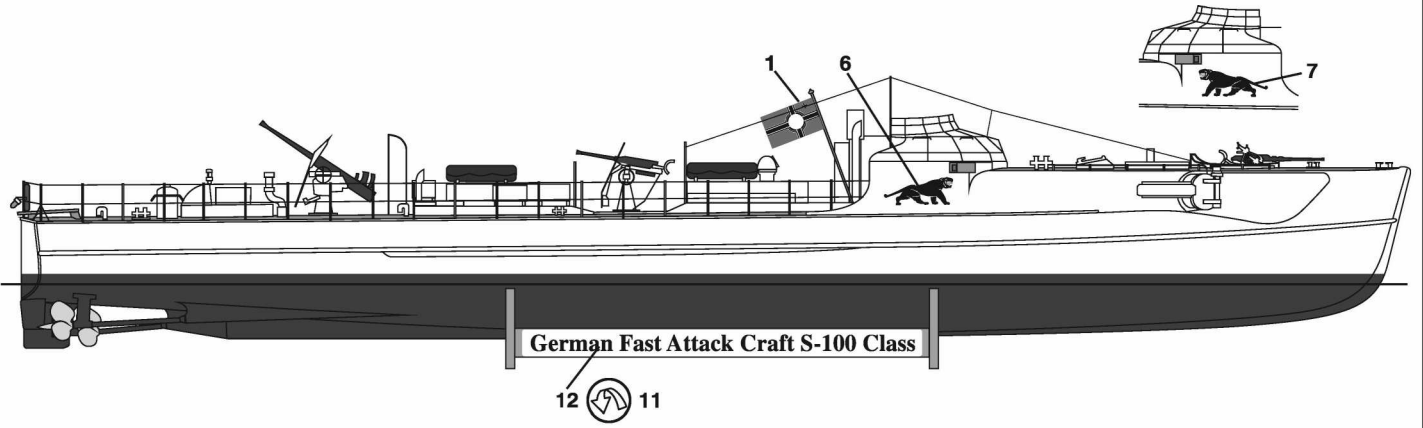

58

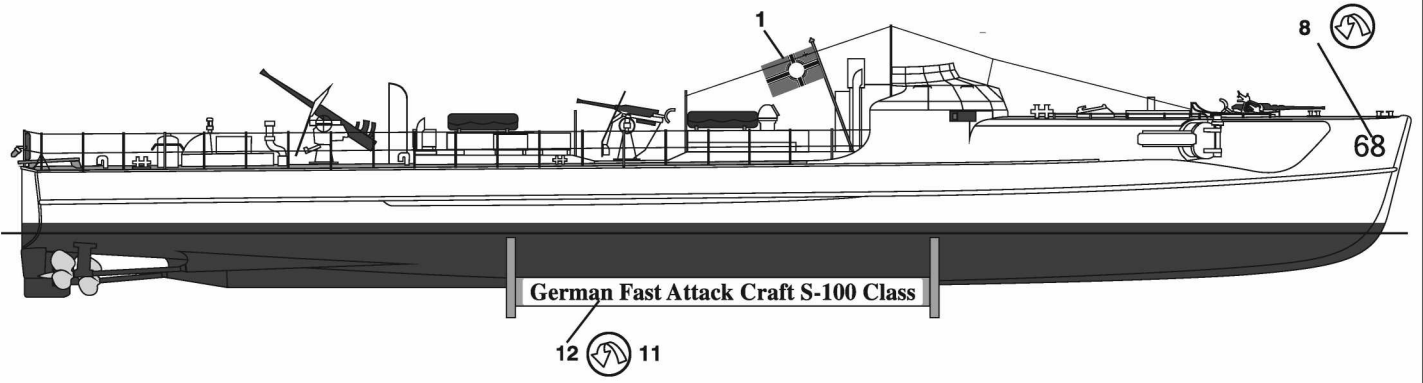

59

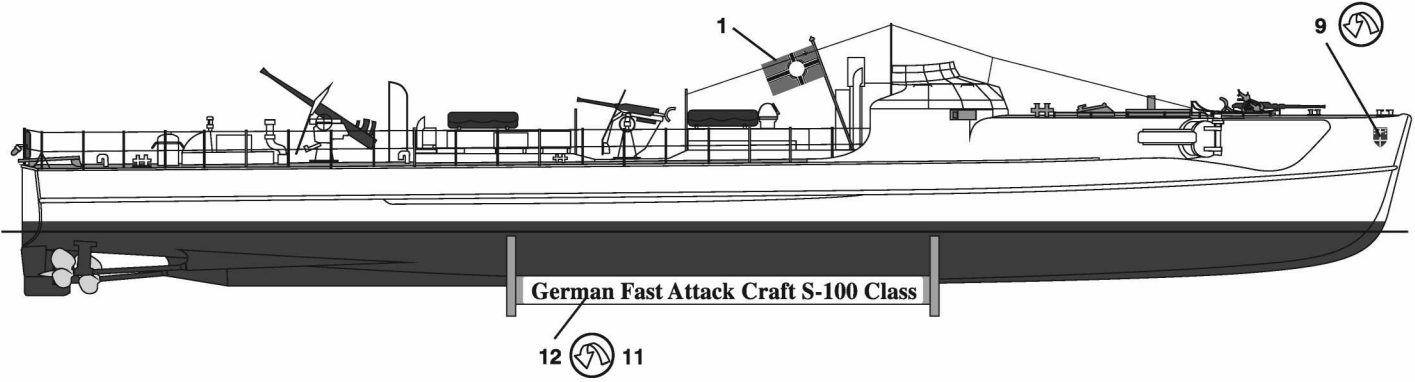

German Fast Attack Craft S-100 Class

60

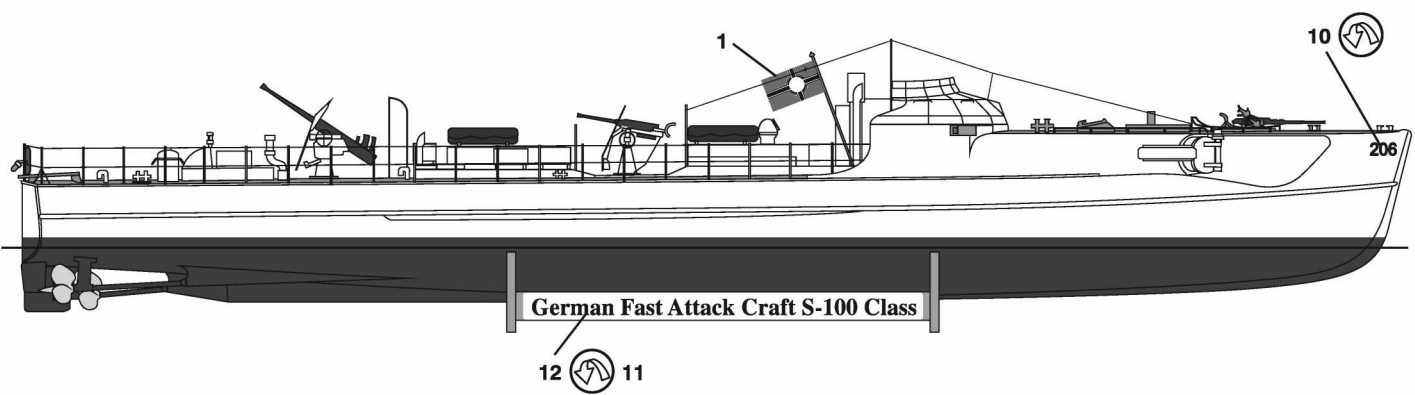

German Fast Attack Craft S-100 Class