

2x

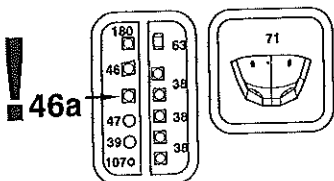
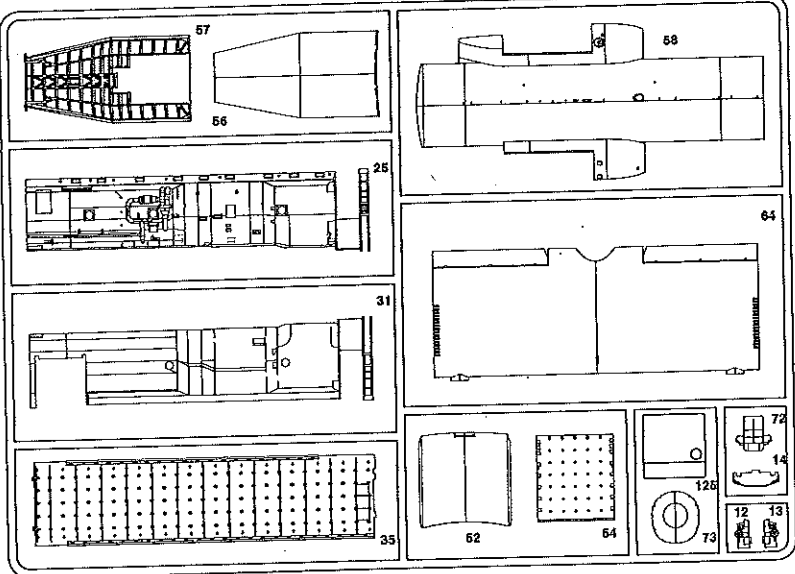
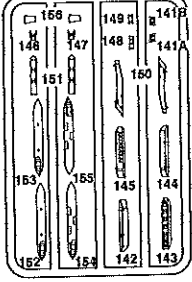
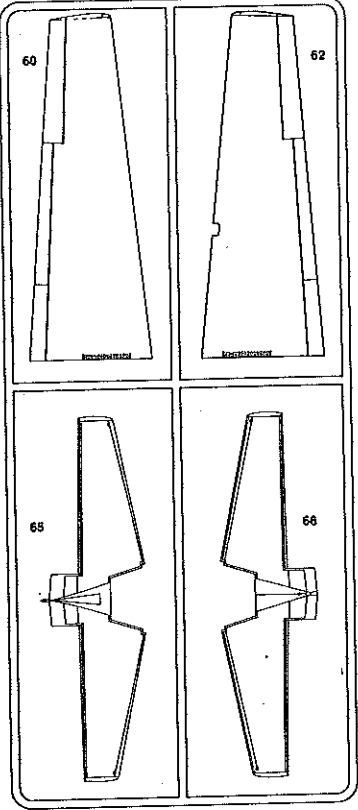
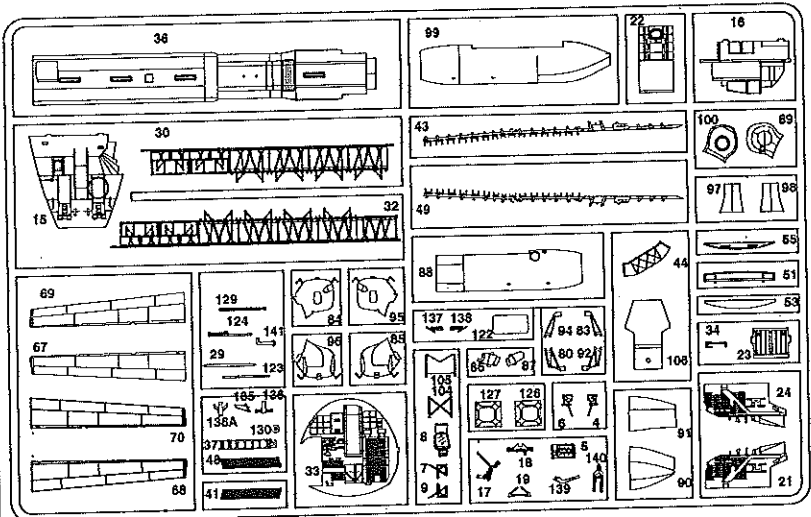
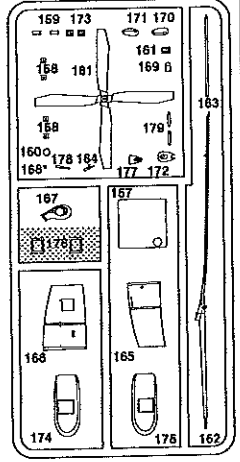

! 46a  
 Nicht benötigte Teile  
 Parts not used  
 Pièces non utilisées  
 Niet benodigde onderdelen  
 Piezas no necesarias  
 Peças não utilizadas  
 Parti non usate  
 Inta anevândă delar  
 Tarpeittonat osat  
 Ikke nødvendige dele  
 Deler som ikke er nødvendige  
 Неиспользуемые детали  
 Elementy niepotrzebne  
 μη χρησιμοποιούμενα εξαρτήματα  
 Gereksiz parçalar  
 Nepotřebné díly  
 Ite nem használt alkatrészek  
 Nepotrební díli

Deutsche Luftwaffe  
ELOKA

Armée de l'Air  
NG

D



F

F(1)



F(2)

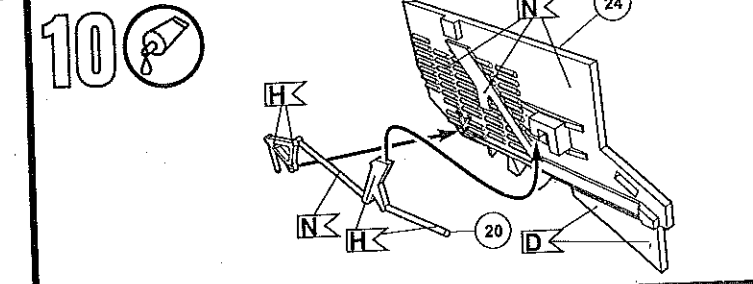
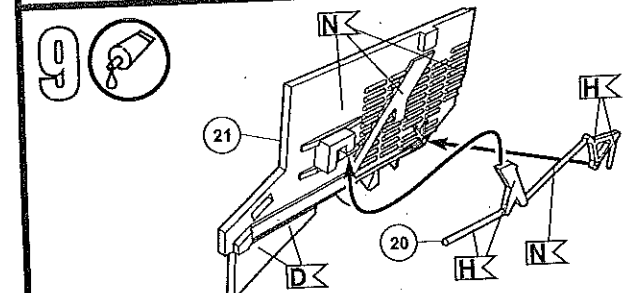
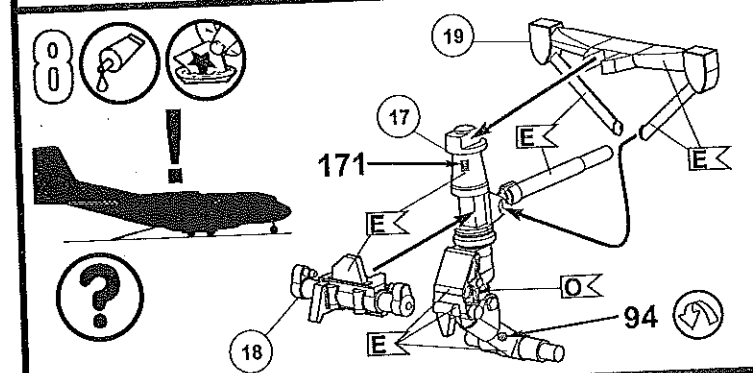
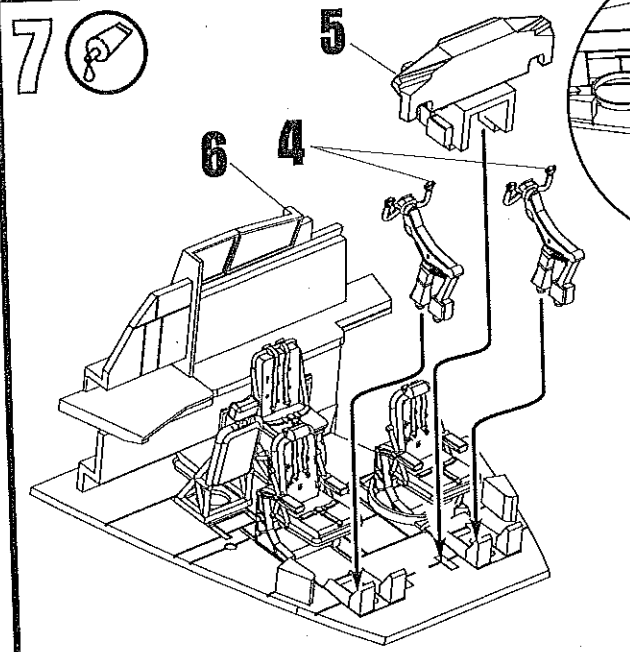
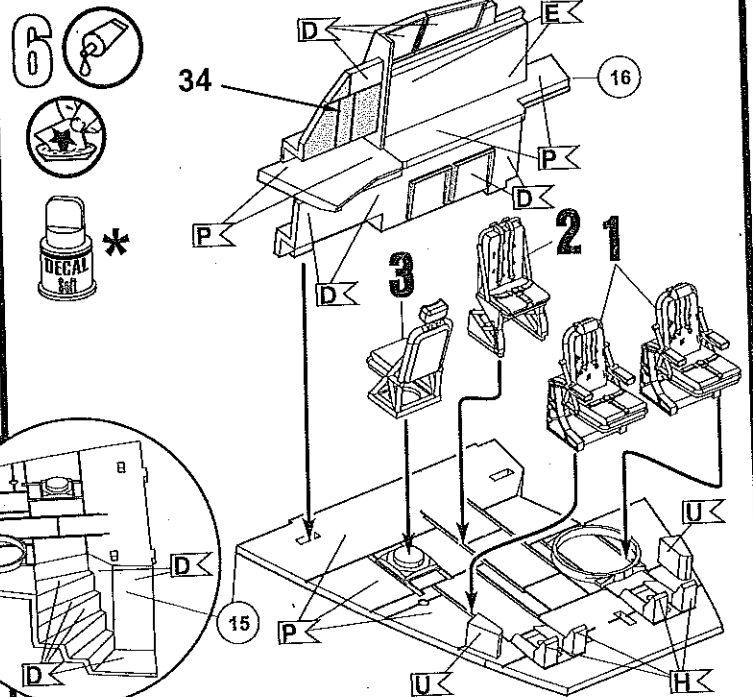
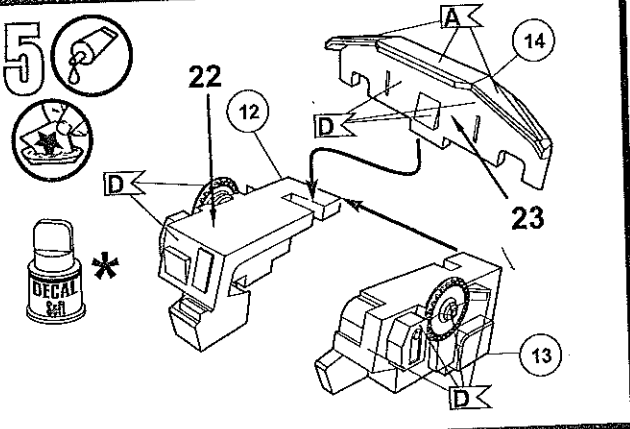
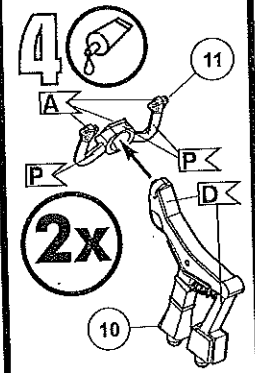
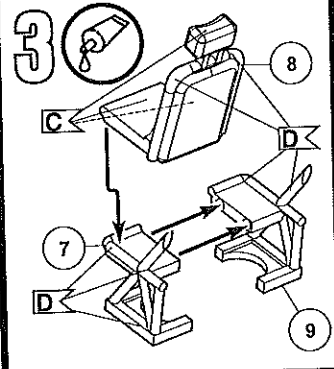
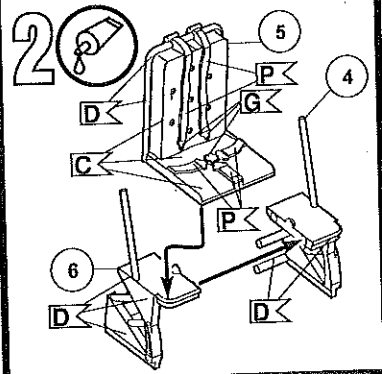
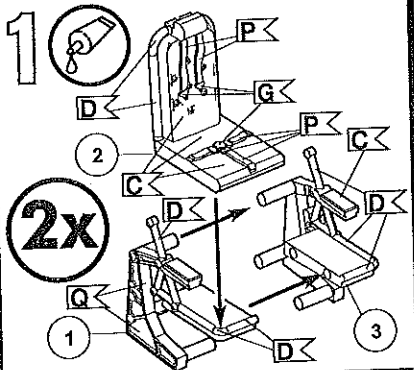
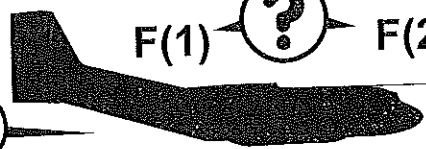
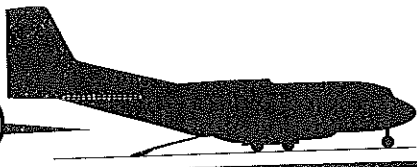

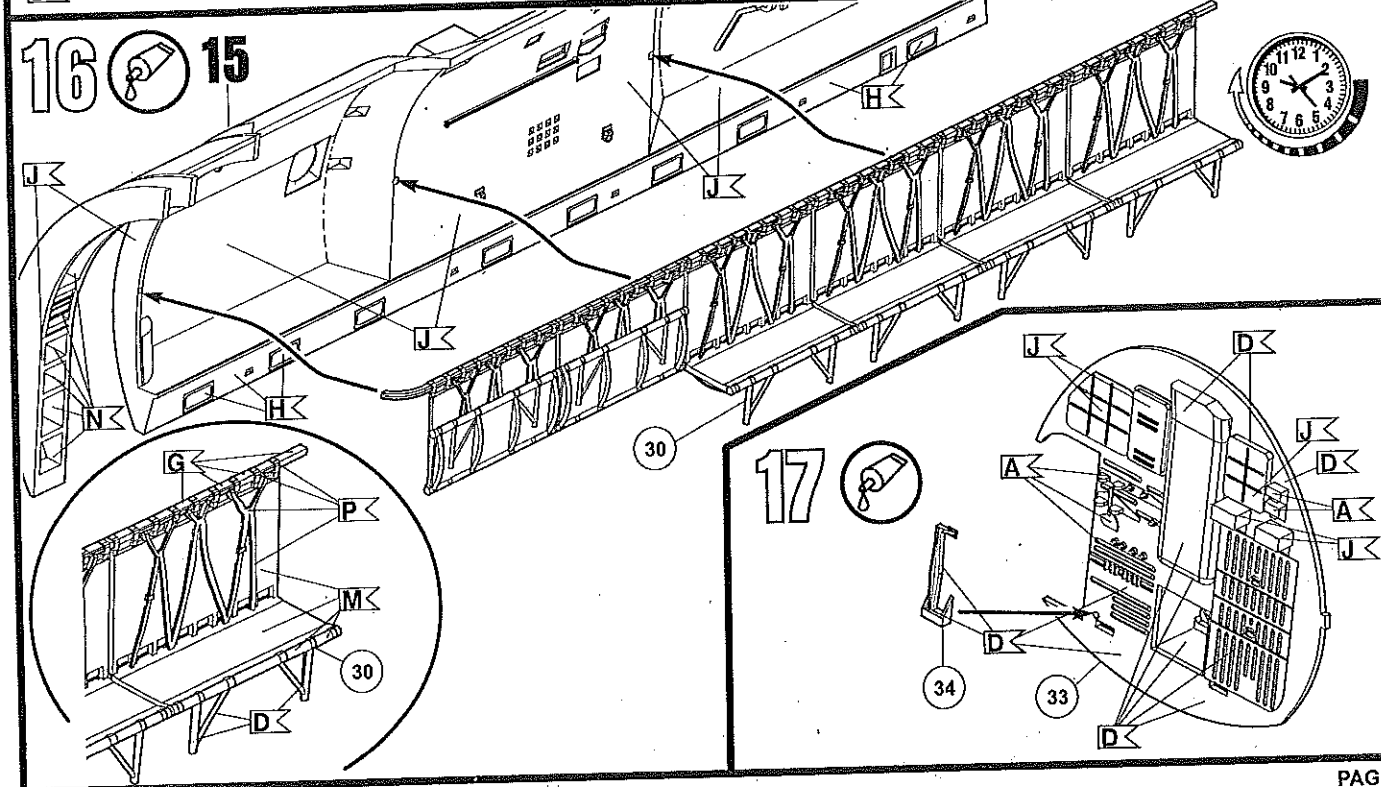
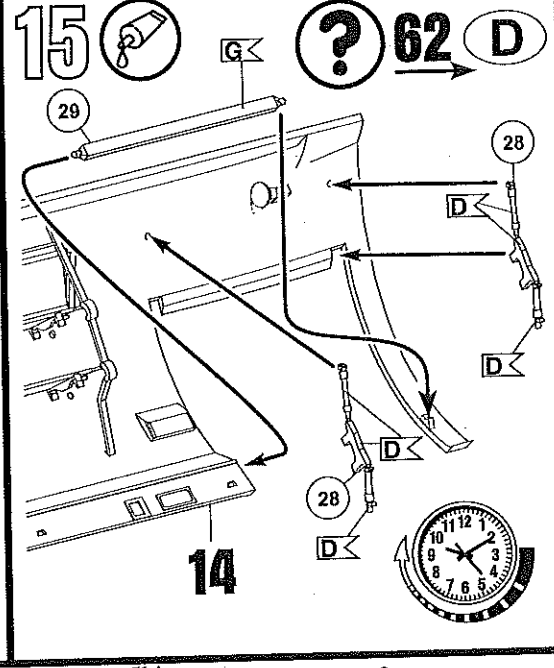
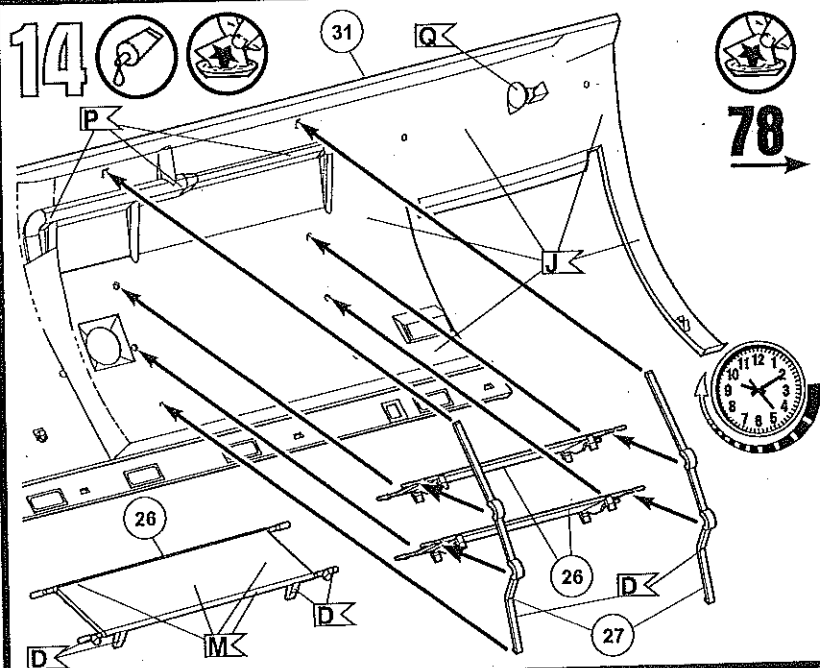
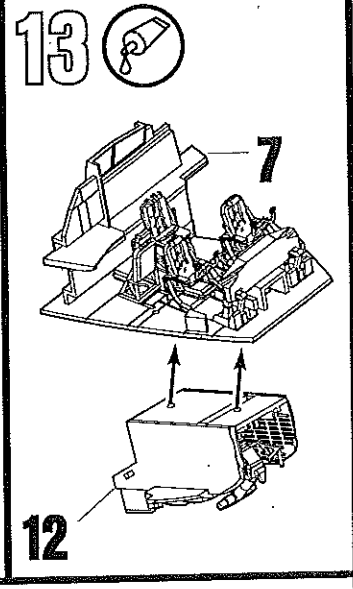
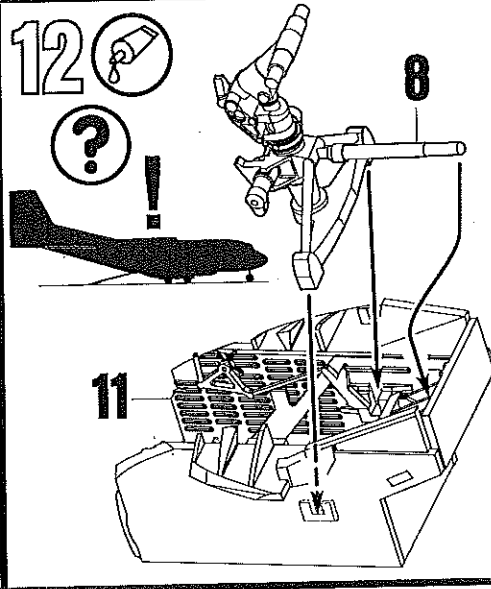
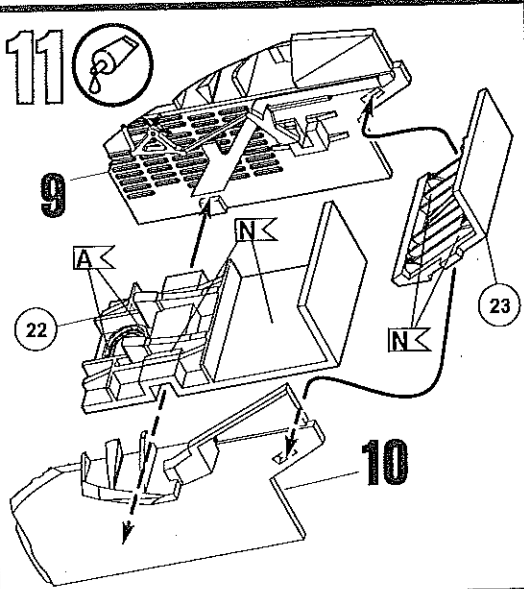

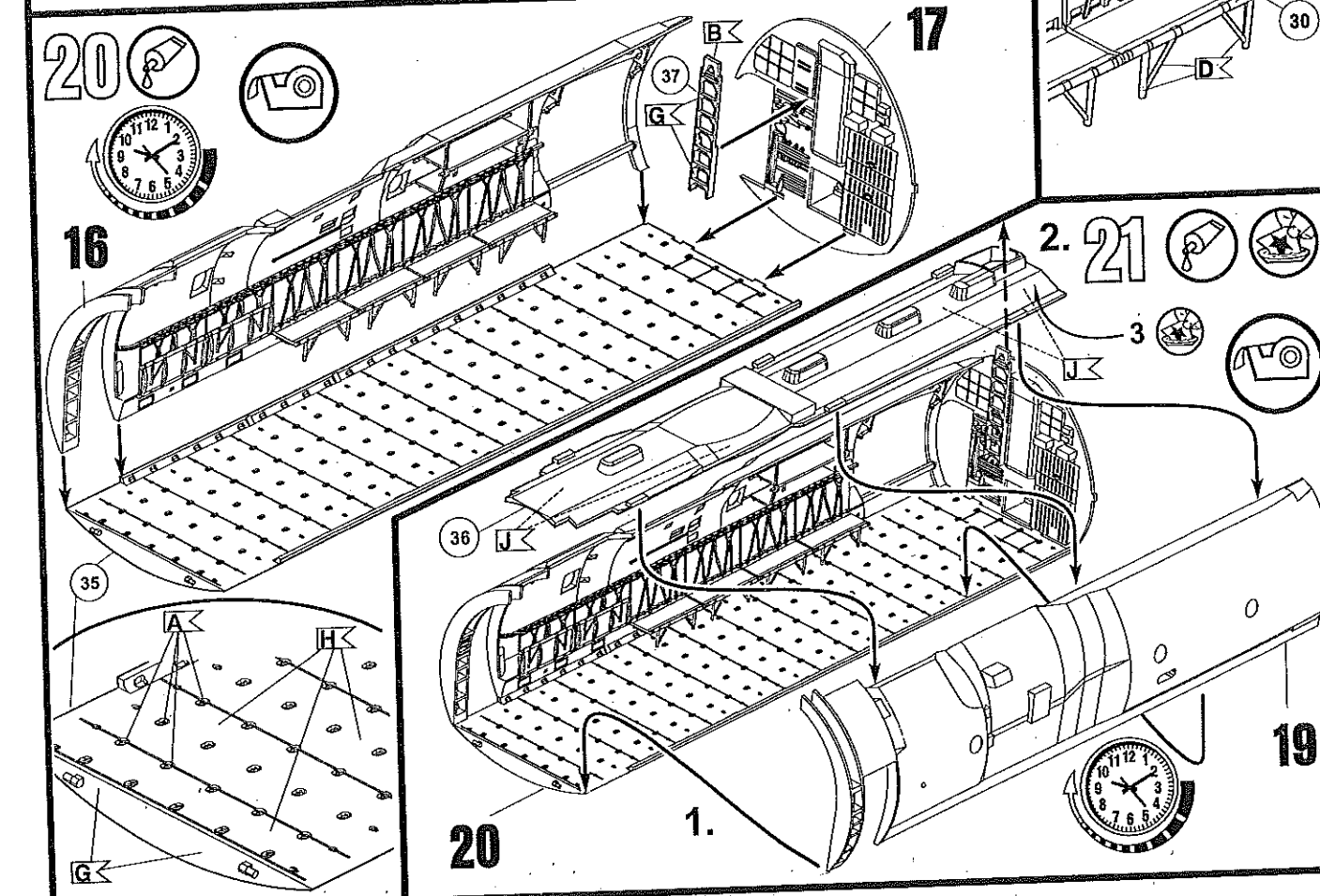
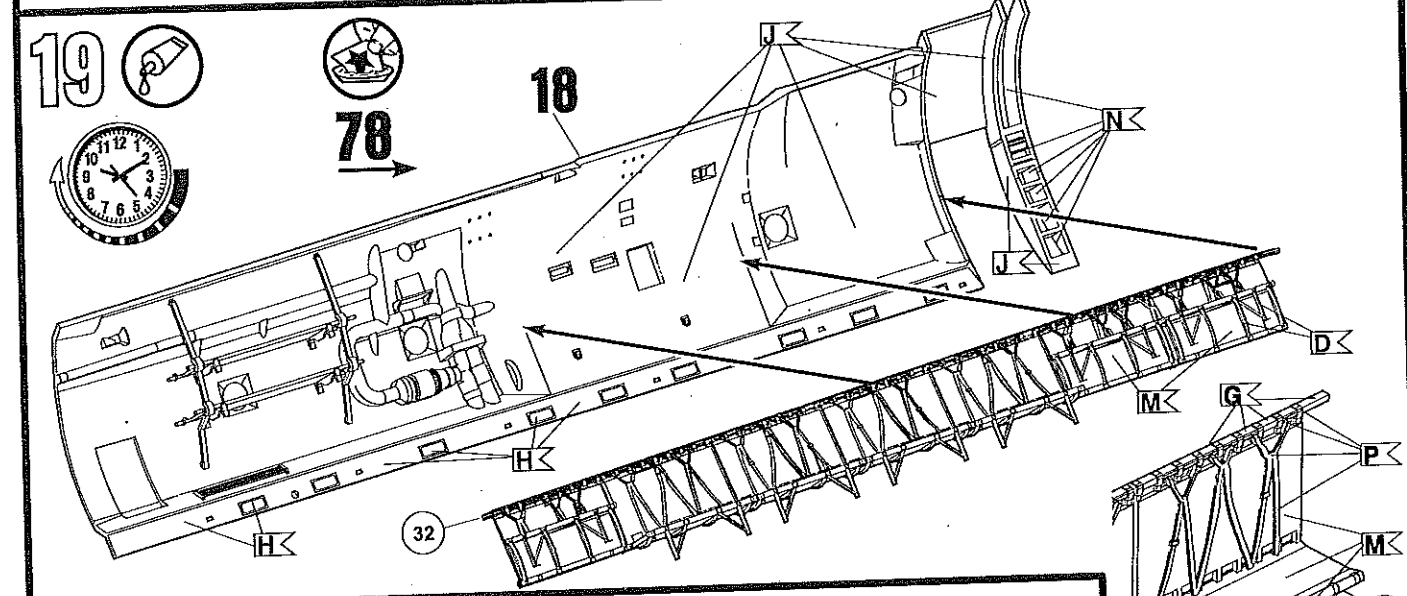
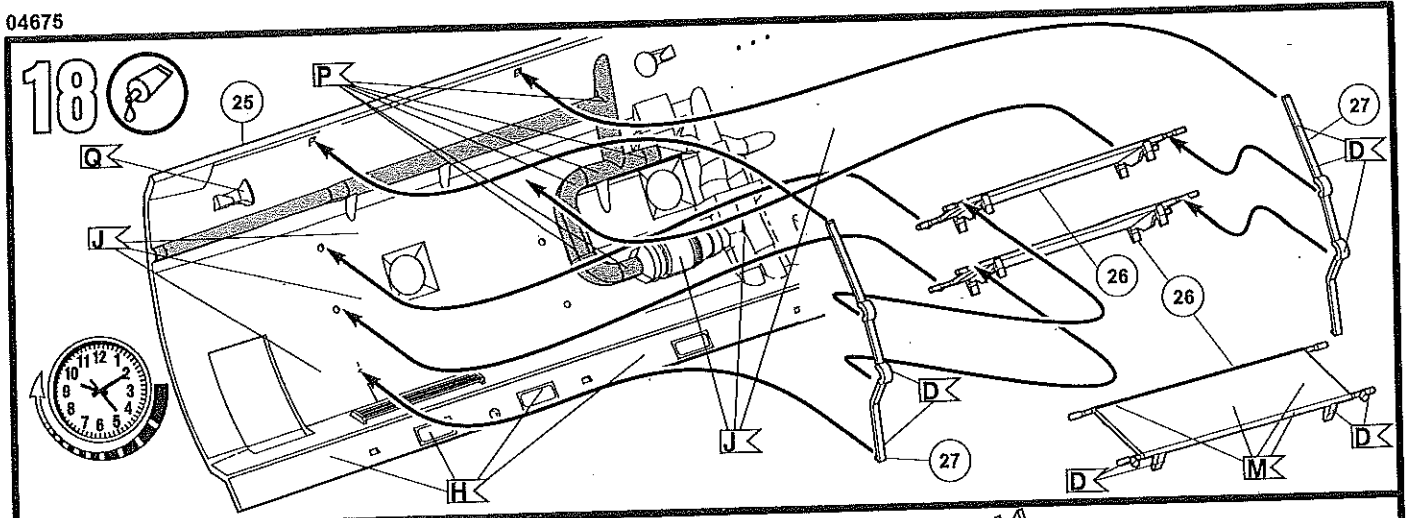



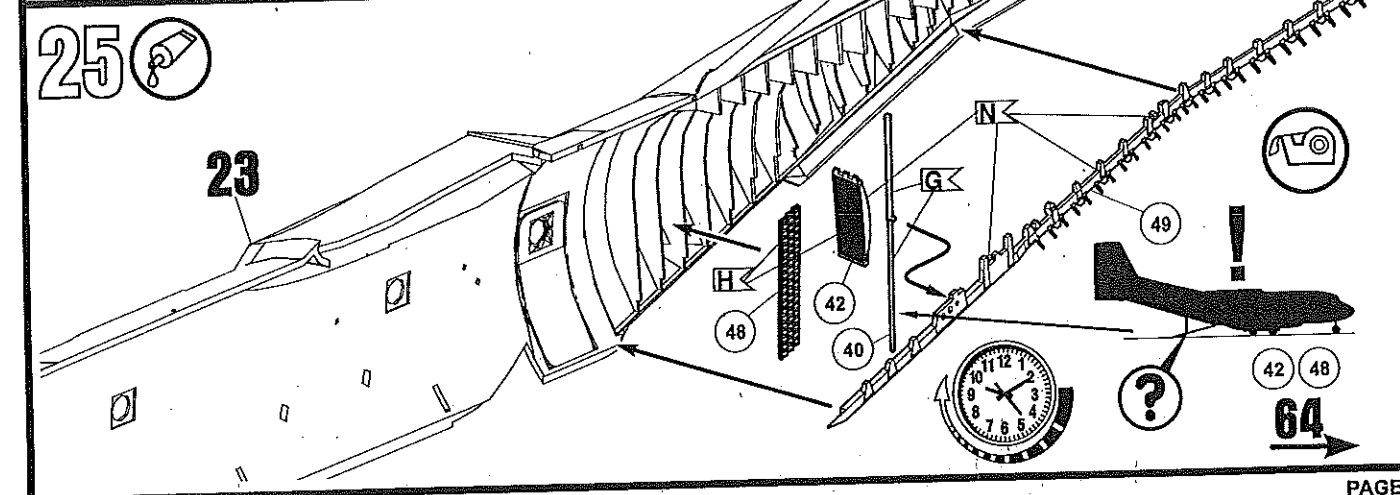
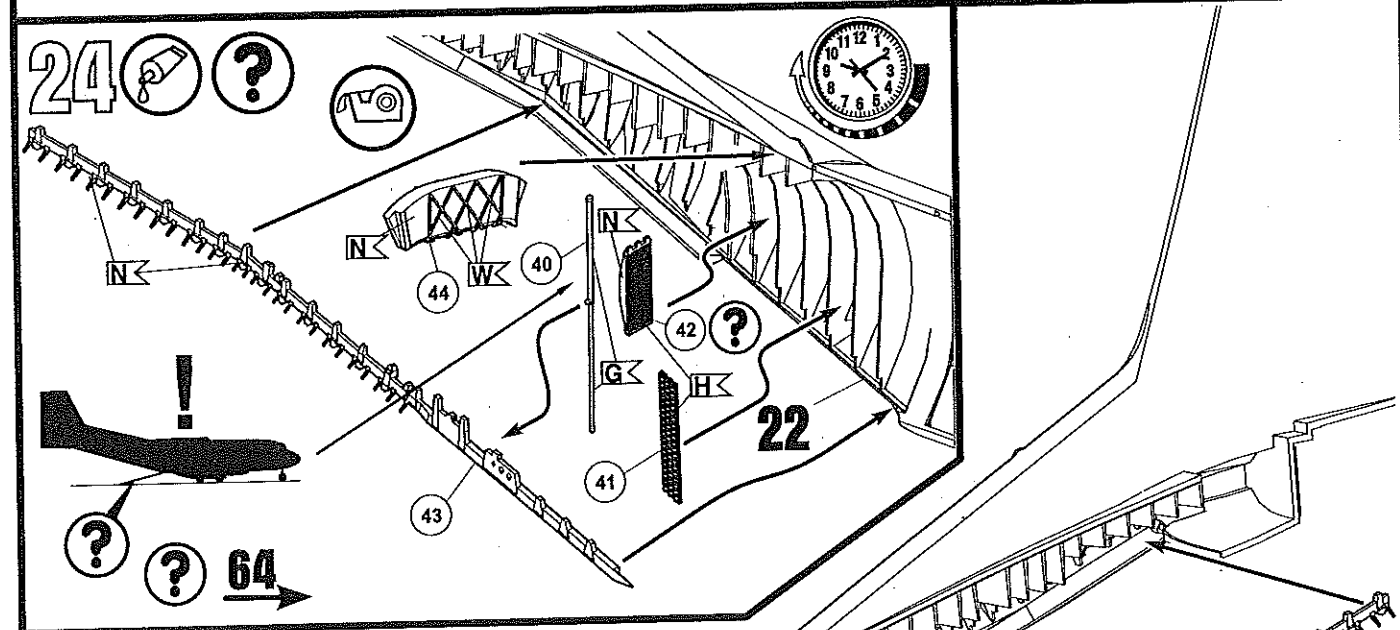
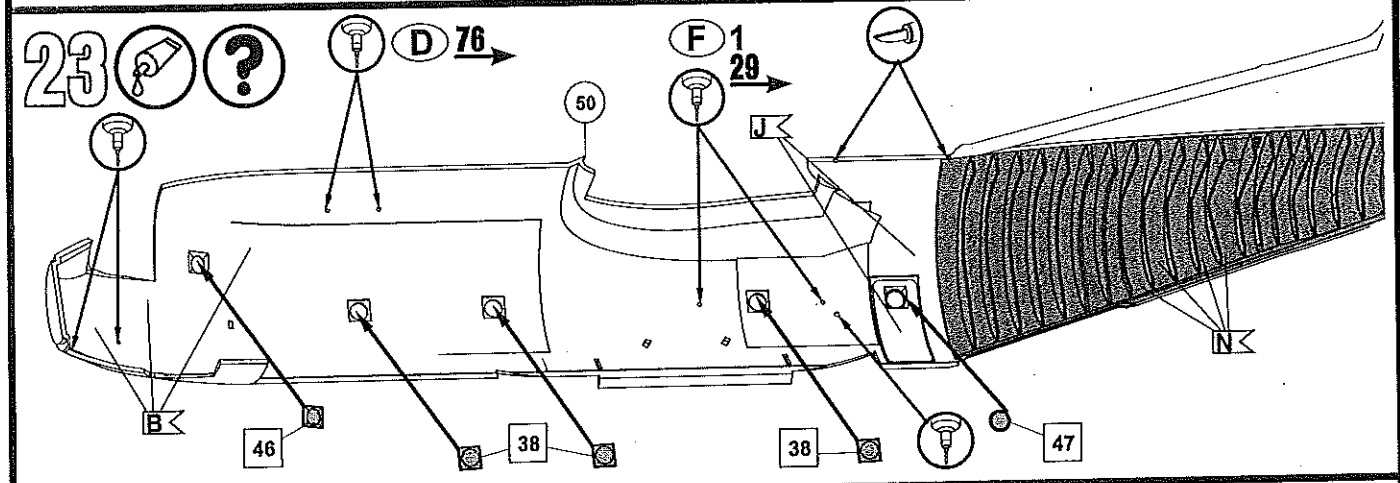
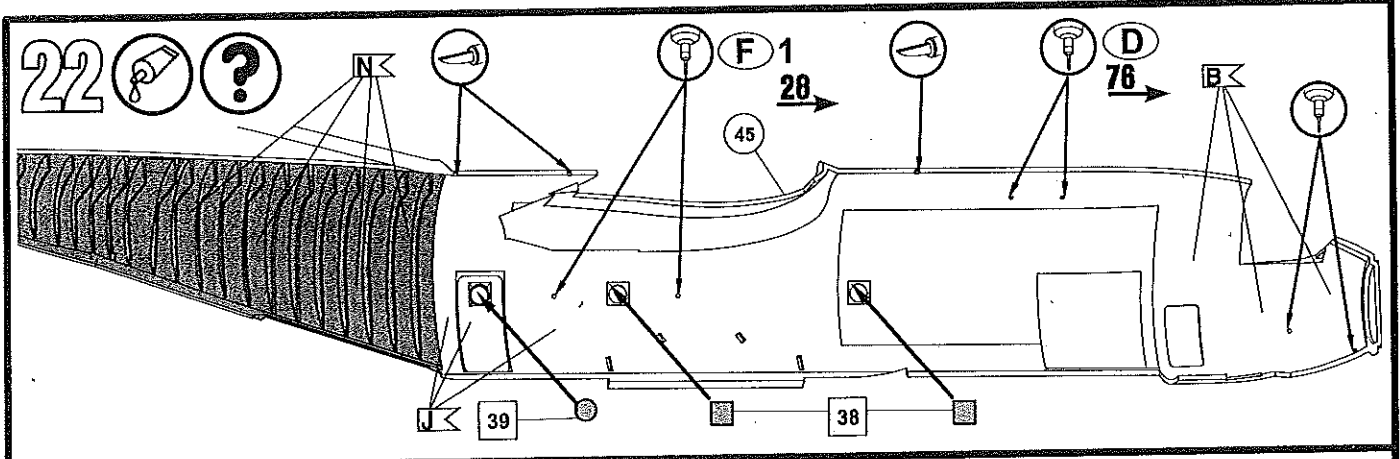

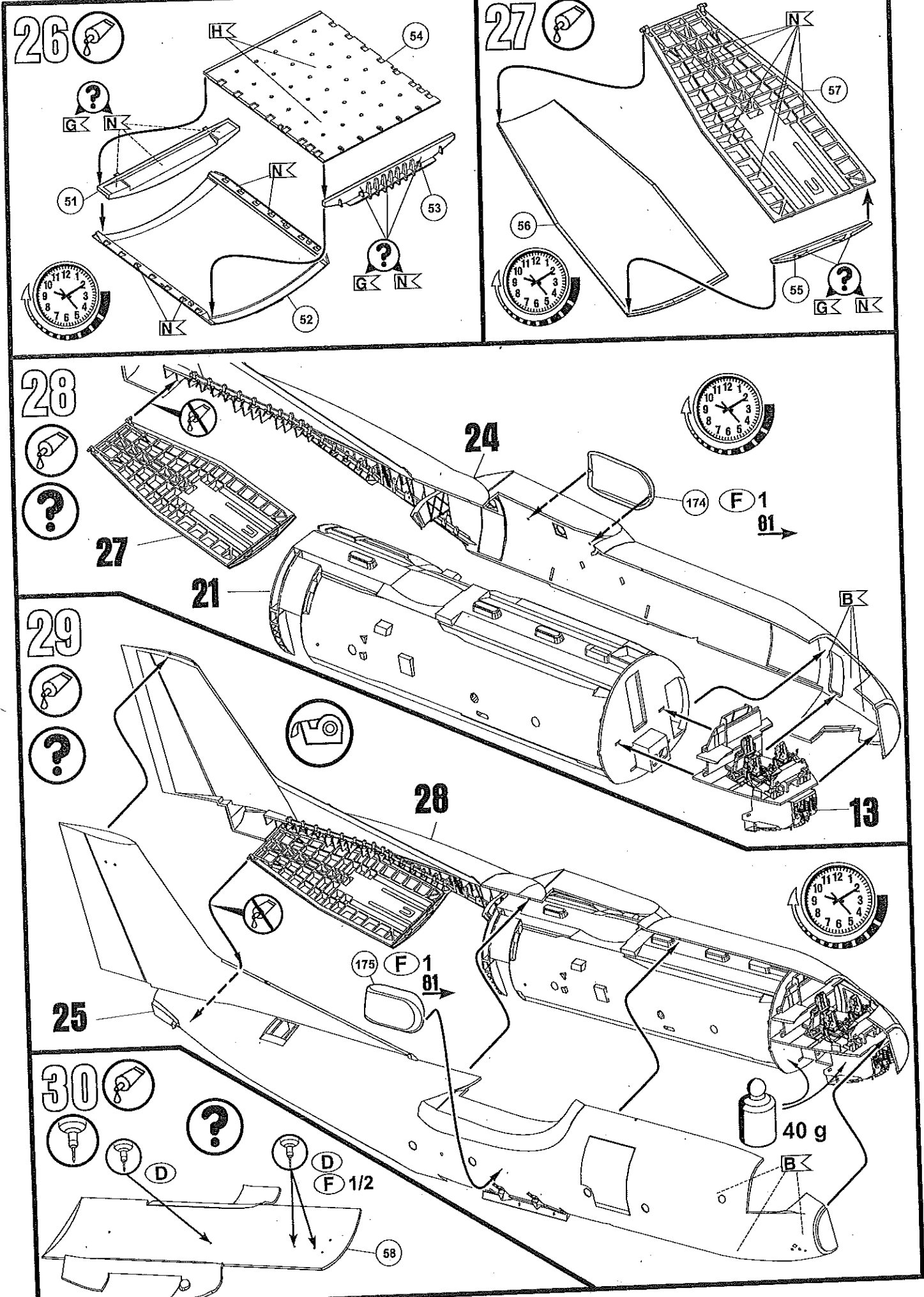

31



30

58



30 g

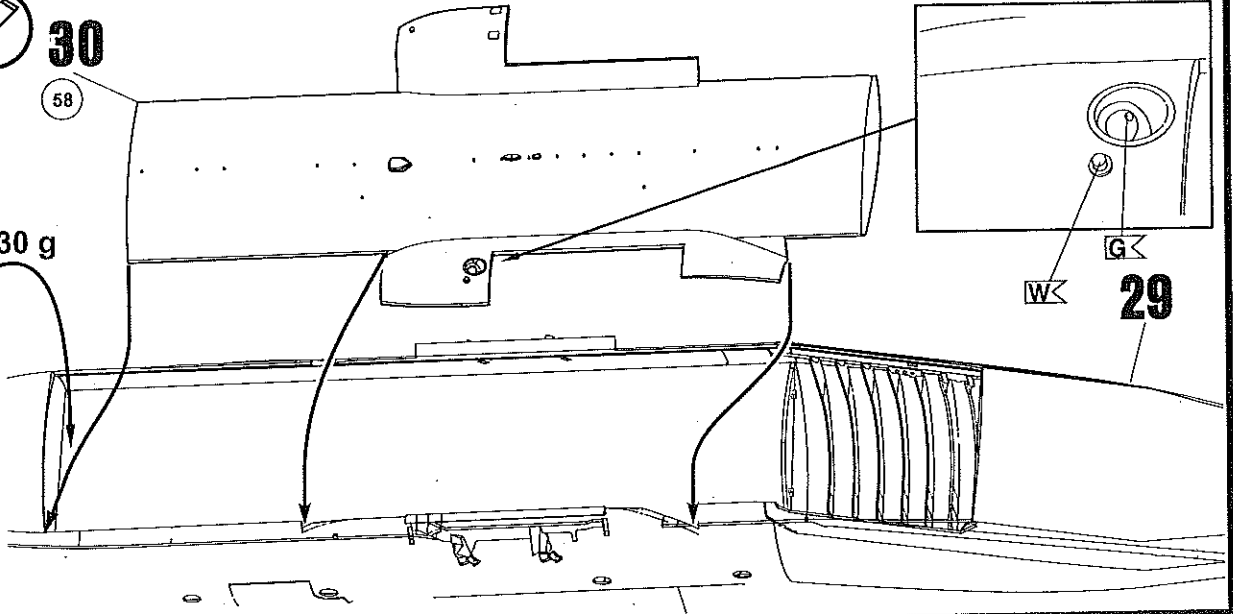

32



64

60

62

D



F 1/2

D

F 1/2

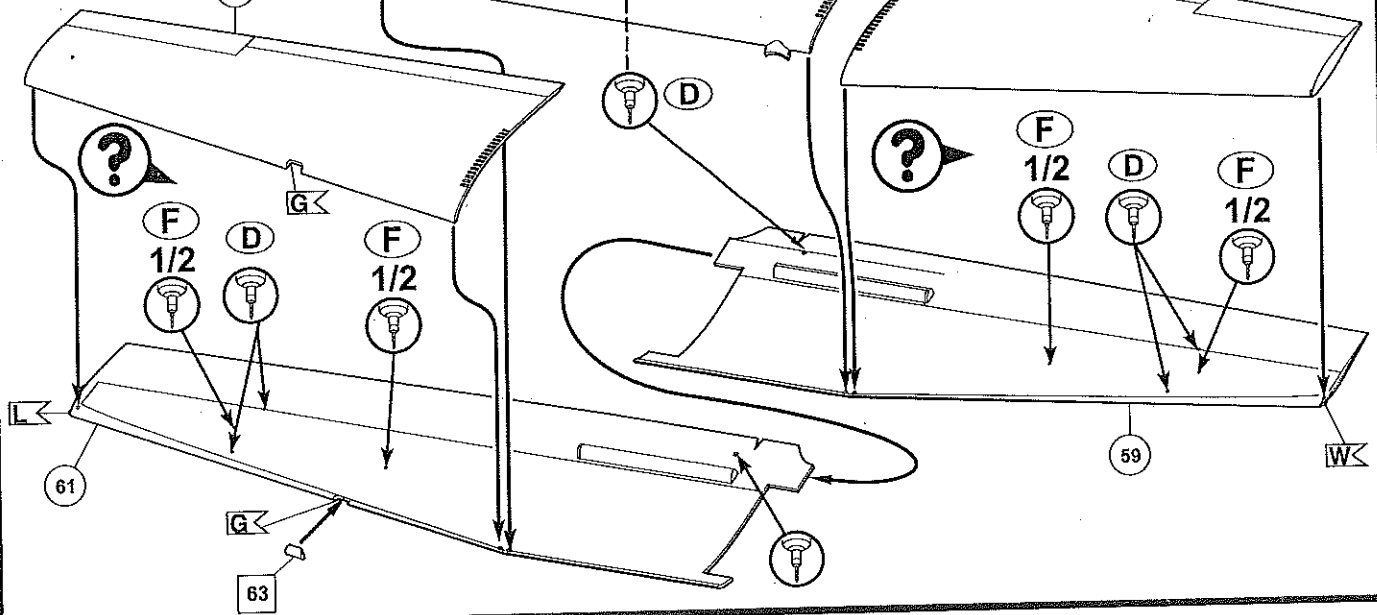

33



67

69

70

68



65

66

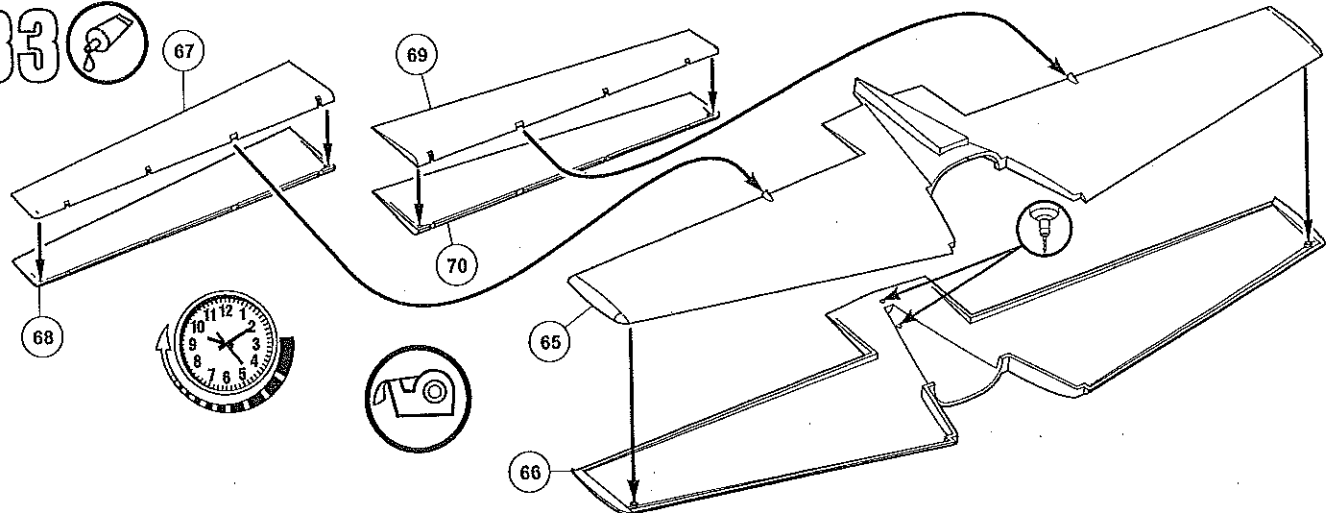

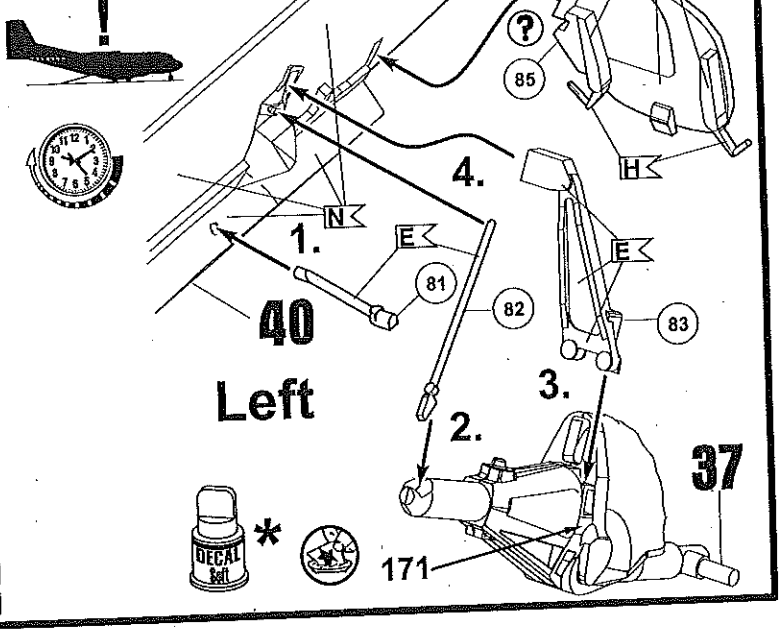
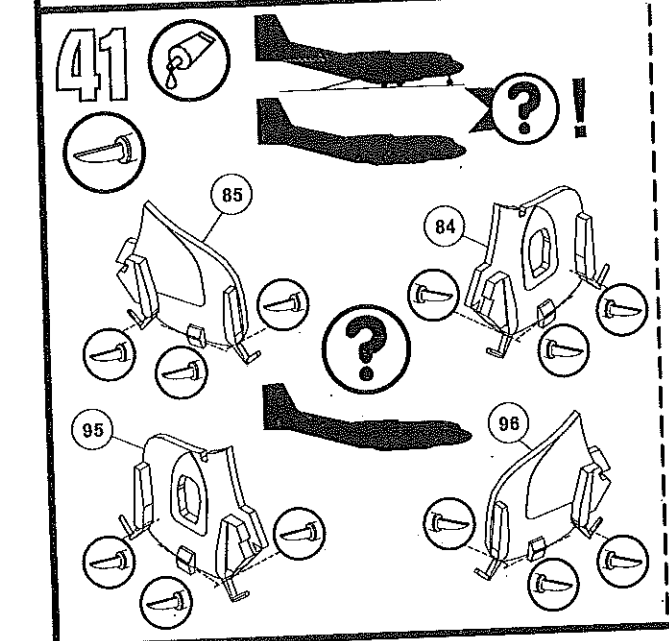
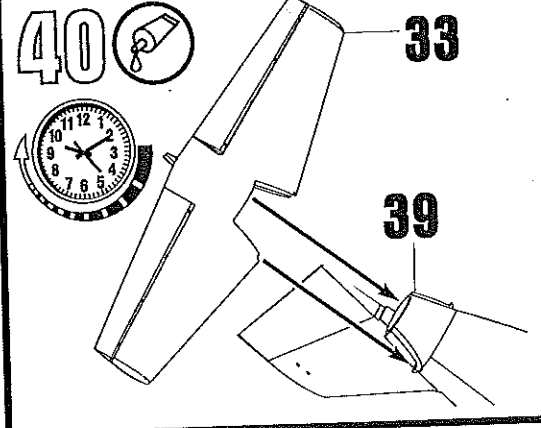
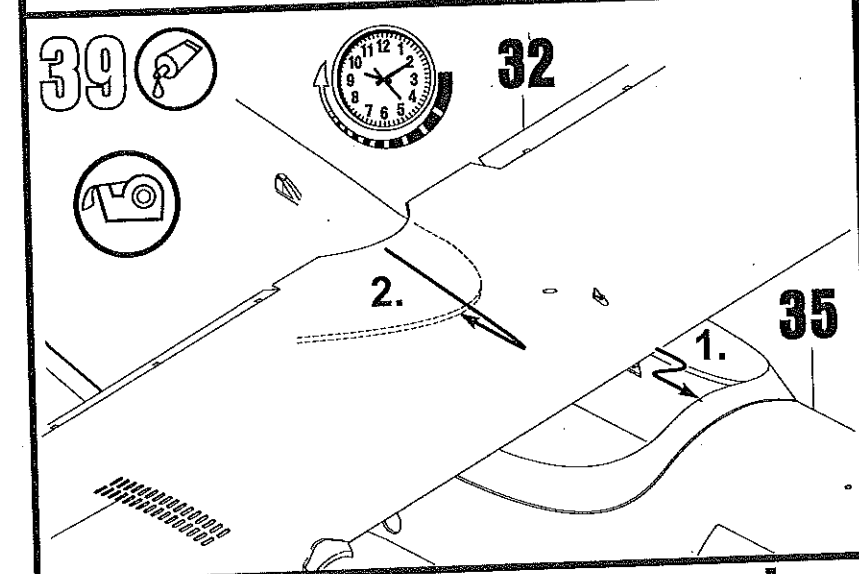
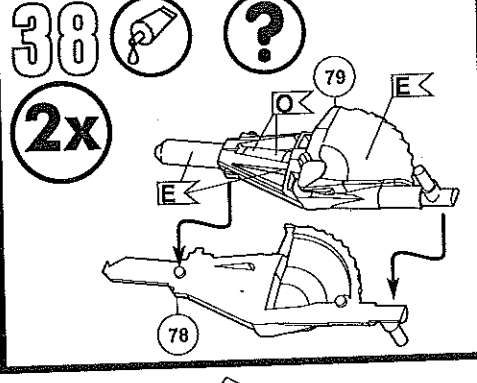
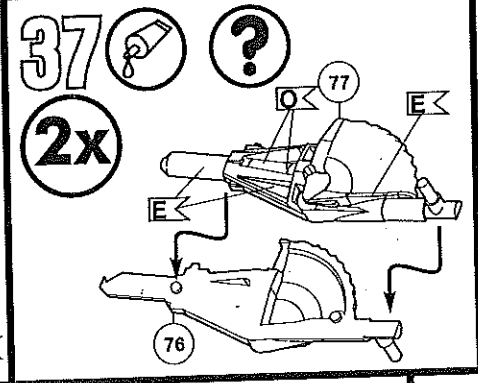
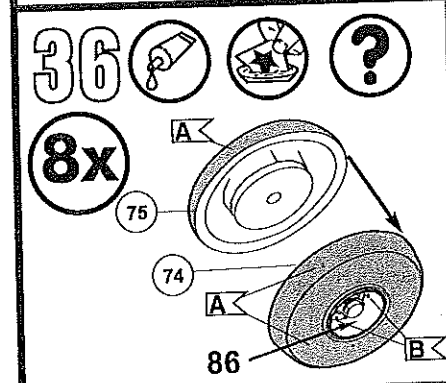
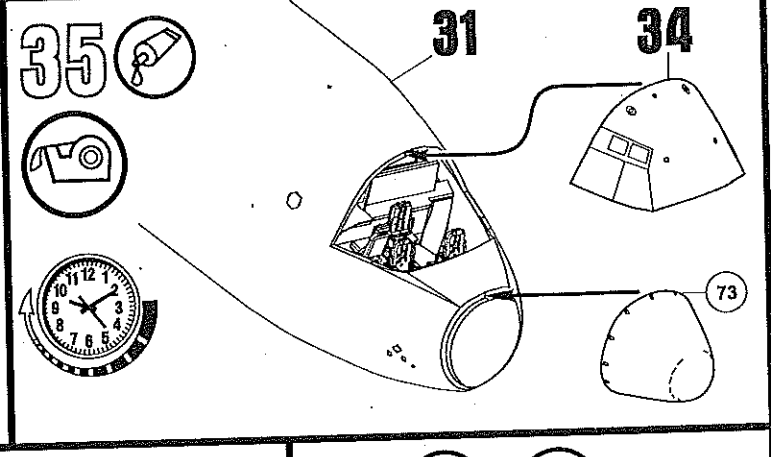
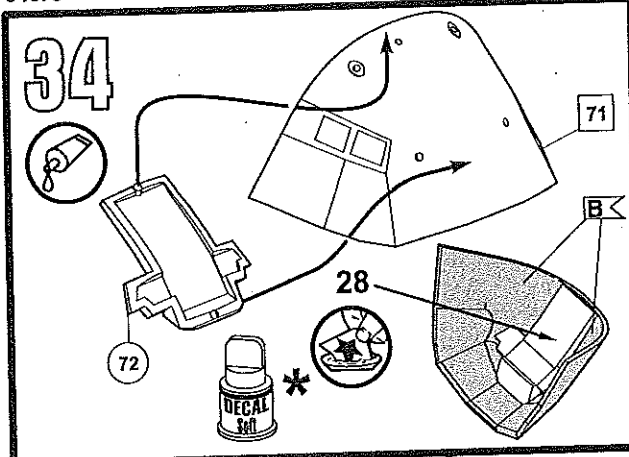

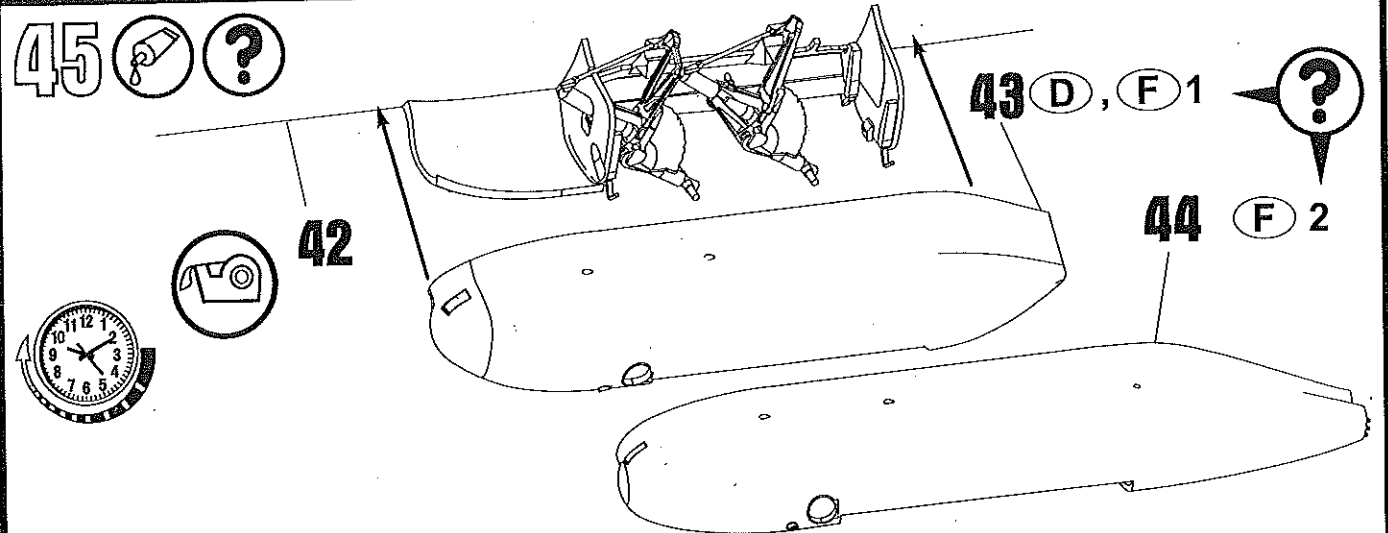
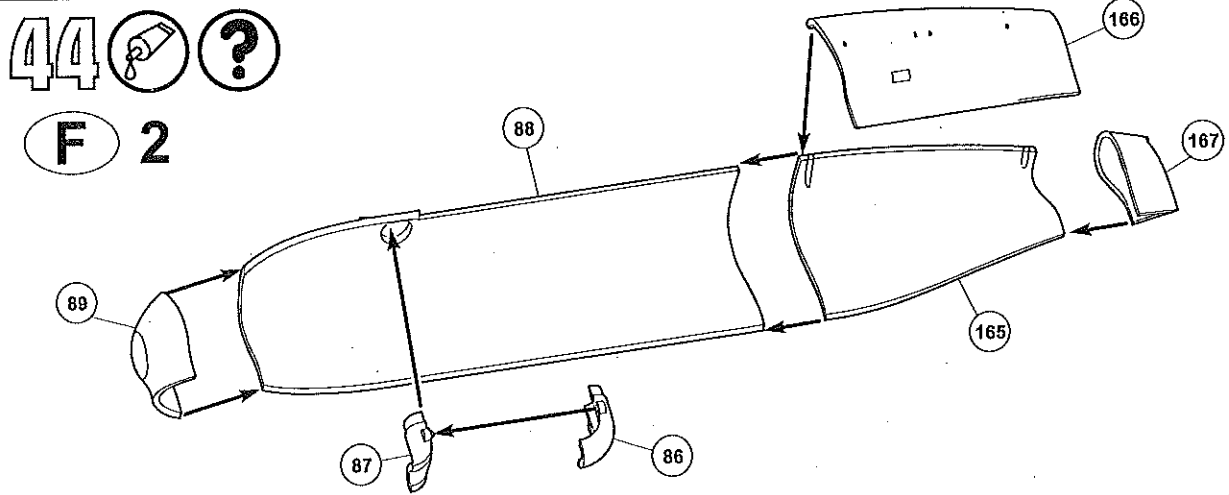
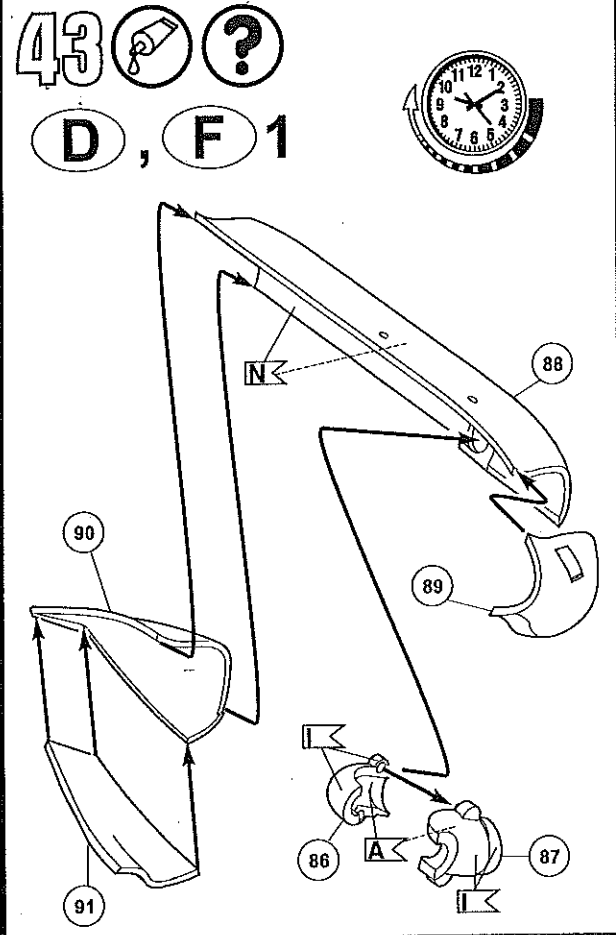
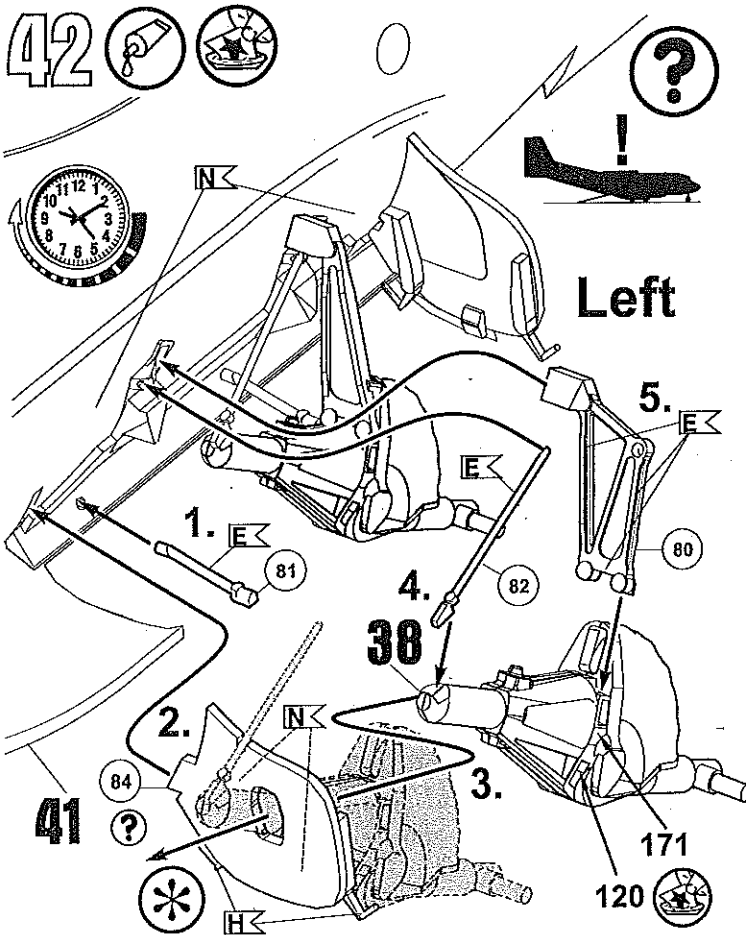

46

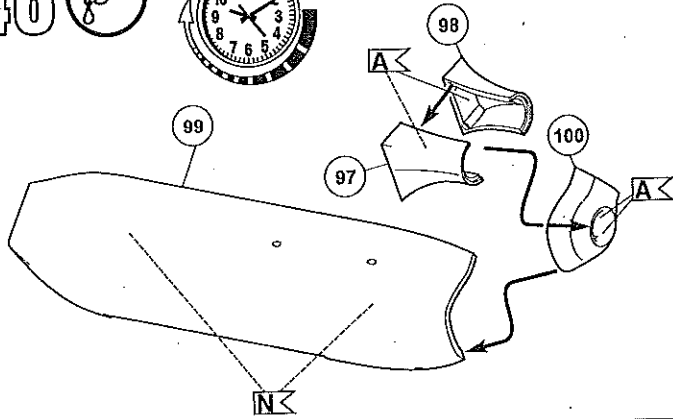

47

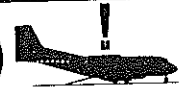

2x

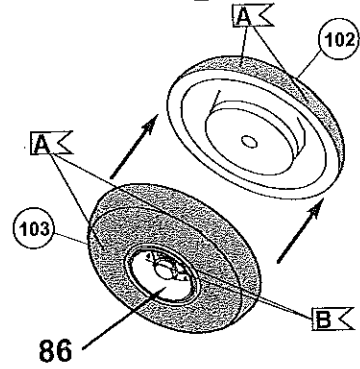

48



Right

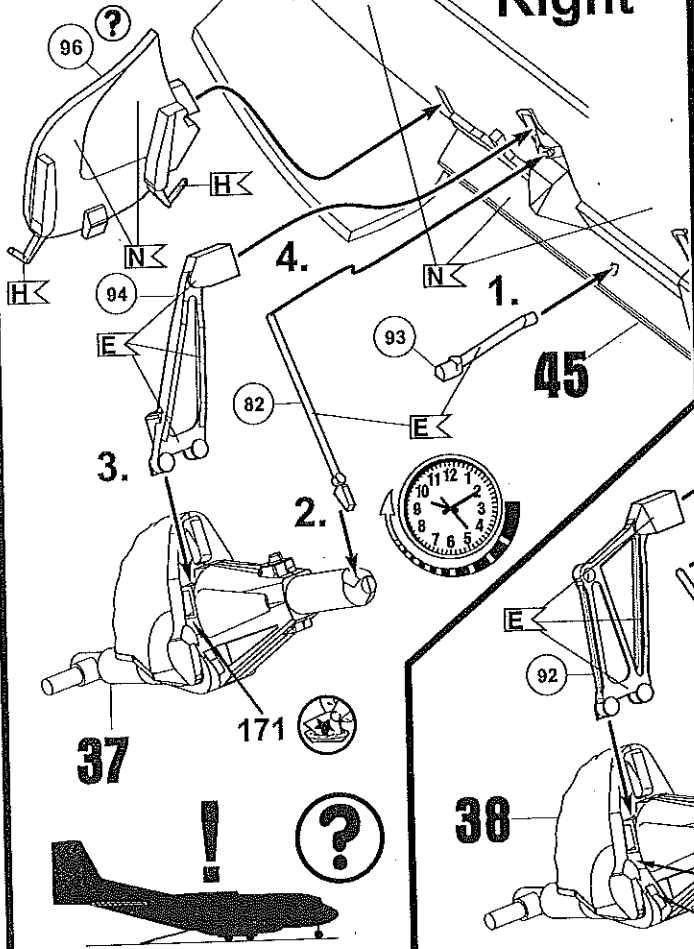

49

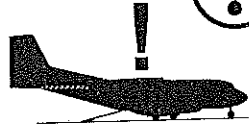

Right

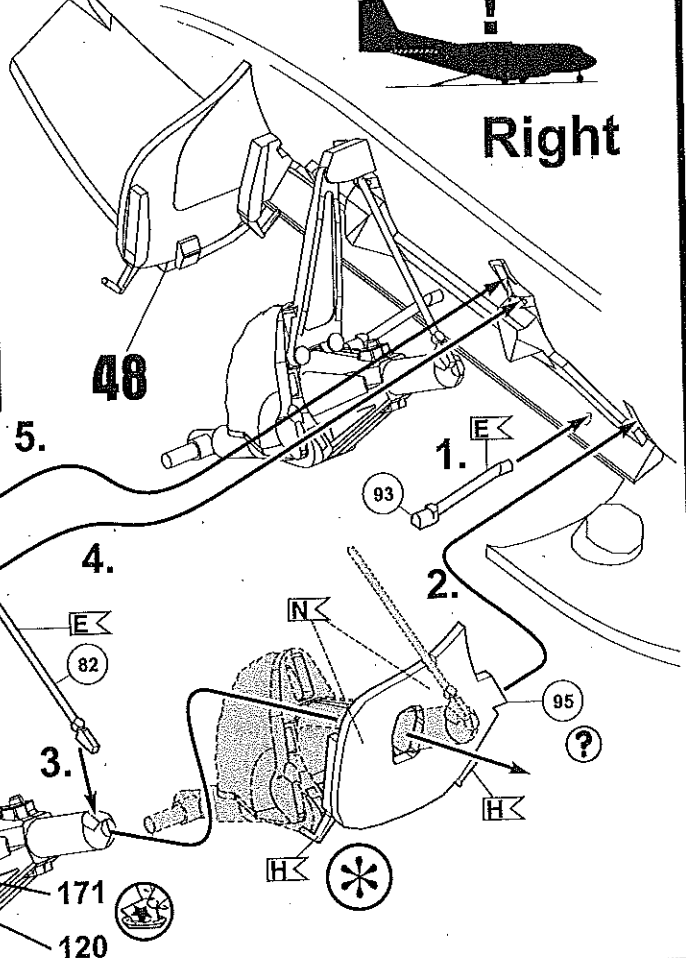

50



46

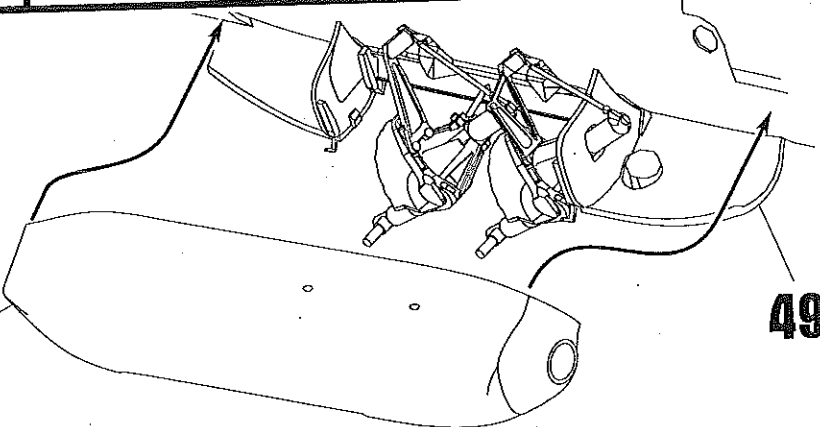

49

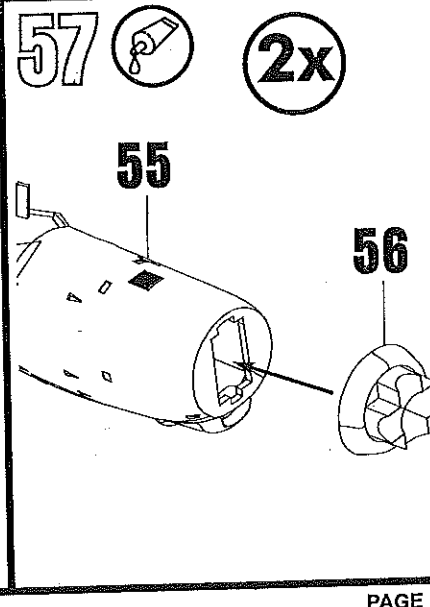
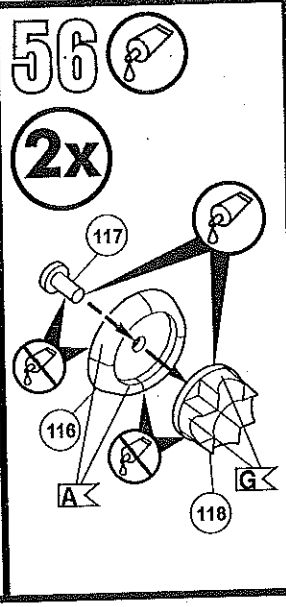
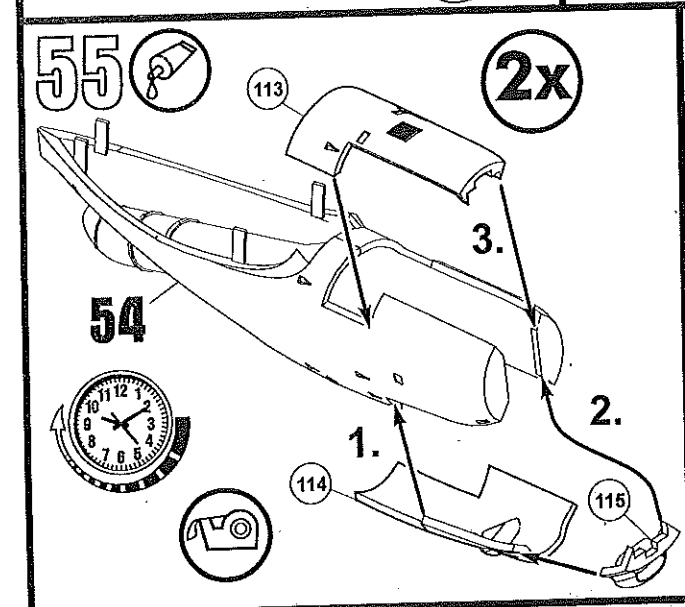
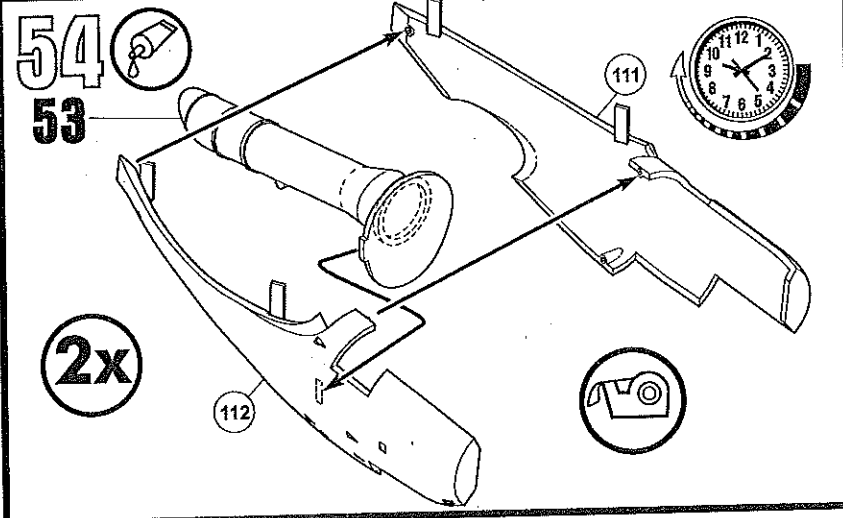
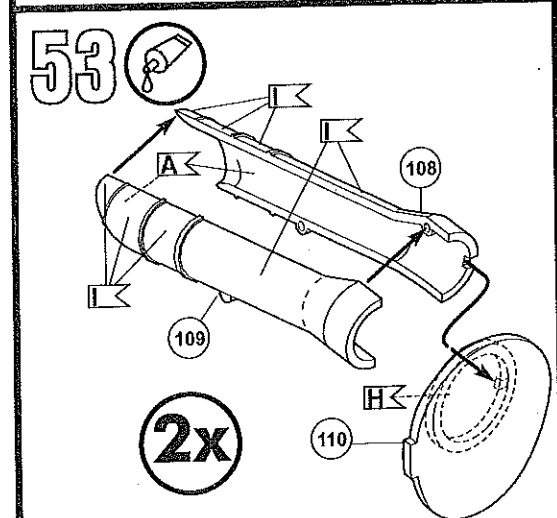
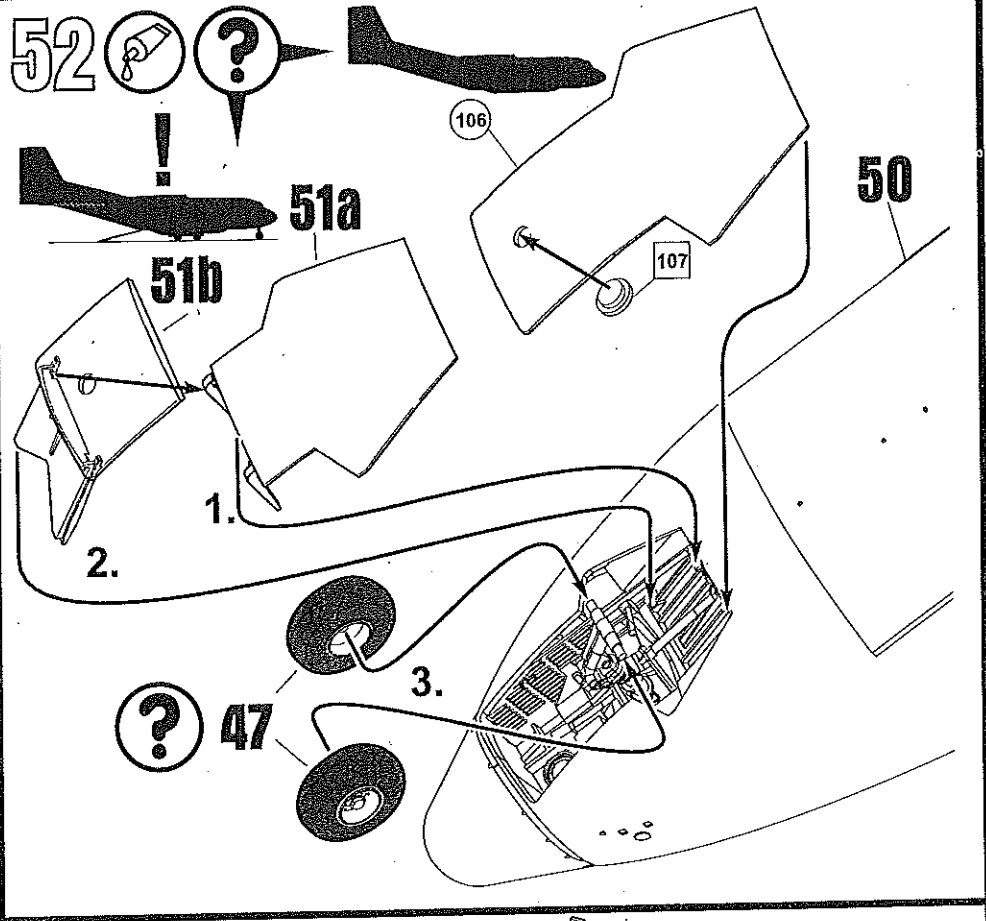
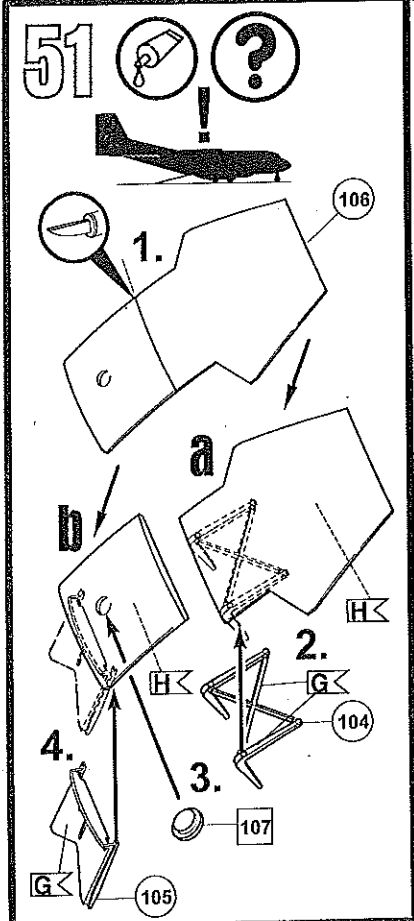

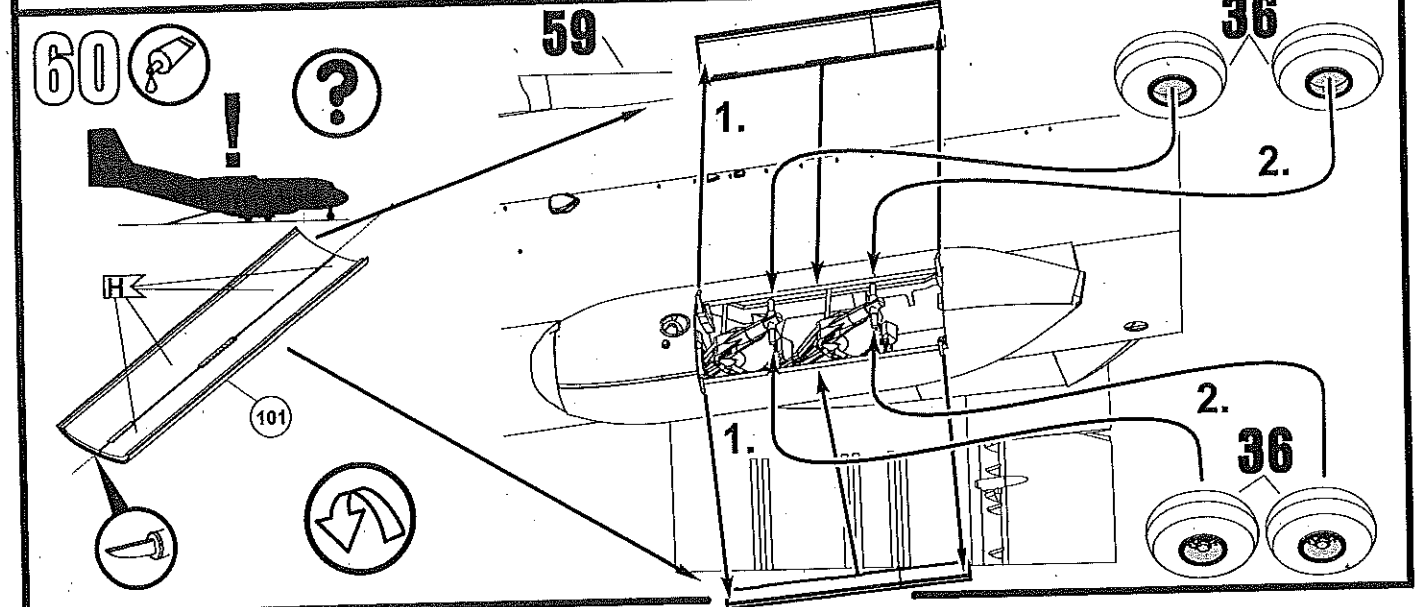
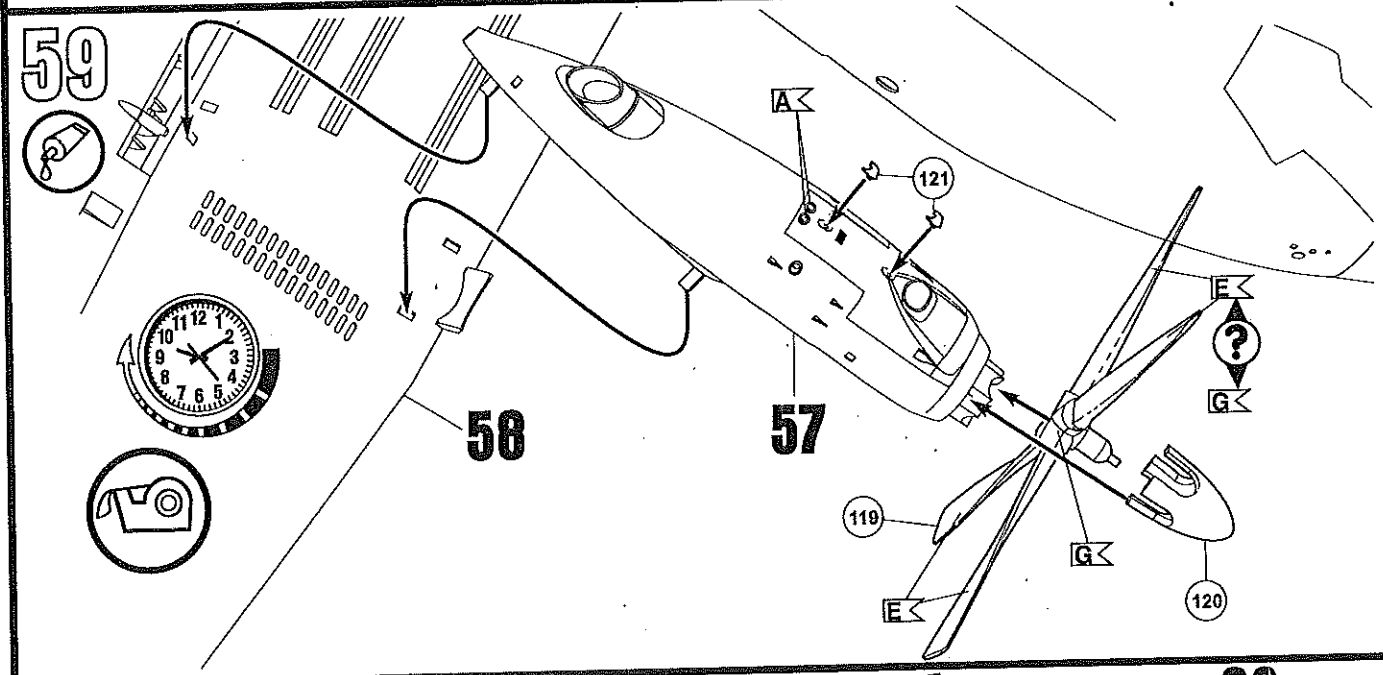
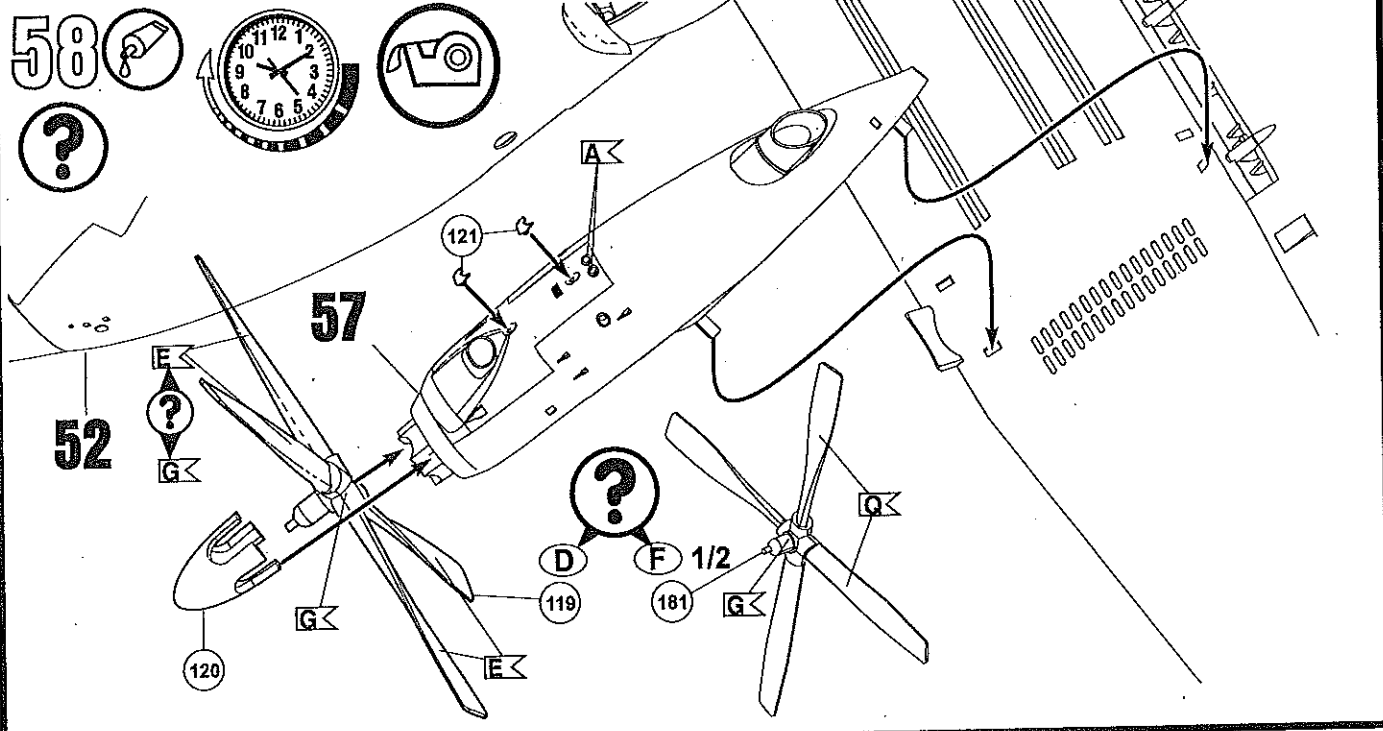



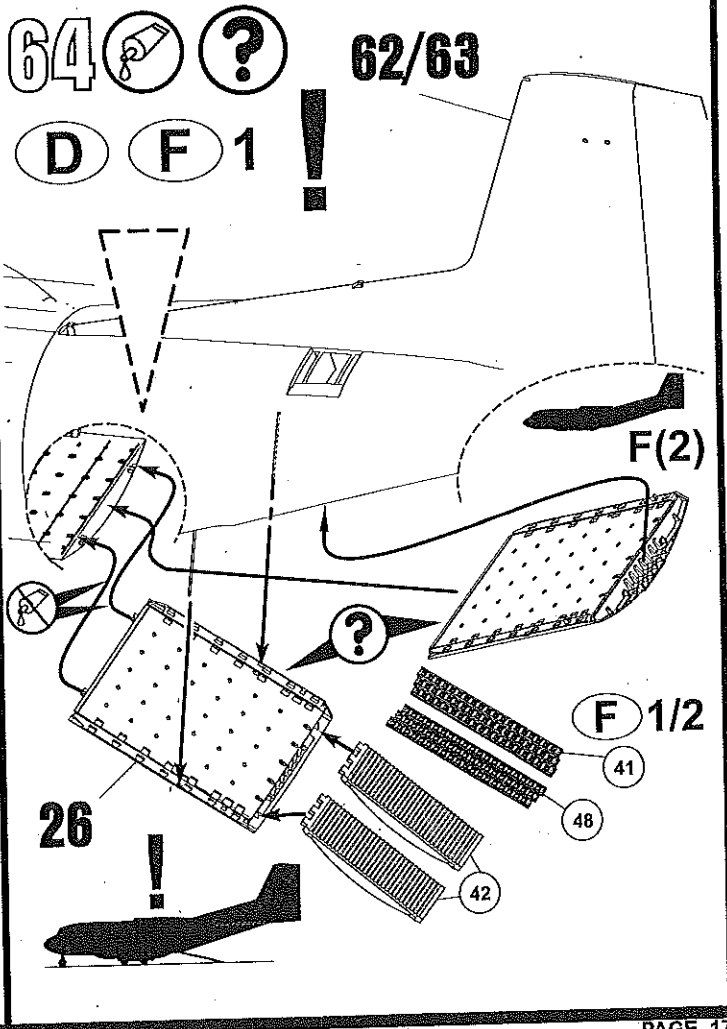
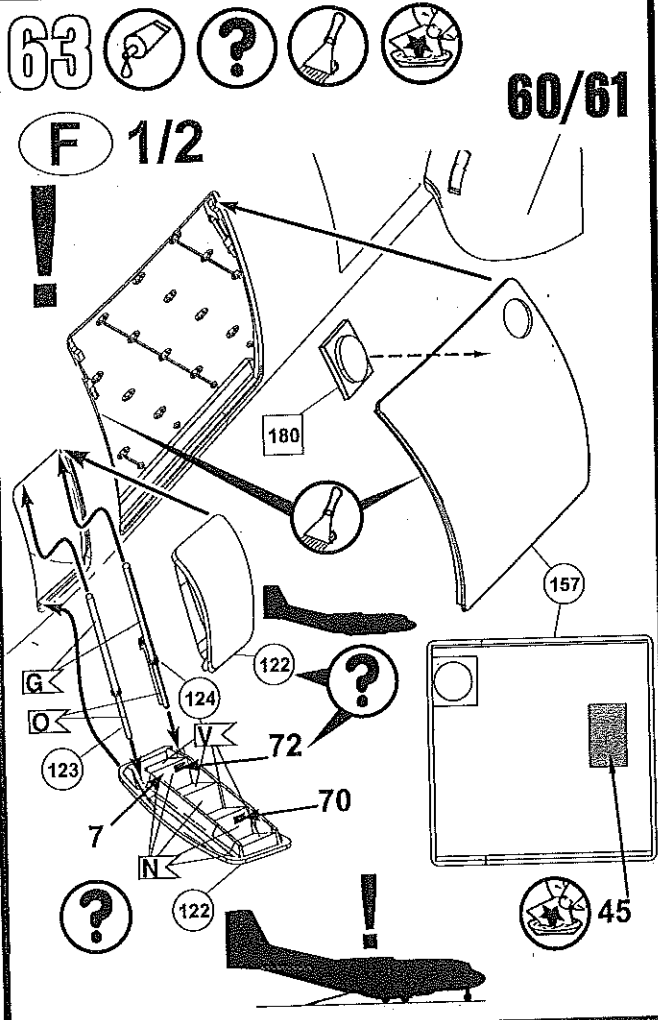
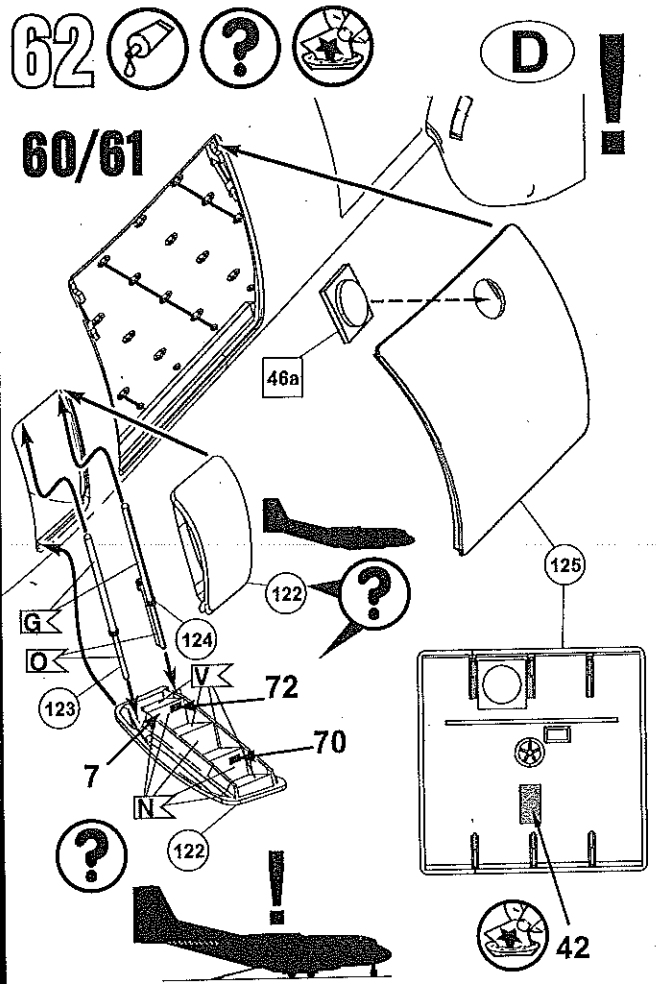
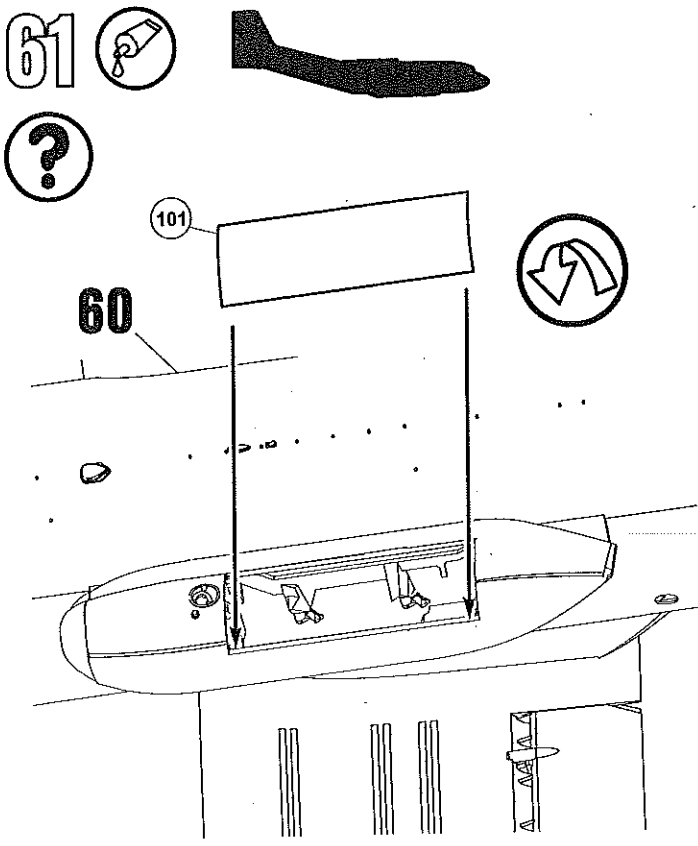

65

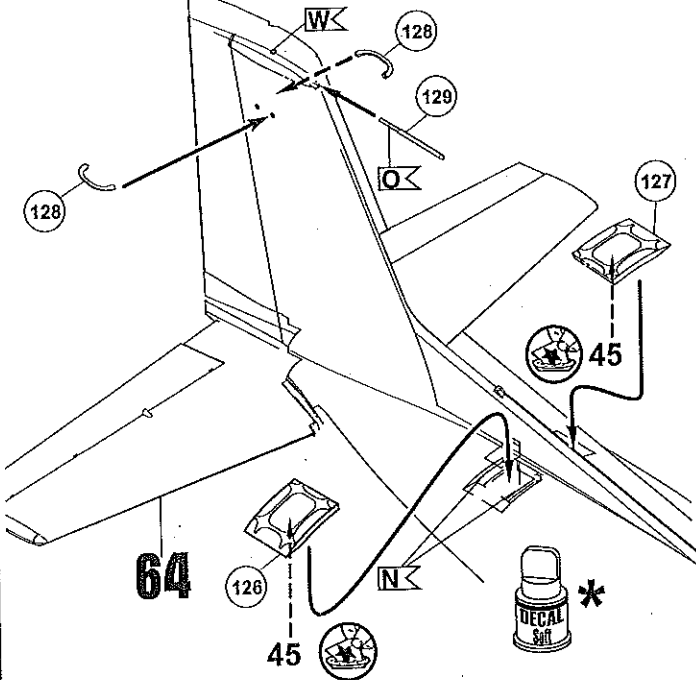

66

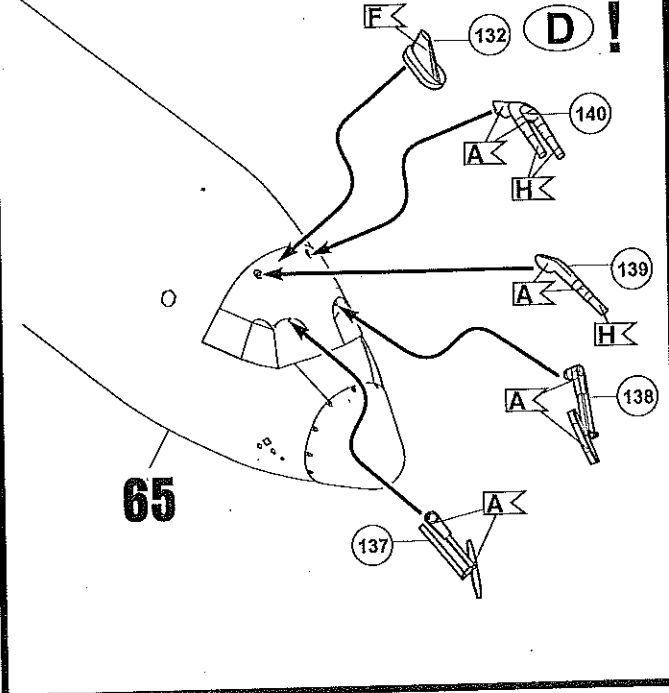

67

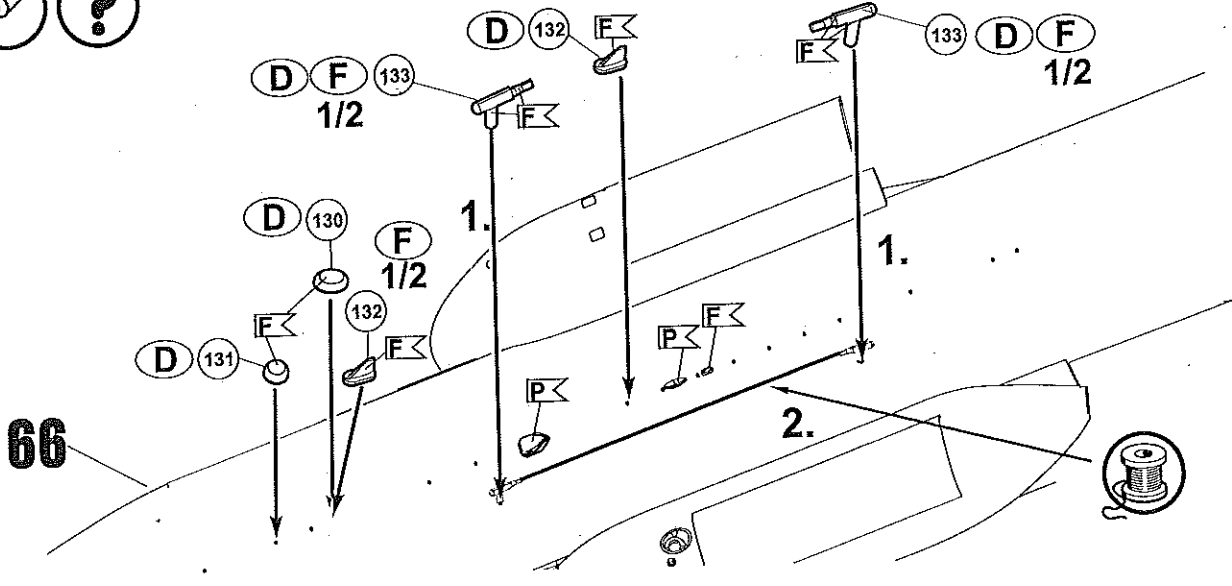

68

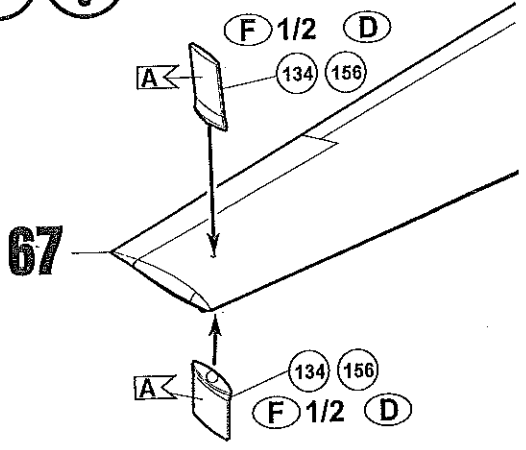

69

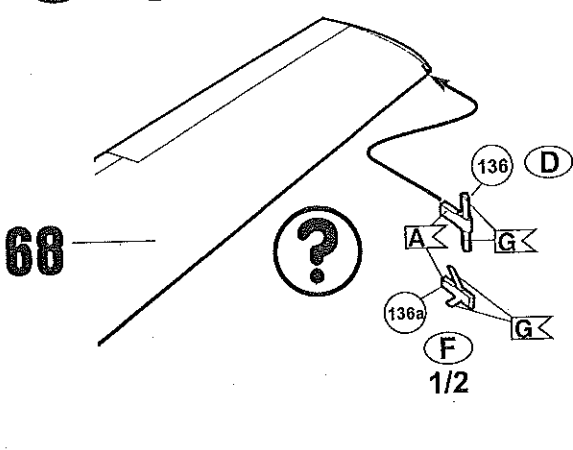

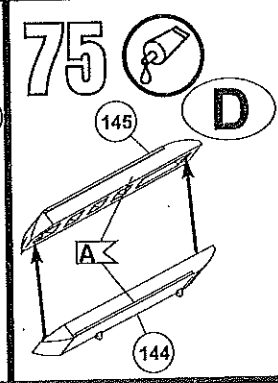
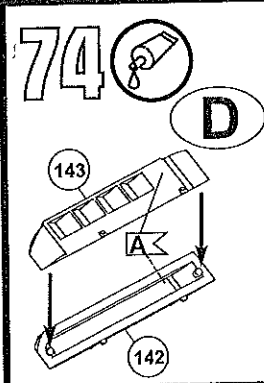
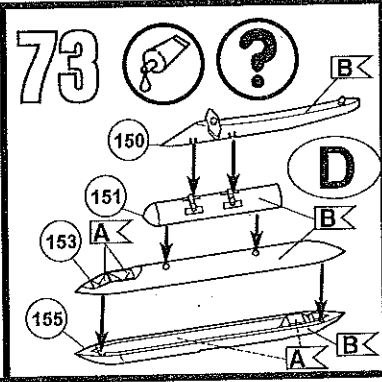
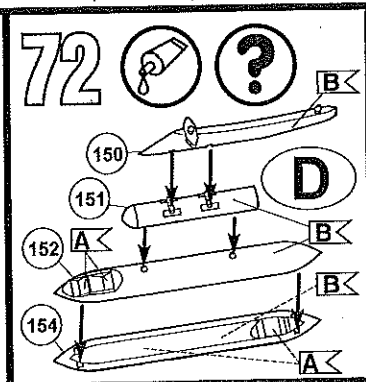
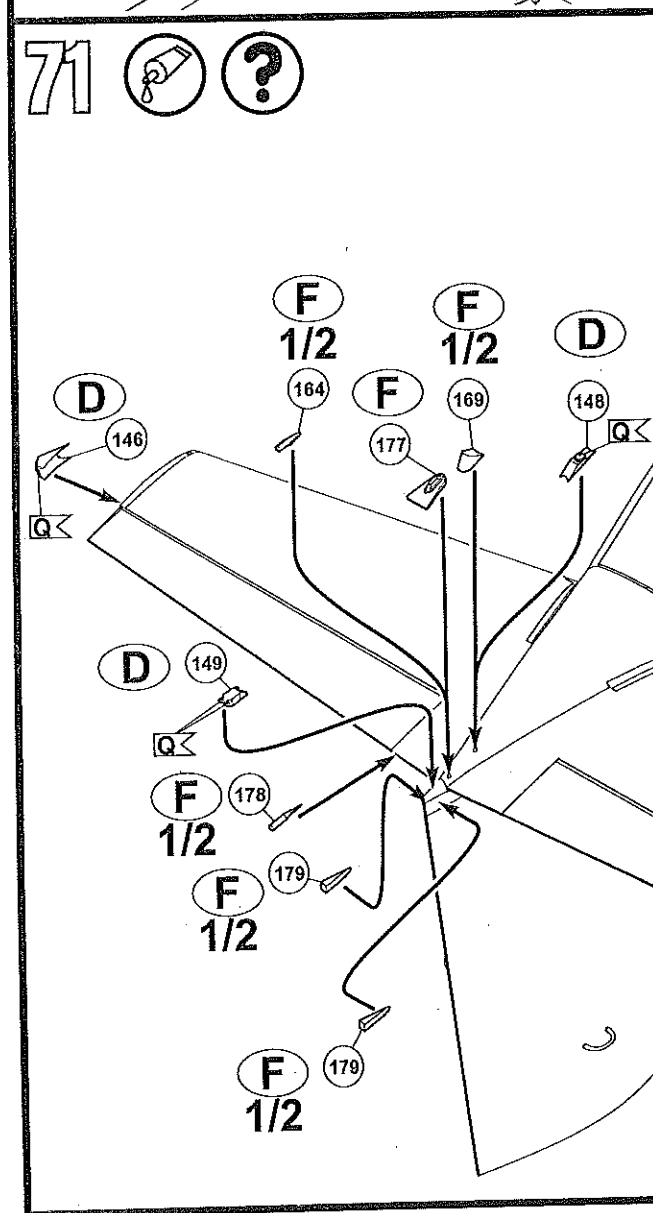
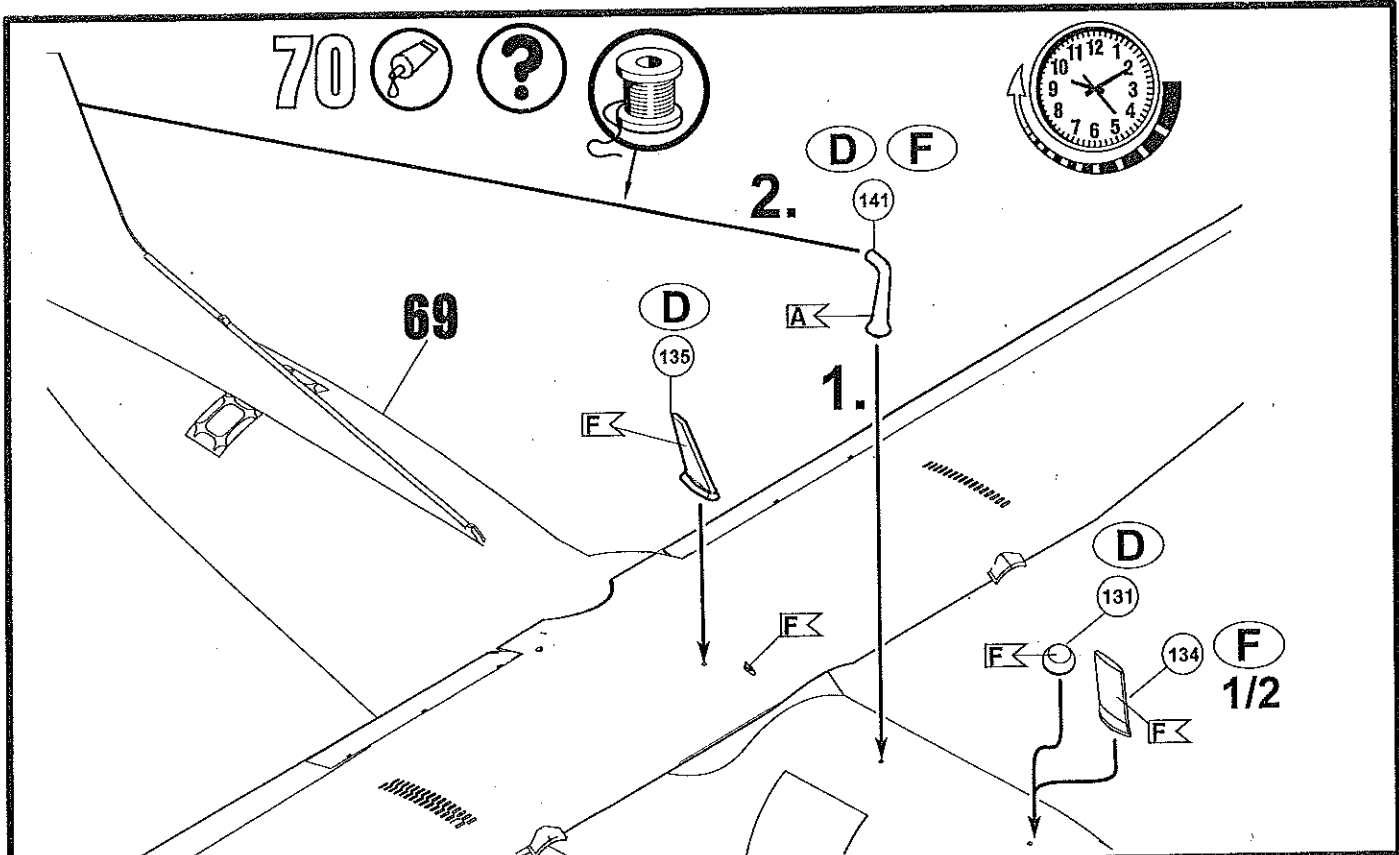

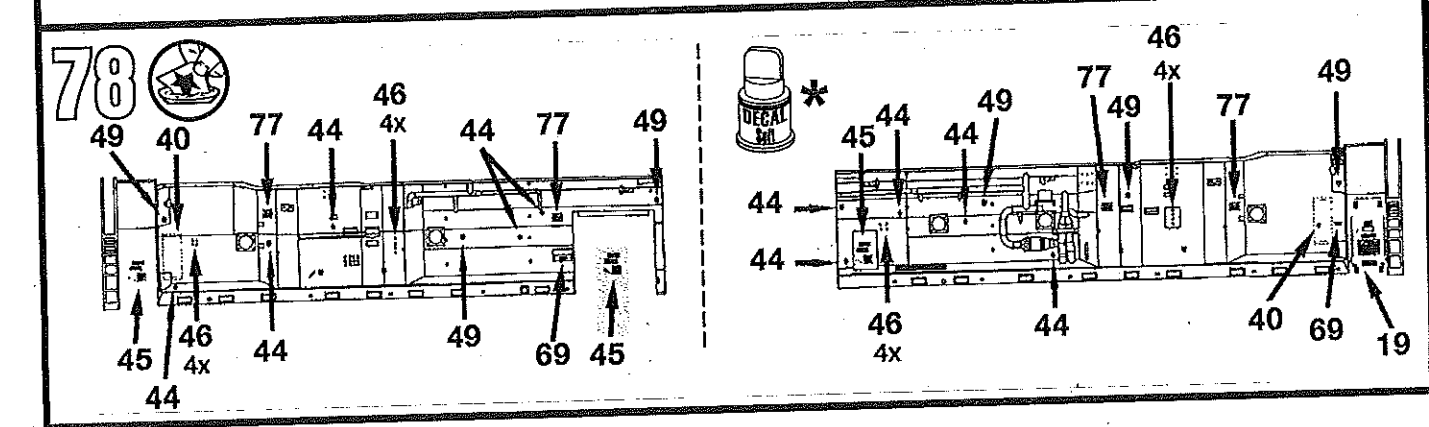
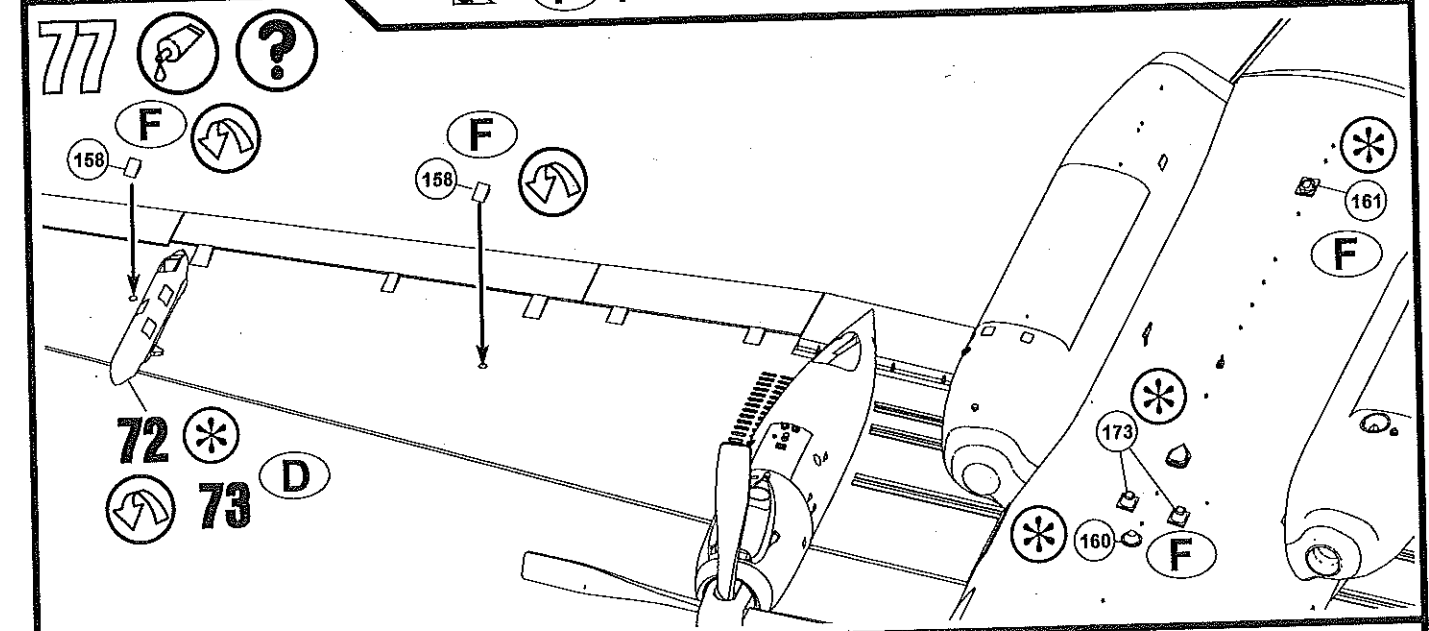
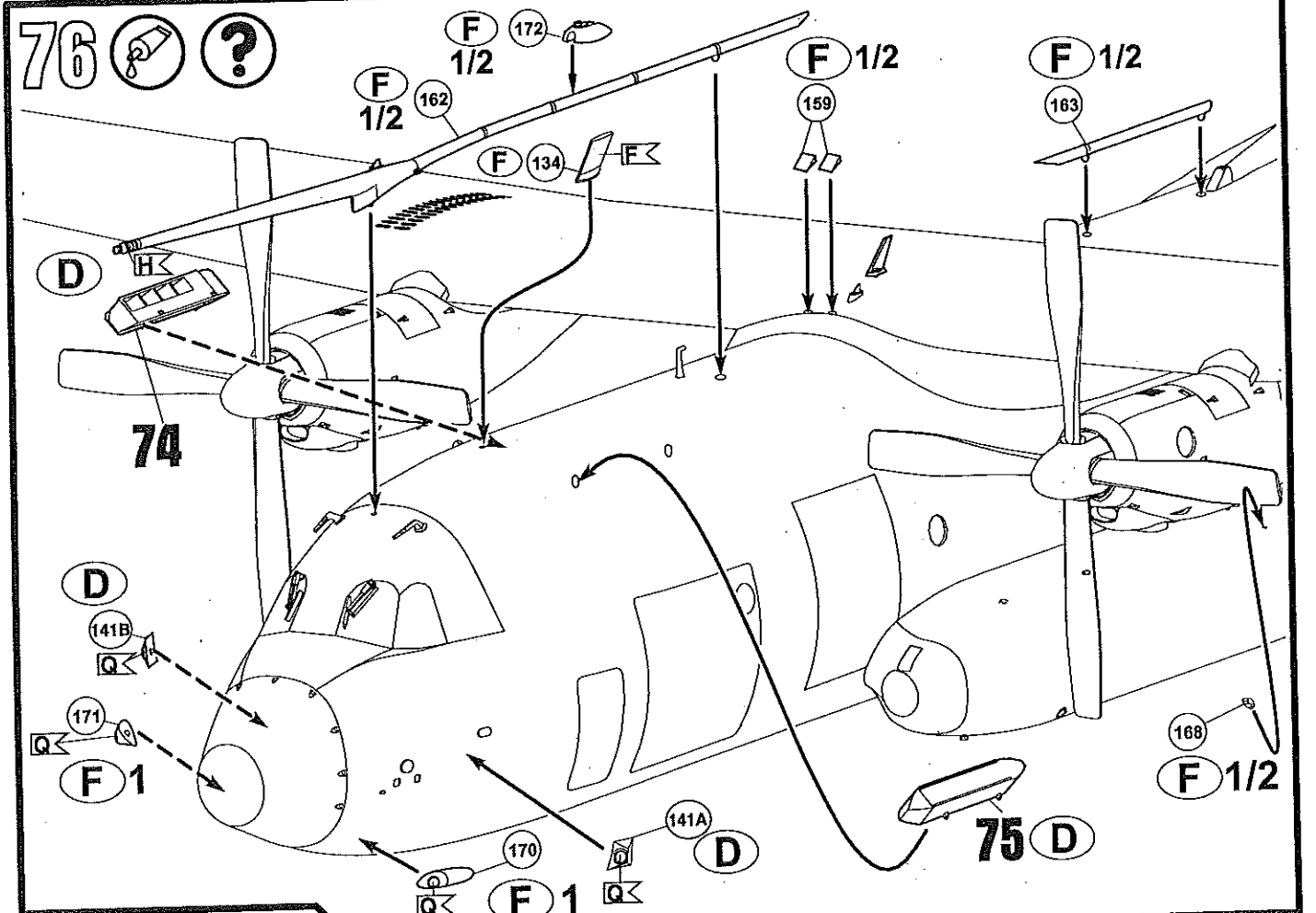

79



C-160D ELoKa Transall LTG 61 of Einsatzgeschwader Mazar-e-Sharif  
at Strategischer Lufttransportstützpunkt Termez, Usbekistan;  
April 2010

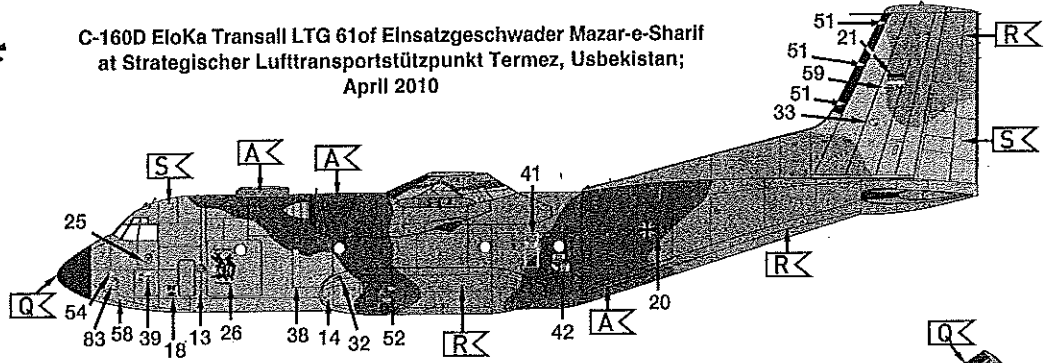

Decalplacement on Propeller  
- both Side -

2 x

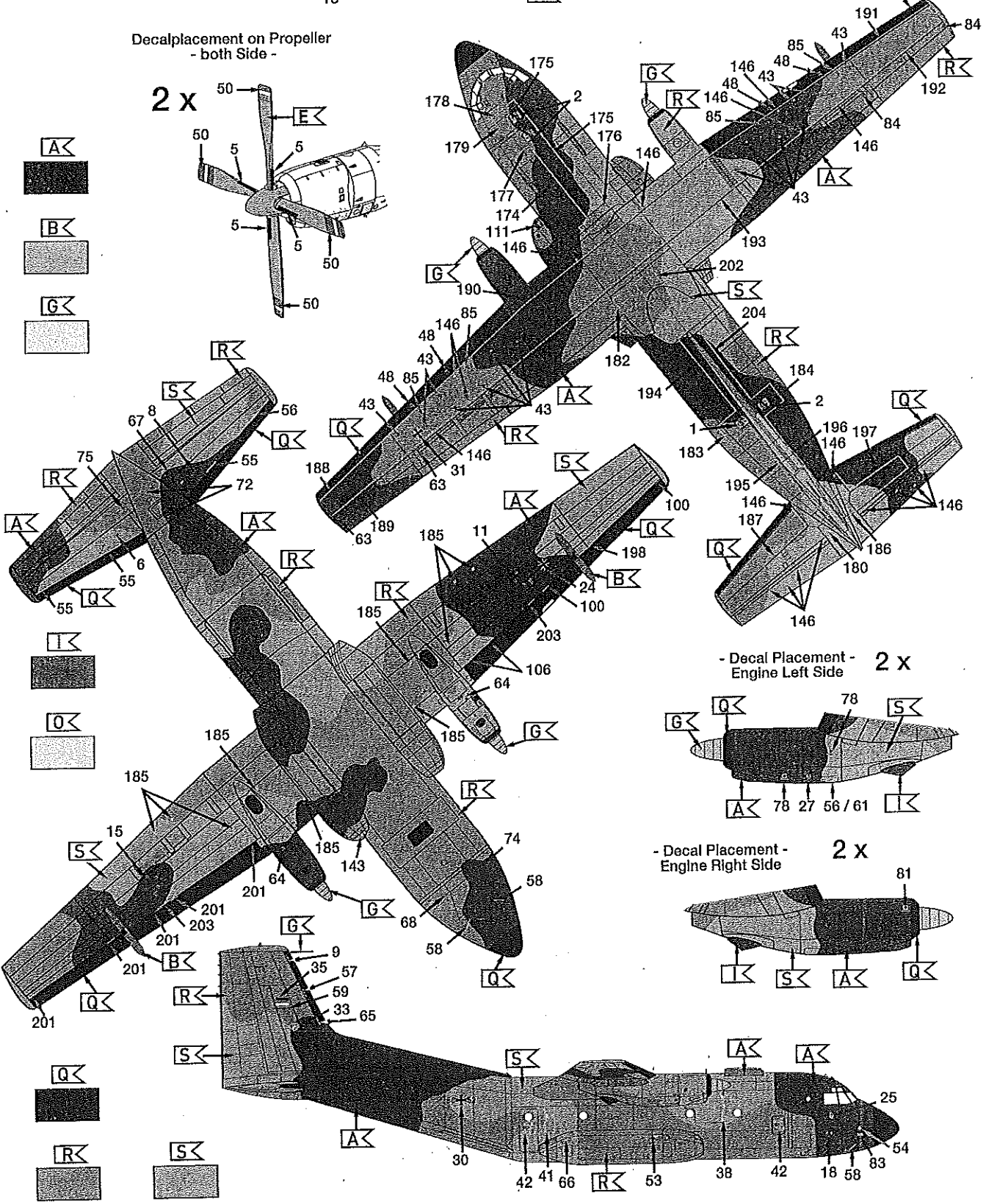
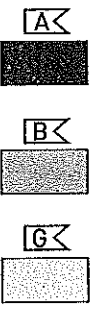
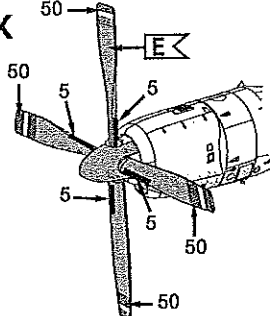

- Decal Placement - Engine Left Side 2 x

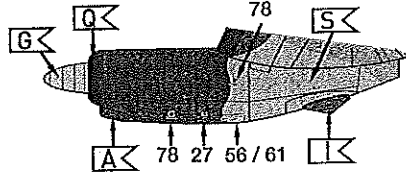

- Decal Placement - Engine Right Side 2 x

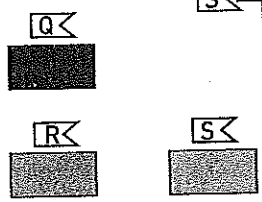
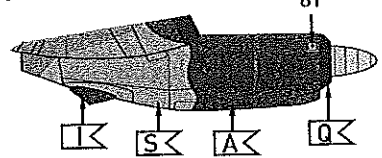



# Version F (1)

C-160NG Armee de l'Air of Escadre de Transport  
ET 2/64 „Anjou“, BAN 105 Evreux-Fauville, France, June 2010

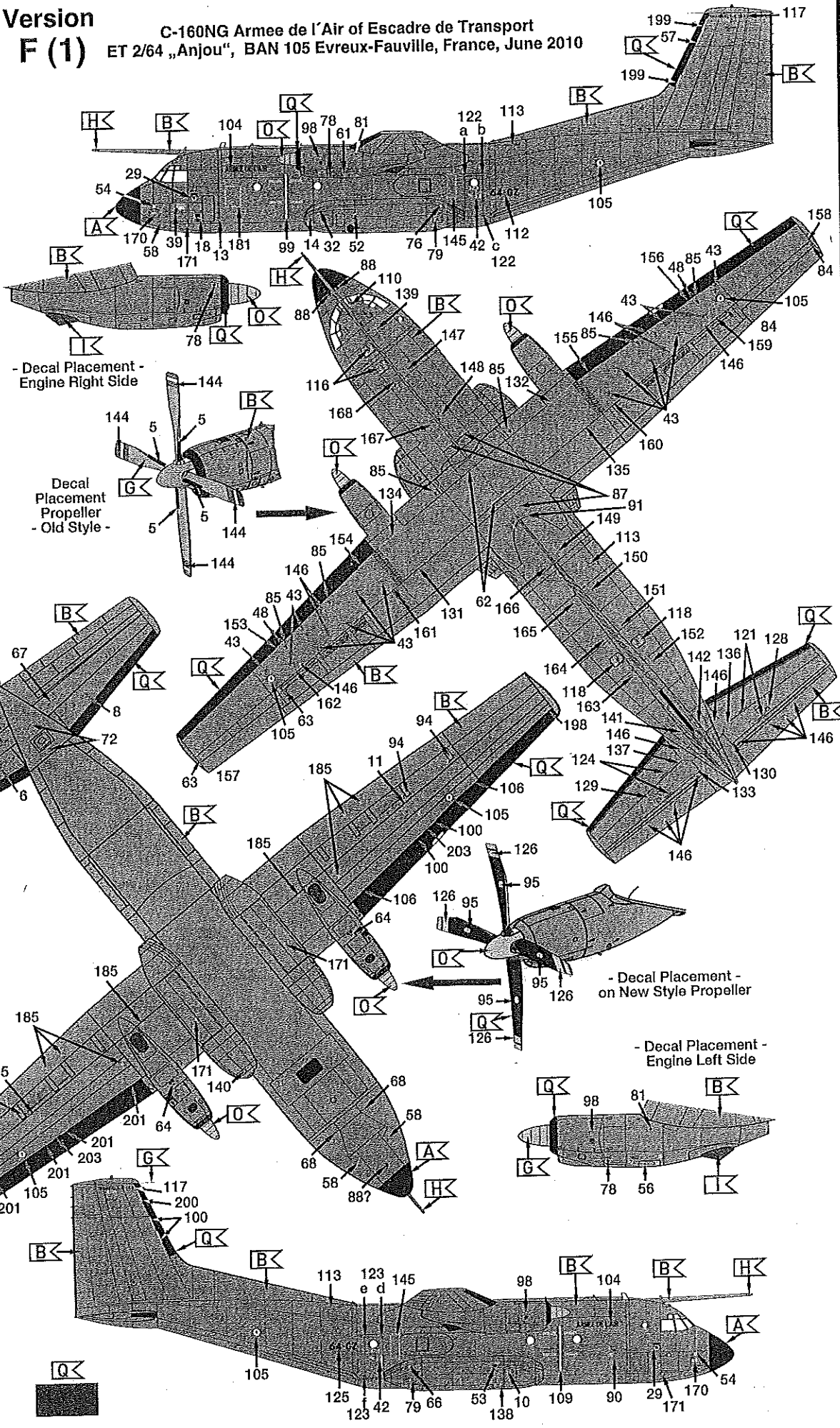

- Decal Placement -  
Engine Right Side

Decal  
Placement  
Propeller  
- Old Style -

- Decal Placement -  
on New Style Propeller

- Decal Placement -  
Engine Left Side

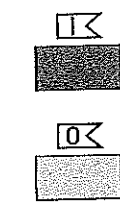
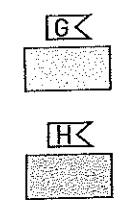
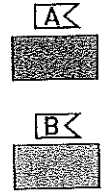

# 81 Version F (2)

C-160NG Armee de l'Air of Escadre de Transport  
ET 2/64 „Anjou“, BAN 105 Evreux-Fauville, France, June 2010

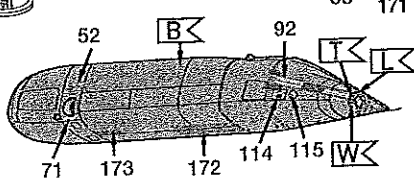
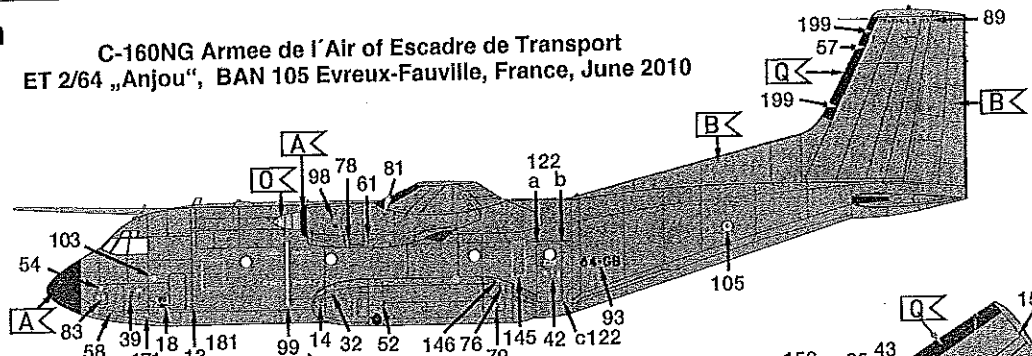

Installation of Air Refuelling „Basket“

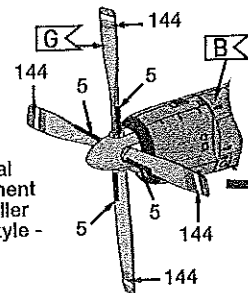

Decal Placement Propeller - Old Style -

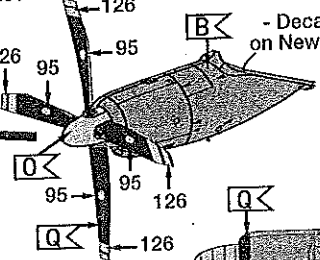
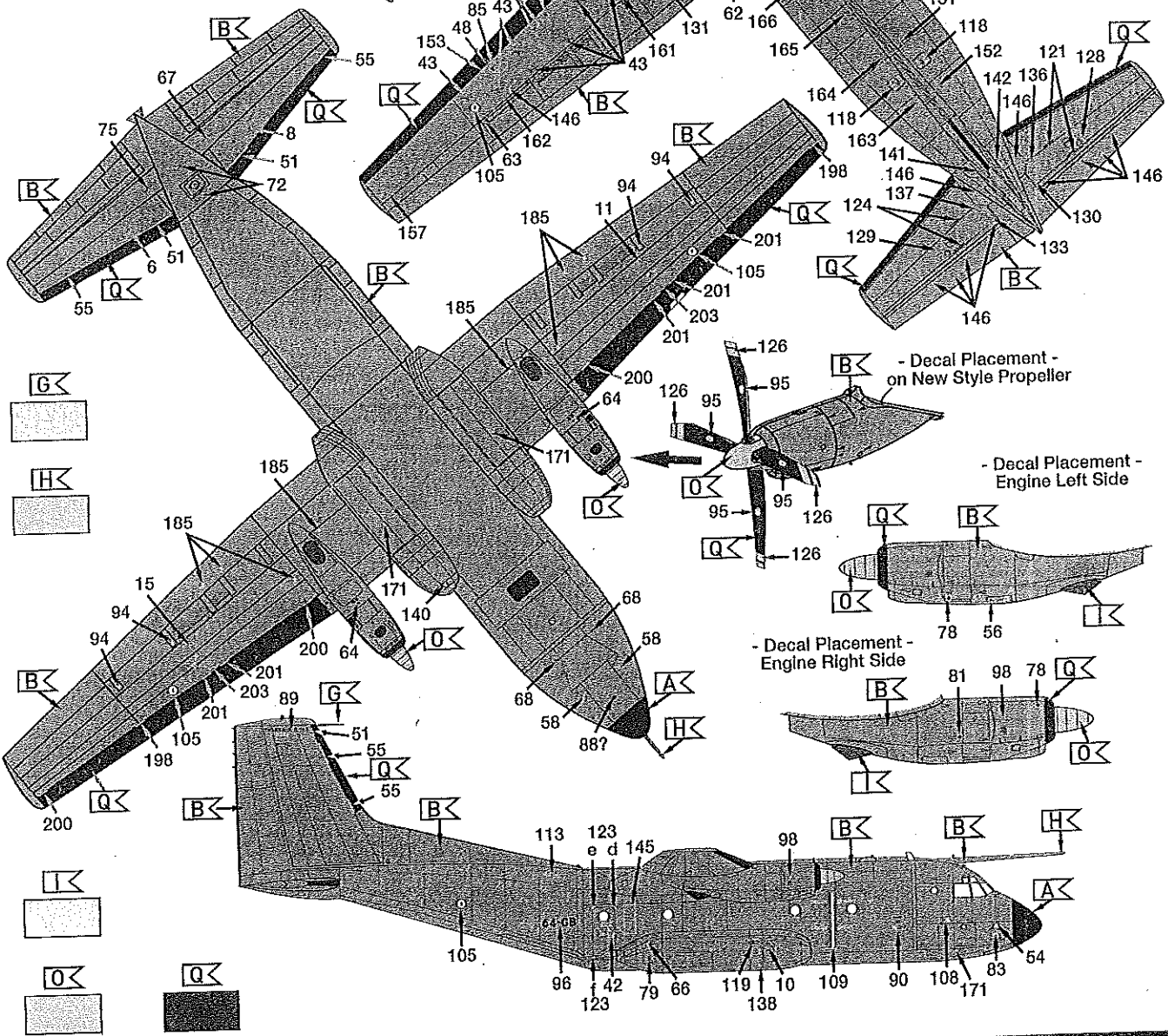
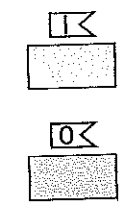
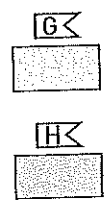

- Decal Placement - on New Style Propeller

- Decal Placement - Engine Left Side

- Decal Placement - Engine Right Side

