

450MX MOTOR 關於450MX馬達



This new Brushless motor developed by the ALIGN POWER R&D TEAM, is packed with the latest, cutting edge technology available today. It features exceptional levels of high-torque power. The 450MX utilizes an 6-pole outrunner stator-rotor and unrivaled Ndfcb extra strong magnets that traditional magnets cannot compare to. Also included is a high temperature, wear-resisting, low friction, double ZZ high efficiency bearing. The 450MX will be the most revolutionary motor operating on low current amperage, and delivering high torque to RC models.

由亞拓動力團隊獨家研發出新款的無刷馬達，具有超高扭力特色，採用9槽矽鋼片、6極外轉子以及傳統磁鐵無法比擬的釹鐵鈷超強磁鐵，搭配高溫耐磨的雙ZZ超高效能精密軸承設計，電流低、扭力強，將是下一波動力革命中最具代表性的一顆星。

SPECIFICATION 尺寸規格

ILLUSTRATION 接線示意圖

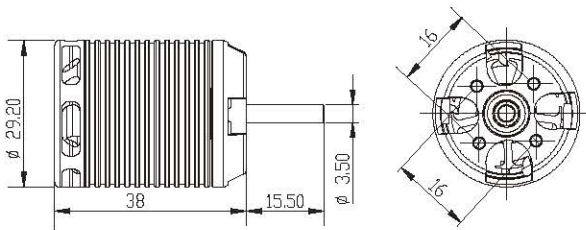

(Unit單位:mm)

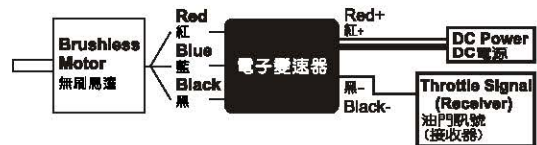

The motor rotates in different direction with different brand ESCs. If the wrong rotating direction happens, please switch any two cables to make the motor rotates in right direction.

由於各品牌電子變速器的馬達啟動轉向不盡相同，若發生轉向錯誤時，請將馬達與電子變速器的接線任兩條對調即可。

KV KV值	1700KV(RPM/V)	Input voltage 輸入電壓	6S
Stator Arms 矽鋼片槽數	9	Magnet Poles 磁鐵極數	6
Max continuous current 最大持續電流	30A	Max instantaneous current 最大瞬間電流	45A(5sec/5秒)
Max continuous power 最大持續功率	650W	Max Instantaneous power 最大瞬間功率	970W(5sec5秒)
Dimension 尺寸	Shaft 軸ϕ3.5x29.2x53.5mm	Weight 重量	Approx.約 83g

FEATURES 特性說明

- The 450MX motor incorporates radial fan in its end bell, creating powerful airflow to dissipate heat. Tweaks to motor design and reduction in weight not only contributes to dramatic power increase, the high efficiency cooling system enables cooler operating temperature during and after flights when compared to motor of previous generation.
 - The 450MX motor armature had a special balance adjust to improve the serious shaking problem that other tiny motors have.
 - Maintenance free, high torque, high efficiency, low temperature variant, stable and quiet.
 - Japanese made high-speed ball bearings, powerful magnetic outrunner rotor.
- 450MX採用全新的鼓風式後蓋設計，提供強大的散熱氣流，搭配嚴密的調校與輕量化設計，不僅扭力大幅提升，高效率的散熱設計在飛行中與飛行後都較前一代馬達有更低的溫昇表現。
 - 450MX馬達轉子皆經過特殊平衡校正，改善一般無外殼外轉馬達平衡不佳，易產生嚴重震動的缺失。
 - 免保養、高扭力、高效率、低噪音、低溫昇、控制穩定!
 - 日製高速滾珠軸承、高磁通外轉子。
 - 直昇機適用450全系列機型，齒比搭配建議，一般3D飛行可搭配14T，暴力3D可搭配15T馬達齒。